

NOTES
 1. NO OCCUPIED DWELLINGS OR BUILDINGS TWO THOUSAND FIVE HUNDRED (2,500) SQUARE FEET OR LARGER USED TO HOUSE OR SHELTER DAIRY CATTLE OR POULTRY HUSBANDRY ARE LOCATED WITHIN SIX HUNDRED TWENTY-FIVE (625) FEET OF THE CENTER OF THE WELL PAD. THERE ARE NO WATER WELLS OR DEVELOPED SPRINGS WITHIN 250 FEET OF THE PROPOSED WELL.
 2. LEASE BOUNDARY AND BEARINGS AND DISTANCES SHOWN HEREON ARE TAKEN FROM RITCHIE COUNTY DEED BOOK 182 AT PAGE 578.

(NAD) 27 (UTM) ZONE 17 COORDS:
 WELL 5H TOP HOLE INFORMATION:
 N: 14,223,895ft E: 1,673,850ft

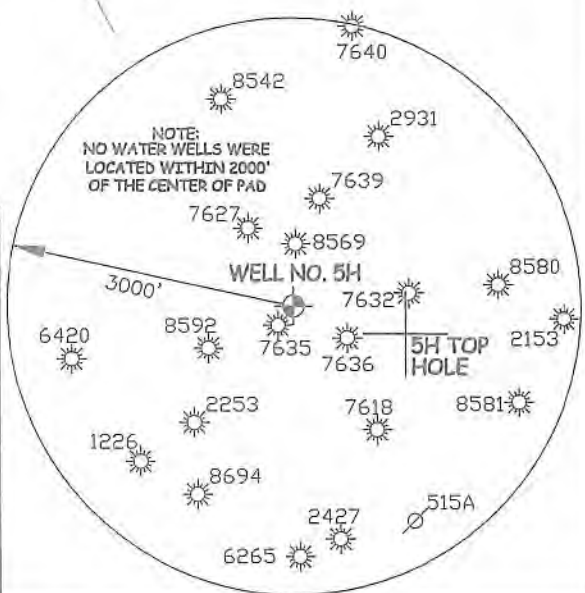

NOTES:
 WELL 5H TOP HOLE INFORMATION:
 WV STATE PLANE NAD 27 COORDS:
 N: 247,080ft E: 1,608,175ft
 GEOGRAPHIC NAD 27 COORDS:
 LAT: 39°10'12.38" LON: 80°52'55.32"
 (NAD) 83 (UTM) ZONE 17 COORDS:
 N: 4,335,670m E: 510,205m
 WEST VIRGINIA COORDINATE SYSTEM OF 1927 NORTH ZONE. ZONE WAS DERIVED FROM MEASUREMENTS TAKEN WITH TRIMBLE GEOXT SUBMETER MAPPING GRADE GPS UNIT. PLAT ORIENTATION, CORNER, AND WELL REFERENCE TIE LINES ARE BASED ON GRID NORTH.



JOB # 19-040WA
 DRAWING # GESEK5H
 SCALE 1" = 500'
 MINIMUM DEGREE OF ACCURACY SUBMETER
 PROVEN SOURCE OF ELEV. SUBMETER MAPPING GRADE GPS

I THE UNDERSIGNED, HEREBY CERTIFY THAT THIS PLAT IS CORRECT TO THE BEST OF MY KNOWLEDGE AND BELIEF AND SHOWS ALL THE INFORMATION REQUIRED BY LAW AND THE RULES ISSUED AND PERSCRIBED BY THE DEPARTMENT OF ENVIRONMENTAL PROTECTION.



STATE OF WEST VIRGINIA, DIVISION OF ENVIRONMENTAL PROTECTION, OFFICE OF OIL AND GAS
 WILLOW LAND SURVEYING PLLC
 266 HUSHERS RUN RD PENNSBORO WEST VIRGINIA 26415

LEGEND
 - - - - - Surface Owner Boundary Lines +/-
 - - - - - Adjoining Surface Tracts +/-
 ⊕ Found monument, as noted

DOUGLAS R. ROWE P.S. 2202

STATE OF WEST VIRGINIA DEPARTMENT OF ENERGY DIVISION OF OIL AND GAS

DATE 01/08/19
 OPERATOR'S WELL# GESEK#5H

WELL TYPE: OIL ___ GAS LIQUID INJECTION ___ WASTE DISPOSAL ___
 (IF "GAS") PRODUCTION STORAGE ___ DEEP ___ SHALLOW
 LOCATION: ELEVATION ORIGINAL - 1,052' PROPOSED - 1,031' WATERSHED SOUTH FORK HUGHES RIVER
 QUADRANGLE PULLMAN 7.5' DISTRICT UNION COUNTY RITCHIE

SURFACE OWNER CAROL A. MEYERS ET AL ACREAGE 39.88 ACRES +/-
 OIL & GAS ROYALTY OWNER ALMA J. MARTIN ET AL LEASE ACREAGE 39.88 ACRES +/-

PROPOSED WORK: DRILL CONVERT ___ DRILL DEEPER ___ REDRILL ___ FRACTURE OR STIMULATE PLUG OFF OLD FORMATION ___ PERFORATE NEW FORMATION

OTHER PHYSICAL CHANGE IN WELL (SPECIFY) _____
 PLUG & ABANDON ___ CLEAN OUT & REPLUG ___ ESTIMATED DEPTH 6,900' TVD 6,900' MD
 TARGET FORMATION MARCELLUS

WELL OPERATOR ANTERO RESOURCES CORP. DESIGNATED AGENT DIANNA STAMPER
 ADDRESS 1615 WYNKOOP STREET ADDRESS 5400 D BIG TYLER ROAD
 DENVER, CO 80202 CHARLESTON, WV 25313

COUNTY NAME PERMIT