

WR-35
Rev. 8/23/13Page 1 of 4

State of West Virginia
Department of Environmental Protection - Office of Oil and Gas
Well Operator's Report of Well Work

API 47 - 085 - 10412 County Wetzel District Union
 Quad TH: Pullman BH: Oxford Pad Name Weekly West Field/Pool Name -----
 Farm name David W & David Martin Weekley Well Number Maxson Unit 1H
 Operator (as registered with the OOG) Antero Resources Corporation
 Address 1615 Wynkoop Street City Denver State CO Zip 80202

As Drilled location NAD 83/UTM Attach an as-drilled plat, profile view, and deviation survey
 Top hole Northing 4335620m Easting 510779m
 Landing Point of Curve Northing 4335549.48m Easting 510259.59m
 Bottom Hole Northing 4331716m Easting 511573m

Elevation (ft) 1125' GL Type of Well New Existing Type of Report Interim Final
 Permit Type Deviated Horizontal Horizontal 6A Vertical Depth Type Deep Shallow
 Type of Operation Convert Deepen Drill Plug Back Redrilling Rework Stimulate
 Well Type Brine Disposal CBM Gas Oil Secondary Recovery Solution Mining Storage Other _____
 Type of Completion Single Multiple Fluids Produced Brine Gas NGL Oil Other _____
 Drilled with Cable Rotary

Drilling Media Surface hole Air Mud Fresh Water Intermediate hole Air Mud Fresh Water Brine
 Production hole Air Mud Fresh Water Brine

Mud Type(s) and Additive(s)

Air - Foam & 4% KCL

Mud - Polymer

Date permit issued 11/10/2021 Date drilling commenced 1/16/2022 Date drilling ceased 2/2/2022
 Date completion activities began 4/4/2022 Date completion activities ceased 6/13/2022
 Verbal plugging (Y/N) N/A Date permission granted N/A Granted by N/A

Please note: Operator is required to submit a plugging application within 5 days of verbal permission to plug

Freshwater depth(s) ft 401', 478' Open mine(s) (Y/N) depths No
 Salt water depth(s) ft 1511', 1926' Void(s) encountered (Y/N) depths No
 Coal depth(s) ft 1495', 742' Cavern(s) encountered (Y/N) depths No
 Is coal being mined in area (Y/N) No

Reviewed by:

02/10/2023

WR-35
Rev. 8/23/13

Page 2 of 4

API 47-085 - 10412 Farm name David W & David Martin Weekley Well number Maxson Unit 1H

CASING STRINGS	Hole Size	Casing Size	Depth	New or Used	Grade wt/ft	Basket Depth(s)	Did cement circulate (Y/N) * Provide details below*
Conductor	24"	20"	80'	New	78#, X60	N/A	Y
Surface	17-1/2"	13-3/8"	552'	New	54.5#, J-55	N/A	Y
Coal							
Intermediate 1	12-1/4"	9-5/8"	2659'	New	36#, J-55	N/A	Y
Intermediate 2							
Intermediate 3							
Production	8-3/4"/8-1/2"	5-1/2"	20952'	New	23#, P-100	N/A	Y
Tubing		2-3/8"	7038'		4.7#, P-110		
Packer type and depth set		N/A					

Comment Details _____

CEMENT DATA	Class/Type of Cement	Number of Sacks	Slurry wt (ppg)	Yield (ft ³ /sks)	Volume (ft ³)	Cement Top (MD)	WOC (hrs)
Conductor	Class A	209 sx	15.6	1.18	44	0'	8 Hrs.
Surface	Class A	685 sx	15.8	1.16	142	0'	8 Hrs.
Coal							
Intermediate 1	Class A	935 sx	15.8	1.16	193	0'	8 Hrs.
Intermediate 2							
Intermediate 3							
Production	Class H	875 sx (Lead) 3655 sx (Tail)	15.2 (Lead), 15.2(Tail)	1.19 (Lead), 1.18 (Tail)	767	-500' into intermediate casing	8 Hrs.
Tubing							

Drillers TD (ft) 20997' MD, 6552' TVD (BHL), 6578' (Deepest Point Drilled) Loggers TD (ft) 20997' MD
 Deepest formation penetrated Marcellus Plug back to (ft) N/A
 Plug back procedure N/A

Kick off depth (ft) 6045'

Check all wireline logs run caliper density deviated/directional induction
 neutron resistivity gamma ray temperature sonic

Well cored Yes No Conventional Sidewall Were cuttings collected Yes No

DESCRIBE THE CENTRALIZER PLACEMENT USED FOR EACH CASING STRING _____
 Conductor - 0
 Surface - 1 above guide shoe, 1 above insert float, 1 every 4th joint to surface
 Intermediate - 1 above float joint, 1 above float collar, 1 every 4th joint to surface
 Production - 1 above float joint, 1 below float collar, 1 every 3rd joint to top of cement

WAS WELL COMPLETED AS SHOT HOLE Yes No DETAILS _____

WAS WELL COMPLETED OPEN HOLE? Yes No DETAILS _____

WERE TRACERS USED Yes No TYPE OF TRACER(S) USED N/A

02/10/2023

WR-35
Rev. 8/23/13

Page 4 of 4

API 47- 085 - 10412 Farm name David W & David Martin Weekley Well number Maxson Unit 1H

PRODUCING FORMATION(S)	DEPTHS		
Marcellus	6525' (TOP)	TVD	7160' (TOP) MD

Please insert additional pages as applicable.

GAS TEST Build up Drawdown Open Flow OIL TEST Flow Pump

SHUT-IN PRESSURE Surface 2800 psi Bottom Hole --- psi DURATION OF TEST --- hrs

OPEN FLOW Gas 12353 mcfpd Oil 152 bpd NGL --- bpd Water 179 bpd GAS MEASURED BY Estimated Orifice Pilot

LITHOLOGY/ FORMATION	TOP	BOTTOM	TOP	BOTTOM	DESCRIBE ROCK TYPE AND RECORD QUANTITY AND TYPE OF FLUID (FRESHWATER, BRINE, OIL, GAS, H ₂ S, ETC)
	DEPTH IN FT NAME TVD	DEPTH IN FT TVD	DEPTH IN FT MD	DEPTH IN FT MD	

***PLEASE SEE ATTACHED EXHIBIT 3**

Please insert additional pages as applicable.

Drilling Contractor H & P Drilling
Address 912 N Eagle Valley Rd City Howard State PA Zip 16841

Logging Company Nine Energy Services
Address 6500 West Fwy City Fort Worth State TX Zip 76116

Cementing Company Halliburton Energy Services
Address 3000 W. Sam Houston Pkwy City Houston State TX Zip 76114

Stimulating Company Halliburton
Address 3000 W. Sam Houston Pkwy City Houston State TX Zip 76114

Please insert additional pages as applicable.

Completed by Brandi Hankins Telephone 304-842-9759
Signature  Title Completions Technician Date 2/2/23

Submittal of Hydraulic Fracturing Chemical Disclosure Information Attach copy of FRACFOCUS Registry

02/10/2023

API 47-085-10412 Farm Name David W & David Martin Weekley Well Number Maxson Unit 1H					
Stage No.	Perforation Date	Perforated from MD ft.	Perforated to MD ft.	Number of Perforations	Formations
1	04/04/2022	20882	20840	36	Marcellus
2	04/05/2022	20802.60294	20637.6176	36	Marcellus
3	04/06/2022	20602.22059	20437.2353	36	Marcellus
4	04/06/2022	20401.83824	20236.8529	36	Marcellus
5	04/07/2022	20201.45588	20036.4706	36	Marcellus
6	04/07/2022	20001.07353	19836.0882	36	Marcellus
7	04/07/2022	19800.69118	19635.7059	36	Marcellus
8	04/08/2022	19600.30882	19435.3235	36	Marcellus
9	04/08/2022	19399.92647	19234.9412	36	Marcellus
10	04/08/2022	19199.54412	19034.5588	36	Marcellus
11	04/09/2022	18999.16176	18834.1765	36	Marcellus
12	04/09/2022	18798.77941	18633.7941	36	Marcellus
13	04/10/2022	18598.39706	18433.4118	36	Marcellus
14	04/10/2022	18398.01471	18233.0294	36	Marcellus
15	04/10/2022	18197.63235	18032.6471	36	Marcellus
16	04/11/2022	17997.25	17832.2647	36	Marcellus
17	04/11/2022	17796.86765	17631.8824	36	Marcellus
18	04/12/2022	17596.48529	17431.5	36	Marcellus
19	04/12/2022	17396.10294	17231.1176	36	Marcellus
20	04/12/2022	17195.72059	17030.7353	36	Marcellus
21	04/13/2022	16995.33824	16830.3529	36	Marcellus
22	04/13/2022	16794.95588	16629.9706	36	Marcellus
23	04/13/2022	16594.57353	16429.5882	36	Marcellus
24	04/13/2022	16394.19118	16229.2059	36	Marcellus
25	04/14/2022	16193.80882	16028.8235	36	Marcellus
26	04/14/2022	15993.42647	15828.4412	36	Marcellus
27	04/14/2022	15793.04412	15628.0588	36	Marcellus
28	04/15/2022	15592.66176	15427.6765	36	Marcellus
29	04/15/2022	15392.27941	15227.2941	36	Marcellus
30	04/15/2022	15191.89706	15026.9118	36	Marcellus
31	04/16/2022	14991.51471	14826.5294	36	Marcellus
32	04/16/2022	14791.13235	14626.1471	36	Marcellus
33	04/16/2022	14590.75	14425.7647	36	Marcellus
34	04/17/2022	14390.36765	14225.3824	36	Marcellus
35	04/17/2022	14189.98529	14025	36	Marcellus
36	04/17/2022	13989.60294	13824.6176	36	Marcellus
37	04/18/2022	13789.22059	13624.2353	36	Marcellus
38	04/18/2022	13588.83824	13423.8529	36	Marcellus
39	04/18/2022	13388.45588	13223.4706	36	Marcellus
40	04/19/2022	13188.07353	13023.0882	36	Marcellus
41	04/19/2022	12987.69118	12822.7059	36	Marcellus
42	04/19/2022	12787.30882	12622.3235	36	Marcellus
43	04/20/2022	12586.92647	12421.9412	36	Marcellus
44	04/20/2022	12386.54412	12221.5588	36	Marcellus
45	04/20/2022	12186.16176	12021.1765	36	Marcellus
46	04/21/2022	11985.77941	11820.7941	36	Marcellus
47	04/21/2022	11785.39706	11620.4118	36	Marcellus
48	04/21/2022	11585.01471	11420.0294	36	Marcellus
49	04/21/2022	11384.63235	11219.6471	36	Marcellus
50	04/22/2022	11184.25	11019.2647	36	Marcellus
51	04/22/2022	10983.86765	10818.8824	36	Marcellus
52	04/23/2022	10783.48529	10618.5	36	Marcellus
53	04/23/2022	10583.10294	10418.1176	36	Marcellus
54	04/23/2022	10382.72059	10217.7353	36	Marcellus
55	04/23/2022	10182.33824	10017.3529	36	Marcellus
56	04/24/2022	9981.955882	9816.97059	36	Marcellus
57	04/24/2022	9781.573529	9616.58824	36	Marcellus
58	04/24/2022	9581.191176	9416.20588	36	Marcellus
59	04/25/2022	9380.808824	9215.82353	36	Marcellus
60	04/25/2022	9180.426471	9015.44118	36	Marcellus
61	04/25/2022	8980.044118	8815.05882	36	Marcellus
62	04/25/2022	8779.661765	8614.67647	36	Marcellus
63	04/26/2022	8579.279412	8414.29412	36	Marcellus
64	04/26/2022	8378.897059	8213.91176	36	Marcellus
65	04/27/2022	8178.514706	8013.52941	36	Marcellus
66	04/27/2022	7978.132353	7813.14706	36	Marcellus
67	04/27/2022	7777.75	7612.76471	36	Marcellus
68	04/27/2022	7577.367647	7412.38235	36	Marcellus
69	04/27/2022	7376.985294	7212	36	Marcellus

02/10/2023

02/10/2023

API 47-085-10412 Farm Name David W & David Martin Weekley Well Number Maxson Unit 1H								
EXHIBIT 2								
Stage No.	Stimulations Date	Avg Pump Rate	Avg Treatment Pressure (PSI)	Max Breakdown Pressure (PSI)	ISIP (PSI)	Amount of Proppant (lbs)	Amount of Water (bbls)	Amount of Nitrogen/ other (units)
1	04/04/2022	55.57	7564	6226	2815	52689	169725	N/A
2	04/05/2022	76.91	8305	7002	2881.88	411201	329919	N/A
3	04/06/2022	82.79	8700	9327	2738	403312	312222	N/A
4	04/06/2022	86.14	8474	7850	3297	409310	322291	N/A
5	04/07/2022	79.85	8792	8446	2717	402862	311943	N/A
6	04/07/2022	82.92	8123	6879	2957	398425	367807	N/A
7	04/07/2022	81.19	8589	7368	2705	408195	317481	N/A
8	04/08/2022	80.54	8406	7003	2893	404117	310338	N/A
9	04/08/2022	86.72	8523	6775	4131	399186	318761	N/A
10	04/08/2022	83.75	8475	7081	2701	404780	317458	N/A
11	04/09/2022	77.45	8542	7566	3276	405996	315908	N/A
12	04/09/2022	89.26	8439	3861	2943	405657	313397	N/A
13	04/10/2022	80.16	8345	7274	2531	405194	327797	N/A
14	04/10/2022	84.06	8403	7659	3408	400828	436869	N/A
15	04/10/2022	76.83	8006	7432	2555	407040	299696	N/A
16	04/11/2022	88.62	8516	7656	3032	401976	318500	N/A
17	04/11/2022	83.96	8342	7765	2996	405477	300811	N/A
18	04/12/2022	83.67	8370	7360	2984	407034	290932	N/A
19	04/12/2022	89.9	8386	6800	2934	407804	310720	N/A
20	04/12/2022	90.95	8464	6532	3199	404193	306684	N/A
21	04/13/2022	86.33	8519	8033	2928	402860	297607	N/A
22	04/13/2022	85.91	8715	7008	3125	404718	296595	N/A
23	04/13/2022	91.89	8683	7090	3261	405087	292221	N/A
24	04/13/2022	90.9	8427	8208	2767	405160	296408	N/A
25	04/14/2022	95.2	8545	8028	2900	407020	296799	N/A
26	04/14/2022	92.3	8511	7553	3341.18	404685	294146	N/A
27	04/14/2022	92.18	8365	7891	2905	403559	296204	N/A
28	04/15/2022	92.7	8413	8126	3275	408080	301448	N/A
29	04/15/2022	92.8	8474	7355	3368	401356	297669	N/A
30	04/15/2022	97.62	8199	7954	3379	416376	304659	N/A
31	04/16/2022	94.97	8648	7962	2986	401362	293615	N/A
32	04/16/2022	98.42	8202	7076	3076	404914	300645	N/A
33	04/16/2022	97.45	8228	7719	3040	407325	297857	N/A
34	04/17/2022	96.56	8300	7913	2892	406000	294914	N/A
35	04/17/2022	98.58	8332	7159	2840	410220	300945	N/A
36	04/17/2022	97.14	8108	7961	3103	406440	297996	N/A
37	04/18/2022	97.99	8099	7967	2939	407700	299775	N/A
38	04/18/2022	96.84	8214	6607	2949	401541	287414	N/A
39	04/18/2022	98.08	7956	7818	2950	404843	294692	N/A
40	04/19/2022	97.14	8005	7779	3128	401496	297070	N/A
41	04/19/2022	97.89	7897	7038	2967	401650	301495	N/A
42	04/19/2022	91.98	8053	7917	3051	402723	295470	N/A
43	04/20/2022	96.83	7871	7774	3044	402266	300500	N/A
44	04/20/2022	96.3	7925	6861	3128	399433	296097	N/A
45	04/20/2022	96.9	7715	7616	2979	404780	304577	N/A
46	04/21/2022	97.69	7680	7814	2988	413880	293213	N/A
47	04/21/2022	97.06	7687	7888	2992	413840	301382	N/A
48	04/21/2022	97.97	7582	6564	2989	401766	295551	N/A
49	04/21/2022	97.73	7331	7349	2965	406113	294480	N/A
50	04/22/2022	96.88	7478	6945	2965	401864	293765	N/A
51	04/22/2022	97.07	7477	6204	2778	412800	293069	N/A
52	04/23/2022	95.66	7421	7800	2816	411540	294181	N/A
53	04/23/2022	98	7511	5942	2609	409020	342692	N/A
54	04/23/2022	97.82	7235	5872	3038	422162	305750	N/A
55	04/23/2022	98.41	7409	7914	2886	404287	290516	N/A
56	04/24/2022	97.1	7364	8198	2614	405780	289021	N/A
57	04/24/2022	96.86	7093	7188	2887	408400	299636	N/A
58	04/24/2022	98.3	7079	8114	2872	403380	288242	N/A
59	04/25/2022	99.03	7198	8159	2945	408500	288805	N/A
60	04/25/2022	97.04	7276	8089	2953.44	411620	299887	N/A
61	04/25/2022	98.46	7106	5813	3245	408960	297057	N/A
62	04/25/2022	98.52	7129	8118	2924	407340	295850	N/A
63	04/26/2022	98.55	6989	8308	2953	404100	294316	N/A
64	04/26/2022	98.3	6995	6912	2825	402723	293763	N/A
65	04/27/2022	87.96	6868	6785	2988	406180	325713	N/A
66	04/27/2022	94.83	6885	6604	2589	403280	361365	N/A
67	04/27/2022	98.78	6719	6487	3030	409820	294161	N/A
68	04/27/2022	98.24	6687	6228	3161	405780	287185	N/A
69	04/27/2022	96.75	6427	5772	3436	405620	297143	N/A
	AVG=	92	7,925	7,324	2,992	27,655,625	20,952,820	TOTAL

02/10/2023

02/10/2023

API 47-085-10412 Farm Name Barbara Kay Turner Well Number Maxson Unit 1H				
EXHIBIT 3				
LITHOLOGY/ FORMATION	TOP DEPTH (TVD)	BOTTOM DEPTH (TVD)	TOP DEPTH (MD)	BOTTOM DEPTH (MD)
	From Surface	From Surface	From Surface	From Surface
Sandy Siltstone, tr LS	100	280	100	280
Sandy Siltstone, occ LS	280	430	280	430
Shaly Siltstone, tr SS	430	490	430	490
Shaly Siltstone, Coal	490	520	490	520
Shaly Siltstone, occ SS, tr Coal	520	610	520	610
Shaly Siltstone	610	730	610	730
Silty Shale, tr ls, coal	730	820	730	820
Sandy Shale, tr coal	820	970	820	970
Shaly Sandstone, tr coal	970	1,300	970	1,300
Sandy Shale, occ Siltstone	1,300	1,540	1,300	1,540
Silty Shale, occ sandstone	1,540	1,930	1,540	1,930
Shale, occ sandstone	1,930	2,050	1,930	2,050
Sandy Siltstone, occ shale	2,050	2,002	2,050	2,050
Big Lime	2,032	2,542	2,050	2,638
Fifty Foot Sandstone	2,542	2,745	2,608	2,867
Gordon	2,745	3,030	2,837	3,181
Fifth Sandstone	3,030	3,112	3,151	3,270
Bayard	3,112	3,866	3,240	4,086
Speechley	3,866	4,046	4,056	4,279
Balltown	4,046	4,582	4,249	4,859
Bradford	4,582	4,976	4,829	5,279
Benson	4,976	5,219	5,249	5,542
Alexander	5,219	6,388	5,512	6,811
Sycamore	6,188	6,358	6,582	6,781
Middlesex	6,358	6,472	6,781	6,971
Burkett	6,472	6,507	6,971	7,073
Tully	6,507	6,525	7,073	7,160
Marcellus	6,525	NA	7,160	NA

*Please note Antero determines formation tops based on mud logs that are only run on one well on a multi-well pad. The measured depth (MD) data on subsequent wells may be slightly different due to the well's unique departure.

02/10/2023

Hydraulic Fracturing Fluid Product Component Information Disclosure

Job Start Date:	4/4/2022
Job End Date:	4/27/2022
State:	West Virginia
County:	Ritchie
API Number:	47-085-10412-00-00
Operator Name:	Antero Resources Corporation
Well Name and Number:	MAXSON UNIT 1H
Latitude:	39.16965000
Longitude:	-80.87539000
Datum:	NAD27
Federal Well:	NO
Indian Well:	NO
True Vertical Depth:	6,578
Total Base Water Volume (gal):	22,330,203
Total Base Non Water Volume:	0



Hydraulic Fracturing Fluid Composition:

Trade Name	Supplier	Purpose	Ingredients	Chemical Abstract Service Number (CAS #)	Maximum Ingredient Concentration in Additive (% by mass)**	Maximum Ingredient Concentration in HF Fluid (% by mass)**	Comments
Produced Water	Halliburton	Base Fluid					
			Water	7732-18-5	100.00000	87.11681	Density = 8.50
Ingredients	Listed Above	Listed Above					
			Water	7732-18-5	100.00000	0.16752	

FDP-S1443-21	Halliburton	Corrosion Inhibitor					
				Listed Below			
WG-36 GELLING AGENT	Halliburton	Gelling Agent					
				Listed Below			
Sand-Premium White-30/70	Halliburton	Proppant					
				Listed Below			
LEGEND(TM) LD-7750W	MultiChem	Scale Control					
				Listed Below			
Sand-Premium White-30/50	Halliburton	Proppant					
				Listed Below			
MC B-8614A	MultiChem	Biocide					
				Listed Below			
HYDROCHLORIC ACID, 22 BAUME	Halliburton	Solvent					
				Listed Below			
Excelerate LX-15	Halliburton	Friction Reducer					
				Listed Below			

OPTIFLO-II DELAYED RELEASE BREAKER	Halliburton	Breaker					
				Listed Below			
Sand-Common White-100 Mesh, SSA-2	Halliburton	Proppant					
				Listed Below			
HAI-501	Halliburton	Acid Corrosion Inhibitor					
				Listed Below			
Items above are Trade Names with the exception of Base Water . Items below are the individual ingredients.							
			Crystalline silica, quartz	14808-60-7	100.00000	12.69330	
			Hydrochloric acid	7647-01-0	30.00000	0.03747	
			Complex Amine Compound	Proprietary	60.00000	0.02493	
			Hydrotreated light petroleum distillate	64742-47-8	30.00000	0.01246	
			Methanol	67-56-1	100.00000	0.00709	
			Guar gum	9000-30-0	100.00000	0.00529	
			Glutaraldehyde	111-30-8	30.00000	0.00245	
			Sorbitan, mono-9- octadecenoate, (Z)	1338-43-8	5.00000	0.00208	
			Surfactant	Proprietary	5.00000	0.00208	
			Phosphoric Acid Salt	Proprietary	5.00000	0.00057	
			Sodium chloride	7647-14-5	5.00000	0.00057	
			Ethoxylated alcohols	Proprietary	30.00000	0.00048	
			Alkoxylated polyhydric alcohol	Proprietary	1.00000	0.00042	
			Organic chloride compound	Proprietary	1.00000	0.00042	

			Alkyl (C12-16) dimethylbenzyl ammonium chloride	68424-85-1	5.00000	0.00041	
			Ammonium persulfate	7727-54-0	100.00000	0.00025	
			Ethanol	64-17-5	1.00000	0.00008	
			Oxylated phenolic resin	Proprietary	30.00000	0.00008	
			Modified thiourea polymer	Proprietary	30.00000	0.00002	
			Formaldehyde	50-00-0	0.10000	0.00002	
			Mixture of dimer and trimer fatty acids of indefinite composition derived from tall oil	61790-12-3	30.00000	0.00001	
			Aldehyde	Proprietary	5.00000	0.00001	
			Acrylamide	79-06-1	0.01000	0.00000	
			Organic salt #1	Proprietary	0.01000	0.00000	
			Sodium glycolate	2836-32-0	0.01000	0.00000	
			Nitrated acetate salt	Proprietary	0.01000	0.00000	
			Organic salt #2	Proprietary	0.01000	0.00000	
			Sodium hydroxide	1310-73-2	0.01000	0.00000	
			C.I. pigment Orange 5	3468-63-1	1.00000	0.00000	
			1-Octadecene	112-88-9	1.00000	0.00000	
			1-Hexadecene	629-73-2	1.00000	0.00000	
			Hexadecene	629-73-2	5.00000	0.00000	
			Propargyl alcohol	107-19-7	5.00000	0.00000	

* Total Water Volume sources may include various types of water including fresh water, produced water, and recycled water

** Information is based on the maximum potential for concentration and thus the total may be over 100%

*** If you are calculating a percentage of total ingredients do not add the water volume below the green line to the water volume above the green line

Note: For Field Development Products (products that begin with FDP), MSDS level only information has been provided.

Ingredient information for chemicals subject to 29 CFR 1910.1200(i) and Appendix D are obtained from suppliers Material Safety Data Sheets (MSDS)

Hydraulic Fracturing Fluid Product Component Information Disclosure

Job Start Date:	4/4/2022
Job End Date:	4/27/2022
State:	West Virginia
County:	Ritchie
API Number:	47-085-10412-00-00
Operator Name:	Antero Resources Corporation
Well Name and Number:	MAXSON UNIT 1H
Latitude:	39.16965000
Longitude:	-80.87539000
Datum:	NAD27
Federal Well:	NO
Indian Well:	NO
True Vertical Depth:	6,578
Total Base Water Volume (gal):	22,330,203
Total Base Non Water Volume:	0



Hydraulic Fracturing Fluid Composition:

Trade Name	Supplier	Purpose	Ingredients	Chemical Abstract Service Number (CAS #)	Maximum Ingredient Concentration in Additive (% by mass)**	Maximum Ingredient Concentration in HF Fluid (% by mass)**	Comments
Produced Water	Halliburton	Base Fluid					
			Water	7732-18-5	100.00000	87.11681	Density = 8.50
Ingredients	Listed Above	Listed Above					
			Water	7732-18-5	100.00000	0.16752	

FDP-S1443-21	Halliburton	Corrosion Inhibitor					
				Listed Below			
WG-36 GELLING AGENT	Halliburton	Gelling Agent					
				Listed Below			
Sand-Premium White-30/70	Halliburton	Proppant					
				Listed Below			
LEGEND(TM) LD-7750W	MultiChem	Scale Control					
				Listed Below			
Sand-Premium White-30/50	Halliburton	Proppant					
				Listed Below			
MC B-8614A	MultiChem	Biocide					
				Listed Below			
HYDROCHLORIC ACID, 22 BAUME	Halliburton	Solvent					
				Listed Below			
Excelerate LX-15	Halliburton	Friction Reducer					
				Listed Below			

OPTIFLO-II DELAYED RELEASE BREAKER	Halliburton	Breaker					
				Listed Below			
Sand-Common White-100 Mesh, SSA-2	Halliburton	Proppant					
				Listed Below			
HAI-501	Halliburton	Acid Corrosion Inhibitor					
				Listed Below			

Items above are Trade Names with the exception of Base Water . Items below are the individual ingredients.

			Crystalline silica, quartz	14808-60-7	100.00000	12.69330	
			Hydrochloric acid	7647-01-0	30.00000	0.03747	
			Complex Amine Compound	Proprietary	60.00000	0.02493	
			Hydrotreated light petroleum distillate	64742-47-8	30.00000	0.01246	
			Methanol	67-56-1	100.00000	0.00709	
			Guar gum	9000-30-0	100.00000	0.00529	
			Glutaraldehyde	111-30-8	30.00000	0.00245	
			Sorbitan, mono-9- octadecenoate, (Z)	1338-43-8	5.00000	0.00208	
			Surfactant	Proprietary	5.00000	0.00208	
			Phosphoric Acid Salt	Proprietary	5.00000	0.00057	
			Sodium chloride	7647-14-5	5.00000	0.00057	
			Ethoxylated alcohols	Proprietary	30.00000	0.00048	
			Alkoxyated polyhydric alcohol	Proprietary	1.00000	0.00042	
			Organic chloride compound	Proprietary	1.00000	0.00042	

		Alkyl (C12-16) dimethylbenzyl ammonium chloride	68424-85-1	5.00000	0.00041
		Ammonium persulfate	7727-54-0	100.00000	0.00025
		Ethanol	64-17-5	1.00000	0.00008
		Oxylated phenolic resin	Proprietary	30.00000	0.00008
		Modified thiourea polymer	Proprietary	30.00000	0.00002
		Formaldehyde	50-00-0	0.10000	0.00002
		Mixture of dimer and trimer fatty acids of indefinite composition derived from tall oil	61790-12-3	30.00000	0.00001
		Aldehyde	Proprietary	5.00000	0.00001
		Acrylamide	79-06-1	0.01000	0.00000
		Organic salt #1	Proprietary	0.01000	0.00000
		Sodium glycolate	2836-32-0	0.01000	0.00000
		Nitrated acetate salt	Proprietary	0.01000	0.00000
		Organic salt #2	Proprietary	0.01000	0.00000
		Sodium hydroxide	1310-73-2	0.01000	0.00000
		C.I. pigment Orange 5	3468-63-1	1.00000	0.00000
		1-Octadecene	112-88-9	1.00000	0.00000
		1-Hexadecene	629-73-2	1.00000	0.00000
		Hexadecene	629-73-2	5.00000	0.00000
		Propargyl alcohol	107-19-7	5.00000	0.00000

* Total Water Volume sources may include various types of water including fresh water, produced water, and recycled water

** Information is based on the maximum potential for concentration and thus the total may be over 100%

*** If you are calculating a percentage of total ingredients do not add the water volume below the green line to the water volume above the green line

Note: For Field Development Products (products that begin with FDP), MSDS level only information has been provided.

Ingredient information for chemicals subject to 29 CFR 1910.1200(i) and Appendix D are obtained from suppliers Material Safety Data Sheets (MSDS)

LATITUDE 39°12'30" 109'

LATITUDE 39°10'00"

9,342' TO BOTTOM HOLE

Antero Resources Corporation Well No. Maxson Unit 1H

AS DRILLED DATA: WELL 1H TOP HOLE INFORMATION: N: 246,886ft E: 1,610,057ft LAT: 39°10'10.75" LON: 80°52'31.39" BOTTOM HOLE INFORMATION: N: 234,029ft E: 1,612,447ft LAT: 39°08'04.04" LON: 80°51'58.56" WEST VIRGINIA COORDINATE SYSTEM OF 1927 NORTH ZONE. ZONE WAS DERIVED FROM MEASUREMENTS TAKEN WITH TRIMBLE GEOXT SUBMETER MAPPING GRADE GPS UNIT. PLAT ORIENTATION, CORNER, AND WELL REFERENCE TIE LINES ARE BASED ON GRID NORTH.

(NAD) 83 (UTM) ZONE 17 COORDS: WELL 1H TOP HOLE INFORMATION: N: 4,335,620m E: 510,779m BOTTOM HOLE INFORMATION: N: 4,331,716m E: 511,573m

WELL 1H POINT OF ENTRY INFORMATION: WV STATE PLANE NAD '27 (NORTH ZONE): N: 247,161ft E: 1,608,208ft GEOGRAPHIC (NAD) 27: LAT: 39°10'13.19" LON: 80°52'54.92" (NAD) 83 (UTM) ZONE 17 COORDS: N: 4,335,695m E: 510,215m

Table listing landowners and lease information for the area, including names like David W. Weekley, Albin Gesek, and various lease numbers.

WV NORTH ZONE GRID NORTH

1,731' TO BOTTOM HOLE

14,088'

LONGITUDE 80°50'00"

LONGITUDE 80°52'30"

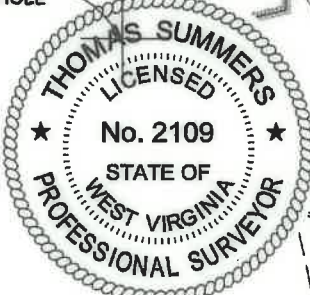

I, THE UNDERSIGNED, HEREBY CERTIFY THAT THIS PLAT IS CORRECT TO THE BEST OF MY KNOWLEDGE AND BELIEF AND SHOWS ALL THE INFORMATION REQUIRED BY LAW AND THE RULES ISSUED AND PERSCRIBED BY THE DEPARTMENT OF ENVIRONMENTAL PROTECTION.



STATE OF WEST VIRGINIA, DIVISION OF ENVIRONMENTAL PROTECTION, OFFICE OF OIL AND GAS. WILLOW LAND SURVEYING PLLC 220 MASONIC AVE. PENNSBORO WEST VIRGINIA 26415

JOB # 15-059WA DRAWING # MAXSON1HAD SCALE 1" = 2000' MINIMUM DEGREE OF ACCURACY SUBMETER PROVEN SOURCE OF ELEV. SUBMETER MAPPING GRADE GPS

LEGEND: Surface Owner Boundary Lines +/- Interior Surface Tracts +/- Proposed Well Path As Drilled Well Path. THOMAS SUMMERS P.S. 2109

STATE OF WEST VIRGINIA DEPARTMENT OF ENERGY DIVISION OF OIL AND GAS

DATE 8/19/22 OPERATOR'S WELL# MAXSON UNIT #1H

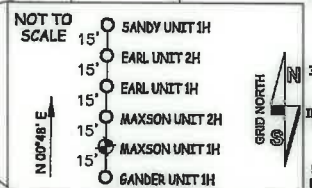

- NOTES: 1. NO OCCUPIED DWELLINGS OR BUILDINGS TWO THOUSAND FIVE HUNDRED (2,500) SQUARE FEET OR LARGER USED TO HOUSE OR SHELTER BARRY CATTLE OR POULTRY... 2. TOP HOLE DATA SHOWN HEREON WAS PROVIDED BY ANTERO RESOURCES CORPORATION... 3. AS DRILLED DATA WAS PROVIDED BY ANTERO RESOURCES CORPORATION... 4. WLS IS NOT CERTIFYING THE DATA AND INFORMATION PROVIDED LISTED IN NOTES 2 AND 3... 5. WLS IS BY NO MEANS RESPONSIBLE FOR ANY ERRORS OR INACCURACIES WITH THE DATA AND INFORMATION THAT HAS BEEN PROVIDED.

WELL TYPE: OIL ___ GAS X LIQUID INJECTION ___ WASTE DISPOSAL ___ 47 - 085 - 10412 (IF "GAS") PRODUCTION X STORAGE ___ DEEP ___ SHALLOW X STATE COUNTY PERMIT LOCATION: ELEVATION 1,125' -AS BUILT WATERSHED SOUTH FORK HUGHES RIVER QUADRANGLE TH - PULLMAN 7.5' BH - OXFORD 7.5' DISTRICT UNION COUNTY RITCHIE SURFACE OWNER DAVID W. & DAVID MARTIN WEEKLEY ACREAGE 39.87 ACRES +/- OIL & GAS ROYALTY OWNER T. D. DOTSON ET UX; ALMA J. MARTIN ET AL.; DAVID W. WEEKLEY ET AL.; LEASE ACREAGE 39.87 AC +/-; 39.88 AC +/-; 71 AC +/-; JOHN M. DEBRULAR ET UX; LEWIS EARL PIERCE ET UX; BRADFORD SPIKER ET UX; SUSAN V. DRENNAN REVOCABLE TRUST; 154AC +/-; 82 AC +/-; 52 AC +/-; 49 AC +/-; DONALD J. SHEETS; MICHAEL I. SPIKER; GLEN MAXSON; HARRY H. SHEETS ET AL.; ELVA MAXSON ET AL.; ENOCH DOW MAXSON 89 AC +/-; 60.33 AC +/-; 72.62 AC +/-; 167.3 AC +/-; 240 AC +/-; 65 AC +/- PROPOSED WORK: DRILL ___ CONVERT ___ DRILL DEEPER ___ REDRILL ___ FRACTURE OR STIMULATE ___ PLUG OFF OLD FORMATION ___ PERFORATE NEW FORMATION ___ OTHER PHYSICAL CHANGE IN WELL (SPECIFY) AS DRILLED PLUG & ABANDON CLEAN OUT & REPLUG TARGET FORMATION MARCELLUS ESTIMATED DEPTH 6,552' TVD 20,997' MD WELL OPERATOR ANTERO RESOURCES CORP. DESIGNATED AGENT DIANNA STAMPER - CT CORPORATION SYSTEM ADDRESS 1615 WYNKOOP ST. ADDRESS 5400 D BIG TYLER ROAD DENVER, CO 80202 CHARLESTON, WV 25313

