

LATITUDE 39°12'30"

6,887'

LATITUDE 39°12'30" 1,200' TO BOTTOM HOLE 2H BOTTOM

Antero Resources Corporation Well No. Allender 2H

Table listing Union District - Ritchie County well numbers and names, including Naomi Cunningham, John Louke, Marvin Osborne, etc.

Table listing Southwest District - Doddridge County well numbers and names, including Jeffrey Polan, Cevasco Family Trust, Juanita Leggett, etc.

AS DRILLED DATA: HOLE WELL 2H TOP HOLE INFORMATION: N: 247,725ft E: 1,615,106ft LAT: 39°10'19.80" LON: 80°51'27.45" BOTTOM HOLE INFORMATION: N: 260,432ft E: 1,609,173ft LAT: 39°12'24.49" LON: 80°52'45.25" WEST VIRGINIA COORDINATE SYSTEM OF 1927 NORTH ZONE. ZONE WAS DERIVED FROM MEASUREMENTS TAKEN WITH TRIMBLE GEOXT SUBMETER MAPPING GRADE GPS UNIT. PLAT ORIENTATION, CORNER, AND WELL REFERENCE TIE LINES ARE BASED ON GRID NORTH.

(NAD) 83 (UTM) ZONE 17 COORDS: WELL 2H TOP HOLE INFORMATION: N: 4,335,901m E: 512,313m BOTTOM HOLE INFORMATION: N: 4,339,742m E: 510,441m

(NAD) 27 (UTM) ZONE 17 COORDS: WELL 2H TOP HOLE INFORMATION: N: 14,224,656ft E: 1,680,768ft POINT OF ENTRY INFORMATION: N: 14,224,326ft E: 1,679,989ft BOTTOM HOLE INFORMATION: N: 14,237,257ft E: 1,674,626ft

- NOTE: 1. NO OCCUPIED DWELLINGS OR BUILDINGS TWO THOUSAND FIVE HUNDRED (2,500) SQUARE FEET OR LARGER USED TO HOUSE OR SHEAR DAIRY CATTLE OR POULTRY HUSBANDRY ARE LOCATED WITHIN SIX HUNDRED TWENTY-FIVE (625) FEET OF THE CENTER OF THE WELL PAD. 2. TOP HOLE DATA SHOWN HEREON WAS PROVIDED BY ANTERO RESOURCES CORPORATION. 3. AS DRILLED DATA WAS PROVIDED BY ANTERO RESOURCES CORPORATION. 4. WLS IS NOT CERTIFYING THE DATA AND INFORMATION PROVIDED LISTED IN NOTES 2 AND 3, ONLY THE RELATIONSHIP TO THE DATA AND INFORMATION PROVIDED TO THE LEASE BOUNDARIES. 5. WLS IS BY NO MEANS RESPONSIBLE FOR ANY ERRORS OR INACCURACIES WITH THE DATA AND INFORMATION THAT HAS BEEN PROVIDED.

WV NORTH ZONE GRID NORTH

557' TO BOTTOM HOLE

LONGITUDE 80°52'30"

13,173'

LONGITUDE 80°50'00"

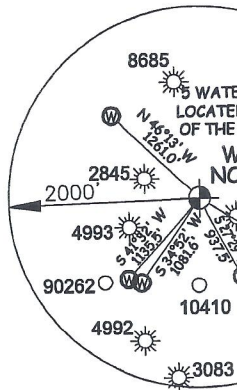

I THE UNDERSIGNED, HEREBY CERTIFY THAT THIS PLAT IS CORRECT TO THE BEST OF MY KNOWLEDGE AND BELIEF AND SHOWS ALL THE INFORMATION REQUIRED BY LAW AND THE RULES ISSUED AND PERSCRIBED BY THE DEPARTMENT OF ENVIRONMENTAL PROTECTION.



STATE OF WEST VIRGINIA, DIVISION OF ENVIRONMENTAL PROTECTION, OFFICE OF OIL AND GAS. WILLOW LAND SURVEYING PLLC 220 MASONIC AVE. PENNSBORO WEST VIRGINIA 26415

JOB # 12-121WA DRAWING # ALLENDER2HAD SCALE 1" = 2000' MINIMUM DEGREE OF ACCURACY SUBMETER PROVEN SOURCE OF ELEV. SUBMETER MAPPING GRADE GPS

LEGEND: Surface Owner Boundary Lines +/- Interior Surface Tracts +/- Proposed Well Path As Drilled Well Path. THOMAS SUMMERS P.S. 2109

STATE OF WEST VIRGINIA DEPARTMENT OF ENERGY DIVISION OF OIL AND GAS

DATE 05/07/24 OPERATOR'S WELL# ALLENDER 2H

WELL TYPE: OIL ___ GAS X LIQUID INJECTION ___ WASTE DISPOSAL ___ 47 - 085 - 10497 (IF "GAS") PRODUCTION X STORAGE ___ DEEP ___ SHALLOW X STATE COUNTY PERMIT LOCATION: ELEVATION 1,019' -AS-BUILT WATERSHED SOUTH FORK HUGHES RIVER QUADRANGLE OXFORD 7.5' DISTRICT UNION COUNTY RITCHIE SURFACE OWNER ELMER W. PIERCE ACREAGE 67.78 ACRES +/- LEASE ACREAGE 70 AC.± 06/14/2024 OIL & GAS ROYALTY OWNERR. F. KIESTER ET AL

PROPOSED WORK: DRILL ___ CONVERT ___ DRILL DEEPER ___ REDRILL ___ FRACTURE OR STIMULATE ___ PLUG OFF OLD FORMATION ___ PERFORATE NEW FORMATION ___ OTHER PHYSICAL CHANGE IN WELL (SPECIFY) AS DRILLED PLUG & ABANDON CLEAN OUT & REPLUG TARGET FORMATION MARCELLUS ESTIMATED DEPTH 6,488' TVD 20,875' MD WELL OPERATOR ANTERO RESOURCES CORP. DESIGNATED AGENT KEVIN ELLIS ADDRESS 1615 WYNKOOP ST. DENVER, CO 80202 ADDRESS 535 WHITE OAK BLVD. BRIDGEPORT, WV 26330

COUNTY NAME PERMIT