

Antero Resources Corporation
Well No. Saturn #1H

CLAY DISTRICT - RITCHIE COUNTY

18-14.2	RONALD HAYHURST
24-04	DAVID LAWRENCE
24-4.1	ROGER HART
24-05	RICHARD BLOUIR
24-5.2	FREDERICK WANSTREET
24-21	FRANKLIN OWENS
24-22	CHARLES THOMAS
24-22.1	TRIPLE B TRUCKING INC
24-23	CLARENCE MCCULLOUGH
24-23.1	CLARENCE MCCULLOUGH
24-24	KIMBERLY BARNES
24-24.1	MATTHEW BLOUIR
24-33	CHRISTOPHER LANE
24-34	CRAIG HOGUE
24-34.1	CRAIG HOGUE
24-34.2	STONEWALL PROPERTY HOLDINGS LLC
24-34.4	BARNES & SONS TRUCKING LLC
24-34.5	RODNEY HOGUE
24-35	RICHARD LAMBERT
24-35.1	RICHARD LAMBERT
24-35.3	RICHARD LAMBERT
24-36	BRUCETON FARM SERVICE INC
24-36.1	RONALD LANE INC.
24-37	RONALD LANE INC.
24-37.1	PARKS PERKINS PROPERTIES LLC
24-38	CHRISTOPHER LANE
24-40.2	PARKS PERKINS PROPERTIES LLC
24-40.3	MICHAEL HALL
24-41	HALL FAMILY TRUST
24-41.1	NEW MARTINSVILLE SUPPLY COMPANY INC.
24-45	MICHAEL HALL
24-45.1	MICHAEL HALL
24-45.2	DAVID SEESE
24-45.3	ROBERT OWENS
24-45.4	PATRICK SEESE
24-45.5	DAVID SEESE
24-46	CLINTEN GILLIS
24-46.2	DAVID SEESE
24-59	RONALD LANE INC.
29-4.1	ROBERT SHIPE
29-4.2	ROBERT SHIPE
29-4.3	ROBERT SHIPE
29-4.4	ROBERT SHIPE
29-05	THE NATURE CONSERVANCY
29-10	JOHNNIE BOSTON
29-29	MARK MOSSOR
29-30	ERICA DEEM
29-31	LORRAINE RANKIN
29-31.1	CURTIS SEESE
29-32	WILLIAM EDMINSTER
29-33	AMOS BUNNER
29-47	ROBERT KOCH
29-49	ERICA DEEM
29-50	ERICA DEEM
29-51	ERICA DEEM

NOTES:
WELL 1H TOP HOLE INFORMATION:
N: 290,263ft E: 1,569,440ft
LAT: 39°17'12.97" LON: 81°01'16.37"
BOTTOM HOLE INFORMATION:
N: 288,111ft E: 1,568,926ft
LAT: 39°16'51.61" LON: 81°01'22.43"
WEST VIRGINIA COORDINATE SYSTEM OF 1927 NORTH ZONE. MEASUREMENTS TAKEN WITH TRIMBLE 660XT SUBMETER MAPPING GRADE GPS UNIT. PLAT ORIENTATION, CORNER, AND WELL REFERENCE TIE LINES ARE BASED ON GRID NORTH.

(NAD) 83 (UTM) ZONE 17 COORDS:
WELL 1H TOP HOLE INFORMATION:
N: 4,348,628m E: 498,185m
BOTTOM HOLE INFORMATION:
N: 4,347,970m E: 498,040m

(NAD) 27 (UTM) ZONE 17 COORDS:
WELL 1H TOP HOLE INFORMATION:
N: 14,266,410ft E: 1,634,414ft
POINT OF ENTRY INFORMATION:
N: 14,264,723ft E: 1,633,775ft
BOTTOM HOLE INFORMATION:
N: 14,264,251ft E: 1,633,937ft

PAD LAYOUT

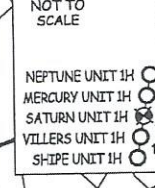

LEASES

A	WV DIVISION OF MULTIMODAL TRANSPORTATION FACILITIES
B	TOM G. STRICKLER JR. ET UX
C	KIMBERLY BARNES
T	VIRGINIAL CONNERS
U	AGNES L. ROGERS
V	F. HAYHURST FAMILY TRUST
W	AGNES L. ROGERS
X	CLARENCE J. MCCULLOUGH ET UX
Y	RICHARD BLOUIR ET AL

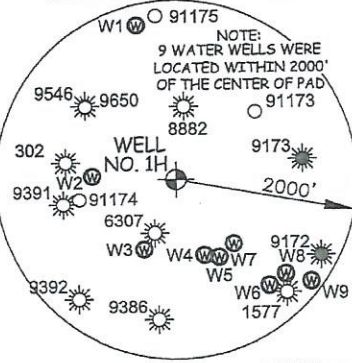

WATER WELLS

W1	S 13°36' E	1772.1'
W2	N 87°26' W	929.2'
W3	S 24°40' W	864.4'
W4	S 19°28' E	906.8'
W5	S 27°55' E	993.1'
W6	S 40°30' E	1566.5'
W7	N 40°45' W	960.8'
W8	S 48°22' E	1604.4'
W9	S 52°09' E	1872.9'

I THE UNDERSIGNED, HEREBY CERTIFY THAT THIS PLAT IS CORRECT TO THE BEST OF MY KNOWLEDGE AND BELIEF AND SHOWS ALL THE INFORMATION REQUIRED BY LAW AND THE RULES ISSUED AND PERSCRIBED BY THE DEPARTMENT OF ENVIRONMENTAL PROTECTION.



STATE OF WEST VIRGINIA, DIVISION OF ENVIRONMENTAL PROTECTION, OFFICE OF OIL AND GAS

WILLOW LAND SURVEYING PLLC
220 MASONIC AVE. PENNSBORO WEST VIRGINIA 26415

JOB # 23-010WA
DRAWING # SATURN1HSR2
SCALE 1" = 2000'
MINIMUM DEGREE OF ACCURACY SUBMETER
PROVEN SOURCE OF ELEV. SUBMETER MAPPING GRADE GPS

STATE OF WEST VIRGINIA DEPARTMENT OF ENERGY DIVISION OF OIL AND GAS

LEGEND

- Surface Owner Boundary Lines +/-
- Adjoining Surface Tracts +/-
- Found monument, as noted

THOMAS SUMMERS P.S. 2109
DATE 01/07/25
OPERATOR'S WELL# SATURN UNIT #1H
47 - 085 - 10536
STATE COUNTY PERMIT

NOTE
NO OCCUPIED DWELLINGS OR BUILDINGS TWO THOUSAND FIVE HUNDRED (2,500) SQUARE FEET OR LARGER USED TO HOUSE OR SHELTER DAIRY CATTLE OR POULTRY HUSBANDRY ARE LOCATED WITHIN SIX HUNDRED TWENTY-FIVE (625) FEET OF THE CENTER OF THE WELL PAD.

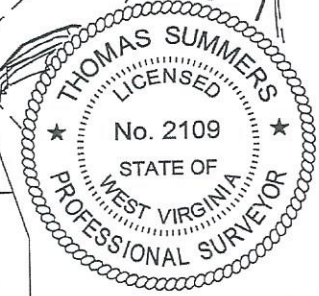

WELL TYPE: OIL GAS LIQUID INJECTION WASTE DISPOSAL (IF "GAS") PRODUCTION STORAGE DEEP SHALLOW

LOCATION: ELEVATION PROPOSED -1,007' WATERSHED NORTH FORK HUGHES RIVER
QUADRANGLE ELLENBORO 7.5' DISTRICT CLAY COUNTY RITCHIE

SURFACE OWNER RICHARD E. BLOUIR ET UX ACREAGE 53.682 ACRES +/-
OIL & GAS ROYALTY OWNER AGNES L. ROGERS LEASE ACREAGE 57 ACRES±

PROPOSED WORK: DRILL CONVERT DRILL DEEPER REDRILL
FRACTURE OR STIMULATE PLUG OFF OLD FORMATION PERFORATE NEW
FORMATION OTHER PHYSICAL CHANGE IN WELL (SPECIFY) MOD-BACKBUILD

PLUG & ABANDON CLEAN OUT & REPLUG
TARGET FORMATION MARCELLUS ESTIMATED DEPTH 7,600' TVD 10,900' MD
WELL OPERATOR ANTERO RESOURCES CORP. DESIGNATED AGENT KEVIN ELLIS
ADDRESS 1615 WYNKOOP ST. ADDRESS 535 WHITE OAKS BLVD
DENVER, CO 80202 BRIDGEPORT, WV 26330

