

LATITUDE 39°17'30"

6,007'

10,431' TO BOTTOM HOLE

LATITUDE 39°20'00"

1,739' LONGITUDE 81°00'00"

10,489' TO BOTTOM HOLE

LONGITUDE 81°00'00"

COUNTY NAME PERMIT

Antero Resources Corporation Well No. Villers Unit 1H

NOTES:
 WELL 1H TOP HOLE INFORMATION:
 N: 290,249ft E: 1,569,438ft
 LAT: 39°17'12.82" LON: 81°01'16.39"
 BOTTOM HOLE INFORMATION:
 1H TOP HOLE
 N: 296,747ft E: 1,565,121ft
 LAT: 39°18'16.32" LON: 81°02'12.70"
 WEST VIRGINIA COORDINATE SYSTEM OF 1927 NORTH ZONE. ZONE WAS DERIVED FROM MEASUREMENTS TAKEN WITH TRIMBLE GEOXT SUBMETER MAPPING GRADE GPS UNIT. PLAT ORIENTATION, CORNER, AND WELL REFERENCE TIE LINES ARE BASED ON GRID NORTH.
 (NAD) 83 (UTM) ZONE 17 COORDS:
 WELL 1H TOP HOLE INFORMATION:
 N: 4,348,623m E: 498,184m
 BOTTOM HOLE INFORMATION:
 N: 4,350,581m E: 496,836m

LEASES	
A	ROSE ALKIRE, ET AL
B1	M.B. LEASBURGE, ET UX
B2	M.B. LEASBURGE, ET UX
B3	M.B. LEASBURGE, ET UX
C	C.B. MORRIS AND S.A. SMITH IRREVOCABLE LIVING TRUST
D1	BLACK GOLD GROUP, LTD
D2	BLACK GOLD GROUP, LTD
E	FREDERICK R. HAYHURST, ET AL
F	ALFRED A. LAMBERT
G1	TOM G. STRICKLER, JR., ET UX
G2	TOM G. STRICKLER, JR., ET UX
G3	TOM G. STRICKLER, JR., ET UX
G4	TOM G. STRICKLER, JR., ET UX
G5	TOM G. STRICKLER, JR., ET UX
H1	F. ROBERT HAYHURST FAMILY TRUST
H2	F. ROBERT HAYHURST FAMILY TRUST
H3	F. ROBERT HAYHURST FAMILY TRUST
I	MICHAEL P. SHEARER & NELLIE H. SHEARER
J	WEST VIRGINIA DIVISION OF MULTIMODEL TRANSPORTATION FACILITIES
K	FRANKLIN OWENS AND ANNIE I. OWENS
L	L VIRGINIA L. CONNORS
M	AGNES L. ROGERS
N	AGNES L. ROGERS
P	CLARENCE J. MCCULLOUGH, ET UX
O	F. ROBERT HAYHURST FAMILY TRUST
Q	CLARENCE J. MCCULLOUGH, ET UX
R	TOM G. STRICKLER, JR., ET UX
S	RICHARD BLOUIR, ET AL
T	KIMBERLY BARNES
U	NANCY LOUISE VAUGHN

(NAD) 27 (UTM) ZONE 17 COORDS:
 WELL 1H TOP HOLE INFORMATION:
 N: 14,266,396ft E: 1,634,412ft
 POINT OF ENTRY INFORMATION:
 N: 14,263,920ft E: 1,632,104ft
 BOTTOM HOLE INFORMATION:
 N: 14,272,819ft E: 1,629,990ft

NOTE
 NO OCCUPIED DWELLINGS OR BUILDINGS TWO THOUSAND FIVE HUNDRED (2,500) SQUARE FEET OR LARGER USED TO HOUSE OR SHELTER DAIRY CATTLE OR POULTRY HUSBANDRY ARE LOCATED WITHIN SIX HUNDRED TWENTY-FIVE (625) FEET OF THE CENTER OF THE WELL PAD.

CLAY DISTRICT - RITCHIE COUNTY	
11-42.1	JUDITH PACKMAN
18-04	DAVID VILLERS
18-4.1	DAVID VILLERS
18-4.2	ALFRED LAMBERT
18-4.3	DAVID VILLERS
18-4.4	WESLEY EZELL
18-4.5	LEANDRA PARSONS
18-4.6	LEANDRA PARSONS
18-06	DANIEL MARTIN
18-12	ALFRED LAMBERT
18-12.1	ALFRED LAMBERT
18-12.2	NAOMI FREDERKEIL
18-14	RONALD HAYHURST
18-17	DELNO HAYHURST
18-17.1	CAROL SPANGLER
18-18	THOMAS SUMMERS
18-20.2	MICHAEL REED
18-20.3	REGINA WAAS
24-02	KEVIN MINOR
24-03	M P CHURCH HUSHERS RUN
24-3.1	HUSHERS RUN U.M. CHURCH
24-04	DAVID LAWRENCE
24-4.1	ROGER HART
24-05	RICHARD BLOUIR
24-5.2	FREDERICK WANSTREET
24-21	FRANKLIN OWENS
24-22	CHARLES THOMAS
24-22.1	TRIPLE B TRUCKING INC
24-23	CLARENCE MCCULLOUGH
24-23.1	CLARENCE MCCULLOUGH
24-24.1	MATTHEW BLOUIR

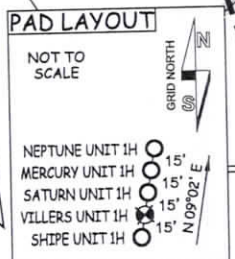
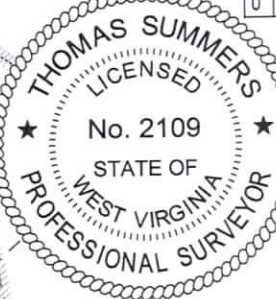

WATER WELLS		
W1	S 13°36' E	1772.1'
W2	N 87°26' W	929.2'
W3	S 24°40' W	864.4'
W4	S 19°28' E	906.8'
W5	S 27°55' E	993.1'
W6	S 40°30' E	1566.5'
W7	N 40°45' W	960.8'
W8	S 48°22' E	1604.4'
W9	S 52°09' E	1872.9'

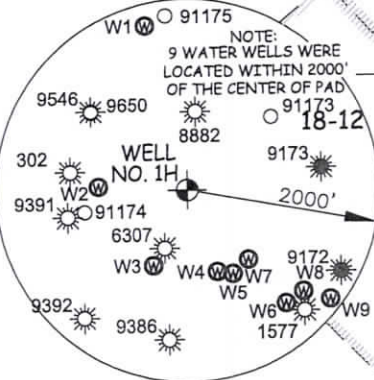

JOB # 23-010WA
 DRAWING # VILLERS1HR2
 SCALE 1" = 1000'
 MINIMUM DEGREE OF ACCURACY SUBMETER
 PROVEN SOURCE OF ELEV. SUBMETER MAPPING GRADE GPS
 STATE OF WEST VIRGINIA DEPARTMENT OF ENERGY DIVISION OF OIL AND GAS

THOMAS SUMMERS P.S. 2109
 DATE 01/07/25
 OPERATOR'S WELL# VILLERS UNIT #1H
 API WELL # 47 - 085 - 10538
 STATE COUNTY PERMIT

I THE UNDERSIGNED, HEREBY CERTIFY THAT THIS PLAT IS CORRECT TO THE BEST OF MY KNOWLEDGE AND BELIEF AND SHOWS ALL THE INFORMATION REQUIRED BY LAW AND THE RULES ISSUED AND PERSCRIBED BY THE DEPARTMENT OF ENVIRONMENTAL PROTECTION.



STATE OF WEST VIRGINIA, DIVISION OF ENVIRONMENTAL PROTECTION, OFFICE OF OIL AND GAS
 WILLOW LAND SURVEYING PLLC
 220 MASONIC AVENUE PENNSBORO WEST VIRGINIA 26415

WELL TYPE: OIL GAS X LIQUID INJECTION WASTE DISPOSAL
 (IF "GAS") PRODUCTION X STORAGE DEEP SHALLOW X
 LOCATION: ELEVATION PROPOSED - 1,007' WATERSHED NORTH FORK HUGHES RIVER
 QUADRANGLE ELLENBORO 7.5' DISTRICT CLAY COUNTY RITCHIE
 SURFACE OWNER RICHARD E. BLOUIR ET UX ACREAGE 53.682 ACRES +/-
 OIL & GAS ROYALTY OWNER AGNES L. ROGERS LEASE ACREAGE 57 ACRES +/-
 PROPOSED WORK: DRILL CONVERT DRILL DEEPER X REDRILL FRACTURE OR STIMULATE X
 PLUG OFF OLD FORMATION PERFORATE NEW FORMATION X OTHER PHYSICAL CHANGE IN WELL (SPECIFY) MOD-BACKBUILD PLUG & ABANDON CLEAN OUT & REPLUG
 TARGET FORMATION MARCELLUS ESTIMATED DEPTH 7,600' TVD 21,100' MD
 WELL OPERATOR ANTERO RESOURCES CORPORATION DESIGNATED AGENT KEVIN ELLIS
 ADDRESS 1615 WYNKOOP STREET ADDRESS 535 WHITE OAKS BLVD
 FORM WW-6 DENVER, CO 80202 BRIDGEPORT, WV 26330

