

LATITUDE 39°17'30"

6,007'

LATITUDE 39°20'00"

10,428' TO BOTTOM HOLE

1,738'

10,498' TO BOTTOM HOLE

LONGITUDE 81°00'00"

COUNTY NAME PERMIT

Antero Resources Corporation
Well No. Villers Unit 1H

AS DRILLED DATA:
WELL 1H TOP HOLE INFORMATION:
N: 290,249ft E: 1,569,438ft
LAT: 39°17'12.83" LON: 81°01'16.39"
BOTTOM HOLE INFORMATION:
1H TOP HOLE
N: 296,739ft E: 1,565,124ft
LAT: 39°18'16.24" LON: 81°02'12.67"
WEST VIRGINIA COORDINATE SYSTEM OF 1927 NORTH ZONE.
ZONE WAS DERIVED FROM MEASUREMENTS TAKEN WITH TRIMBLE GEOXT SUBMETER MAPPING GRADE GPS UNIT. PLAT ORIENTATION, CORNER, AND WELL REFERENCE TIE LINES ARE BASED ON GRID NORTH.

(NAD) 83 (UTM) ZONE 17 COORDS:
WELL 1H TOP HOLE INFORMATION:
N: 4,348,623m E: 498,184m
BOTTOM HOLE INFORMATION:
N: 4,350,579m E: 496,837m

(NAD) 27 (UTM) ZONE 17 COORDS:
WELL 1H TOP HOLE INFORMATION:
N: 14,266,396ft E: 1,634,412ft
POINT OF ENTRY INFORMATION:
N: 14,263,913ft E: 1,633,102ft
BOTTOM HOLE INFORMATION:
N: 14,272,810ft E: 1,629,992ft

LEASES	
A	ROSE ALKIRE, ET AL
B1	M.B. LEASBURGE, ET UX
B2	M.B. LEASBURGE, ET UX
B3	M.B. LEASBURGE, ET UX
C	C.B. MORRIS AND S.A. SMITH IRREVOCABLE LIVING TRUST
D1	BLACK GOLD GROUP, LTD
D2	BLACK GOLD GROUP, LTD
E	FREDERICK R. HAYHURST, ET AL
F	ALFRED A. LAMBERT
G1	TOM G. STRICKLER, JR., ET UX
G2	TOM G. STRICKLER, JR., ET UX
G3	TOM G. STRICKLER, JR., ET UX
G4	TOM G. STRICKLER, JR., ET UX
G5	TOM G. STRICKLER, JR., ET UX
H1	F. ROBERT HAYHURST FAMILY TRUST
H2	F. ROBERT HAYHURST FAMILY TRUST
H3	F. ROBERT HAYHURST FAMILY TRUST
I	MICHAEL P. SHEARER & NELLIE H. SHEARER
J	WEST VIRGINIA DIVISION OF MULTIMODEL TRANSPORTATION FACILITIES
K	FRANKLIN OWENS AND ANNIE I. OWENS
L	VIRGINIA L. CONNORS
M	AGNES L. ROGERS
N	AGNES L. ROGERS
P	CLARENCE J. MCCULLOUGH, ET UX
Q	F. ROBERT HAYHURST FAMILY TRUST
O	CLARENCE J. MCCULLOUGH, ET UX
R	TOM G. STRICKLER, JR., ET UX
S	RICHARD BLOUIR, ET AL
T	KIMBERLY BARNES
U	NANCY LOUISE VAUGHN

CLAY DISTRICT - RITCHIE COUNTY	
11-42.1	JUDITH PACKMAN
18-04	DAVID VILLERS
18-4.1	DAVID VILLERS
18-4.2	ALFRED LAMBERT
18-4.3	DAVID VILLERS
18-4.4	WESLEY EZELL
18-4.5	LEANDRA PARSONS
18-4.6	LEANDRA PARSONS
18-06	DANIEL MARTIN
18-12	ALFRED LAMBERT
18-12.1	ALFRED LAMBERT
18-12.2	NAOMI FREDERKEIL
18-14	RONALD HAYHURST
18-17	DELNO HAYHURST
18-17.1	CAROL SPANGLER
18-18	THOMAS SUMMERS
18-20.2	MICHAEL REED
18-20.3	REGINA WAAS
24-02	KEVIN MINOR
24-03	M P CHURCH HUSHERS RUN
24-3.1	HUSHERS RUN U.M. CHURCH
24-04	DAVID LAWRENCE
24-4.1	ROGER HART
24-05	RICHARD BLOUIR
24-5.2	FREDERICK WANSTREET
24-21	FRANKLIN OWENS
24-22	CHARLES THOMAS
24-22.1	TRIPLE B TRUCKING INC
24-23	CLARENCE MCCULLOUGH
24-23.1	CLARENCE MCCULLOUGH
24-24.1	MATTHEW BLOUIR

WV NORTH ZONE GRID NORTH

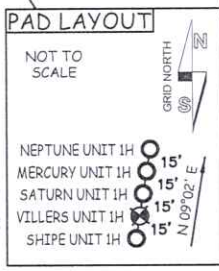

WATER WELLS		
W1	S 13°36' E	1772.1'
W2	N 87°26' W	929.2'
W3	S 24°40' W	864.4'
W4	S 19°28' E	906.8'
W5	S 27°55' E	993.1'
W6	S 40°30' E	1566.5'
W7	N 40°45' W	960.8'
W8	S 48°22' E	1604.4'
W9	S 52°09' E	1872.9'

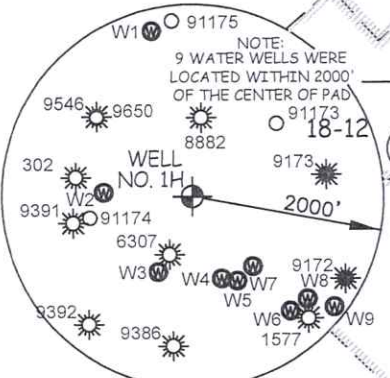

JOB # 23-010WA
DRAWING # VILLERS1HAD
SCALE 1" = 1000'
MINIMUM DEGREE OF ACCURACY SUBMETER
PROVEN SOURCE OF ELEV. SUBMETER MAPPING GRADE GPS

STATE OF WEST VIRGINIA
DEPARTMENT OF ENERGY
DIVISION OF OIL AND GAS

THOMAS SUMMERS P.S. 2109
DATE 11/12/25
OPERATOR'S WELL# VILLERS UNIT #1H
API WELL # 47 - 085 - 10538
STATE COUNTY PERMIT

I THE UNDERSIGNED, HEREBY CERTIFY THAT THIS PLAT IS CORRECT TO THE BEST OF MY KNOWLEDGE AND BELIEF AND SHOWS ALL THE INFORMATION REQUIRED BY LAW AND THE RULES ISSUED AND PERSCRIBED BY THE DEPARTMENT OF ENVIRONMENTAL PROTECTION.

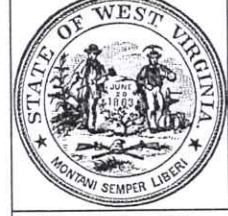

STATE OF WEST VIRGINIA, DIVISION OF ENVIRONMENTAL PROTECTION, OFFICE OF OIL AND GAS
WILLOW LAND SURVEYING PLLC
220 MASONIC AVENUE PENNSBORO WEST VIRGINIA 26415

WELL TYPE: OIL GAS X LIQUID INJECTION WASTE DISPOSAL
(IF "GAS") PRODUCTION X STORAGE DEEP SHALLOW X
LOCATION: ELEVATION AS BUILT - 1,007' WATERSHED NORTH FORK HUGHES RIVER
QUADRANGLE ELLENBORO 7.5' DISTRICT CLAY COUNTY RITCHIE
SURFACE OWNER RICHARD E. BLOUIR ET UX ACREAGE 53.682 ACRES +/-
OIL & GAS ROYALTY OWNER AGNES L. ROGERS LEASE ACREAGE 57 ACRES +/-
PROPOSED WORK: DRILL CONVERT DRILL DEEPER REDRILL FRACTURE OR STIMULATE
PLUG OFF OLD FORMATION PERFORATE NEW FORMATION OTHER PHYSICAL CHANGE IN WELL
(SPECIFY) AS DRILLED PLUG & ABANDON CLEAN OUT & REPLUG
TARGET FORMATION MARCELLUS ESTIMATED DEPTH 6,182' TVD 16,622' MD
WELL OPERATOR ANTERO RESOURCES CORPORATION DESIGNATED AGENT CONRAD BASTON
ADDRESS 1615 WYNKOOP STREET ADDRESS 535 WHITE OAKS BLVD
FORM WW-6 DENVER, CO 80202 BRIDGEPORT, WV 26330

LEGEND
--- Surface Owner Boundary Lines +/-
--- Interior Surface Tracts +/-
○ Proposed Well Path
● As Drilled Information

NOTE
1. NO OCCUPIED DWELLINGS OR BUILDINGS TWO THOUSAND FIVE HUNDRED (2,500) SQUARE FEET OR LARGER USED TO HOUSE OR SHELTER DAIRY CATTLE OR POULTRY HUSBANDRY ARE LOCATED WITHIN SIX HUNDRED TWENTY-FIVE (625) FEET OF THE CENTER OF THE WELL PAD.
2. TOP HOLE DATA SHOWN HEREON WAS PROVIDED BY ANTERO RESOURCES CORPORATION.
3. AS DRILLED DATA WAS PROVIDED BY ANTERO RESOURCES CORPORATION.
4. WLS IS NOT CERTIFYING THE DATA AND INFORMATION PROVIDED LISTED IN NOTES 2 AND 3, ONLY THE RELATIONSHIP TO THE DATA AND INFORMATION PROVIDED TO THE LEASE BOUNDARIES.
5. WLS IS BY NO MEANS RESPONSIBLE FOR ANY ERRORS OR INACCURACIES WITH THE DATA AND INFORMATION THAT HAS BEEN PROVIDED.

03/13/2026