



**Antero Resources Corporation**

Appalachian Basin

Minear Pad

Ritchie County

Quadrangle: Pullman  
Watershed: South Fork Hughes River  
District: Union  
Date: 10-24-2023

RECEIVED  
Office of Oil and Gas  
FEB 10 2024  
WV Department of  
Environmental Protection

03/14/2025



LATITUDE 39°12'30"

11,799'

10,359' TO BOTTOM HOLE  
LATITUDE 39°12'30"

3,260'

2,282' TO BOTTOM HOLE

LONGITUDE 80°55'00"

LONGITUDE 80°55'00"

### Antero Resources Corporation Well No. Keel #1H

UNION DISTRICT - RITCHIE COUNTY	
7-13	Dawn McLaughlin
7-14	Wayne & Delphine Haddox
7-15	Louis Daniel Easterday Revocable Living Trust
7-16	Louis D Easterday
7-18	Louis D Easterday
7-19	Max & Laura Dodd
8-1	Danny Haddox Et Al
8-11	Danny Haddox Et Al
8-12	Danny Haddox Et Al
8-13	Wayne & Delphine Haddox
8-14	David Haddox
8-16	David Haddox
12-2	Phillip & Sharon Estep
12-2.1	Haight Farm LLC
12-2.2	Donald J. Ensminger, III
12-6	Robert & Dorothy Layton
12-6.1	Robert & Dorothy Layton
12-7	Louis Daniel Easterday Revocable Living Trust
12-7.1	Louis Daniel Easterday Revocable Living Trust
12-12	Anthony & Steven Riddle
12-13	Clay Mossor & Victoria McGinnis
13-1	David & Rose Cox
13-1.1	David & Rose Cox
CLAY DISTRICT - RITCHIE COUNTY	
39-17.4	Andrew Fulest & Kain Grimm
40-15	Wayne & Delphine Haddox
40-15.3	Earl H Riggs Sr.
40-17	Buane Riggs

**NOTES:**  
**WELL 1H TOP HOLE INFORMATION:**  
 N: 258,084ft E: 1,586,727ft  
 LAT: 39°11'57.78" LON: 80°57'29.88"  
**BOTTOM HOLE INFORMATION:**  
 N: 259,038ft E: 1,588,182ft  
 LAT: 39°12'07.44" LON: 80°57'11.60"  
 WEST VIRGINIA COORDINATE SYSTEM OF 1927 NORTH ZONE WAS DERIVED FROM MEASUREMENTS TAKEN WITH TRIMBLE GEOXT SUBMETER MAPPING GRADE GPS UNIT. PLAT ORIENTATION, CORNER, AND WELL REFERENCE TIE LINES ARE BASED ON GRID NORTH.  
**(NAD) 83 (UTM) ZONE 17 COORDS:**  
**WELL 1H TOP HOLE INFORMATION:**  
 N: 4,338,913m E: 503,615m  
**BOTTOM HOLE INFORMATION:**  
 N: 4,339,211m E: 504,054m  
**(NAD) 27 (UTM) ZONE 17 COORDS:**  
**WELL 1H TOP HOLE INFORMATION:**  
 N: 14,234,536ft E: 1,652,230ft  
**POINT OF ENTRY INFORMATION:**  
 N: 14,235,162ft E: 1,653,790ft  
**BOTTOM HOLE INFORMATION:**  
 N: 14,235,514ft E: 1,653,668ft

WV NORTH ZONE  
GRID NORTH

1H TOP HOLE  
1H BOTTOM HOLE

LEASES	
U	NORMA C. DAWSON
W	DANIEL HADDOX AND CLARETH HADDOX
X	JAMES M. HOWARD
Y	JOYCE ANN HOWARD
Z	JOSEPH A. HOWARD
AA	KENNETH B. PERINE AND PATRICIA PERINE

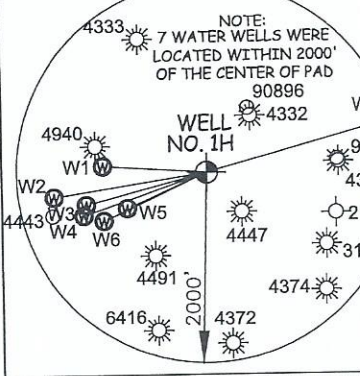

WELL	S	E	FEET
W1	S 86°08' E	1093.5'	
W2	S 81°22' W	1624.9'	
W3	S 75°32' W	1309.4'	
W4	S 71°11' W	1368.5'	
W5	S 66°20' W	914.7'	
W6	S 65°21' W	1193.6'	
W7	N 74°39' E	1936.7'	

I THE UNDERSIGNED, HEREBY CERTIFY THAT THIS PLAT IS CORRECT TO THE BEST OF MY KNOWLEDGE AND BELIEF AND SHOWS ALL THE INFORMATION REQUIRED BY LAW AND THE RULES ISSUED AND PERSCRIBED BY THE DEPARTMENT OF ENVIRONMENTAL PROTECTION.



STATE OF WEST VIRGINIA, DIVISION OF ENVIRONMENTAL PROTECTION, OFFICE OF OIL AND GAS

WILLOW LAND SURVEYING PLLC  
220 MASONIC AVE. PENNSBORO  
WEST VIRGINIA 26415

JOB # 24-011WA  
 DRAWING # KEEL1HS  
 SCALE 1" = 2000'  
 MINIMUM DEGREE OF ACCURACY SUBMETER  
 PROVEN SOURCE OF ELEV. SUBMETER MAPPING GRADE GPS

**LEGEND**  
 — Surface Owner Boundary Lines +/-  
 - - - Adjoining Surface Tracts +/-  
 ⊕ Found monument, as noted

*Thomas Summers*  
 THOMAS SUMMERS P.S. 2109  
 DATE 02/05/25  
 OPERATOR'S WELL# KEEL UNIT #1H  
 47 — 085 — 10553  
 STATE COUNTY PERMIT

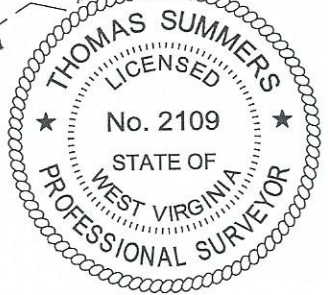
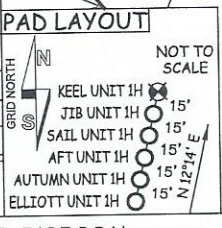

WELL TYPE: OIL \_\_\_ GAS X LIQUID INJECTION \_\_\_ WASTE DISPOSAL  
 (IF "GAS") PRODUCTION X STORAGE \_\_\_ DEEP \_\_\_ SHALLOW  
 LOCATION: ELEVATION PROPOSED -1,097' EXISTING -1,111' WATERSHED SOUTH FORK HUGHES RIVER  
 QUADRANGLE PULLMAN 7.5' DISTRICT UNION COUNTY RITCHIE  
 SURFACE OWNER LOUIS DANIEL EASTERDAY REVOCABLE LIVING TRUST ACREAGE 5.25 ACRES +/-  
 OIL & GAS ROYALTY OWNER JOSEPH A. HOWARD LEASE ACREAGE 5.25 ACRES±  
 PROPOSED WORK: DRILL X CONVERT \_\_\_ DRILL DEEPER \_\_\_ REDRILL \_\_\_  
 FRACTURE OR STIMULATE X PLUG OFF OLD FORMATION \_\_\_ PERFORATE NEW  
 FORMATION \_\_\_ OTHER PHYSICAL CHANGE IN WELL (SPECIFY) \_\_\_  
 PLUG & ABANDON \_\_\_ CLEAN OUT & REPLUG \_\_\_  
 TARGET FORMATION MARCELLUS ESTIMATED DEPTH 6,800' TVD 9,900' MD  
 WELL OPERATOR ANTERO RESOURCES CORP. DESIGNATED AGENT KEVIN ELLIS  
 ADDRESS 1615 WYNKOOP ST. ADDRESS 535 WHITE OAKS BLVD  
DENVER, CO 80202 BRIDGEPORT, WV 26330

