

LATITUDE 39° 25'

SJM 1/12/93 80°
LONGITUDE 81° 55'

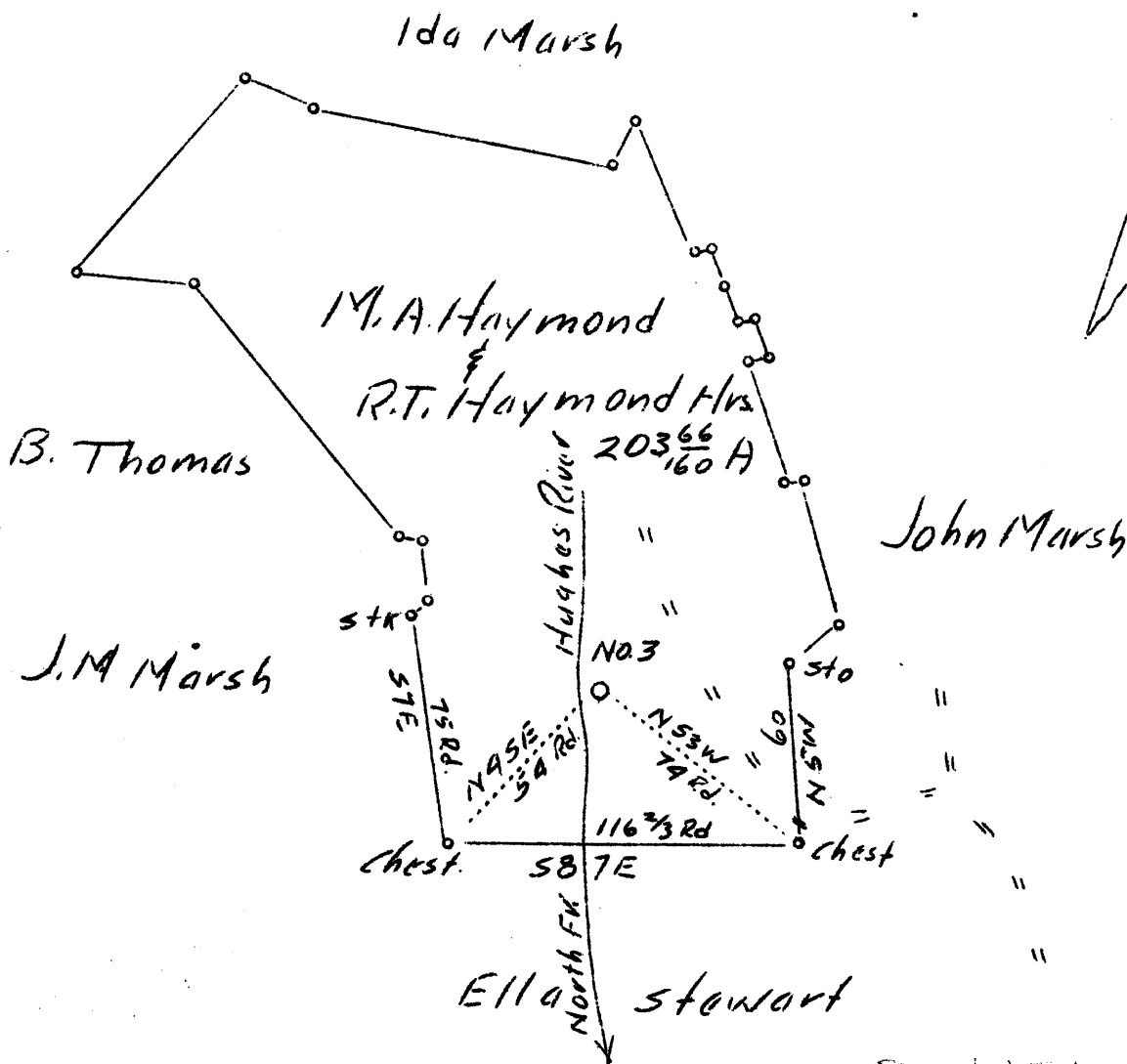

Abandonment

0.15 W
3.4

Company	Consumers Gas Utilities Co.
Address	Pennsboro, W.Va.
Farm	M.A. Haymond & R.I. Haymond Hrs.
Tract	Acres 203.66 Lease No.
Well (Farm) No.	3 Serial No.
Elevation (Spirit Level)	903-1/2
Quadrangle	West Union WC
County	Ritchie District Clay
Engineer	J.V. Dunbar
Engineer's Registration No.	65
File No.	C-23 L Drawing No.
Date	June 17, 1937 Scale 1"-60 Rods

STATE OF WEST VIRGINIA
Department of Mines
OIL AND GAS DIVISION
CHARLESTON

WELL LOCATION MAP
File No. RIT-314A

+ Denotes location of well on United States Topographic Maps; scale 1 to 62,500, latitude and longitude lines being represented by border lines as shown.

- Denotes one inch spaces on border line of original tracing.

RESEARCH TROOPERS
JUN 8 0 1937
U.S. DEPARTMENT OF JUSTICE