

Latitude 39° 05'

Longitude 81° 00'

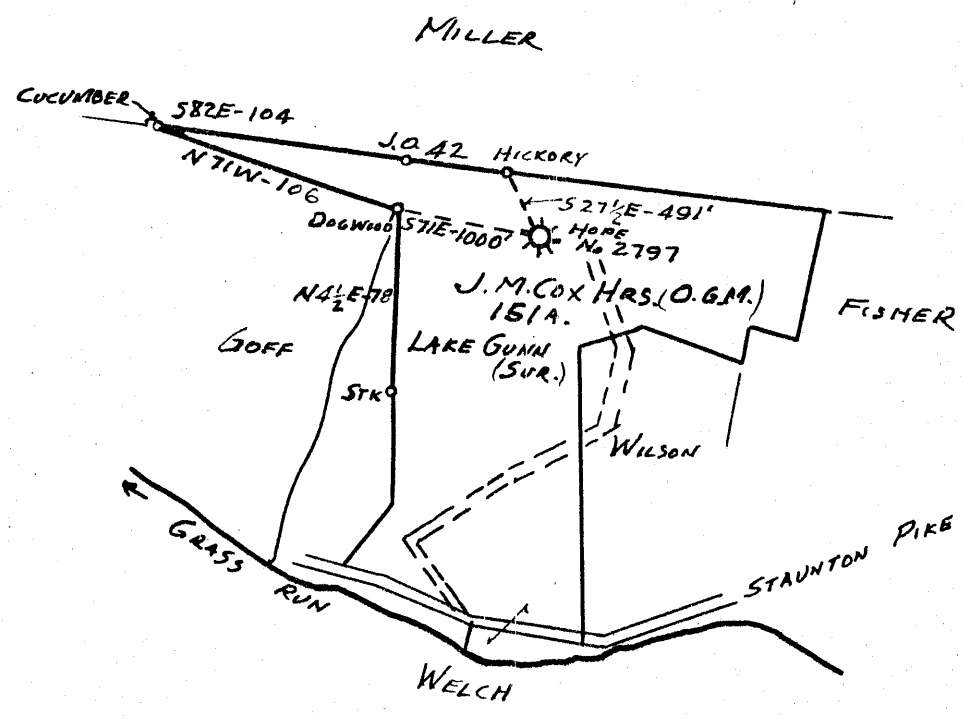

New Location...
 Drill Deeper...
 Abandonment...

JUL 27 1958

0.15 / W
 1.8 D

Company GLEN W. ROBERTS
 Address ELIZABETH, WEST VA.
 Farm J.M. COX HRS. (O.G.M.) LAKE GUNN (SUR.)
 Tract 151 Acres _____ Lease No. _____
 Well (Farm) No. _____ Serial No. 2797 HOPE GAS CO.
 Elevation (Spirit Level) 975'
 Quadrangle HARRISVILLE
 County RITCHIE District MURPHY
 Engineer Glen W. Roberts
 Engineer's Registration No. 860
 File No. _____ Drawing No. _____
 Date 7-26-58 Scale 1 IN = 80 POLES

STATE OF WEST VIRGINIA
 DEPARTMENT OF MINES
 OIL AND GAS DIVISION
 CHARLESTON

WELL LOCATION MAP
 FILE NO. RIT-1278-A

+ Denotes location of well on United States Topographic Maps, scale 1 to 62,500, latitude and longitude lines being represented by border lines as shown.

- Denotes one inch spaces on border line of original tracing.

"IMPERIAL" TRACING CLOTH

J.M. COX HRS. (LAKE GUNN) No. 2797 (Hope No.) - GLEN W. ROBERTS - RIT-1278-A



1126

STATE OF WEST VIRGINIA
DEPARTMENT OF MINES
OIL AND GAS DIVISION

Quadrangle Harrisonville
Permit No. Rit-1278-A

WELL RECORD

Oil or Gas Well _____
(KIND)

Company Glen W. Roberts
Address Elizabeth, W. Va.
Farm Lake Gunn Acres 151
Location (waters) _____
Well No. Hope Nat. Gas Co. #2797 Elev. 975
District Murphy County Ritchie
The surface of tract is owned in fee by Lake Gunn
Address Burnthouse, W. Va.
Mineral rights are owned by J. M. Cox Heirs
Address Eva, W. Va.

Casing and Tubing	Used in Drilling	Left in Well	Packers
Size			Kind of Packer
16			
13			
10	14 3/4"		Size of
8 3/4	1058'	1058'	
6 5/8	1901' 5"	1901' 5"	Depth set
5 3/16			
3			Perf. top
2		1992' 7"	Perf. bottom
Liners Used			Perf. top
			Perf. bottom

Drilling commenced Oct. 20, 1912
Drilling completed Nov. 28, 1912
Date Shot _____ From _____ To _____
With _____
Open Flow _____ /10ths Water in _____ Inch
_____ /10ths Merc. in _____ Inch
Volume _____ Cu. Ft.
Rock Pressure _____ lbs. _____ hrs.
Oil _____ bbls., 1st 24 hrs.
WELL ACIDIZED _____
WELL FRACTURED _____

CASING CEMENTED _____ SIZE _____ No. Ft. _____ Date _____

COAL WAS ENCOUNTERED AT _____ FEET _____ INCHES
_____ FEET _____ INCHES _____ FEET _____ INCHES
_____ FEET _____ INCHES _____ FEET _____ INCHES

RESULT AFTER TREATMENT _____
ROCK PRESSURE AFTER TREATMENT _____
Fresh Water _____ Feet _____ Salt Water _____ Feet _____

Formation	Color	Hard or Soft	Top	Bottom	Oil, Gas or Water	Depth	Remarks
Dunkard Sand			860	1128			
Salt Sand			1448	1700	Oil	1651	
Maxon Sand			1732	1767	Oil and Gas	1763-1767	
Injun Sand			1928		Gas Gas	1928 1931	
				1990 TD			



DEC 20 1958

Formation	Color	Hard or Soft	Top	Bottom	Oil, Gas or Water	Depth Found	Remarks

Date 6/26, 1958
APPROVED Glen W Roberts, Owner
By _____ (Title)