

1.68 Mi. S.
1.45 Mi. W.

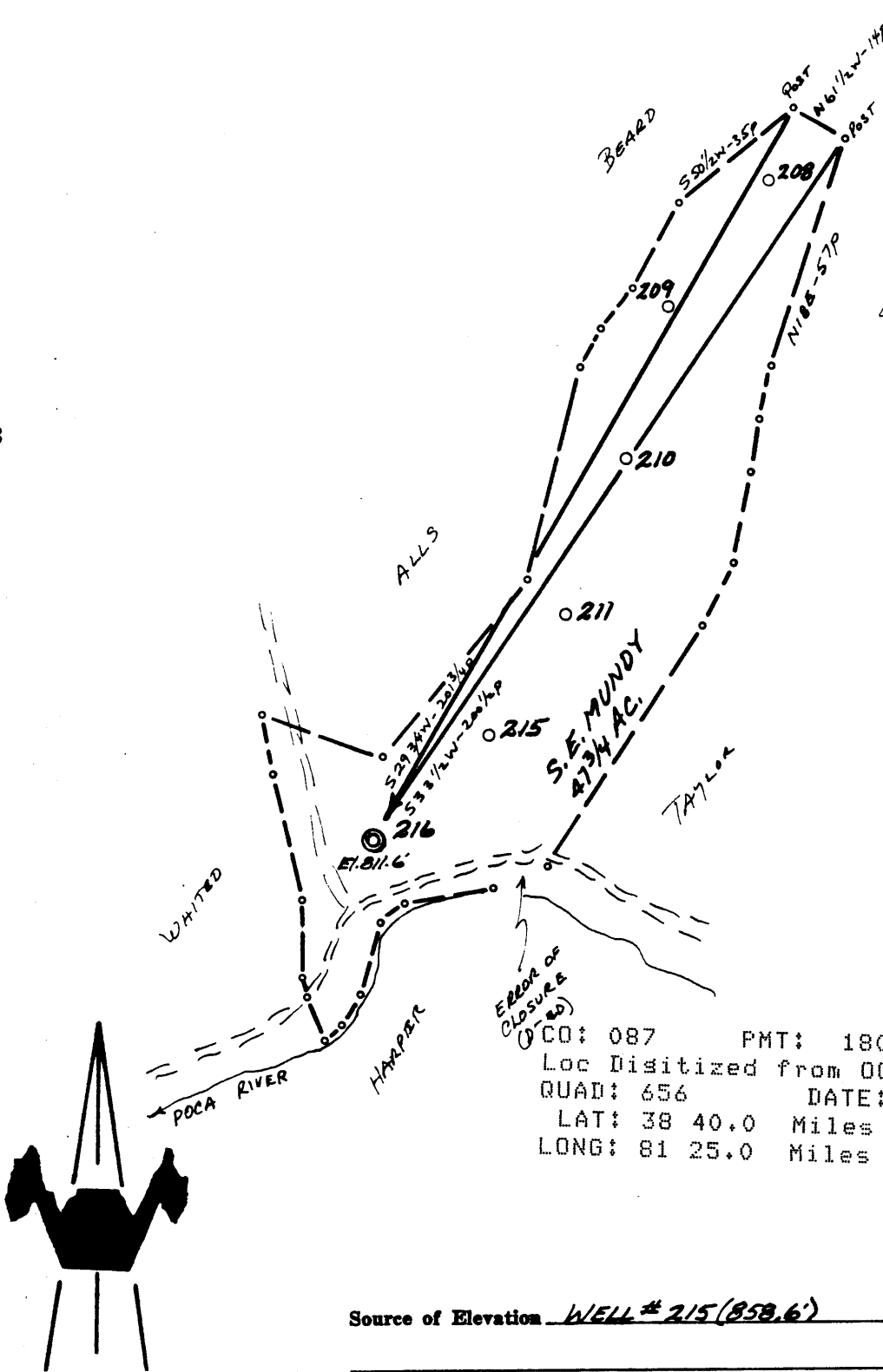

CC: 087 PMT: 1801
Loc Digitized from OGIS 7.5' Mylar
QUAD: 656 DATE: 12-JUN-90
LAT: 38 40.0 Miles South: 1.80
LONG: 81 25.0 Miles West : 1.47

ACCURACY: 1P/200P

Source of Elevation WELL # 215 (858.6')

I, the undersigned, hereby certify that this map is correct to the best of my knowledge and belief and shows all the information required by paragraph 6 of the rules and regulations of the oil and gas section of the mining laws of West Virginia.

- New Location
- Drill Deeper
- Abandonment
- Fracture
- Redrill

Chet Waterman

Company Bow Valley Petroleum
 Address Box 235, Culloden, W.V. 26510
 Farm S.E. MUNDY
 Tract Acres 47 3/4 Lease No. _____
 Well (Farm) No. _____ Serial No. ROA-216
 Elevation (Spirit Level) 811.6'
 Quadrangle WALTON
 County ROANE District HARPER
 Engineer CHET WATERMAN
 Engineer's Registration No. 3788
 File No. 69003-197 Drawing No. _____
 Date 6/2/69 Scale 1" = 400'

STATE OF WEST VIRGINIA
DEPARTMENT OF MINES
OIL AND GAS DIVISION
CHARLESTON

WELL LOCATION MAP
FILE NO. ROA-1801-P

+ Denotes location of well on United States Topographic Maps, scale 1 to 62,500, latitude and longitude lines being represented by border lines as shown.

— Denotes one inch spaces on border line of original tracing.

APR 2 1984

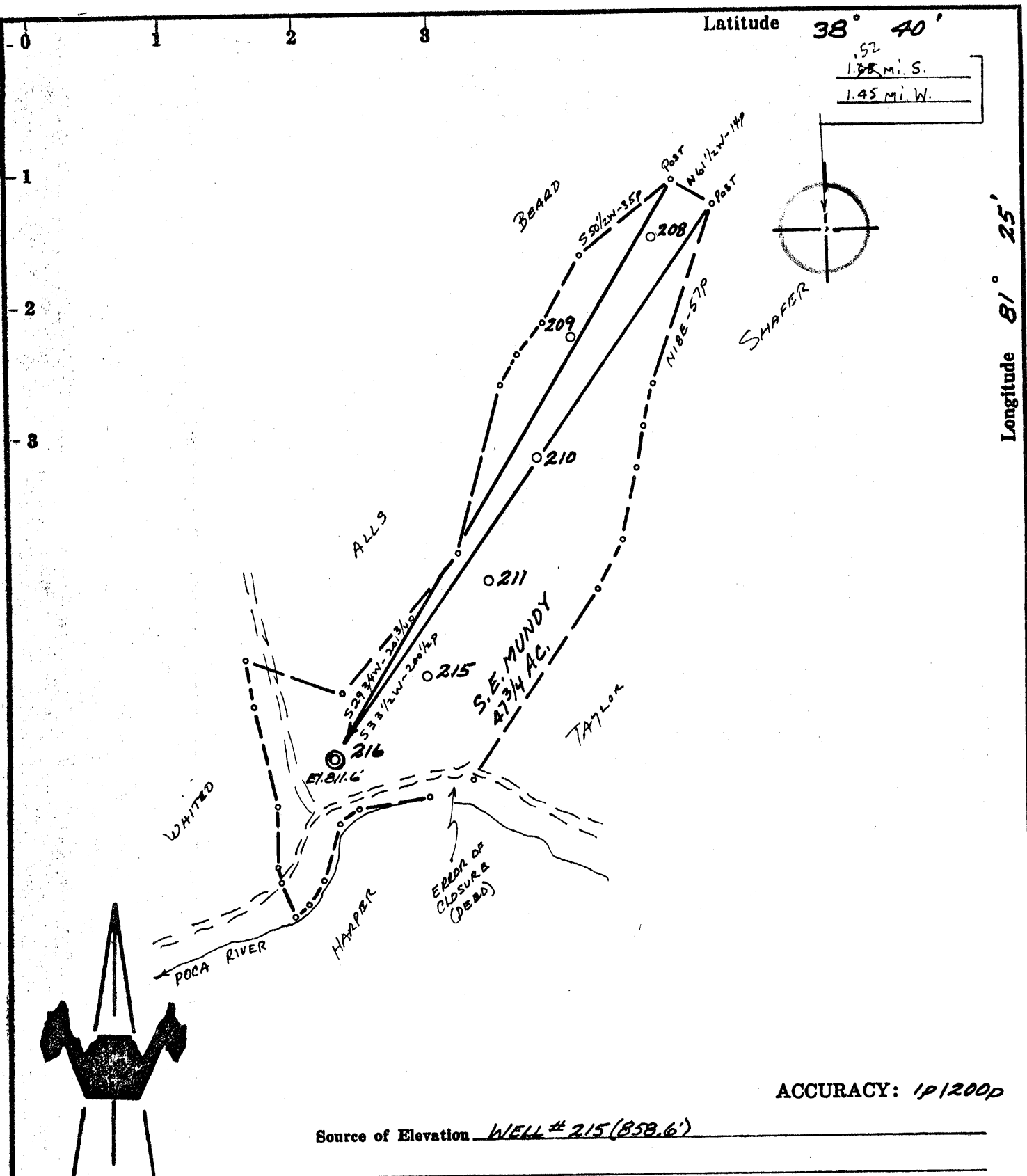

ACCURACY: 1/1200P

Source of Elevation WELL # 215 (858.6')

I, the undersigned, hereby certify that this map is correct to the best of my knowledge and belief and shows all the information required by paragraph 6 of the rules and regulations of the oil and gas section of the mining laws of West Virginia.

Chet Waterman

Company Ray Brothers Corp.
DEV-MARK DRILLING, INC.
 Address 630 Commerce Square, Charleston, W. Va. 25301
SPENCER, W. VA.
 Farm S. E. MUNDY
 Tract Acres 47 3/4 Lease No. _____
 Well (Farm) No. _____ Serial No. ROA-216
 Elevation (Spirit Level) 811.6'
 Quadrangle WALTON W.D.
 County ROANE District HARPER
 Engineer CHET WATERMAN
 Engineer's Registration No. 3788
 File No. 69003-127 Drawing No. _____
 Date 6/2/69 Scale 1" = 400'

STATE OF WEST VIRGINIA
DEPARTMENT OF MINES
OIL AND GAS DIVISION
CHARLESTON

WELL LOCATION MAP
FILE NO. ROA-1801

+ Denotes location of well on United States Topographic Maps, scale 1 to 62,500, latitude and longitude lines being represented by border lines as shown.

— Denotes one inch spaces on border line of original tracing.

4-24



STATE OF WEST VIRGINIA
DEPARTMENT OF MINES
OIL AND GAS WELLS DIVISION

Rotary
Spudder
Cable Tools
Storage E. NOLL

Quadrangle Walton

WELL RECORD

Oil or Gas Well Oil (KIND)

Permit No. ROA 1801

Company	Address	Farm	Location (waters)	Well No.	District	County	Elev.	Casing and Tubing Size	Used in Drilling	Left in Well	Packers
<u>Ray Brothers Corp.</u>	<u>630 Commerce Sq. Charleston, W. Va.</u>	<u>S. E. Mundy</u>	<u>Poca River</u>	<u>ROA 216</u>	<u>Harper</u>	<u>Roane</u>	<u>811.6</u>	<u>8 5/8</u>		<u>130'</u>	
The surface of tract is owned in fee by _____								<u>6 5/8</u>			Kind of Packer _____
Mineral rights are owned by <u>Geary B. Ray, et al</u>								<u>5 3/16</u>		<u>1994'</u>	Size of _____
Address <u>Walton, W. Va.</u>								<u>4 1/2</u>			Depth set _____
Drilling commenced <u>12-2-69</u>								<u>3</u>		<u>17 holes</u>	Perf. top <u>1906'</u>
Drilling completed <u>12-6-69</u>								<u>2</u>			Perf. bottom <u>1930'</u>
Date Shot _____ From _____ To _____											Perf. top _____
With _____											Perf. bottom _____

Attach copy of cementing record.
 CASING CEMENTED 4 1/2" SIZE 1994' No. Ft. _____ Date _____
 Amount of cement used (bags) 125 sks.
 Name of Service Co. Well Service, Inc.
 COAL WAS ENCOUNTERED AT _____ FEET _____ INCHES
 _____ FEET _____ INCHES FEET _____ INCHES
 _____ FEET _____ INCHES FEET _____ INCHES

WELL FRACTURED (DETAILS) 300 Gals. acid, 30,000 #20/40 sand, 750 Bbls. water
15 oil & 115 water
 RESULT AFTER TREATMENT (Initial open Flow or bbls.) 15 oil & 115 water 15 BOPD
 ROCK PRESSURE AFTER TREATMENT _____ HOURS _____
 Fresh Water _____ Feet _____ Salt Water _____ Feet _____
 Producing Sand Injun Depth 1888-1956'

Formation	Color	Hard or Soft	Top	Bottom	Oil, Gas or Water	Depth	Remarks
Soil			0	10			Logged by Birdwell 8 5/8" cemented to surface 4 1/2" above salt sand 7 7/8" Hole
Rock			10	20			
Shale			20	42			
Sand shale			42	120			
Red rock			120	240			
Sand & shale			240	1060			
Sand			1060	1140			
Shale			1140	1410			
Salt sand			1410	1720			
Little Lime			1720	1756			
Pencil Cave			1756	1760			
Big Lime			1760	1888			
<u>Injun</u>			1888	1956	Oil		
Shale			1956	2006	TD		

FEB 16 1970
 & COMPANY ON
 T. C. P. L. 413