

State of West Virginia
Department of Environmental Protection - Office of Oil and Gas
Well Operator's Report of Well Work

API 47-087-02786 County ROANE District REEDY
Quad LIVERPOOL Pad Name _____ Field/Pool Name _____
Farm name MARY B. SNYDER Well Number JOHN STANLEY #2
Operator (as registered with the OOG) KRAKROW, INC.
Address P. O. BOX 1007 City SPENCER State WV Zip 25276

As Drilled location NAD 83/UTM Attach an as-drilled plat, profile view, and deviation survey
Top hole Northing 692,837 Easting 1,824,721
Landing Point of Curve Northing N/A Easting N/A
Bottom Hole Northing _____ Easting _____

Elevation (ft) 994' GL Type of Well New Existing Type of Report Interim Final
Permit Type Deviated Horizontal Horizontal 6A Vertical Depth Type Deep Shallow
Type of Operation Convert Deepen Drill Plug Back Redrilling Rework Stimulate
Well Type Brine Disposal CBM Gas Oil Secondary Recovery Solution Mining Storage Other _____
Type of Completion Single Multiple Fluids Produced Brine Gas NGL Oil Other _____
Drilled with Cable Rotary

Drilling Media Surface hole Air Mud Fresh Water Intermediate hole Air Mud Fresh Water Brine
Production hole Air Mud Fresh Water Brine
Mud Type(s) and Additive(s)
CLA STA, SOAP

Date permit issued 8/10/12 Date drilling commenced REWORK 5/19/14 Date drilling ceased 6/5/14
Date completion activities began 7/24/14 Date completion activities ceased 11/11/14
Verbal plugging (Y/N) N/A Date permission granted N/A Granted by N/A

Please note: Operator is required to submit a plugging application within 5 days of verbal permission to plug

Received
Office of Oil & Gas
APR 03 2015

Freshwater depth(s) ft 90', PITTSBURG 706' - 806' Open mine(s) (Y/N) depths NO
Salt water depth(s) ft SALT SAND 1M668' - 2,152', BIG INJUN 2,185' - 2,193' Void(s) encountered (Y/N) depths NO
Coal depth(s) ft NONE Cavern(s) encountered (Y/N) depths NO
Is coal being mined in area (Y/N) NO

Reviewed by:
A.L. 5/26/15
06/12/2015
API # 87-02787R
W.S. 06/01/15

* PITT DISPOSAL SENT TO JOHN STANLEY #3

API 47-087 - 02786

Farm name MARY B. SNYDER

Well number JOHN STANLEY #2

CASING STRINGS	Hole Size	Casing Size	Depth	New or Used	Grade wt/ft	Basket Depth(s)	Did cement circulate (Y/ N) * Provide details below*
Conductor							
Surface		10'	962'	USED IN DRILLING	554' LEFT IN WELL		SHOE
Coal							
Intermediate 1	8 7/8"	7"	2,196'	EXISTING			SHOE
Intermediate 2							
Intermediate 3							
Production	6 3/8"	4 1/2"	2,216'	EXISTING	10.5#	SQUEEZE PERFORMED @ 2201'	NO, TOP OF CEMENT
Tubing							
Packer type and depth set							

Comment Details _____

CEMENT DATA	Class/Type of Cement	Number of Sacks	Slurry wt (ppg)	Yield (ft ³ /sks)	Volume (ft ³)	Cement Top (MD)	WOC (hrs)
Conductor							
Surface							
Coal							
Intermediate 1							
Intermediate 2							
Intermediate 3							
Production	A/I	57	15.0	1.23	70.11	1,600 EST	
Tubing							

Drillers TD (ft) 2606' Loggers TD (ft) 2606'

Deepest formation penetrated BEREA Plug back to (ft) N/A

Plug back procedure N/A

Kick off depth (ft) N/A

Check all wireline logs run caliper density deviated/directional induction
 neutron resistivity gamma ray temperature sonic

Well cored Yes No Conventional Sidewall Were cuttings collected Yes No

DESCRIBE THE CENTRALIZER PLACEMENT USED FOR EACH CASING STRING EXISTING CASING STRINGS

ALSO: CCL - BOND

WAS WELL COMPLETED AS SHOT HOLE Yes No DETAILS _____

WAS WELL COMPLETED OPEN HOLE? Yes No DETAILS _____

WERE TRACERS USED Yes No TYPE OF TRACER(S) USED _____

Received
Office of Oil & Gas

APR 03 2015

06/12/2015

API 47- 087 - 02786 Farm name MARY B. SNYDER Well number JOHN STANLEY #2

PRODUCING FORMATION(S)	DEPTHS		
<u>BEREA</u>	<u>2599'</u>	<u>TVD</u>	<u>2615'</u> <u>MD</u>
_____	_____	_____	_____
_____	_____	_____	_____

Please insert additional pages as applicable.

GAS TEST Build up Drawdown Open Flow OIL TEST Flow Pump

SHUT-IN PRESSURE Surface _____ psi Bottom Hole _____ psi DURATION OF TEST _____ hrs

OPEN FLOW Gas Oil NGL Water GAS MEASURED BY
 SHOW mcfpd SHOW bpd _____ bpd _____ bpd Estimated Orifice Pilot

LITHOLOGY/ FORMATION	TOP	BOTTOM	TOP	BOTTOM	DESCRIBE ROCK TYPE AND RECORD QUANTITY AND TYPE OF FLUID (FRESHWATER, BRINE, OIL, GAS, H ₂ S, ETC)
	DEPTH IN FT NAME TVD	DEPTH IN FT TVD	DEPTH IN FT MD	DEPTH IN FT MD	
	0		0		
1ST PGH	706	784			
2ND PGH	789	806			
LITTLE DUNKARD	1130	1198			
BIG DUNKARD	1288	1299			
SALT SAND	1668	2152			
BIG LIME	2152	2185			
INJUN	2185	2193			
BREAK	2193	2196			
SLATE & SHALES	2196	2585			
BROWN SHALE	2585	2599			
BEREA SAND	2599	2615			
BEREA SAND	2599	2615			
BLUE LIME	2615	2626			

Please insert additional pages as applicable.

Drilling Contractor ROY G. HILDRETH AND SON, INC.
 Address P O BOX 1007 City SPENCER State WV Zip 25276

Logging Company NABORS COMPLETION & PRODUCTION SERVICES, INC. (BOND & OPEN HOLE)
 Address P O BOX 975682 City DALLAS State TX Zip 75397-5682

Cementing Company ROY G. HILDRETH AND SON, INC.
 Address P O BOX 1007 City SPENCER State WV Zip 25276

Stimulating Company UNIVERSAL WELL SERVICES, INC.
 Address P O BOX 200969 City DALLAS State TX Zip 75320

Please insert additional pages as applicable.

Completed by JON R. HILDRETH Telephone 304-927-2130
 Signature *Jon R. Hildreth* Title PRESIDENT Date 3/7/15

Received
Office of Oil & Gas

Submittal of Hydraulic Fracturing Chemical Disclosure Information Attach copy of FRACFOCUS Registry

APR 03 2015

06/12/2015

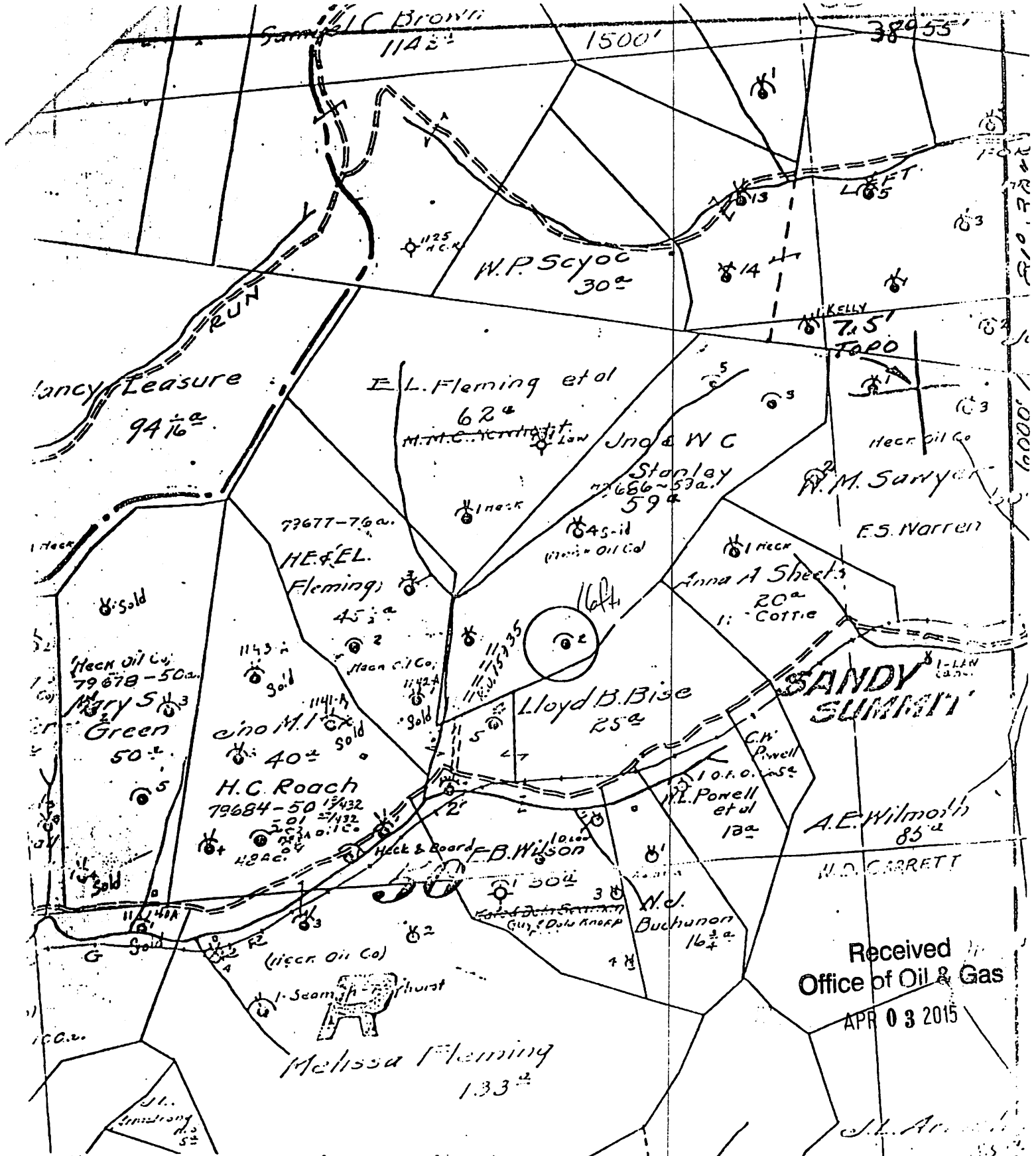

(X) DENOTES LOCATION OF WELL ON UNITED STATES TOPOGRAPHIC MAPS
 FORM IV-6
 10-70
 50 536 W150



DATE 12-8-1978
 OPERATOR'S WELL NO. 2
 API WELL NO. 47-087-2786
 STATE COUNTY PERMIT

STATE OF WEST VIRGINIA
 DEPARTMENT OF MINES
 OIL AND GAS DIVISION

WELL TYPE: OIL & GAS. LIQUID INJECTION. WASTE DISPOSAL.
 (IF "GAS", FROTHING, FLUORIDE, OR OTHER SPECIAL TREATMENT)
 LOCATION: ELEVATION 990 WATER OR BRUSHY FR. SANDY CK.
 DISTRICT REEDY COUNTY ROANE
 QUADRANGLE LIVERPOOL 7.5'

SURFACE OWNER _____ SURFACE
 OIL & GAS ROYALTY OWNER _____ RELEASE AGREEMENT _____
 LEASE NO. _____

PROPOSED WORK: DRILL _____ CONVERT _____ RE-DRILL _____ FRACTURE OR
 STIMULATE _____ FLUG OFF OLD FORMATION _____ REPERFORATE NEW
 FORMATION _____ OTHER PHYSICAL CHANGE IN WELL (SPECIFY) _____

FLUG AND ADJOINING _____ CLEAN OUT AND REFLUG _____
 TARGET FORMATION _____ ESTIMATED DEPTH _____
 WELL OPERATOR: Pennell Company _____ James A. Crews
 P. O. Box 1388 _____ P. O. Box 1548
 Charleston, WV 25301 _____ Charleston, WV 25301

06/12/2015

ROA-2786

Well No. *7* *John + H. C. Stanley* Farm *59* Acres
 Lease No. *79686* *Rudy* *Turntable* *Round* County *W. Va.* State
 District *Round* Contractor *Heck Oil Co.* Contractor
 Drilling Commenced *?* *19* Drilling Completed *5-5-1922*
 N. *S. 36* E. *W. 50* Elevation *904.67*

Rock Formation	Top	Bottom	Steel Line Measurement	Remarks
<i>1st Pgh.</i>	<i>706</i>	<i>784</i>		
<i>2nd Pgh.</i>	<i>789</i>	<i>806</i>		
<i>Little Sunhard</i>	<i>1130</i>	<i>1198</i>		
<i>Big Sunhard</i>	<i>1288</i>	<i>1299</i>		
<i>Salt Sand</i>	<i>1668</i>	<i>2152</i>		
<i>Big Limestone</i>	<i>2152</i>	<i>2185</i>		
<i>Big Limestone</i>	<i>2185</i>	<i>2193</i>		
<i>Brack</i>	<i>2193</i>	<i>2196</i>		
<i>Slates + Shells</i>	<i>2196</i>	<i>2585</i>		
<i>Brown Shale</i>	<i>2585</i>	<i>2599</i>		
<i>Brown</i>	<i>2599</i>	<i>2615</i>		
<i>Oil, Light</i>	<i>2599</i>	<i>2612</i>		
<i>Oil + Gas</i>	<i>2612</i>	<i>2615</i>		
<i>Blue Limestone</i>	<i>2615</i>	<i>2626</i>		

Total Depth 2626

Purchased from the Heck Oil Co on 11-14-35

Shot 10-3-29 - 90 lbs @ 2612-2615 ft

CASING RECORD AS TALLIED. NOT STEEL LINE MEASUREMENT.

Put in Well		Pulled Out		Left in Well		Shot Date <i>5-5-22</i>	Amount <i>70 gts.</i>
Size	Feet	In	Feet	In	Feet		
<i>10"</i>	<i>962</i>		<i>554</i>				<i>Sand 2601-2615</i>
<i>8 1/4"</i>			<i>all pulled</i>				<i>Result</i>
<i>6 3/8"</i>	<i>2196</i>						<i>Packer Size</i>
							<i>Depth Set</i>

Production First 24 Hours *14* Ebls Gas Test

Approved by

Received *06/12/2015*
 Superintendent
 Office of Oil & Gas
 APR 03 2015