

NAD 83  
 LAT. 38.9015383N  
 LONG. 81.5051932W

STATE PLANE COOR.  
 NAD 83  
 N 692,837  
 E 1,824,721

UTM NAD.83  
 17 04 56194E  
 4305972N

(+) DENOTES LOCATION OF WELL ON UNITED STATES TOPOGRAPHIC MAPS

FILE NO. \_\_\_\_\_  
 DRAWING NO. 12-16  
 SCALE 1"=500'  
 MINIMUM DEGREE OF ACCURACY 1 IN 200  
 PROVEN SOURCE OF ELEVATION GPS

I THE UNDERSIGNED, HEREBY CERTIFY THAT THIS PLAT IS CORRECT TO THE BEST OF MY KNOWLEDGE AND BELIEF AND SHOWS ALL THE INFORMATION REQUIRED BY LAW AND THE REGULATIONS ISSUED AND PRESCRIBED BY THE DEPARTMENT OF ENERGY.  
 (SIGNED) *[Signature]*  
 R.P.E. \_\_\_\_\_ L.L.S. 851

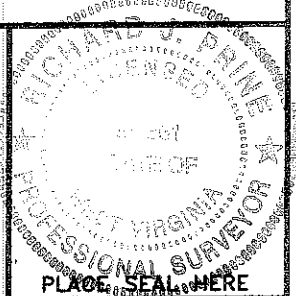

STATE OF WEST VIRGINIA  
 Department of Environmental Protection  
 OFFICE OF OIL AND GAS

DATE 6/29, 2012  
 OPERATOR'S WELL NO. STANLEY#2  
 API WELL NO. 47 - 087 - 02786 R  
 STATE WV COUNTY ROANE PERMIT 02786 R

WELL TYPE: OIL  GAS  LIQUID INJECTION  WASTE DISPOSAL   
 (IF "GAS") PRODUCTION  STORAGE  DEEP  SHALLOW

LOCATION: ELEVATION 994 WATER SHED BRUSHY FORK  
 DISTRICT REEDY COUNTY ROANE  
 QUADRANGLE LIVERPOOL

SURFACE OWNER MARY B. SNYDER ACREAGE 59  
 OIL & GAS ROYALTY OWNER GMH GAS CO. INC LEASE ACREAGE 59  
 LEASE NO. \_\_\_\_\_

PROPOSED WORK: DRILL  CONVERT  DRILL DEEPER  REDRILL  FRACTURE OR STIMULATE  PLUG OFF OLD FORMATION  PERFORATE NEW FORMATION  OTHER PHYSICAL CHANGE IN WELL (SPECIFY): \_\_\_\_\_

PLUG AND ABANDON  CLEAN OUT AND REPLUG

TARGET FORMATION BEREA ESTIMATED DEPTH 2500  
 WELL OPERATOR KRAKROW, INC. DESIGNATED AGENT ROY G. HILDRETH JR  
 ADDRESS PO BOX 1007 ADDRESS PO BOX 1007  
SPENCER, WV 25276 SPENCER, WV 25276

08/10/2012

870278+

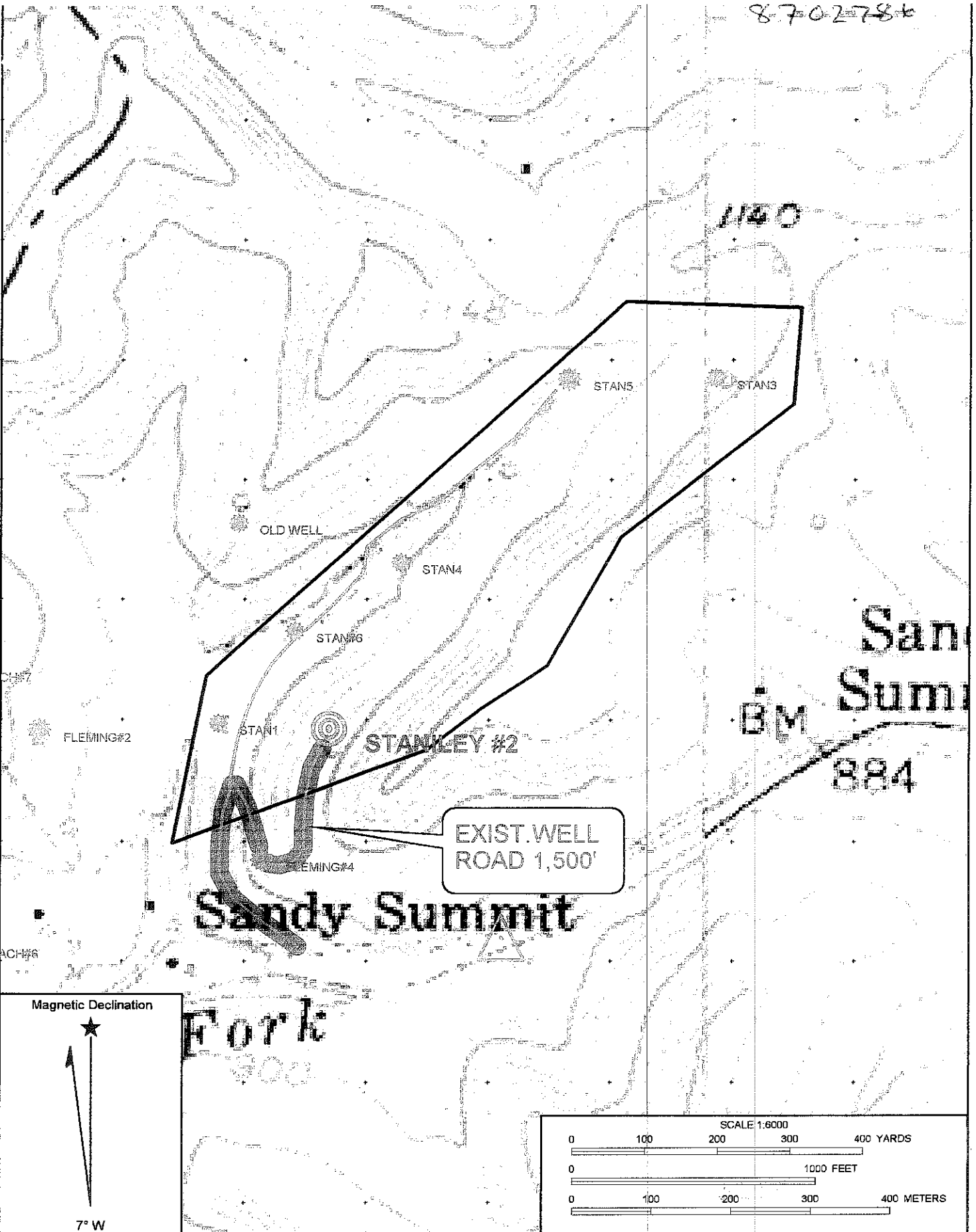

Magnetic Declination

7° W

SCALE 1:6000

0 100 200 300 400 YARDS

0 1000 FEET

0 100 200 300 400 METERS

Copyright (C) 1997, Maptech, Inc.