

FILE NO 425
 MAP 72 S09 S54 W35
 SCALE 1" = 800'
 MINIMUM DEGREE OF ACCURACY 1 in 200'
 PROVEN SOURCE OF ELEVATION W. M. Looney #30
1076.63'

I THE UNDERSIGNED, HEREBY CERTIFY THAT THIS PLAT IS CORRECT TO THE BEST OF MY KNOWLEDGE AND BELIEF AND SHOWS ALL THE INFORMATION REQUIRED BY LAW AND THE REGULATIONS ISSUED AND PRESCRIBED BY THE DEPARTMENT OF MINES
 (SIGNED) Curtis A. Lucas
 CURTIS A. LUCAS LLS 275

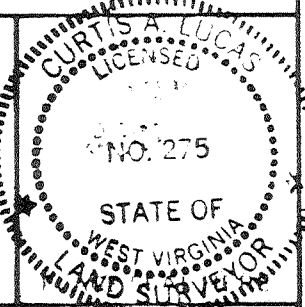

(1) DENOTES LOCATION OF WELL ON UNITED STATES TOPOGRAPHIC MAPS
 FORM IV B
 (8/78)



DATE April 12, 19 84
 FARM W. M. LOONEY NO. 42
 API WELL NO
47 087 3875-LI
 STATE COUNTY PERMIT

STATE OF WEST VIRGINIA
 DEPARTMENT OF MINES
 OIL AND GAS DIVISION

WELL TYPE OIL GAS LIQUID INJECTION WASTE DISPOSAL
 (IF "GAS") PRODUCTION STORAGE DEEP SHALLOW
 LOCATION ELEVATION 1067.77' WATERSHED TRACE FORK
 DISTRICT SMITHFIELD 5 COUNTY ROANE
 QUADRANGLE TARIFF 6357 1/2' OTTER 096 1/5' WC 4
 SURFACE OWNER PENNZOIL ACREAGE 88 Ac.
 OIL & GAS ROYALTY OWNER KEITH CRIHFIELD LEASE ACREAGE 480 ac.
 LEASE NO. 60218-50
 PROPOSED WORK DRILL CONVERT DRILL DEEPER REDRILL FRACTURE OR STIMULATE PLUG OFF OLD FORMATION PERFORATE NEW FORMATION OTHER PHYSICAL CHANGE IN WELL (SPECIFY)

PLUG AND ABANDON CLEAN OUT AND REPLUG
 TARGET FORMATION Big Injun ESTIMATED DEPTH 2,145'
 WELL OPERATOR PENNZOIL COMPANY DESIGNATED AGENT JAMES A. CREWS
 ADDRESS P. O. BOX 1588 673 ADDRESS P. O. BOX 1588
PARKERSBURG, W.V. 26101 PARKERSBURG, W.V. 26101

MAY 7 1984

8-0 Tariff (Tallman) (199)

DETAILS OF PERFORATED INTERVALS, FRACTURING OR STIMULATING, PHYSICAL CHANGE, ETC.

Big Injun: Open Hole 2075-2137

Fractured: w/250 gls. 12-3 reg. mud acid, 48 Bbls. 20# gel, 500# 20/40 sd

WELL LOG

FORMATION	COLOR	HARD OR SOFT	TOP FEET	BOTTOM FEET	REMARKS
					Including indication of all fresh and salt water, coal, oil and gas
Sand			0	94	
Silt & Shale			94	440	
Sand, Shale, Silt			440	1612	
Salt Sand			1612	1857	
Shale, Sand			1857	1910	
Little Lime			1910	1950	
Blue Monday			1950	1957	
Pencil Cave			1957	1974	
Big Lime			1974	2075	
Keener			2075	2091	
Big Injun			2091	2111	
Pocono Shale			2111	2138	
Total Depth				2138	

(Attach separate sheets as necessary)

Pennzoil Company
Well Operator

By: Curtis A. Luman

Date: 12-4-84

Note: Regulation 2.02(i) provides as follows:
"The term 'log' or 'well log' shall mean a systematic detailed geological record of all formations, including coal, encountered in the drilling of a well."

OFFICE USE ONLY
DRILLING PERMIT

Permit number 47-087-3875-LI

May 3 19 84
Date

This permit covering the well operator and well location shown below is evidence of permission granted to drill in accordance with the pertinent legal requirements subject to the conditions contained herein and on the reverse hereof. Notification must be given to the District Oil and Gas Inspector, (Refer to No. 8) Prior to the construction of roads, locations and pits for any permitted work. In addition, the well operator or his contractor shall notify the proper district oil and gas inspector 24 hours before actual permitted work has commenced.)

The permitted work is as described in the Notice and Application, plat, and (if required) construction and reclamation plan, subject to any modifications and conditions specified below.

Permit expires May 13, 1986 unless well work is commenced prior to that date and prosecuted with due diligence.

Bond:	Agent:	Plat:	Casing:	Fee:
	<i>LS</i>	<i>MJ</i>	<i>MJ</i>	<i>17463</i>

Michael Lewis

Administrator, Office of Oil and Gas

NOTE: Keep one copy of this permit posted at the drilling location.

PERMIT MODIFICATIONS AND CONDITIONS (IF ANY) TO THE PROPOSED WELL WORK

OFFICE USE ONLY

This part of Form IV-3(b) is to record the dates of certain occurrences and any follow-up inspections.

	Date	Follow-up inspection(s)	Date(s)
Application received			
Well work started		" "	
Total depth reached		" "	
Well Record received		" "	
Reclamation completed		" "	

OTHER INSPECTIONS

Reason: _____

Reason: _____