

LATITUDE 38° 52' 30"

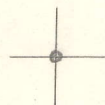

0.40 W  
0.64 S

81° 17' 30" LONGITUDE

7'5 OGIS topo location

7.5' loc \_\_\_\_\_ 15' loc \_\_\_\_\_  
(calc.) \_\_\_\_\_

Company \_\_\_\_\_

Farm \_\_\_\_\_

Quad Spencer 7 1/2'

County Roane

District Spencer

WELL LOCATION MAP

File No. 087-11A

I hereby certify that this map is true and correct, and shows all the information required by Oil & Gas law, Acts of 1929.

*G. Cunningham*

Acknowledged before me a \_\_\_\_\_ Notary Public \_\_\_\_\_ of  
Kanawha County, W. Va. this \_\_\_\_\_ day of \_\_\_\_\_ 19\_\_\_\_  
My Commission expires \_\_\_\_\_

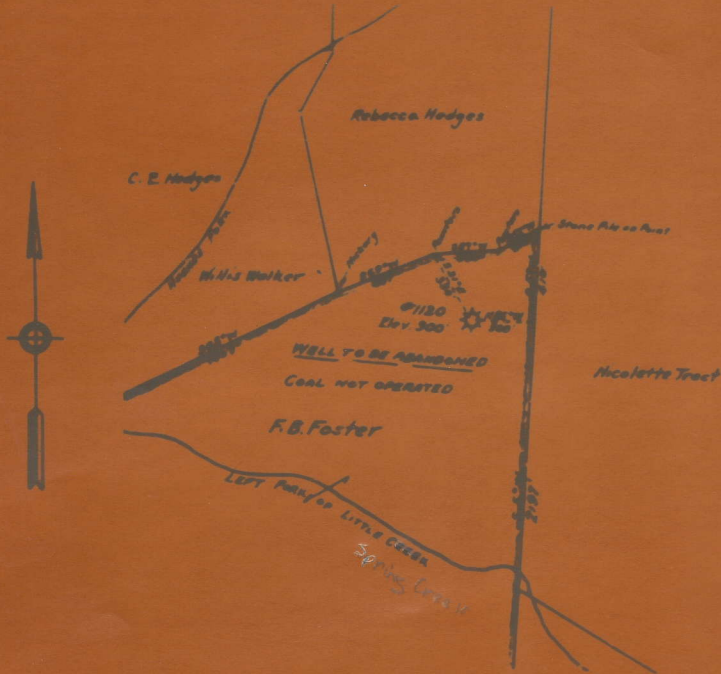

F. B. Foster  
Well No. 1120  
Spencer District  
Roane County, W. Va.  
May 12, 1930

ROA-11-A

UNITED FUEL GAS CO.  
MAP SHOWING  
WELL TO BE ABANDONED  
SCALE - 4 INCHES = 1 MILE

11A

Spencer District, Roane County, W. Va.

By United Fuel Gas Co., Charleston, W. Va.

On 112 acres, surface and mineral rights owned by F. B. Foster Estate,  
Spencer, W. Va.

Well was completed May 16, 1920.

No elevation given. 900' (see plat)

13" conductor, 16'; 10" casing, 832'; 8 $\frac{1}{4}$ " 1128'; 6-5/8" 2173'.

Abandonment reported to Dept. of Mines May 12, 1930.

Well was shot at 2496-2508'.

Producing hole.

	Top.	Bottom.
Pittsburgh Sand	490	- 550
2nd Pittsburgh Sand	685	- 710
Little Dunkard Sand	965	- 995
Big Dunkard Sand	1094	- 1170
Gas Sand	1270	- 1350
Salt Sand	1745	- 1917
Little Lime	1917	- 1947
Pencil Cave	1947	- 1953
Big Lime	1953	- 2078
Big Injun Sand	2078	- 2113
Berea Sand (gas, 2500-2508')	2485	- 2509
Total depth		2560