

Latitude 38 50

Longitude 81 25

J. F. Wright  
3 1/2

O. N. Boyer

F. L. Mathews

Lloyd C. Bailey

W.V. & FLORENCE MATTHEWS

Jacob H. Blackwell

New Location  
Drill Deeper  
Abandonment X

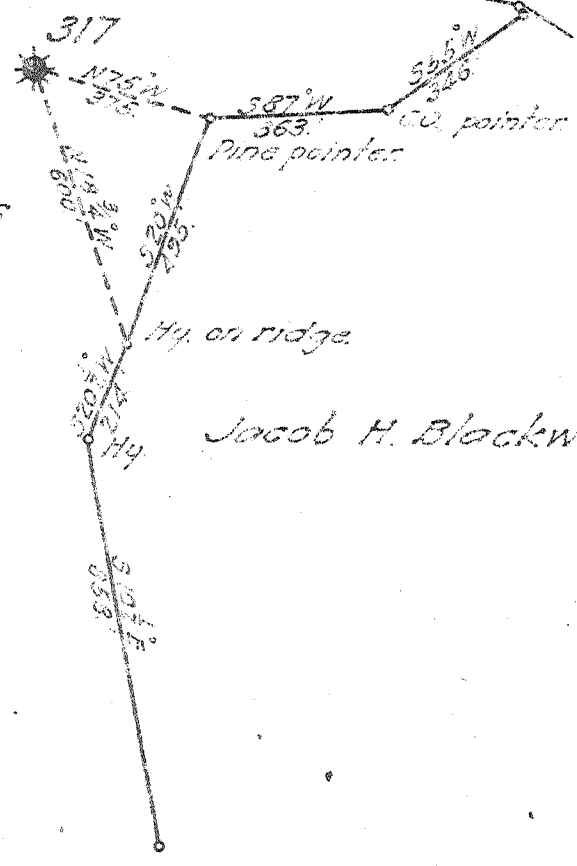

Company UNITED FUEL GAS CO.  
 Address CHARLESTON W.VA.  
 Farm W.V. & FLORENCE MATTHEWS  
 Tract \_\_\_\_\_ Acres 100 Lease No. 8256  
 Well (Farm) No. \_\_\_\_\_ Serial No. 317  
 Elevation (Spirit Level) 1060.342  
 Quadrangle SPENCER  
 County ROANE District CURTIS  
 Engineer \_\_\_\_\_  
 Engineer's Registration No. 659  
 File No. 70-87 Drawing No. \_\_\_\_\_  
 Date Apr 26 1945 Scale 1" = 400'

STATE OF WEST VIRGINIA  
DEPARTMENT OF MINES  
OIL AND GAS DIVISION  
CHARLESTON

WELL LOCATION MAP  
FILE NO. POA-406-A

+ Denotes location of well on United States Topographic Maps, scale 1 to 62,500, latitude and longitude lines being represented by border lines as shown.

- Denotes one inch spaces on border line of original tracing.

Curtis District, Boone County, W. Va.

Carter Oil Co.

3/4 mi. S. E. of Clarence.

Completed, Sept., 1909.

Elevation, 1050' B.

10" casing, 855'; 8 1/2", 1245'; 6-5/8", 2250'; 4" tubing, 2633'.

Top. Bottom.

Sand, Cow Run? (Lower Pittsburgh) 755 - 805

Sand, Cow Run? (Gas Sand) 1380 - 1445

Sand, Salt? (Second Cow Run) 1590 - 1615

Salt Sand (oil and gas show, 1857';  
 water, 1875') 1840 - 2155

Big Lime 2155 - 2225

Big Injun Sand 2225 - 2240

Berea Sand (gas, 2627-2633'), to bottom 2621 - 2633  
 (10,000,000 cu. ft.; R. P. 900+ lbs.)



STATE OF WEST VIRGINIA  
DEPARTMENT OF MINES  
OIL AND GAS DIVISION

316

405 A

WELL RECORD

Permit No. \_\_\_\_\_ Oil or Gas Well GAS  
(KIND)

Company United Fuel Gas Co.  
 Address Box 1273, Charleston 25, W. Va.  
 Farm Florence Matthews Acres 100  
 Location (waters) Middle Fork of Left Fork of Reedy Crk.  
 Well No. 317 Elev. 1060  
 District Curtis County Roane  
 The surface of tract is owned in fee by F.L. Matthews  
 Address Gay, W. Va.  
 Mineral rights are owned by Same  
 Address \_\_\_\_\_  
 Drilling commenced 3-17-1909  
 Drilling completed 5-6-1909  
 Date Shot 1-17-1930 From 2624 To 2634  
 With 40 qts.  
 Open Flow \_\_\_\_\_ /10ths Water in \_\_\_\_\_ Inch  
 \_\_\_\_\_ /10ths Merc. in \_\_\_\_\_ Inch  
 Volume Gas Well \_\_\_\_\_ Cu. Ft.  
 Rock Pressure \_\_\_\_\_ lbs. \_\_\_\_\_ hrs.  
 Oil \_\_\_\_\_ bbls., 1st 24 hrs.  
 Fresh water \_\_\_\_\_ feet \_\_\_\_\_ feet  
 Salt water 1875 feet \_\_\_\_\_ feet

| Casing and Tubing | Used in Drilling | Left in Well | Packers        |
|-------------------|------------------|--------------|----------------|
| Size              |                  |              |                |
| 16                |                  |              | Kind of Packer |
| 13                |                  |              |                |
| 10                |                  |              | Size of        |
| 8 1/4             |                  |              |                |
| 6 5/8             | 2255             | 2255         | Depth set      |
| 5 3/16            |                  |              |                |
| 3                 |                  |              | Perf. top      |
| 2                 |                  |              | Perf. bottom   |
| Liners Used       |                  |              | Perf. top      |
|                   |                  |              | Perf. bottom   |

CASING CEMENTED \_\_\_\_\_ SIZE \_\_\_\_\_ No. Ft. \_\_\_\_\_ Date \_\_\_\_\_  
 COAL WAS ENCOUNTERED AT \_\_\_\_\_ FEET \_\_\_\_\_ INCHES  
 \_\_\_\_\_ FEET \_\_\_\_\_ INCHES FEET \_\_\_\_\_ INCHES  
 \_\_\_\_\_ FEET \_\_\_\_\_ INCHES FEET \_\_\_\_\_ INCHES

| Formation                                               | Color | Hard or Soft | Top  | Bottom | Oil, Gas or Water  | Depth Found  | Remarks |
|---------------------------------------------------------|-------|--------------|------|--------|--------------------|--------------|---------|
| Cow Run (first)                                         |       |              | 755  | 805    |                    |              |         |
| Cow Run (second)                                        |       |              | 1380 | 1445   |                    |              |         |
| Salt Sand (upper)                                       |       |              | 1590 | 1615   |                    |              |         |
| " " (middle)                                            |       |              | 1840 | 2155   | Oil & gas<br>Water | 1857<br>1875 | Small   |
| Big Lime                                                |       |              | 2155 | 2225   |                    |              |         |
| Injun Sand                                              |       |              | 2225 | 2240   |                    |              |         |
| Berea Sand                                              |       |              | 2621 | 2636   | Gas                | 2627         | Pay     |
| Total Depth                                             |       |              |      | 2636   |                    |              |         |
| DRILLED DEEPER Commenced 12-29-1929 Completed 2-28-1930 |       |              |      |        |                    |              |         |
| Drilled 47 feet deeper                                  |       |              |      |        |                    |              |         |
| Total Depth                                             |       |              |      | 2683   |                    |              |         |

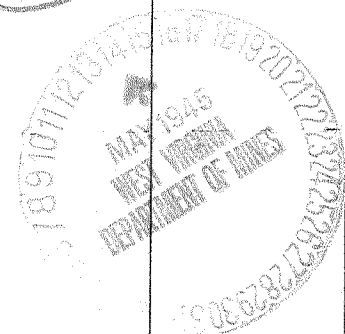

| Formation | Color | Hard or Soft | Top | Bottom | Oil, Gas or Water | Depth Found | Remarks |
|-----------|-------|--------------|-----|--------|-------------------|-------------|---------|
|           |       |              |     |        |                   |             |         |

Date April 12, 194 5

APPROVED UNITED FUEL GAS COMPANY, Owner

By *L. A. Cunningham*  
(Title) Engineer

