

New Location...
 Drill Deeper.....
 Abandonment.....

Company UNITED FUEL GAS CO.
 Address CHARLESTON, WVA.
 Farm D. LARCH
 Tract _____ Acres 20 Lease No. 7605
 Well (Farm) No. 1 Serial No. 2802
 Elevation (Spirit Level) 814.7
 Quadrangle WALTON **NC**
 County ROANE District HARPER
 Engineer J.H. Moore
 Engineer's Registration No. 662
 File No. 70-77 Drawing No. _____
 Date 3-15-49 Scale 1" = 400

STATE OF WEST VIRGINIA
 DEPARTMENT OF MINES
 OIL AND GAS DIVISION
 CHARLESTON
See microfiche for Well Record
WELL LOCATION MAP
 FILE NO. ROA-642-A
Plugging case?
 + Denotes location of well on United States Topographic Maps, scale 1 to 62,500, latitude and longitude lines being represented by border lines as shown.
 - Denotes one inch spaces on border line of original tracing.

O+G Div. An. Rpt. 1949 Table 6
 Roane 642A comp. 1911 - oil well TD. 1896 -
 plugging conc.

maybe now 3116?

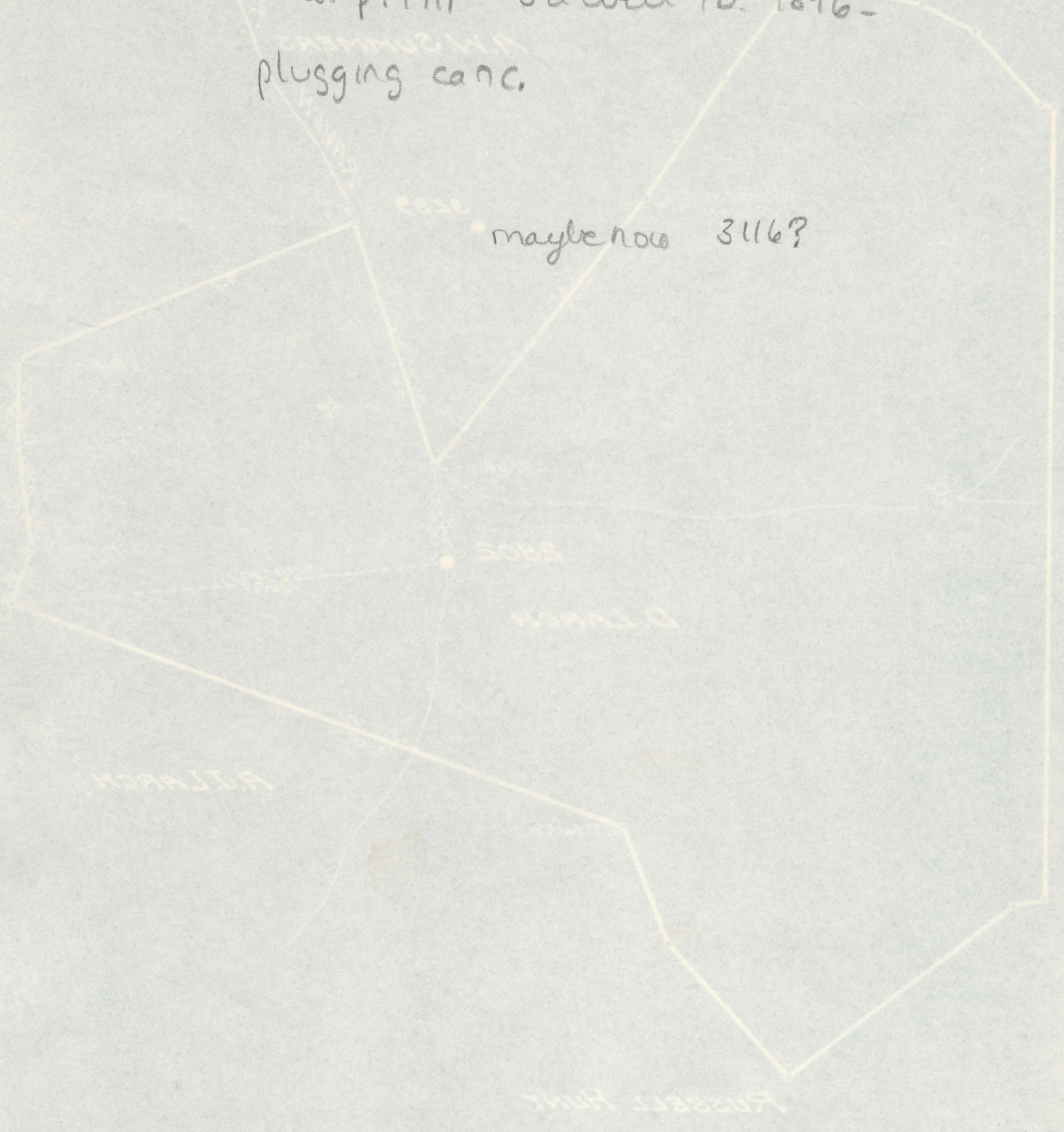

Abandonment
 Drill Depth
 New Location

Company UNITED FUEL GAS CO
 Address CHARLESTON, W. VA.
 Farm D. MARCH
 Acres 50 1/2
 Well (Farm) No. 1
 Elevation 800 feet
 Quantity 1000
 County TOWNE DISTRICT HARRIS
 Engineer WALTER
 Engineer's Registration No. 555
 The No. 20-11 Drawing No.
 Date 3-15-49 Scale 1"=100'

STATE OF WEST VIRGINIA
 DEPARTMENT OF MINES
 OIL AND GAS DIVISION
 CHARLESTON

WELL LOCATION MAP
 FILE NO. 642A

+ Denote location of well on United States
 Topographic Map, scale 1" to 62,500', or
 true and longitude lines being represented
 by border lines as shown.
 - Denote one inch spaces on border line
 of original tracing.