

LATITUDE 38° 40'

LONGITUDE 101° 18'

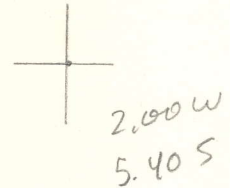

7'5 OGIS topo location

7.5' loc \_\_\_\_\_ 15' loc \_\_\_\_\_  
 \_\_\_\_\_ (calc.) \_\_\_\_\_

Company \_\_\_\_\_

Farm \_\_\_\_\_

Quad Otter (WC)

County Rowe

District Geary

WELL LOCATION MAP

File No. 087 - 726A

0 1 2 3 Latitude 38° 40'

1

2

3

Bl. 101

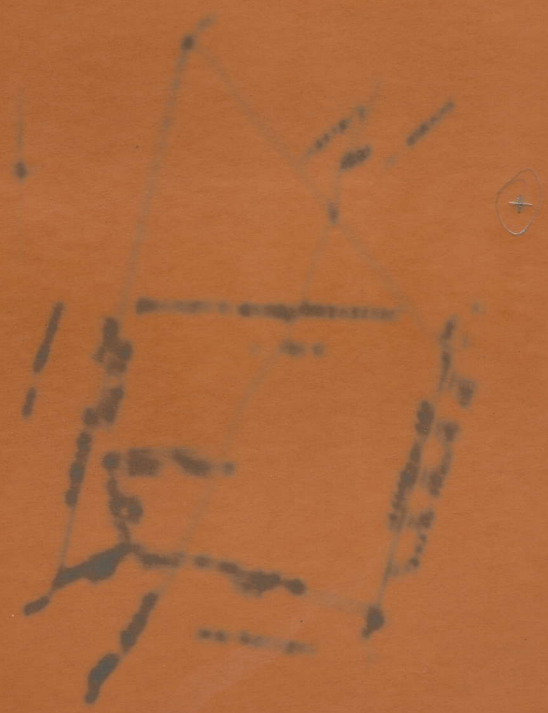

New Location   
 Drill Deeper   
 Abandonment

Company AMERICAN OIL COMPANY  
 Address 1000 MAIN ST  
 Farm ROAD 10 MILES SOUTHWEST  
 Town APRIL 1, 1910

Drill to depth of 1000 feet  
 and then to 1500 feet  
 and then to 2000 feet

ROANE COUNTY BOARD OF EDUCATION NO. 2. Roa-726-A.

By Morley Oil & Gas Co.

Geary Dist.

~~(NO PLAT)~~

see microfilm for  
Plat &  
well record