

Latitude 38° 35'

S. D. LITTLEPAGE

THOMAS B. FIELDS

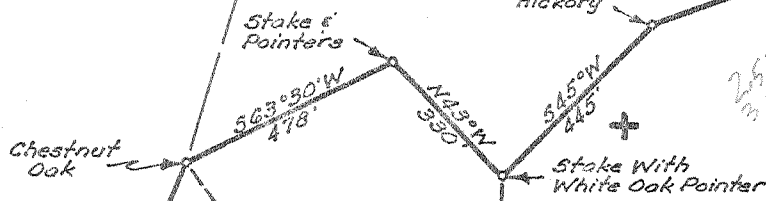

2533
S150W

Longitude 81° 20'

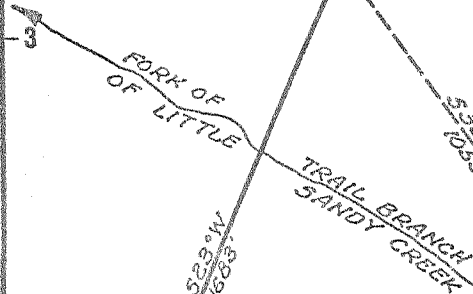

667

Z. L. HIVELY

B. K. LITTLEPAGE

HILARY HIVELY

ROANE LAND CO. MIN.

S. T. ELMORE

- New Location...
- Drill Deeper.....
- Abandonment.....

Company UNITED FUEL GAS CO.
 Address CHARLESTON, W. VA.
 Farm Z. L. HIVELY
 Tract _____ Acres 103 Lease No. 6585
 Well (Farm) No. _____ Serial No. 667
 Elevation (Spirit Level) 1020.44'
 Quadrangle WALTON
 County ROANE District WALTON
 Engineer Paul E. J. ...
 Engineer's Registration No. 669
 File No. 74-71 Drawing No. _____
 Date 6-22-55 Scale 1"=400'

STATE OF WEST VIRGINIA
 DEPARTMENT OF MINES
 OIL AND GAS DIVISION
 CHARLESTON

WELL LOCATION MAP
 FILE NO. ROA-954-A

+ Denotes location of well on United States Topographic Maps, scale 1 to 62,500, latitude and longitude lines being represented by border lines as shown.
 - Denotes one inch spaces on border line of original tracing.



STATE OF WEST VIRGINIA
DEPARTMENT OF MINES
OIL AND GAS DIVISION

709

WELL RECORD

Quadrangle Walton
Permit No. 457-A

Oil or Gas Well Gas
(KIND)

Company UNITED FUEL GAS COMPANY
Address P.O. Box 1273, Charleston 25, W. Va.
Farm Z. L. Hively Acres 103
Location (waters) Fork of Trail Br.
Well No. 667 Elev. 1020.44'
District Walton County Roane
The surface of tract is owned in fee by _____
Address _____
Mineral rights are owned by Oran Hively, et al
Address Clendenin, W. Va.
Drilling commenced 2-18-15
Drilling completed 4-2-15
Date Shot _____ From _____ To _____
With _____
Open Flow 10 /10ths Water in _____ Inch
3 /10ths Merc. in _____ Inch
Volume 1,244,000 Cu. Ft.
Rock Pressure 400 lbs. 48 hrs.
Oil _____ bbls., 1st 24 hrs.
Fresh water 700' feet _____ feet
Salt water 1360 feet 1380 feet

Casing and Tubing	Used in Drilling	Left in Well	Packers
Size			
16		16'	Kind of Packer <u>Callanan</u>
13			
10			Size of <u>3x6-5/8x16</u>
8 1/4	752'		
6 5/8		1804' 11"	Depth set <u>1867'</u>
5 3/16			
3		2003' 3"	Perf. top
2			Perf. bottom
Liners Used			Perf. top
			Perf. bottom

CASING CEMENTED _____ SIZE _____ No. Ft. _____ Date _____
COAL WAS ENCOUNTERED AT 690 FEET 60 INCHES
740 FEET 72 INCHES FEET INCHES
FEET INCHES FEET INCHES

Formation	Color	Hard or Soft	Top	Bottom	Oil, Gas or Water	Depth Found	Remarks
Red Rock			0	50			
Mountain Sand			50	130			
Slate			130	155			
Red Rock			155	265			
Slate			265	300			
Red Rock			300	400			
Slate & Lime Shells			400	565			
Sand			565	690			
Native Coal			690	695			
Sand			695	740			
Pittsburg Coal			740	746			
Slate			746	756			
Sand			756	795			
Lime			795	800			
Slate			800	880			
Sand			880	940			
Slate			940	1038			
Sand			1038	1068			
Slate			1068	1156			
Sand			1156	1176			
Slate & Shells			1176	1250			
Salt Sand			1250	1695			
Maxon Sand			1695	1735	Gas 1347-1351'		
Little Lime			1735	1764			
Big Lime			1764	1908	Show of gas 1864'		
Big Injun			1908	1938	Gas 1913-1933		
Total depth			1988'				

