

Latitude 38° 50'

Longitude 81° 30'

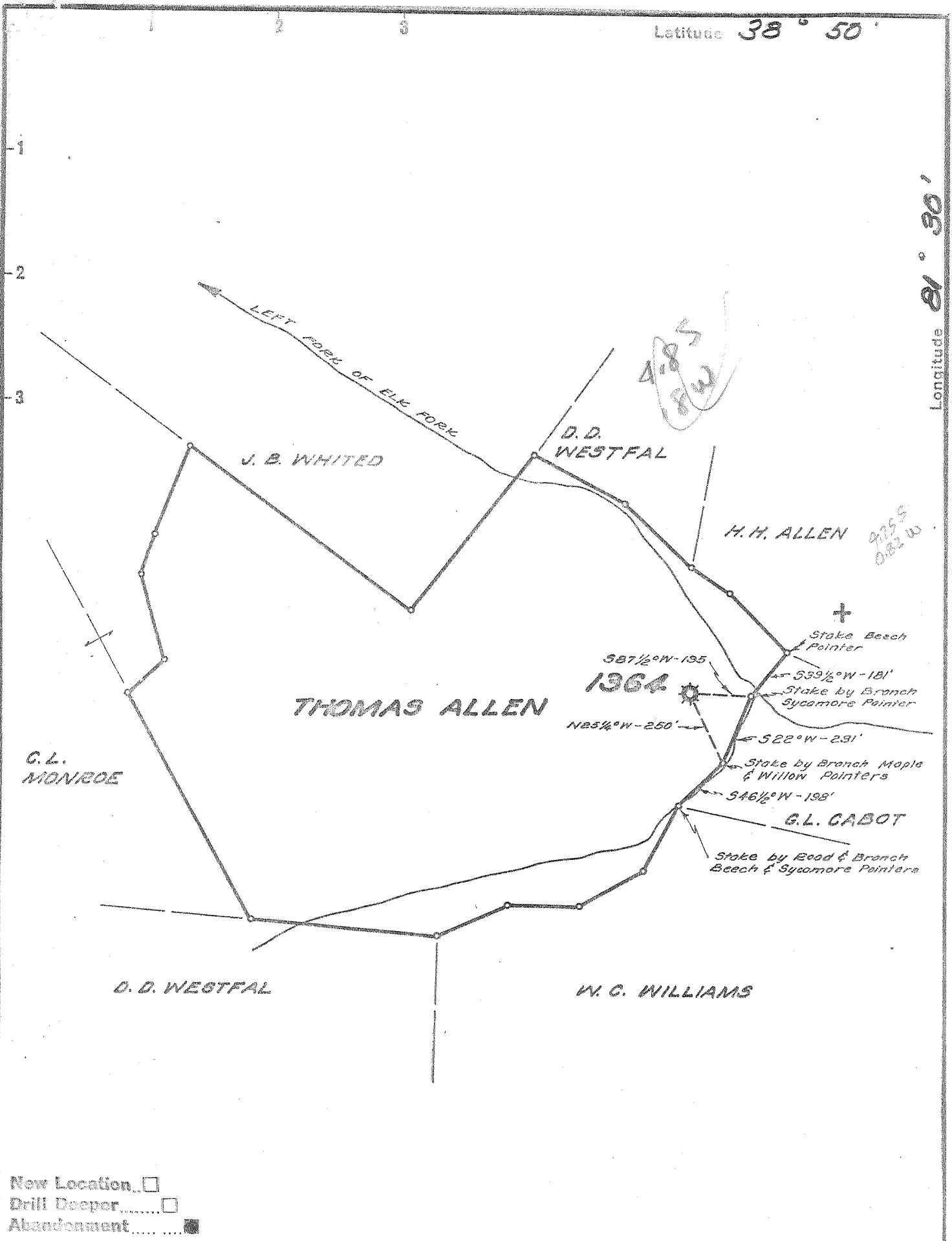

New Location
 Drill Deeper
 Abandonment

Company UNITED FUEL GAS CO.
 Address CHARLESTON, W.VA.
 Farm THOMAS ALLEN
 Tract _____ Acres 40 Lease No. 1453
 Well (Farm) No. 2 Serial No. 1364
 Elevation (Spirit Level) 900.0
 Quarter angle RIPLEY
 County ROANE District CURTIS
 Engineer [Signature]
 Engineer's Registration No. 2529
 File No. 87-68 Drawing No. _____
 Date 6-23-55 Scale 1"=400'

STATE OF WEST VIRGINIA
 DEPARTMENT OF MINES
 OIL AND GAS DIVISION
 CHARLESTON

WELL LOCATION MAP
 FILE NO. ROA-957-A

+ Denotes location of well on United States Topographic Maps, scale 1 to 62,500, latitude and longitude lines being represented by border lines as shown.

- Denotes one inch spaces on border line of original tracing.



STATE OF WEST VIRGINIA
DEPARTMENT OF MINES
OIL AND GAS DIVISION

J.03

Quadrangle Ripley

WELL RECORD

Permit No. _____ Oil or Gas Well Gas
(KIND)

Company UNITED FUEL GAS CO.
 Address P.O. Box 1273, Charleston 25, W. Va.
 Farm Thomas Allen Acres 40
 Location (waters) Left Fork of Elk Fork
 Well No. 1364 Elev. 900'
 District Curtis County Roane
 The surface of tract is owned in fee by _____
 Address _____
 Mineral rights are owned by J.B. Tolley, Agt., et al
 Address Leroy, W. Va.
 Drilling commenced 12-27-23
 Drilling completed 2-6-24
 Date Shot 4-11-24 From _____ To _____
 With 20 qts.
 Open Flow 10 /10ths Water in 2 Inch
 _____ /10ths Merc. in _____ Inch
 Volume 150,720 Cu. Ft.
 Rock Pressure 63 lbs. _____ hrs.
 Oil _____ bbls., 1st 24 hrs.
 Fresh water 490' feet _____ feet
 Salt water 1641' feet _____ feet

Casing and Tubing	Used in Drilling	Left in Well	Packers
Size			
16			Kind of Packer
13			<u>Parnaco</u>
10	<u>666'</u>		Size of
8 1/4	<u>1064'</u>		<u>5-3/16x2</u>
6 5/8		<u>2033'</u>	Depth set
5 3/16			<u>2215'</u>
3			Perf. top
2		<u>2502'</u>	Perf. bottom
Liners Used			Perf. top
			Perf. bottom

CASING CEMENTED _____ SIZE _____ No. Ft. _____ Date _____
 COAL WAS ENCOUNTERED AT _____ FEET _____ INCHES
 _____ FEET _____ INCHES FEET _____ INCHES
 _____ FEET _____ INCHES FEET _____ INCHES

Formation	Color	Hard or Soft	Top	Bottom	Oil, Gas or Water	Depth Found	Remarks
1st Pittsburgh Sand			398	509			
2nd Pittsburgh Sand			570	615			
Little Dunkard			1040	1137			
Gas Sand			1175	1215			
Stray Sand			1340	1385			
Salt Sand			1630	1916			
Oil			1674				
Big Line			1916	1996			
Big Injun			1996	2029			
Brown Shale			2418	2429			
Berea Grit			2429	2443			
Gas			2437	2442			
Slate			2443				
Total depth			2490'				

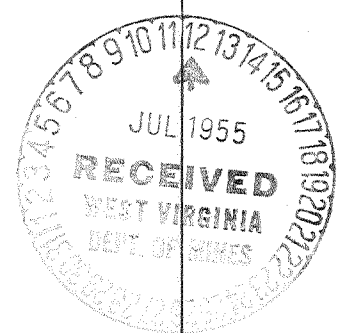

AUG 12 1955

