

Latitude **38° 35'**

+ 0785
4.21 W

Longitude **81° 20'**

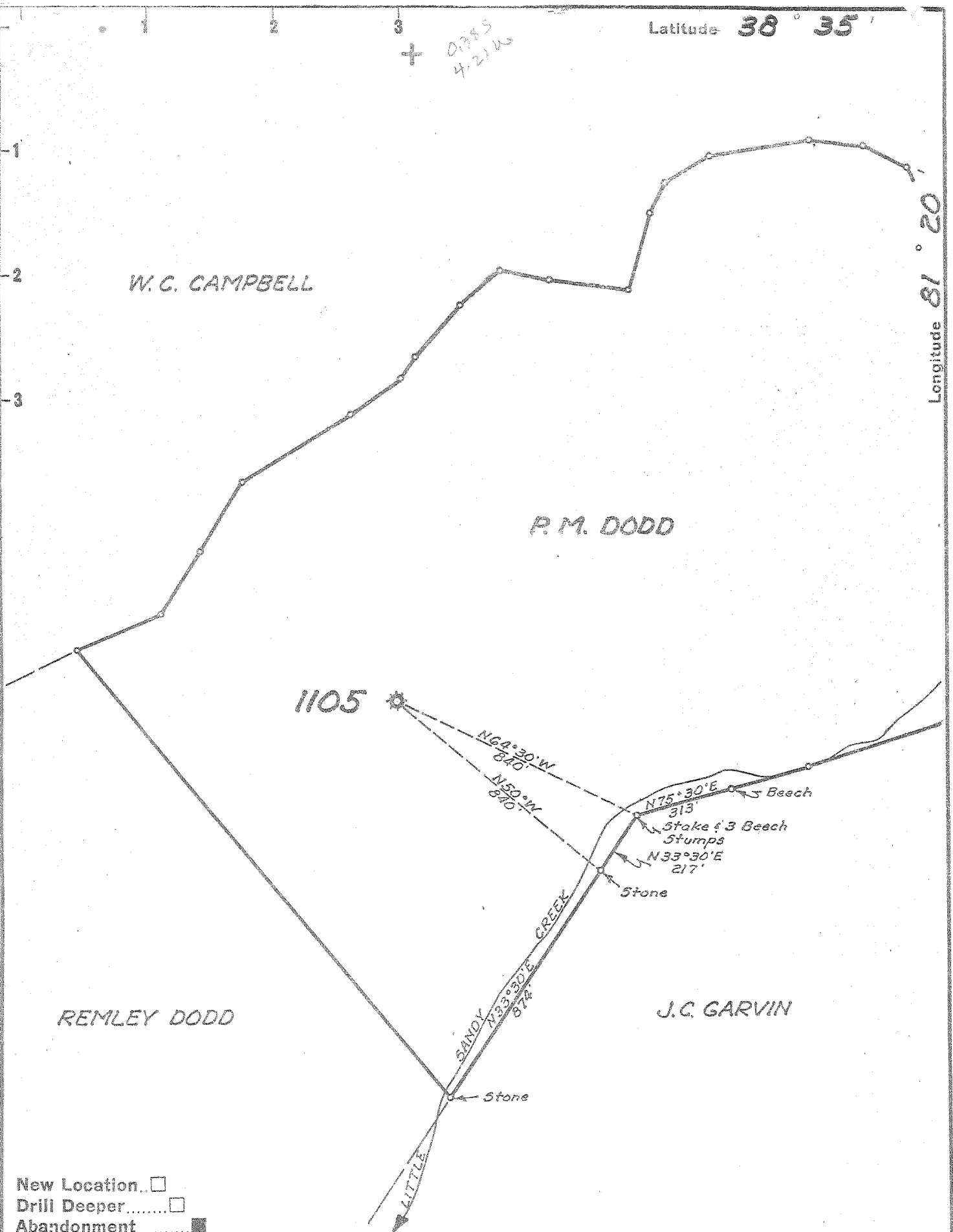

Company UNITED FUEL GAS CO.
 Address CHARLESTON, W. VA.
 Farm P. M. DODD
 Tract _____ Acres 150 Lease No. 11980
 Well (Farm) No. _____ Serial No. 1105
 Elevation (Spirit Level) 958.20'
 Quadrangle WALTON
 County ROANE District WALTON
 Engineer Paul G. Osullivan
 Engineer's Registration No. 669
 File No. 72-75 Drawing No. _____
 Date 7-11-55 Scale 1"=400'

STATE OF WEST VIRGINIA
 DEPARTMENT OF MINES
 OIL AND GAS DIVISION
 CHARLESTON

WELL LOCATION MAP
 FILE NO. ROA-958-A

+ Denotes location of well on United States Topographic Maps, scale 1 to 62,500, latitude and longitude lines being represented by border lines as shown.
 - Denotes one inch spaces on border line of original tracing.

(198)



STATE OF WEST VIRGINIA
DEPARTMENT OF MINES
OIL AND GAS DIVISION

Handwritten signature/initials in a circle

WELL RECORD

Oil or Gas Well Gas
(KIND)

Quadrangle Walton
 Permit No. 9584
 Company UNITED FUEL GAS CO.
 Address P.O. Box 1273, Charleston 25, W. Va.
 Farm P. M. Dodd Acres 150
 Location (waters) Little Sandy Creek
 Well No. 1105 Elev. 958.20'
 District Walton County Roane
 The surface of tract is owned in fee by _____
 Address _____
 Mineral rights are owned by Ida M. Robinson, et al
Poca Valley Bank Address Walton, W. Va.
 Drilling commenced 1-10-20
 Drilling completed 3-2-20
 Date Shot 3-8-20 From _____ To _____
 With 30qts.
 Open Flow _____ /10ths Water in _____ Inch
14 /10ths Merc. in 3 Inch
 Volume 1,500,000 Cu. Ft.
 Rock Pressure 255 lbs. _____ hrs.
 Oil _____ bbls., 1st 24 hrs.
 Fresh water _____ feet _____ feet
 Salt water 1448' feet _____ feet

Casing and Tubing	Used in Drilling	Left in Well	Packers
Size			
16			Kind of Packer _____
13			<u>Parmaco Anchor</u>
10		<u>18'8"</u>	Size of _____
8 1/2	<u>697'9"</u>	<u>174'5"</u>	<u>3x5-3/16x16</u>
6 5/8		<u>1857'6"</u>	Depth set _____
5 3/16		<u>2067'10"</u>	<u>1923'</u>
3			Perf. top _____
2			Perf. bottom _____
Liners Used			Perf. top _____
			Perf. bottom _____

CASING CEMENTED _____ SIZE _____ No. Ft. _____ Date _____

COAL WAS ENCOUNTERED AT _____ FEET _____ INCHES
 _____ FEET _____ INCHES _____ FEET _____ INCHES
 _____ FEET _____ INCHES _____ FEET _____ INCHES

Formation	Color	Hard or Soft	Top	Bottom	Oil, Gas or Water	Depth Found	Remarks
Sand & Soil			0	50			
Sand			355	390			
Little Dunkard			658	688			
Big Dunkard			693	790			
Sand			795	825	Hole filled with water		
Sand			870	893			
Sand			928	1052			
White Lime			1300	1370			
Salt Sand			1370	1770			
Little Lime			1770	1809			
Pencil Cave			1809	1819			
Big Lime			1819	1949			
Big Injun			1949	1997			
Total depth			2051'				



OCT 6 1955

