

*Foot*  
38° 40'  
383730

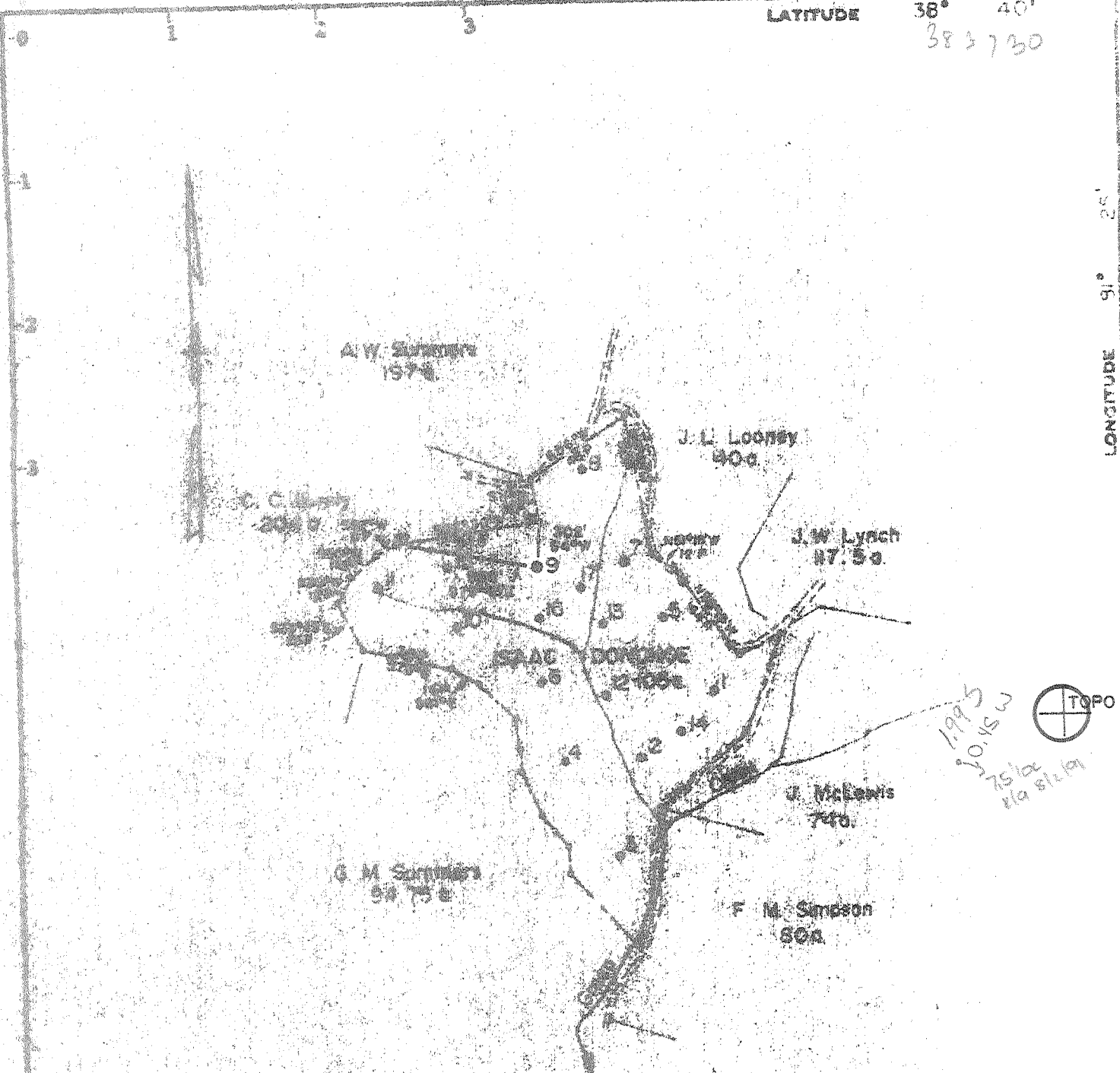

Scale of drawing 1 in. = 200'  
 PEANUT COMPANY RECORDS

*[Blacked out text]* to the best of my know-  
*[Blacked out text]* by paragraph 5 of the rules  
*[Blacked out text]* of the mining laws of West Virginia.

Geo. M. JAMES  
 111  
 Weston, W. Va.  
 26085

Map No. 70      858      W46

Company	PEANUT COMPANY
Address	P.O. Box 100, Beckley, W. Va. 26001
Farm	1000 AC
Tract	Acres 100      Issue No. 20754-50
Well (Farm) No.	9      Serial No.
Height (Spinal Level)	1000 ft
Quadrangle	WALTON
County	ROANE      District WALTON
Surveyor	CURTIS A. LUCAS
Surveyor's Registration No.	875
File No.	1500
Drawing No.	
Date	6-19-74      Scale 1" = 200'

STATE OF WEST VIRGINIA  
 DEPARTMENT OF MINES  
 OIL AND GAS DIVISION  
 CHARLESTON

WELL LOCATION MAP  
 FILE NO. ROA-1168-A

\* Depicts location of well on United States  
 Topographic Maps, scale 1 to 62,500, latitude  
 and longitude lines being represented by  
 dashed lines as shown.  
 -- Dashed one-inch spaces on border line of  
 original copies. **47 087**

66

(190)

J. S. SUMMERS - DONOHUE NO. 9 WELL.

Walton District, Beane County, W. Va.

By Louis F. Feyn Oil Co.

Contractor, Joshua Davis.

Elevation, 1047' L.

Drilling commenced Aug. 14, 1908; completed Sept. 21, 1908.

Shot Sept. 21, 1908, with 40 gts., at 2087-2112'; Nov. 1, 1911,

with 50 gts., at 2087-2112'; July 8, 1913, with 60 gts.,

at 2082-2105', bridged.

13" casing, 13' 10", 389'; 8 1/2", 875'; 6", 1941' (left in).

THIS NOTE appeared on record of Summers-Donohue No. 8 well;

Apr. 29, 1915, set tubing packer in Don. #9 165' from bottom.

Record in Eastern Petroleum Co. Well Record book of Clifton Oil & Gas Co.

	Top.	Bottom.
Little Dunkard Sand	840	- 865
Big Dunkard Sand	875	- 1000
First Salt Sand (water, 1550-1665')	1470	- ....
Little Line	1905	- ....
Pencil Cave	1936	- ....
Big Line	1941	- ....
Big Injun Sand (oil, 2080-2112')	2078	- 2110
Squaw Sand	2110	- 2112
Total depth		2112

87-31168

Form 534

FILE NO. Roa-1168-A

PENNZOIL UNITED, INC. - COMPLETION

SERIAL NO. FARM Isaac Donohoe WELL NO. 9
ELEVATION 1040.21' N. S. 58 E. W. 46
LEASE NO. ACRES 105
WATERS OF MAP NO. 70
DISTRICT Walton COUNTY Roane STATE W. Va.
DRILLING COMMENCED COMPLETED DEPTH

Table with 5 columns: SANDS, TOP, BOTTOM, ELEV. TOP, CASING. Includes rows for PGH. COAL OR BIG LIME and PACKERS AND DEPT. SET.

INITIAL PROD. SAND DEPTH
GAS TEST "
SHOT - FRAC. "
REMARKS
REPORTED BY AREA ABANDONED 10-11-74

Chatham Oil Co.

Sheet # 560 COMPLETION

SERIAL NO. FARM I.A. Donahue WELL No. 9
ELEVATION N. S. 58 E. W. 47
CONTRACTOR ACRES
WATERS OF Green Creek
DISTRICT Walton COUNTY Roane STATE W. Va.
DRILLING COMMENCED COMPLETED 9/29/08 DEPTH 2050

Table with 5 columns: SANDS, TOP, BOTTOM, ELEV. TOP, CASING. Includes rows for PGH. COAL OR BIG LIME and PACKERS AND DEPTH SET.

INITIAL PROD. 40 Bbls. SAND Injun DEPTH
GAS TEST "
SHOT QUARTS "
REMARKS Comp. in Injun
REPORTED BY ABANDONED
F. O. 533-5M-10-21

# WELL RECORD

87-31168  
-1168A

PRODUCTION FIRST 24  
HOURS FROM

Sand ..... Blbs. Approved.

Sand ..... Blbs. By ..... Supt.

IA Donohoe

..... FARM No. OF LEASE ..... No. ACRES

Walton ..... DISTRICT Noone ..... COUNTY W. Va. .... STATE

WELL No. 9 ..... DATE OF LOCATION ..... 19.....

RIG COMMENCED ..... 19.....  
 RIG COMPLETED ..... 19.....  
 DRILLING COMMENCED August 14 ..... 19. 08.....  
 DRILLING COMPLETED September 2.1 ..... 19. 08.....

*Jacksona Dennis* ..... CONTRACTOR  
 ..... CONTRACTOR

### CASING RECORD

Size	CHARGED TO WELL		PUT IN WELL		BOTTOM OF CASING		PULLED OUT OF WELL		LEFT IN WELL		TRANSFERRED Before Completion		LEFT AT WELL NOT IN USE	
	Feet	In.	Feet	In.	Feet	In.	Feet	In.	Feet	In.	Feet	In.	Feet	In.
13			13											
10			383											
8 1/4			875											
6 3/8			1941					1941						
5 1/2			1772					1772						

Formation	Top	Bottom	Remarks
Conductor			
Native Coal			Shot 9/21/08 70 qts 2087-2112
Pittsburgh Coal			" 11/1/11 ~ 50 " " "
Little Dunkard Sand	840	865	" 7/8/13 ~ 60 2082-2105 budget
Big Dunkard Sand	875	1000	
First Salt Sand	12470		
Second Salt Sand			
Water	1550	1665	
Maxon Sand			
Little Lime	1905	1936	
Pencil Cave	1936	1941	
Big Lime	1941	2078	
Big Injun Sand	2078	2110	
Gas			
First Pay			
Second Pay			
Water			
Squaw Sand	2110	2112	
Gantz Sand			
Fifty Foot Sand			
Thirty Foot Sand			
Gordon Stray Sand			ABANDONED ..... 19.....
Gordon Sand			Size Casing Pulled Casing Left In
Gas			
First Pay			
Second Pay			
Fourth Sand			
Fifth Sand			
Gas			REMARKS
Oil	2080	2112	
Bayard Sand			
Total Depth		2112	