



---

west virginia department of environmental protection

---

Office of Oil and Gas  
601 57<sup>th</sup> Street, S.E.  
Charleston, WV 25304  
(304) 926-0450  
fax: (304) 926-0452

Austin Caperton, Cabinet Secretary  
[www.dep.wv.gov](http://www.dep.wv.gov)

Thursday, May 17, 2018  
WELL WORK PLUGGING PERMIT  
Vertical Plugging

ICG TYGART VALLEY, LLC  
100 TYGART DR

GRAFTON, WV 26354

Re: Permit approval for J-1219  
47-091-00496-00-00

This well work permit is evidence of permission granted to perform the specified well work at the location described on the attached pages and located on the attached plat, subject to the provisions of Chapter 22 of the West Virginia Code of 1931, as amended, and all rules and regulations promulgated thereunder, and to any additional specific conditions and provisions outlined in the pages attached hereto. Notification shall be given by the operator to the Oil and Gas Inspector at least 24 hours prior to the construction of roads, locations, and/or pits for any permitted work. In addition, the well operator shall notify the same inspector 24 hours before any actual well work is commenced and prior to running and cementing casing. Spills or emergency discharges must be promptly reported by the operator to 1-800-642-3074 and to the Oil and Gas Inspector.

Upon completion of the plugging well work, the above named operator will reclaim the site according to the provisions of WV Code 22-6-30. Please be advised that form WR-38, Affidavit of Plugging and Filling Well, is to be submitted to this office within 90 days of completion of permitted well work, as should form WR-34 Discharge Monitoring Report within 30 days of discharge of pits, if applicable. Failure to abide by all statutory and regulatory provisions governing all duties and operations hereunder may result in suspension or revocation of this permit and, in addition, may result in civil and/or criminal penalties being imposed upon the operators.

Per 35 CSR 4-5.2.g this permit will expire in two (2) years from the issue date unless permitted well work is commenced. If there are any questions, please feel free to contact me at (304) 926- 0450.

James A. Martin  
Chief

Operator's Well Number: J-1219  
Farm Name: DRENNAN, CHARLES  
U.S. WELL NUMBER: 47-091-00496-00-00  
Vertical Plugging  
Date Issued: 5/17/2018

## PERMIT CONDITIONS

West Virginia Code §22-6-11 allows the Office of Oil and Gas to place specific conditions upon this permit. Permit conditions have the same effect as law. Failure to adhere to the specified permit conditions may result in enforcement action.

### CONDITIONS

---

1. All pits must be lined with a minimum of 20 mil thickness synthetic liner.
2. In the event of an accident or explosion causing loss of life or serious personal injury in or about the well or while working on the well, the well operator or its contractor shall give notice, stating the particulars of the accident or explosion, to the oil and gas inspector and the Chief within twenty-four (24) hours.
3. Well work activities shall not constitute a hazard to the safety of persons.

- 1) Date April 18, 2018
- 2) Operator's Well No. J-1219
- 3) API Well No. 47-91 - 0496

STATE OF WEST VIRGINIA  
DEPARTMENT OF ENVIRONMENTAL PROTECTION  
OFFICE OF OIL AND GAS

APPLICATION FOR A PERMIT TO PLUG AND ABANDON

- 4) Well Type: Oil \_\_\_ / Gas \_\_\_ / Liquid injection \_\_\_ / Waste disposal \_\_\_ /  
(If "Gas, Production \_\_\_ or Underground storage \_\_\_) Deep \_\_\_ / Shallow X
- 5) Location: Elevation 1560' Watershed Swamp Run  
District Knottsville County Taylor Quadrangle Thornton (638)
- 6) Well Operator ICG Tygart Valley, LLC 7) Designated Agent Charles E. Duckworth  
Address 100 Tygart Drive Address 100 Tygart Drive  
Grafton, WV 26354 Grafton, WV 26354
- 8) Oil and Gas Inspector to be notified Name Kenneth Greynolds 9) Plugging Contractor Name Coastal Drilling East, LLC  
Address 613 Broad Run Road Address 130 Meadows Ridge Road  
Jane Lew, WV 26378 Mt. Morris, PA 15349

10) Work Order: The work order for the manner of plugging this well is as follows:  
**See Exhibit Nos. 1 and 2 and MSHA 101-C Exemption**

ICG Tygart Valley, LLC (47-091-01089)  
Leer Mine (MSHA ID# 46-09192)  
MSHA 101-C Docket No. M-2012-065-C

Appropriate coal seam top = 576.9'  
Approximate coal seam bottom = 580.6'

RECEIVED  
Office of Oil and Gas  
  
MAY 01 2018  
  
WV Department of  
Environmental Protection

Notification must be given to the district oil and gas inspector 24 hours before permitted work can commence.

Work order approved by inspector *Linda L. [Signature]* Date 4-20-18

05/18/2018

---

EXHIBIT NO. 1

---

From the experience and technology developed since 1970 in plugging oil and gas wells for mining through, ICG Tygart Valley, LLC will utilize the following method to plug all future wells.

**SOLID PLUG METHOD**

- ★ a) If active well: clean out to total depth and plug back according to state regulations to a minimum of 200 feet below lowest minable coal seam.
- b) If abandoned well: clean out to first plug 200 feet below lowest minable coal seam.
- c) Circulate through tubing or drill steel an expanding cement plug from a minimum of 200 feet below minable coal seam to a point 100 feet above minable coal.

Circulate through tubing or drill steel from 100 feet above coal seam to surface.

A monument will be installed with API No. and stating "solid plug".

RECEIVED  
Office of Oil and Gas  
MAY 01 2018  
WV Department of  
Environmental Protection

EXHIBIT No. 2

Coastal Drilling East LLC • 130 Meadow Ridge Road, Mt. Morris, PA 15349

Phone 304-296-1120 Fax 304-413-0061

"A Shaft Drillers International Company"

05/26/2016

Mr. Chuck Duckworth  
 Gas Well & Property Manager  
 Arch Coal, Inc. – Leer Mine Complex  
 100 Tygart Drive  
 Grafton, WV 26354

Mr. Duckworth,

Below is the proposed plugging plan we discussed that can be used on wells similar to the wells we have been plugging for the last few years.

Plugging Plan

- Move to site, rig up, mix mud, drill rathole
- Attempt to clean out well to original total depth (TD).
- Run cement bond log on 4 ½" casing to determine top of cement
- Set bottom hole cement plug as required by the WV DEP from PBTD (5450) TO TOP OF cement determined by the bond log.
- Tag top of bottom hole plug to insure plug is at correct depth. Re-cement if necessary.
- Cut and pull 4 ½" casing from the free point determined by the bond log.
- Clean out wellbore to top of remaining 4 ½" casing
- Run suite of logs to determine casing size, bottom of casing, depth of coal seams, deviation of wellbore and cement bond to casing.
- Cement hole from top of bottom hole plug to a depth within 200' of the bottom of the 8 5/8" casing.
- If necessary cut and pull any free casing. 8 5/8" WAS CEMENTED TO SURFACE
- Perforate, cut, rip or mill any remaining casing at depths determined by MSHA's 101C Petition.

1043'

CEMENT WITH EXPANDING CEMENT FROM 200' BELOW 8 5/8" TO 100'  
 INTO 8 5/8" @ 1043'. FROM THIS POINT FOLLOW MSHA 101C PETITION.

05/18/2018

RECEIVED  
Office of Oil and Gas

MAY 01 2018

WV Department of  
Environmental Protection

- Cement hole from top of intermediate plug to surface using cement required by MSHA's 101C Petition.
- Rig down and set monument as required by WV DEP.

RECEIVED  
Office of Oil and Gas  
MAY 01 2018  
WV Department of  
Environmental Protection

MSHA 101 C EXEMPTION

RECEIVED  
Office of Oil and Gas

MAY 01 2018

27088

Federal Register/Vol. 77, No. 89/Tuesday, May 8, 2012/Notices

WV Department of  
Environmental Protection

face area will be available. The fire hose will be located near the working face.

(5) Sufficient supplies of roof support and ventilation materials will be available and located near the working face. In addition, an emergency plug and/or plugs will be available within the immediate area of the well intersection.

(6) Equipment involved in mining through the well will be checked for permissibility and serviced on the maintenance shift prior to mining through the well. The methane monitor on the continuous mining machine involved in mining through the well will also be calibrated on the maintenance shift prior to mining through the well.

(7) When mining is in progress, tests for methane will be made with a handheld methane detector at least every 10 minutes, from the time that mining with the continuous mining machine is within 30 feet of the well until the well is intersected, and immediately prior to mining through. During the actual cutting-through process, no individual will be allowed on the return side until mining-through has been completed and the area has been examined and declared safe.

(8) The working area will be free from accumulations of coal dust and coal spillages, and rock dust will be placed on the roof, rib, and floor to within 20 feet of the face when mining through the well.

(9) When the well is intersected, all equipment will be deenergized and the place thoroughly examined and determined safe before mining is resumed.

(10) Any casing will be removed and no open flame will be permitted in the area until adequate ventilation has been established around the well.

(11) After a well has been intersected and the working place determined safe, mining will continue in by the well at a distance sufficient to permit adequate ventilation around the area of the well.

(12) No person will be permitted in the area of the mining-through operation except those actually engaged in the operation, company personnel, personnel from MSHA, and personnel from the Kentucky OMSL.

(13) The mining-through operation will be under the direct supervision of a certified individual. Instructions concerning the mining-through operation will be issued only by the certified individual in charge. MSHA personnel may interrupt or halt the mining through operation when necessary for the safety of the miners.

(14) Within 30 days after this Order becomes final, the petitioner will submit

proposed revisions for its approved mine emergency evacuation and firefighting plan required by 30 CFR 75.1501. The petitioner will revise the plans to include the hazards and evacuation procedures to be used for well intersections.

The petitioner further states that this petition will apply to all types of mining (conventional, continuous, and longwall) and asserts that the proposed alternative method will at all times provide a measure of protection no less than that of the existing standard.

*Docket Number: M-2012-064-C.*  
*Petitioner: Lone Mountain Processing, Inc., Drawer C, St. Charles, Virginia 24282.*

*Mine: Mine No. 1, MSHA I.D. No. 15-18734, Route 636 Benedict Road, St. Charles, Virginia 24282, located in Haylan County, Kentucky.*

*Regulation Affected: 30 CFR 75.208 (Warning devices).*

*Modification Request: The petitioner requests a modification of the existing standard to permit a readily visible warning to be posted at the second row of permanent roof support outby unsupported roof or a physical barrier to be installed to impede travel beyond permanent support, except during the installation of roof supports. The petitioner states that:*

(1) The Kentucky Office of Mine Safety and Licensing requires "a warning device to be installed on the second row of permanent roof support outby unsupported roof."

(2) MSHA's approved Precautions for Remote Control Operation of Continuous Mining Machines states that "While using remote controls, the continuous mining machine operator and all other persons will position themselves no closer than the second 'full row' of installed roof bolts outby the face."

(3) This petition is necessary to improve safety and to attain commonality between State and Federal regulations.

(4) Safety increases when the distance an employee keeps from unsupported roof increases.

The petitioner asserts that the proposed alternative method will at all times guarantee no less than the same measure of protection afforded by the existing standard.

*Docket Number: M-2012-065-C.*  
*Petitioner: ICG Tygart Valley, LLC, 1200 Tygart Drive, Grafton, West Virginia 26354.*

*Mine: Tygart #71 Mine, MSHA I.D. No. 46-09192, located in Taylor County, West Virginia.*

*Regulation Affected: 30 CFR 75.1700 (Oil and gas wells).*

*Modification Request: The petitioner requests a modification of the existing standard requiring that barriers be established and maintained around oil and gas wells penetrating coalbeds or underground areas of coal mines to permit an alternative method of compliance. The petitioner states that:*

(1) The mine is projected to encounter vertical in-seam boreholes, typical to oil and natural gas wells, as mine development progresses.

(2) The active development section is approaching these boreholes, and is projected to encounter additional boreholes in the future as mining operations continue.

(3) The procedure presented in this petition will be used to ensure that mining through these boreholes is accomplished safely and, as an alternative to compliance with 30 CFR 75.1700, will provide no less than the same measure of protection to the miners, as required by the MSHA standard.

The petitioner proposes to use the following procedures when plugging oil or gas wells:

(1) Prior to plugging an oil or gas well, a diligent effort will be made to clean the borehole to the original total depth. If this depth cannot be reached, the borehole will be cleaned out to a depth that would permit the placement of at least 200 feet of expanding cement below the base of the lowest minable coal bed.

(2) When cleaning the borehole, a diligent effort will be made to remove all of the casing in the borehole. If it is not possible to remove all of the casing, the casing that remains will be perforated or ripped at intervals spaced close enough to permit expanding cement slurry to infiltrate the annulus between the casing and the borehole wall for a distance of at least 200 feet below the base of the lowest minable coal bed.

(3) If the cleaned-out borehole produces gas, a mechanical bridge plug will be placed in the borehole in a competent stratum at least 200 feet below the base of the lowest minable coal bed, but above the top of the uppermost hydrocarbon-producing stratum. If it is not possible to set a mechanical bridge plug, a substantial brush plug may be used in its place.

The District Manager may allow the use of other effective methods of stopping any and all gas flow emitting from the wellbore before placement of cement through the minable coal seam(s). Such approval will be documented in a written response to the operators' submittal of a detailed explanation of the method to be used

and an engineering evaluation of the relative effectiveness of the alternative.

(4) A suite of logs will be made, consisting of a caliper survey, directional deviation survey, and log(s) suitable for determining the top and bottom of the lowest minable coal bed and potential hydrocarbon-producing strata and the location for the bridge plug.

(5) If the uppermost hydrocarbon-producing stratum is within 200 feet of the base of the lowest minable coal bed, properly placed mechanical bridge plugs or a suitable brush plug described in paragraph (3) above will be used to isolate the hydrocarbon-producing stratum from the expanding cement plug. Nevertheless, a minimum of 200 feet of expanding cement will be placed below the lowest minable coal bed.

(6) The wellbore will be completely filled and circulated with a gel that inhibits any flow of gas, supports the walls of the borehole, and increases the density of the expanding cement. This gel will be pumped through open-end tubing run to a point approximately 20 feet above the bottom of the cleaned out area of the borehole or bridge plug.

The petitioner proposes to use the following procedures when plugging gas and oil wells to the surface:

(1) A cement plug will be set in the wellbore by pumping expanding cement slurry down the tubing to displace the gel and fill the borehole to the surface. As an alternative, the cement slurry may be pumped down the tubing so that the borehole is filled. There will be at least 200 feet of expanding cement below the base of the lowest minable coal bed.

(2) A marker conforming to the requirements of the state regulatory authority will be installed at the borehole, or a small quantity of steel turnings or other small magnetic particles will be embedded in the top of the cement near the surface. The method used will be suitable to serve as a permanent magnetic monument of the borehole.

The following procedures will be used for the vent pipe method for plugging oil and gas wells:

(1) A 4 1/2-inch or larger pipe will be run into the wellbore to a depth of 100 feet below the lowest minable coal bed and wedged to a smaller diameter pipe that, if desired, will extend to a point approximately 20 feet above the bottom of the cleaned-out area of the borehole or bridge plug.

(2) A cement plug will be set in the wellbore by pumping expanding cement slurry, Portland cement, or a Portland cement-fly ash mixture down the tubing to displace the gel so that the borehole is filled with cement. The borehole and

the vent pipe will be filled with expanding cement for a minimum of 200 feet below the base of the lowest minable coal bed. The top of the expanding cement will extend upward to a point approximately 100 feet above the top of the lowest minable coal bed.

(3) All fluid will be evacuated from the vent pipe to facilitate testing for gases. During the evacuation of fluid, the expanding cement will not be disturbed.

(4) The top of the vent pipe will be protected to prevent liquids or solids from entering the wellbore, but permit ready access to the full internal diameter of the vent pipe when necessary.

The petitioner proposes to use the following procedures when plugging oil or gas wells for subsequent use as degasification boreholes:

(1) A cement plug will be set in the wellbore by pumping expanding cement slurry down the tubing to displace the gel and provide at least 200 feet of expanding cement below the lowest minable coal bed. The top of the expanding cement will extend upward to a point above the top of the coal bed being mined. This distance will be based on the average height of the roof strata breakage for the mine.

(2) To facilitate methane drainage, degasification casing of suitable diameter, slotted or perforated throughout its lower 150 to 200 feet, will be set in the borehole to a point 10 to 30 feet above the top of the expanding cement.

(3) The annulus between the degasification casing and the borehole wall will be cemented from a point immediately above the slots or perforations to the surface.

(4) The degasification casing will be cleaned out for its total length.

(5) The top of the degasification casing will be fitted with a wellhead equipped as required by the District Manager. Such equipment may include check valves, shut-in valves, sampling port, flame arrestor equipment, and security fencing.

The following alternative procedures for preparing and plugging oil and gas wells will apply to wells that the petitioner and the District Manager agree cannot be completely cleaned out due to damage to the well caused by subsidence, caving, or other factors; as determined by the petitioner and agreed to by the District Manager. These provisions will apply unless alternative measures are agreed upon and based upon a plan submitted to the District Manager:

(1) The petitioner will drill a hole adjacent and parallel to the well to a

depth of at least 200 feet below the lowest minable coal seam.

(2) The petitioner will use a geophysical sensing device to locate any casing that may remain in the well.

(3) If the well contains casing(s), the petitioner will drill into the well from the parallel hole. From 10 feet below the coal seam to 10 feet above the coal seam, the petitioner will perforate or rip all casings at intervals of at least 5 feet. Beyond this distance, the petitioner will perforate or rip at least every 50 feet from at least 200 feet below the base of the lowest minable coal seam up to 100 feet above the seam being mined. The petitioner will fill the annulus between the casing, and between the casings and the well wall with expanding cement (minimum 0.5 percent expansion upon setting), and will ensure that these areas contain no voids. If the petitioner, using a casing bond log, can demonstrate to the satisfaction of the District Manager that the annulus of the well is adequately sealed with cement, then the petitioner will not be required to perforate or rip the casing for that particular well or fill these areas with cement. When multiple casing and tubing strings are present in the coal horizon(s), any casing that remains will be ripped or perforated and filled with expanding cement as indicated above. An acceptable casing bond log for each casing and tubing string is needed if used in lieu of ripping or perforating multiple strings.

(4) Where the petitioner determines and the District Manager agrees that there is insufficient casing in the well to allow the method outlined in paragraph (3) above to be used, then the petitioner will use a horizontal hydraulic fracturing technique to intercept the original well. From at least 200 feet below the base of the lowest minable coal seam to a point at least 50 feet above the seam being mined, the petitioner will fracture at least six places at intervals to be agreed upon by the petitioner and the District Manager after considering the geological strata and the pressure within the well. The petitioner will then pump expanding cement into the fractured well in sufficient quantities and in a manner that fills all intercepted voids.

(5) The petitioner will prepare down-hole logs for each well. The logs will consist of a caliper survey and log(s) suitable for determining the top, bottom, and thickness of all coal seams and potential hydrocarbon-producing strata and the location for the bridge plug. The petitioner may obtain the logs from the adjacent hole rather than the well if the condition of the well makes it impractical to insert the equipment



necessary to obtain the log. The District Manager may approve the use of a down-hole camera survey in lieu of down-hole logs if, in his or her judgment, such logs would not be suitable for obtaining the data or are impractical to obtain due to the condition of the drill hole. A journal will be maintained describing the length and type material used to plug the well; the length of casing(s) removed, perforated, or ripped or left in place; and other pertinent information concerning sealing the well.

(6) After the petitioner has plugged the well, the petitioner will plug the open portions of both holes from the bottom to the surface with Portland cement or a lightweight cement mixture. The petitioner will embed steel turnings or other small magnetic particles in the top of the cement near the surface to serve as a permanent magnetic monument of the well. In the alternative, a 4½-inch or larger casing set in cement will extend at least 36 inches above the ground level. A combination of the methods outlined in paragraph (3) and (4) above may have to be used in a single well, depending upon the conditions of the hole and the presence of casings. The petitioner and the District Manager may discuss the nature of each hole and the District Manager may require the use of more than one method.

The petitioner proposes to use the following cut-through procedures whenever the safety barrier diameter is reduced to a distance less than the District Manager would approve pursuant to § 75.1700 or the petitioner proceeds with an intent to cut through a plugged well:

(1) Prior to reducing the safety barrier to a distance less than the District Manager would approve or proceeding with intent to cut through a plugged well, the petitioner will notify the District Manager.

(2) Mining in close proximity to or through a plugged well will be done on a shift approved by the District Manager.

(3) The District Manager, a representative of the miners, and the appropriate States agency will be notified by the operator in sufficient time prior to the mining-through operation to provide an opportunity for them to have a representative present.

(4) When using continuous mining equipment, drifage sights will be installed at the last open crosscut near the place to be mined to ensure intersection of the well. The drifage sights will not be more than 50 feet from the well. When using longwall mining methods, drifage sights will be installed

on 10-foot centers for a distance of 50 feet in advance of the well bore. The drifage sights will be installed in the headgate and tailgate.

(5) Firefighting equipment, including fire extinguishers, rock dust, and sufficient fire hose to reach the working face area of the mining-through will be available when either the conventional or continuous mining method is used. The fire hose will be located in the last open crosscut of the entry or room. All fire hoses will be ready for operation during the mining-through.

(6) Sufficient supplies of roof support and ventilation materials will be available and located at the last open crosscut. In addition, an emergency plug and/or plugs will be available in the immediate area of the cut-through.

(7) The quantity of air required by the approved mine ventilation plan, but not less than 6,000 cubic feet per minute (cfm) of air for scrubber-equipped continuous miners or not less than 9,000 cfm for continuous miner sections using auxiliary fans or line brattice only, will be used to ventilate the working face during the mining-through operation. The quantity of air required by the ventilation plan, but not less than 30,000 cfm, will reach the working face of each longwall during the mining-through operation.

(8) Equipment will be checked for permissibility and serviced on the shift prior to mining-through the well. The methane monitors on the continuous mining machine or the longwall shear and face will be calibrated on the shift prior to mining through the well.

(9) When mining is in progress, tests for methane will be made with a hand-held methane detector at least every 10 minutes from the time that mining with the continuous mining machine is within 30 feet of the well until the well is intersected and immediately prior to mining through. When mining with longwall mining equipment, tests for methane will be made at least every 10 minutes when the longwall face is within 10 feet of the well. During the actual cutting-through process, no individual will be allowed on the return side until mining through has been completed and the area has been examined and declared safe.

(10) When using continuous mining methods, the working area will be free from accumulations of coal dust and coal spillages, and rock dust will be placed on the roof, rib, and floor to within 20 feet of the face when mining through or near the well on the shift or shifts during which the cut-through will occur. On longwall sections, rock-dusting will be conducted and placed

on the roof, rib, and floor up to both headgate and tailgate gob.

(11) When the wellbore is intersected, all equipment will be deenergized and the area thoroughly examined and determined safe before mining is resumed. Any well casing will be removed and no open flame will be permitted in the area until adequate ventilation has been established around the wellbore.

(12) After a well has been intersected and the working area determined safe, mining will continue in by the well at a distance sufficient to permit adequate ventilation around the area of the wellbore.

(13) No person will be permitted in the area of the mining-through operation except those actually engaged in the operation, company personnel, representatives of the miners, personnel from MSHA, and personnel from the appropriate State agency.

(14) The mining-through operation will be under the direct supervision of a certified official. Instructions concerning the mining-through operation will be issued only by the certified official in charge. MSHA personnel may interrupt or halt the mining-through operation when necessary for the safety of the miners.

(15) The petitioner will file a plugging affidavit setting forth the persons who participated in the work, a description of the plugging work, and a certification by the petitioner that the well has been plugged as described.

(16) Within 60 days after the Proposed Decision and Order (PDO) becomes final, the petitioner will submit proposed revisions for its approved 30 CFR Part 48 training plan to the District Manager. The provisions will include initial and refresher training regarding compliance with the terms and conditions stated in the PDO.

The petitioner asserts that the proposed alternative method will at all times guarantee miners no less than the same measure of protection as afforded by the existing standard.

*Docket Number:* M-2012-002-M.

*Petitioner:* Hecla Greens Creek Mining Company, P.O. Box 32199, Juneau, Alaska 99803.

*Mine:* Greens Creek Mine, MSHA I.D. No. 50-01267, located in Juneau County, Alaska.

*Regulation Affected:* 30 CFR 57.14130 (Roll-over protective structures (ROPS) and seat belts for surface equipment).

*Modification Request:* The petitioner requests a modification of the existing standard to permit employees to be transported 1,600 feet to and from the surface dry facility to work sites underground using underground mine

91-00496P



IV-35 (Rev 8-81)

RECEIVED  
AUG 27 1985

State of West Virginia

Department of Mines  
Oil and Gas Division

DIVISION OF OIL & GAS  
DEPARTMENT OF ENERGY

Date August 22, 1985  
Operator's Well No. J-1219  
Farm Drennan  
API No. 47 - 091 - 0496

RECEIVED  
Office of Oil and Gas  
AUG 01 2018  
WV Department of  
Environmental Protection

WELL OPERATOR'S REPORT  
OF

DRILLING, FRACTURING AND/OR STIMULATING, OR PHYSICAL CHANGE

WELL TYPE: Oil / Gas x / Liquid Injection / Waste Disposal /  
(If "Gas," Production x / Underground Storage / Deep / Shallow x /)

LOCATION: Elevation: 1560 Watershed Swamp Run  
District: Knottsville County Taylor Quadrangle Thornton

COMPANY J&J Enterprises, Inc.  
ADDRESS P.O. Box 48, Buckhannon, WV 26201  
DESIGNATED AGENT Richard Reddecliff  
ADDRESS P.O. Box 48, Buckhannon, WV 26201  
SURFACE OWNER Charles Drennan, Jr.  
ADDRESS Rt. # 3, Box 48, Grafton, WV 26354  
MINERAL RIGHTS OWNER Same as surface  
ADDRESS  
OIL AND GAS INSPECTOR FOR THIS WORK Donald  
2604 Crab Apple Lane  
Ellis ADDRESS Fairmont, WV 26554

Casing & Tubing	Used in Drilling	Left in Well	Cement fill up Cu. ft.
Size 20-16 Cord.			
13-10"	20	0	0 sks.
9 5/8			
8 5/8	1143.15	1143.15	275 sks.
7			
5 1/2			
4 1/2	5490.75	5490.75	375 sks.
3			
2			
Liners used			

CTS

PERMIT ISSUED 5/22/85  
DRILLING COMMENCED 6/13/85  
DRILLING COMPLETED 6/20/85

IF APPLICABLE: PLUGGING OF DRY HOLE ON CONTINUOUS PROGRESSION FROM DRILLING OR REWORKING. VERBAL PERMISSION OBTAINED ON

GEOLOGICAL TARGET FORMATION Haverly Depth 5555-5640 feet  
Depth of completed well 5972 feet Rotary x / Cable Tools  
Water strata depth: Fresh 60,625 feet; Salt 0 feet  
Coal seam depths: 160-62,515-17 Is coal being mined in the area? No

OPEN FLOW DATA  
Producing formation 4th Elk Pay zone depth 5334-57 feet  
Gas: Initial open flow Mcf/d Oil: Initial open flow Bbl/d  
Combined Final open flow (492) Mcf/d Final open flow Bbl/d  
Time of open flow between initial and final tests 4 hours  
Static rock pressure 1450 psig (surface measurement) after 96 hours shut in  
(If applicable due to multiple completion--)  
Second producing formation 3rd ELK & Benson Pay zone depth 5033-37 / 4410-12 feet  
Gas: Initial open flow Mcf/d Oil: Initial open flow Bbl/d  
Final open flow Mcf/d Oil: Final open flow Bbl/d  
Time of open flow between initial and final tests hours  
Static rock pressure psig (surface measurement) after hours shut in

(Continue on reverse side)

SEP 09 1985

05/18/2018

DETAILS OF PERFORATED INTERVALS, FRACTURING OR STIMULATING, PHYSICAL CHANGE, ETC.

Benson: Perforations: 4410-12 ( 8 holes)  
 Fracturing: 400 sks. 20/40 sand: 500 gal. acid: 591 Bbls. fluid.  
 3rd. Elk: 5033-37. (16 holes)  
 Fracturing: 350 sks. 20/40 sand: 500 gal. acid: 596 Bbls. fluid.  
 4th Elk: Perforations: 5334-36 ( 8 holes) 5353-57-( 8 holes)  
 Fracturing: 300 sks. 20/40 sand: 530 Bbls. fluid.

BOTTOM HOLE PRESSURE Pf=Pwe  $\frac{XGLS}{1}$

$$t=60 + (0.0075 \times 5491) + 459.7 = 561 \quad X=53.35 \times 561 = 29929 \quad = 0.000033 \quad Pf=1450 \times 2.72^{(0.000033)}$$

$$(0.670)(4884)(0.5) = 1450 \times 2.72^{0.1} = 1450 \times 1.1$$

Pf=1595 psi

WELL LOG

RECEIVED  
Office of Oil and Gas  
MAY 01 2018

WV Department of  
Environmental Protection

FORMATION	COLOR	HARD OR SOFT	TOP FEET	BOTTOM FEET	REMARKS Including indication of all fresh and salt water, coal, oil and gas
KB- Ground Level			0	10	
Soil, shale & red rock			10	140	
Sand & shale			140	160	
Coal			160	162	1/2" stream @ 60'
Sand & shale			162	330	1/2" stream @ 625'
Sand & shale			330	515	
Coal			515	517	Gas ck @ 1607 No show
Sand & shale			517	705	
Sand & shale			705	1050	Gas ck @ 1732 No show
Sand, shale & red rock			1050	1140	
Sand & shale			1140	1345	Gas ck @ 2462 No show
Little Lime			1345	1365	
Sand			1365	1380	Gas ck @ 3253 No show
Big Lime & Injun. gk.			1380	1570	
Sand, shale & red rock			1570	2385	Gas ck @ 3411 No show
Sand & shale			2385	3140	
Sand & shale			3140	4410	Gas ck @ 4170 No show
Benson			4410	4412	
Sand & shale			4412	5033	Gas ck @ 4390 No show
3rd Elk			5033	5037	
Sand & shale			5037	5334	Gas ck @ 5430 No show
4th Elk			5334	5357	
Sand & shale			5357	5555	Gas ck @ 5749 2/10-1/2" w/water 2,333 cu.ft.
Haverty			5555	5640	
Sand & shale			5640	5972	Gas ck @ T.D. 4/10-1/2" w/water 3,735 cu.ft.
				T.D.	

(Attach separate sheets as necessary)

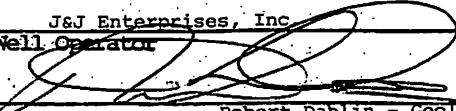
J&J Enterprises, Inc  
 Well Operator  
 By:   
 Date: 8/22/85 Robert Dahlin - Geologist

Note: Regulation 2.02(i) provides as follows:  
 "The term 'log' or 'well log' shall mean a systematic  
 detailed geological record of all formations, including  
 and encountered in the drilling of a well."

STATE OF WEST VIRGINIA  
DEPARTMENT OF ENVIRONMENTAL PROTECTION  
OFFICE OF OIL AND GAS

CONSTRUCTION AND RECLAMATION PLAN AND SITE REGISTRATION APPLICATION FORM  
GENERAL PERMIT FOR OIL AND GAS PIT WASTE DISCHARGE

Operator Name ICG Tygart Valley, LLC OP Code \_\_\_\_\_

Watershed Swamp Run Quadrangle Thornton (638)

Elevation 1560' County Taylor District Knottsville

Description of anticipated Pit Waste: N/A

Will a synthetic liner be used in the pit? N/A

Proposed Disposal Method For Treated Pit Wastes:

- Land Application
- Underground Injection ( UIC Permit Number \_\_\_\_\_ )
- Reuse (at API Number \_\_\_\_\_ )
- Off Site Disposal (Supply form WW-9 for disposal location)
- Other (Explain Tanks - See attached letter)

Proposed Work For Which Pit Will Be Used:

- Drilling
- Workover
- Other (Explain \_\_\_\_\_)
- Swabbing
- Plugging

I certify that I understand and agree to the terms and conditions of the GENERAL WATER POLLUTION PERMIT issued on August 1, 2005, by the Office of Oil and Gas of the West Virginia Department of Environmental Protection. I understand that the provisions of the permit are enforceable by law. Violations of any term or condition of the general permit and/or other applicable law or regulation can lead to enforcement action.

I certify under penalty of law that I have personally examined and am familiar with the information submitted on this application form and all attachments thereto and that, based on my inquiry of those individuals immediately responsible for obtaining the information, I believe that the information is true, accurate, and complete. I am aware that there are significant penalties for submitting false information, including the possibility of fine or imprisonment.

Company Official Signature \_\_\_\_\_  
Company Official (Typed Name) Charles E. Duckworth  
Company Official Title Designated Agent

RECEIVED  
Office of Oil and Gas

MAY 01 2018

WV Department of  
Environmental Protection

Subscribed and sworn before me this 18th day of April, 2018

Thomas Gregory Nair

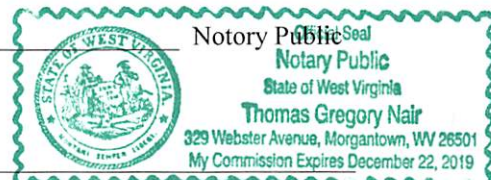

My commission expires December 22, 2019

05/18/2018

**LEGEND**

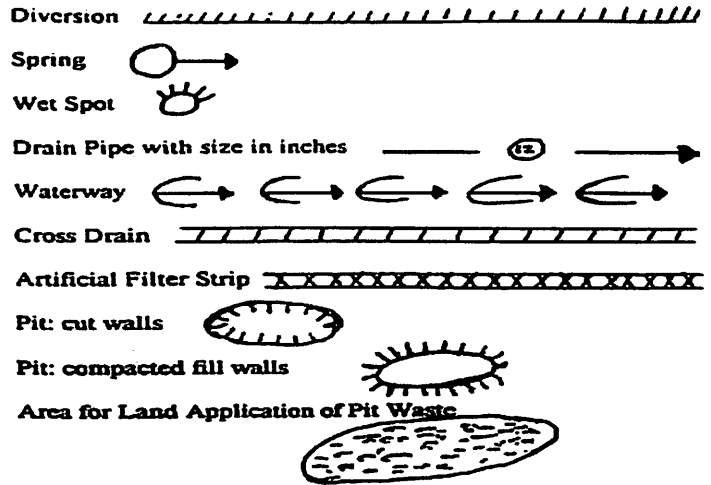
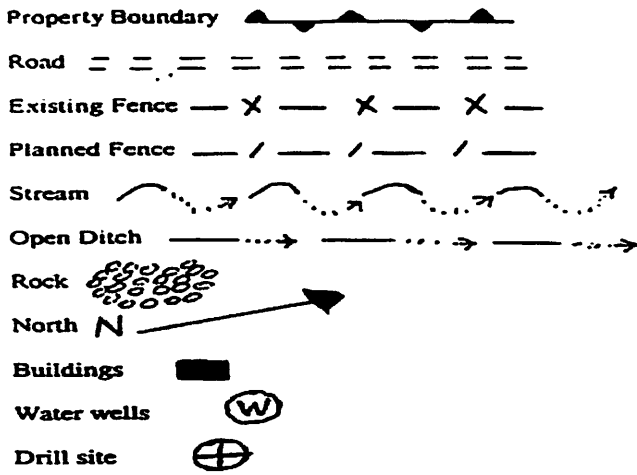

Proposed Revegetation Treatment: Acres Disturbed 1.50/2.0 Prevegetation pH \_\_\_\_\_

Lime 3 Tons/acre or to correct to pH 6.5

Fertilizer (10-20-20 or equivalent) 500 lbs/acre (500 lbs minimum)

Mulch Hay Bales Tons/acre

Seed Mixtures

Area I		Area II	
Seed Type	lbs/acre	Seed Type	lbs/acre
Orchard Grass	12	Orchard Grass	12
Landino Clover	3	Landino Clover	3
Timothy	10	Timothy	10

Attach:  
Drawing(s) of road, location, pit and proposed area for land application.

Photocopied section of involved 7.5' topographic sheet.

See attached

RECEIVED  
Office of Oil and Gas  
MAY 01 2018

Plan Approved by: *Edward L. Sawyer*

WV Department of  
Environmental Protection

Comments: RECLAIM, RESEED & MULCH AS AP

Title: OIL & GAS INSPECTOR

Date: 4-20-18

Field Reviewed? ( ) Yes ( ✓ ) No

91-00496P

WW-4A  
Revised 6-07

1) Date: April 18, 2018  
2) Operator's Well Number  
J-1219  
3) API Well No.: 47 - 91 - 0496

**STATE OF WEST VIRGINIA**  
**DEPARTMENT OF ENVIRONMENTAL PROTECTION, OFFICE OF OIL AND GAS**  
**NOTICE OF APPLICATION TO PLUG AND ABANDON A WELL**

4) Surface Owner(s) to be served:	5) (a) Coal Operator
(a) Name <u>Charles F. Jr., &amp; Betty Drennan</u>	Name <u>CoalQuest Development, LLC</u>
Address <u>651 Haislip Farm Road</u>	Address <u>100 Tygart Drive</u>
<u>Grafton, West Virginia 26354</u>	<u>Grafton, West Virginia 26354</u>
(b) Name _____	(b) Coal Owner(s) with Declaration
Address _____	Name _____
(c) Name _____	Address _____
Address _____	Name _____
6) Inspector <u>Kenneth Greynolds</u>	(c) Coal Lessee with Declaration
Address <u>613 Broad Run Road</u>	Name _____
<u>Jane Lew, WV 26378</u>	Address _____
Telephone <u>(304) 206-6613</u>	_____

RECEIVED  
Office of Oil and Gas  
MAY 01 2018  
WV Department of  
Environmental Protection

**TO THE PERSONS NAMED ABOVE:** You should have received this Form and the following documents:

- (1) The application to Plug and Abandon a Well on Form WW-4B, which sets out the parties involved in the work and describes the well its and the plugging work order; and
- (2) The plat (surveyor's map) showing the well location on Form WW-6.

The reason you received these documents is that you have rights regarding the application which are summarized in the instructions on the reverses side. However, you are not required to take any action at all.

Take notice that under Chapter 22-6 of the West Virginia Code, the undersigned well operator proposes to file or has filed this Notice and Application and accompanying documents for a permit to plug and abandon a well with the Chief of the Office of Oil and Gas, West Virginia Department of Environmental Protection, with respect to the well at the location described on the attached Application and depicted on the attached Form WW-6. Copies of this Notice, the Application, and the plat have been mailed by registered or certified mail or delivered by hand to the person(s) named above (or by publication in certain circumstances) on or before the day of mailing or delivery to the Chief.

Well Operator ICG Tygart Valley, LLC

By: Charles E. Duckworth

Its: Designated Agent

Address 100 Tygart Drive  
Grafton, West Virginia 26354

Telephone (304) 265-9704

Subscribed and sworn before me this 18th day of April 2018

My Commission Expires December 22, 2019

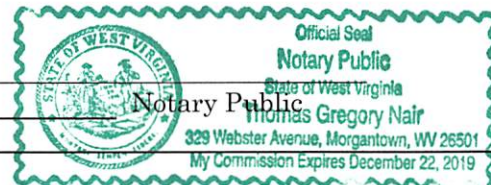

**Oil and Gas Privacy Notice**

The Office of Oil and Gas processes your personal information, such as name, address and phone number, as a part of our regulatory duties. Your personal information may be disclosed to other State agencies or third parties in the normal course of business or as needed to comply with statutory or regulatory requirements, including Freedom of Information Act requests. Our office will appropriately secure your personal information. If you have any questions about our use of your personal information, please contact DEP's Chief Privacy Officer at [depprivacyoffier@wv.gov](mailto:depprivacyoffier@wv.gov).

05/18/2018

**POWER OF ATTORNEY**  
**ICG TYGART VALLEY, LLC**  
**TO**  
**GREG NAIR**

**Dated: January 1, 2018**

**Expires: December 31, 2018**

KNOW ALL MEN BY THESE PRESENTS: That ICG Tygart Valley, LLC, a limited liability company formed under the laws of the State of Delaware (the "Company"), acting by and through Robert G. Jones, its duly authorized Secretary, has and does hereby appoint Greg Nair its true and lawful Attorney-in-Fact with power and authority, for and on behalf, and in the name of the Company, during the period specified above, and subject to the restrictions and limitations set forth in this Power of Attorney to execute and deliver in the ordinary and regular course of the Company's business, applications for mining, environmental, safety and health permits, permit transfers, or permit bond releases or bond adjustments, amendments, supplements or modifications to such permits, certificates or other instruments directly related to such amendments, supplements or modifications, monthly production reports, air quality, water quality or other environmental reports, quarterly discharge monitoring reports and any other like or similar reports required to be filed with any local, state or federal governmental agency.

The Attorney herein appointed shall be authorized to act pursuant to this Power from the date hereof only so long as such Attorney shall remain an employee of Arch Coal, Inc. or any subsidiary thereof, or until December 31, 2018, or until such earlier time as this instrument has been revoked, annulled, rescinded or set aside by an instrument of revocation filed with the Secretary of the Company, whichever first occurs.

IN WITNESS WHEREOF, the Company has caused this Power of Attorney to be executed on its behalf, and its seal to be hereunto affixed as of the day and year first above written, by the undersigned, Robert G. Jones, duly authorized Secretary of the Company.

ICG TYGART VALLEY, LLC

By:   
Robert G. Jones  
Secretary

RECEIVED  
Office of Oil and Gas  
MAY 01 2018  
WV Department of  
Environmental Protection

05/18/2018

STATE OF MISSOURI     )  
  ) ss  
COUNTY OF ST. LOUIS    )

On this 2<sup>nd</sup> day of January, 2018, before me, the undersigned notary public, personally appeared Robert G. Jones, known to me to be the person whose name is subscribed to the within instrument and acknowledged that he executed the same for the purposes therein contained.

IN WITNESS WHEREOF, I hereunto set my hand and official seal.

*Jolene Jouett Mermis*  
Notary Public

My Commission Expires: May 21, 2019

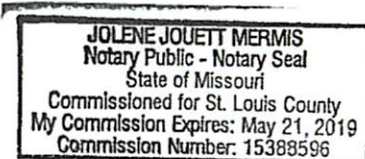

RECEIVED  
Office of Oil and Gas  
MAY 01 2018  
WV Department of  
Environmental Protection



91-00496P

WW-4B

API No.	47-91-0496
Farm Name	Drennan
Well No.	J-1219

**INSTRUCTIONS TO COAL OPERATORS  
OWNERS AND LESSEE**

The well operator named on the obverse side of WW-4 (B) is about to abandon the well described in the enclosed materials and will commence the work of plugging and abandoning said well on the date the inspector is notified. Which date shall not be less than five days after the day on which this notice and application so mailed is received, or in due course should be received by the Department of Environmental Protection Office of Oil & Gas.

This notice and application is given to you in order that your respective representatives may be present at the plugging and filling of said well. You are further notified that whether you are represented or not the operator will proceed to plug and fill said well in the manner required by Section 24, Article 6, Chapter 22 of the Code and given in detail on obverse side of this application.

NOTE: If you wish this well to be plugged according to 22-6-24(d) then as per Regulation 35CSR4-13.9 you must complete and return to this office on form OB-16 "Request by Coal Operator, Owner, or Lessee for plugging" prior to the issuance of this plugging permit.

**WAIVER**

The undersigned coal operator X / owner \_\_\_\_\_ / lessee \_\_\_\_\_ / of the coal under this well location has examined this proposed plugging work order. The undersigned has no objection to the work proposed to be done at this location, provided, the well operator has complied with all applicable requirements of the West Virginia Code and the governing regulations.

Date: 4/12/18

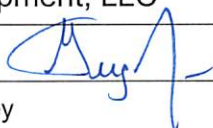
CoalQuest Development, LLC  
 By: Greg Nair   
 Its Power of Attorney

RECEIVED  
 Office of Oil and Gas  
 MAY 01 2018  
 WV Department of  
 Environmental Protection  
 05/18/2018

**POWER OF ATTORNEY**

**COALQUEST DEVELOPMENT LLC  
TO  
GREG NAIR**

**Dated: January 1, 2018**

**Expires: December 31, 2018**

KNOW ALL MEN BY THESE PRESENTS: That CoalQuest Development LLC, a limited liability company formed under the laws of the State of Delaware (the "Company"), acting by and through Robert G. Jones, its duly authorized Secretary, has and does hereby appoint Greg Nair its true and lawful Attorney-in-Fact with power and authority, for and on behalf, and in the name of the Company, during the period herein specified, and subject to the restrictions and limitations set forth in this Power, to execute, acknowledge and deliver in the ordinary and regular course of the Company's business, applications for mining, environmental, safety, and health permits, permit transfers, or permit bond releases or bond adjustments, amendments, supplements or modifications to such permits, certificates, gas well plugging applications, shallow well drilling permit applications, or other instruments directly related to such amendments, supplements or modifications, monthly production reports, air quality, water quality or other environmental reports, quarterly discharge monitoring reports and any other like or similar reports required to be filed with any local, state or federal governmental agency.

The Attorney herein appointed shall be authorized to act pursuant to this Power from the date hereof only so long as such Attorney shall remain an employee of Arch Coal, Inc. or any subsidiary thereof, or until December 31, 2018, or until such earlier time as this instrument has been revoked, annulled, rescinded or set aside by an instrument of revocation filed with the Secretary of the Company, whichever first occurs.

IN WITNESS WHEREOF, the Company has caused this Power of Attorney to be executed on its behalf, and its seal to be hereunto affixed as of the day and year first above written, by the undersigned, Robert G. Jones, duly authorized Secretary of the Company.

COALQUEST DEVELOPMENT LLC

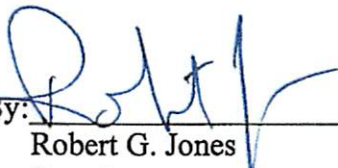
By:   
Robert G. Jones  
Secretary

RECEIVED  
Office of Oil and Gas

MAY 01 2018

WV Department of  
Environmental Protection

05/18/2018

STATE OF MISSOURI     )  
  ) ss  
COUNTY OF ST. LOUIS    )

On this 2<sup>nd</sup> day of January, 2018, before me, the undersigned notary public, personally appeared Robert G. Jones, known to me to be the person whose name is subscribed to the within instrument and acknowledged that he executed the same for the purposes therein contained.

IN WITNESS WHEREOF, I hereunto set my hand and official seal.

*Jolene Jouett Mermis*  
\_\_\_\_\_  
Notary Public

My Commission Expires: May 21, 2019

JOLENE JOUETT MERMIS  
Notary Public - Notary Seal  
State of Missouri  
Commissioned for St. Louis County  
My Commission Expires: May 21, 2019  
Commission Number: 15388596

RECEIVED  
Office of Oil and Gas

MAY 01 2018

WV Department of  
Environmental Protection



## ICG TYGART VALLEY, LLC

---

100 Tygart Drive, Grafton, West Virginia 26354

April 18, 2018

WV Department of Environmental Protection  
Office of Oil and Gas  
601 – 57<sup>th</sup> Street, S.E.  
Charleston, West Virginia 25304

To Whom It May Concern:

As per the WV Department of Environmental Protection, Office of Oil and Gas request, ICG Tygart Valley, LLC, submits the following procedures utilizing pit waste.

Upon submitting a well work application (without a general permit for Oil and Gas Pit Waste Discharge Application), ICG Tygart Valley, LLC, will construct no pits, but instead will use mud tanks to contain all drilling muds.

Once the well is completed, that material (minus the cave material) will be trucked to the next well to be plugged or to DEP impoundment facilities O-2017-06 or to an approved facility that can handle the material.

Sincerely,

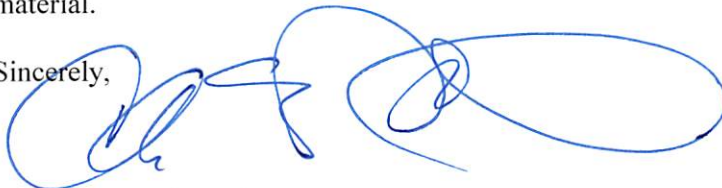

Charles E. Duckworth  
Designated Agent

RECEIVED  
Office of Oil and Gas  
MAY 01 2018  
WV Department of  
Environmental Protection

05/18/2018

ICG TYGART VALLEY, LLC

Diversion Ditch (as Needed)

Typical Drawing  
Of Well Plugging Site  
Plan

GUT

Cut Mulched If Slope  
Less than 1 to 1

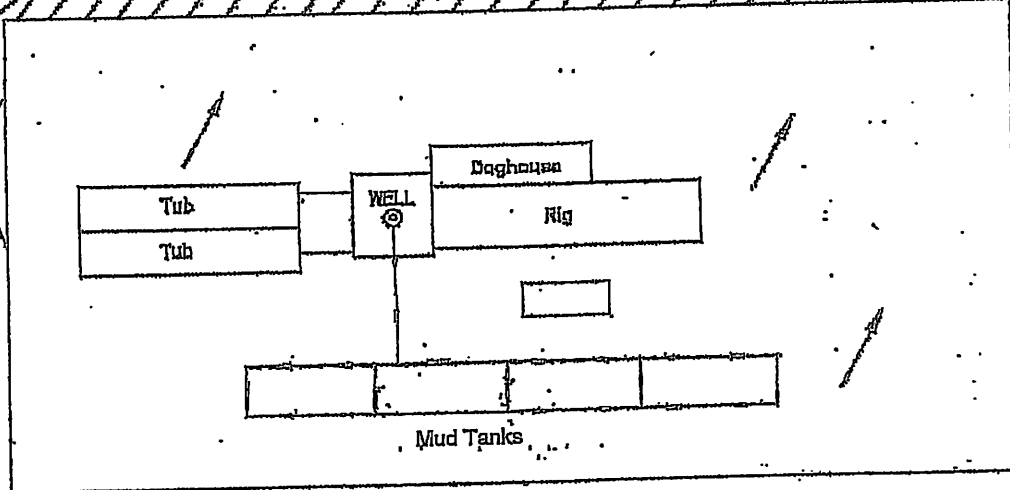
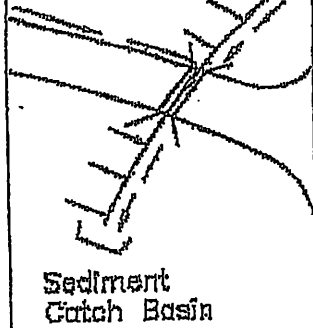

Compacted and Layed

FILL

Original Ground Keywayed

Hay Bales  
or  
Sediment Fence

WV Department of  
Environmental Protection

MAY 01 2018

RECEIVED  
Office of Oil and Gas

91-50496P

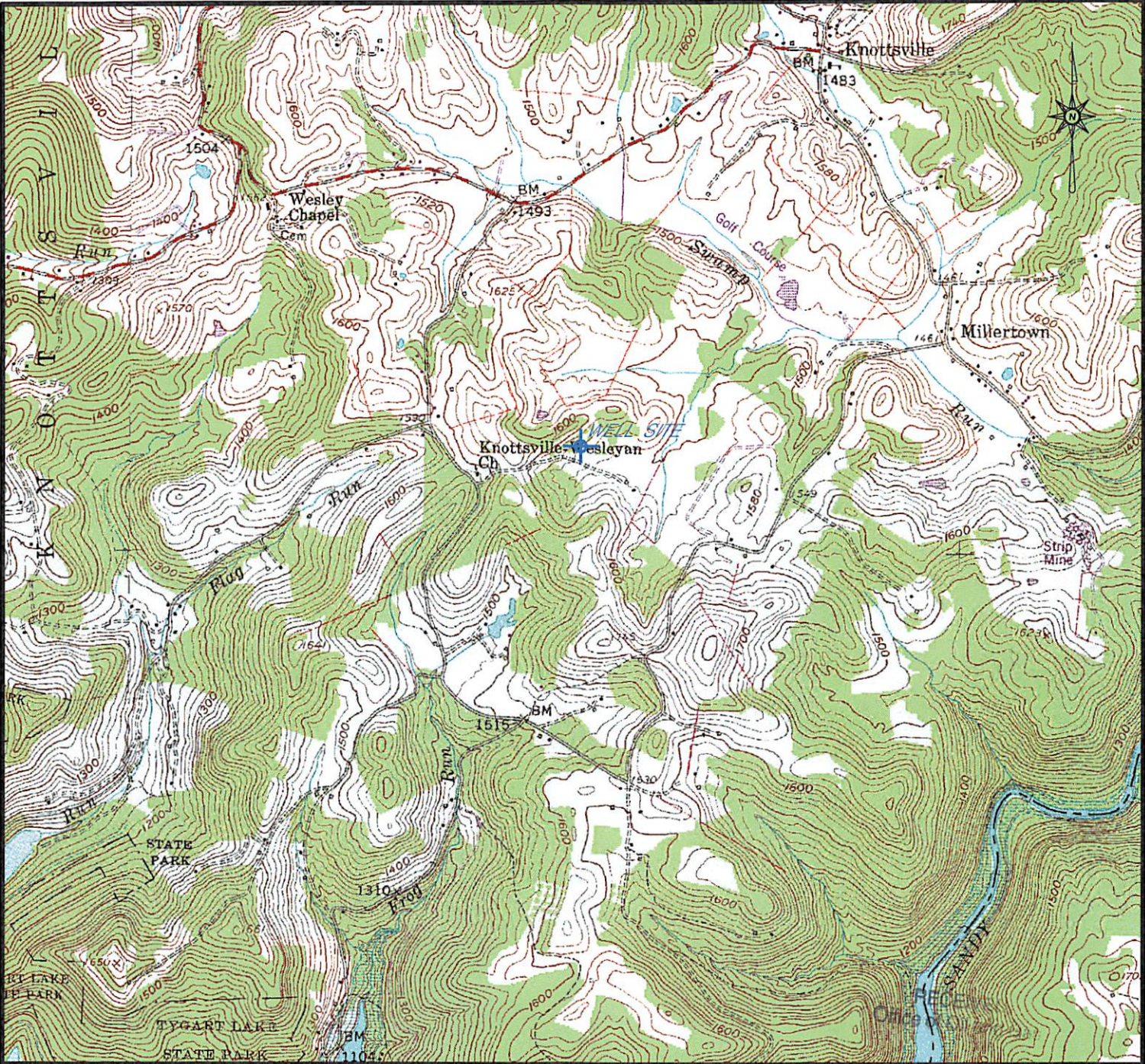

LATITUDE: 39° 17' 44"  
 LONGITUDE: 79° 58' 39"  
 NEAREST WATERCOURSE: Swamp Run  
 NEAREST TOWN: Knottsville

OPERATOR'S WELL NO. \_\_\_\_\_  
 API WELL NO. J1219  
47 - 091 - 00496 P  
 STATE COUNTY PERMIT

WELL TYPE: OIL \_\_\_\_\_ GAS  LIQUID INJECTION \_\_\_\_\_ WASTE DISPOSAL \_\_\_\_\_  
 (IF "GAS") PRODUCTION  STORAGE \_\_\_\_\_ DEEP \_\_\_\_\_ SHALLOW   
 LOCATION: ELEVATION \_\_\_\_\_ WATERSHED Swamp Run  
 DISTRICT Knottsville COUNTY Taylor  
 QUADRANGLE Grafton & Thornton 7 1/2'  
 SURFACE OWNER: Charles E. Jr. & Betty Drennan ACREAGE 130  
 OIL & GAS ROYALTY OWNER: Charles E. Jr. & Betty Drennan LEASE ACREAGE 130  
 LEASE NO. JJ-1904

PROPOSED WORK: DRILL  CONVERT \_\_\_\_\_ DRILL DEEPER \_\_\_\_\_ REDRILL \_\_\_\_\_ FRACTURE OR  
 STIMULATE  PLUG OFF OLD FORMATION \_\_\_\_\_ PERFORATE NEW  
 FORMATION \_\_\_\_\_ OTHER PHYSICAL CHANGE IN WELL (SPECIFY) \_\_\_\_\_  
 PLUG AND ABANDON  CLEAN OUT AND REPLUG \_\_\_\_\_  
 TARGET FORMATION Haverty ESTIMATED DEPTH 5850'  
 WELL OPERATOR ICG Tygart Valley, LLC DESIGNATED AGENT Charles E. Duckworth  
 ADDRESS 100 Tygart Drive, Grafton, WV 26354 ADDRESS 100 Tygart Drive, Grafton, WV 26354

MAY 01 2018

WV Department of  
 Environmental Protection  
**API WELL NO. 47-091-0496**  
**J1219**

REVISED BY:	DATE:	<b>ICG TYGART VALLEY, LLC</b>	
		DRAWN BY: <u>Jerry Allen</u>	SCALE: 1" = 2000'
		DIRECTORY: <u>DWG TYG 718 #1</u> <u>WV OIL &amp; GAS PERMIT MAPS</u>	DATE ORIGINATED: <u>March 2018</u>
		DRAWING NO.: <u>47-091-0496</u> <u>J1219.031</u>	PLOTTING <u>\$047ES</u>



Eastern Operations  
 100 Tygart Drive, Grafton, WV 26354  
 Phone: 304-265-9700 Fax: 304-265-2564

05/18/2018

WW-7  
8-30-06



West Virginia Department of Environmental Protection  
Office of Oil and Gas

**WELL LOCATION FORM: GPS**

API: 47-091-0496 WELL NO.: J-1219

FARM NAME: Drennan

RESPONSIBLE PARTY NAME: ICG Tygart Valley, LLC

COUNTY: Taylor DISTRICT: Knottsville

QUADRANGLE: Thornton

SURFACE OWNER: Charles F. Jr., & Betty Drennan

ROYALTY OWNER: Charles F. Jr., & Betty Drennan

UTM GPS NORTHING: 4350088.483

UTM GPS EASTING: 588177.205 GPS ELEVATION: 1551.05

The Responsible Party named above has chosen to submit GPS coordinates in lieu of preparing a new well location plat for a plugging permit or assigned API number on the above well. The Office of Oil and Gas will not accept GPS coordinates that do not meet the following requirements:

- Datum: NAD 1983, Zone: 17 North, Coordinate Units: meters, Altitude: height above mean sea level (MSL) – meters.
- Accuracy to Datum – 3.05 meters
- Data Collection Method:

Survey grade GPS  : Post Processed Differential \_\_\_\_\_  
Real-Time Differential

Mapping Grade GPS \_\_\_\_\_ : Post Processed Differential \_\_\_\_\_  
Real-Time Differential \_\_\_\_\_

- Letter size copy of the topography map showing the well location.**

I the undersigned, hereby certify this data is correct to the best of my knowledge and belief and shows all the information required by law and the regulations issued and prescribed by the Office of Oil and Gas.

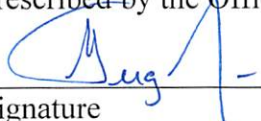
	Power of Attorney	April 18, 2018
Signature	Title	Date

RECEIVED  
Office of Oil and Gas  
MAY 01 2018  
WV Department of  
Environmental Protection