

EQT PRODUCTION CO.
WELL NO. WV 513129

L.J. STARK LEASE
260 ACRES±

NOTES ON SURVEY

1. TIES TO WELLS AND CORNERS ARE BASED ON GRID NORTH FOR THE WV STATE PLANE COORDINATE SYSTEM NORTH ZONE NAD '27.
2. LEASE BOUNDARY SHOWN HEREON TAKEN FROM DEED BOOK 145 PAGE 207, DEED BOOK 85 PAGE 431, DEED BOOK 145 PAGE 199, DEED BOOK 180 PAGE 742 & DEED BOOK 185 PAGE 141.
3. SURFACE OWNER AND ADJOINER INFORMATION TAKEN FROM THE ASSESSOR AND COUNTY CLERK RECORDS OF TAYLOR COUNTY IN JULY, 2010.
4. WELL LAT./LONG. (NAD'27) ESTABLISHED BY DGPS (SURVEY GRADE).
5. U.S. ROUTE 50 IN THIS AREA APPEARS TO BE PART OF THE OLD NORTHWESTERN TURNPIKE, A 60' WIDE STRIP OF LAND CLAIMED IN FEE BY THE WVDOT. SLS RECOMMENDS PROPER LEGAL & LEASING PROCEDURES (IF NEEDED) BE TAKEN BEFORE DRILLING COMMENCES.

REFERENCES

RSM16 WELLS
H3- WV 511399
H4- WV 513129
H5- WV 513130
H6- WV 513131

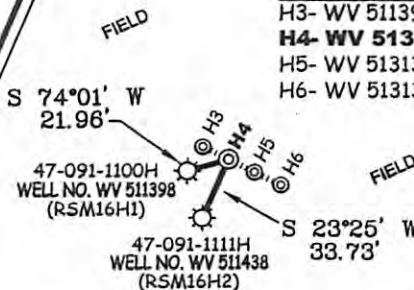

(+) DENOTES LOCATION OF WELL ON UNITED STATES TOPOGRAPHIC MAPS.

DATE JUNE 08, 20 11

OPERATORS WELL NO. WV 513129

API WELL NO. 47-091-1100H
STATE COUNTY PERMIT

CANCELLED

STATE OF WEST VIRGINIA
DIVISION OF ENVIRONMENTAL PROTECTION
OFFICE OF OIL AND GAS



I THE UNDERSIGNED, HEREBY CERTIFY THAT THIS PLAT IS CORRECT TO THE BEST OF MY KNOWLEDGE AND BELIEF AND SHOWS ALL THE INFORMATION REQUIRED BY LAW AND THE REGULATIONS ISSUED AND PRESCRIBED BY THE DIVISION OF ENVIRONMENTAL PROTECTION.

P.S.
677

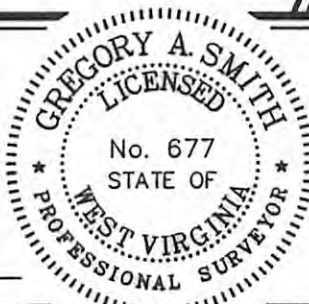

MINIMUM DEGREE OF ACCURACY 1 / 2500 FILE NO. 8732P513129R (350-01)
PROVEN SOURCE OF ELEVATION DGPS (SURVEY GRADE) TIE TO CORS NETWORK SCALE 1" = 1000'

WELL TYPE: OIL GAS X LIQUID INJECTION WASTE DISPOSAL IF "GAS" PRODUCTION X STORAGE DEEP SHALLOW X
LOCATION: ELEVATION 1,394' (ACTUAL) WATERSHED HUSTEAD FORK
DISTRICT BOOTH'S CREEK COUNTY TAYLOR QUADRANGLE ROSEMONT 7.5'
SURFACE OWNER RICHARD D. KNOTTS ACREAGE 89.69±
ROYALTY OWNER PEGGY ANN KNOTTS ET AL (260 AC.±) / PEGGY A. KNOTTS ET AL (201 AC.±) / ANNALEE GOODWIN ET AL (80 AC.±)
PROPOSED WORK: LEASE NO. 121853 / 122736 / 123426
DRILL X CONVERT DRILL DEEPER REDRILL FRACTURE OR STIMULATE X PLUG OFF OLD FORMATION PERFORATE NEW FORMATION PLUG AND ABANDON CLEAN OUT AND REPLUG OTHER
PHYSICAL CHANGE IN WELL (SPECIFY) TARGET FORMATION MARCELLUS
ESTIMATED DEPTH

WELL OPERATOR EQT PRODUCTION COMPANY
ADDRESS 1710 PENNSYLVANIA AVE
CHARLESTON, WV 25302

DESIGNATED AGENT REX C. RAY
ADDRESS 1710 PENNSYLVANIA AVE
CHARLESTON, WV 25302

07/04/2014