

PDC MOUNTAINEER, LLC
WELL NO. UNB 2HM

NOTE:
-BOTTOM HOLE 25' NORTH OF LEASE LINE

7,766' TOP HOLE
6,386' BOTTOM HOLE
LATITUDE 39° 27' 30"

NOTES:
-PLAT ORIENTATION, CORNERS, AND WELL REFERENCES ARE BASED UPON THE GRID-NORTH MERIDIAN FOR THE WV STATE PLANE COORDINATE SYSTEM, NORTH ZONE NAD 27. WELL LOCATION REFERENCE TIES ARE BASED UPON THE MAGNETIC MERIDIAN.

-THERE APPEARS TO BE 1 WATER WELL LOCATED WITHIN 1000' OF WELL UNB 2HM.

BRIAN D. & TRACEY
D. PARK & SURV
TM 3 PAR 21
DB 256 PG 10
35.68 AC±

ESMAIL R. & SHERRY
MONAZAM & SURV
TM 3 PAR 23
DB 256 PG 6
8.44 AC±

VIRGINIA MORGAN
BREWER
TM 6 PAR 7
DB 162 PG 385
230 AC±

VIRGINIA MORGAN BREWER
TM 6 PAR 8
DB 162 PG 385
4.004 AC±

VIRGINIA MORGAN BREWER
TM 6 PAR 4
DB 162 PG 385
37.91 AC±

VIRGINIA MORGAN BREWER
TM 6 PAR 44
DB 162 PG 385
96 AC±

VIRGINIA MORGAN BREWER
TM 6 PAR 43
DB 162 PG 385
49.67 AC±

RONALD G. & MARY
L. FORD & SURV
TM 5 PAR 64
DB 172 PG 586
29.8 AC±

JACK D. & SHIRLEY
R. CANTON & SURV
TM 6 PAR 60 DB
298 PG 76
15.8 AC±

VERNON L. & RONA
POLING & SURV
TM 6 PAR 59
DB 298 PG 221
24.98 AC±

CHARLES E. MacDONALD
TM 3 PAR 16
DB 128 PG 230
222.75 AC±

CARL B.
McCARTNEY SR
(HEIRS)
TM 3 PAR 33
DB 235 PG 332
98.8 AC±

ROY L. III & SUSAN
A. SEXTON & SURV
TM 6 PAR 8
DB 196 PG 70
94.4 AC±

MORGANTOWN
LANDSCAPERS INC.
TM 6 PAR 39
DB 231 PG 488
71 AC±

JOSEPH R. & TAMMY
K. BARNES & SURV
TM 6 PAR 40.11
DB 289 PG 335
10.7 AC±

S 10°00' E
5693.30'

S 76°28'41" W 1708.22'

S 25°15'38" W 863.76'

S 54°01'42" W 2098.52'

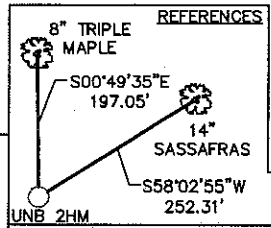
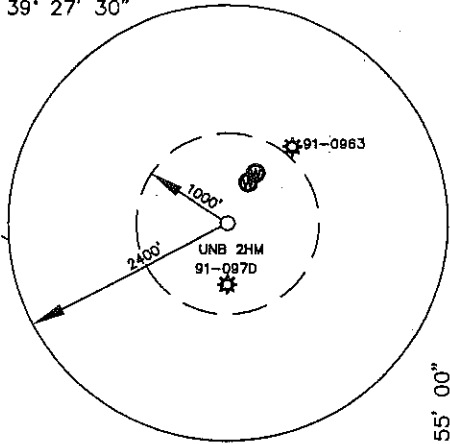

WELL NO. UNB 2HM TOP-HOLE
STATE PLANE COORDINATES
(NAD 27 NORTH ZONE)
N: 340484.4230
E: 1874550.5453
LAT: 39° 26' 02.326"
LON: 79° 56' 38.911"
STATE PLANE COORDINATES
(NAD 83 NORTH ZONE-METER)
N: 103791.629
E: 561781.869
UTM COORDINATES
(NAD 83-METER)
N: 4365479.421
E: 590886.240
LAT: 39° 26' 02.644"
LON: 79° 56' 38.163"

WELL NO. UNB 2HM BOTTOM-HOLE
STATE PLANE COORDINATES
(NAD 27 NORTH ZONE)
N: 334203.4974
E: 1875902.6331
LAT: 39° 25' 00.311"
LON: 79° 56' 21.287"
STATE PLANE COORDINATES
(NAD 83 NORTH ZONE-METER)
N: 101877.265
E: 562193.943
UTM COORDINATES
(NAD 83-METER)
N: 4363572.649
E: 591330.017
LAT: 39° 25' 00.633"
LON: 79° 56' 20.540"

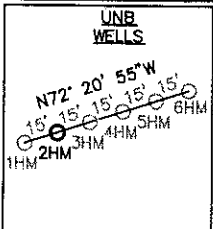

Daniel L. Wheeler, P.S. 530

I, THE UNDERSIGNED, HEREBY CERTIFY THAT THIS PLAT IS CORRECT TO THE BEST OF MY KNOWLEDGE AND BELIEF AND SHOWS ALL THE INFORMATION REQUIRED BY LAW AND THE REGULATIONS ISSUED AND PRESCRIBED BY THE DIVISION OF ENVIRONMENTAL PROTECTION.

FILE NO. 030-1999
SCALE: 1"=1000'
MINIMUM DEGREE OF ACCURACY: 1 in 2500
PROVEN SOURCE OF ELEVATION: OPUS SURVEY GRADE GPS

STATE OF WEST VIRGINIA
DIVISION OF ENVIRONMENTAL PROTECTION
OFFICE OF OIL & GAS

DATE SEPTEMBER 23, 2011
OPERATOR'S WELL NO. UNB NO. 2HM
API WELL NO. 47 - 091 - 01259H
STATE COUNTY PERMIT

WELL TYPE: OIL GAS LIQUID INJECTION WASTE DISPOSAL (IF "GAS"), PRODUCTION STORAGE DEEP SHALLOW
LOCATION: ELEVATION: 1878' WATER SHED: WHITE DAY CREEK
DISTRICT: FETTERMAN COUNTY: TAYLOR
QUADRANGLE: GLADESVILLE 7.5' ACREAGE: 222.75 AC±
SURFACE OWNER: CHARLES E. MacDONALD LEASE ACREAGE: 552.42 AC ±
OIL & GAS ROYALTY OWNER: UNION NAT'L BANK, TRUSTEE FOR GORE-MORRIS, ET. AL LEASE NO. _____
PROPOSED WORK: DRILL CONVERT DRILL DEEPER REDRILL FRACTURE OR STIMULATE
PERFORATE NEW FORMATION PLUG OFF OLD FORMATION OTHER PHYSICAL CHANGE IN WELL (SPECIFY) _____



PLUG AND ABANDON _____ CLEAN OUT AND REPLUG _____
TARGET FORMATION: MARCELLUS SHALE ESTIMATED DEPTH: 7,830' TVD / 14,500' MD
WELL OPERATOR: PDC MOUNTAINEER, LLC DESIGNATED AGENT: JAMES A HAGA
ADDRESS: 120 GENESIS BOULEVARD ADDRESS: 120 GENESIS BOULEVARD
BRIDGEPORT, WV 26330 BRIDGEPORT, WV 26330

91-01259H

WELL RECLAMATION PLAN
FOR
PDC UNB 2HM

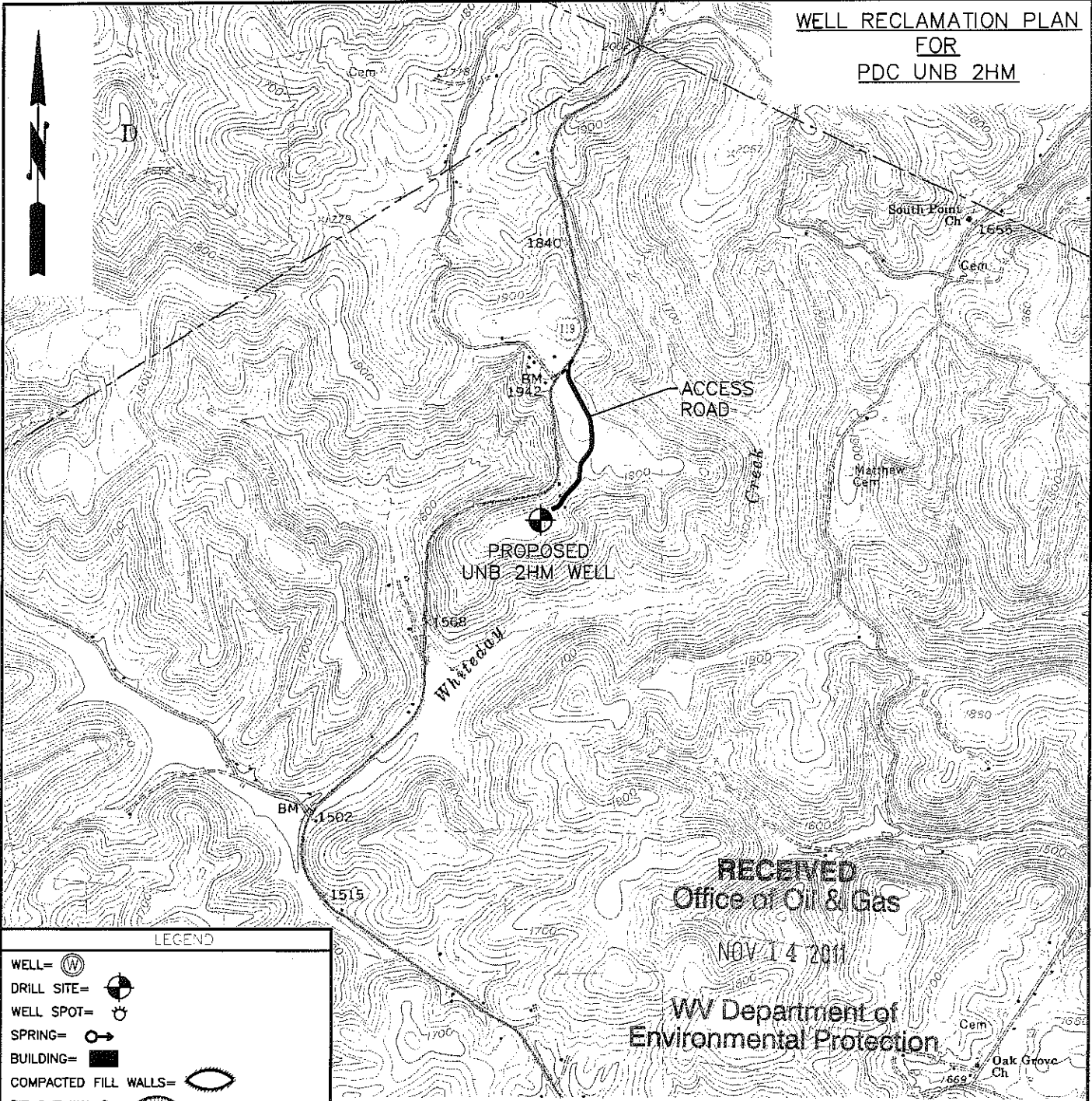

RECEIVED
Office of Oil & Gas
NOV 14 2011

WV Department of
Environmental Protection

LEGEND

- WELL= (W)
- DRILL SITE= (Symbol)
- WELL SPOT= (Symbol)
- SPRING= (Symbol)
- BUILDING= (Symbol)
- COMPACTED FILL WALLS= (Symbol)
- PIT CUT WALLS= (Symbol)
- PIT WASTE= (Symbol)
- GRAVEL= (Symbol)
- SILT FENCE= — SF — SF —
- PROPERTY LINE= (Symbol)
- EXISTING FENCE= — x — x —
- PLANNED FENCE= — o — o —
- ROAD= (Symbol)
- OPEN DITCH= (Symbol)
- STREAM LINE= (Symbol)
- CROSS DRAIN= (Symbol)
- FILTER STRIP= (Symbol)
- DIVERSION= (Symbol)

WELL RECLAMATION PLAN
DONALD VINCENT 101
FELLOWSVILLE 7.5 QUADRANGLE



PHONE (304) 824-4108 **THRASHER** ENGINEERING (FAX) (304) 824-7831
CIVIL, ENVIRONMENTAL, AND CONSULTING
30 COLUMBIA BOULEVARD - CLARKSBURG, WV 26301

WELL RECLAMATION PLAN	SCALE: NOT TO SCALE
FOR	DRAWN: JCP
	CHECKED:
	APPROVED:
PROJECT# 030-1999	

SHEET No.
4