

Latitude: 39°27'30" 7,737' SHL

8,958' BHL

THRASHER

THE THRASHER GROUP, INC.
600 WHITE OAKS BLVD.
BRIDGEPORT, WV 26330
PHONE 304-624-4108

NOTES ON SURVEY

- COORDINATES SYSTEM IS UTM, NAD 83 DATUM, ZONE 17, U.S. FOOT AND WELL COORDINATES ESTABLISHED USING SURVEY GRADE GPS.
- SURFACE AND ROYALTY OWNER INFORMATION AND THEIR BOUNDARIES SHOWN HEREON WERE PLOTTED FROM DEEDS AND/OR TAX PARCEL MAPS PROVIDED BY CLIENT AND FIELD LOCATIONS.
- THIS PLAT DOES NOT REPRESENT A BOUNDARY SURVEY OF THE PARCELS SHOWN HEREON.
- NO DWELLINGS AND BUILDINGS WITHIN 625 FEET OF PROPOSED CENTER OF PAD.
- NO WATER WELLS OR DEVELOPED SPRINGS WITHIN 250 FEET OF PROPOSED WELL.
- NO PERENNIAL STREAMS, LAKES, PONDS, RESERVOIRS OR WETLANDS WITHIN 100 FEET OF THE LIMITS OF DISTURBANCE.
- NO NATURALLY PRODUCING TROUT STREAM WITHIN 300 FEET OF LIMITS OF DISTURBANCE.

PROPOSED COORDINATES UTM (NAD83, ZONE 17, METERS):	
SURFACE HOLE LOCATION (SHL):	NORTHING: 4,365,467.27 EASTING: 590,895.35
BOTTOM HOLE LOCATION (BHL):	NORTHING: 4,365,525.98 EASTING: 591,061.59
BOTTOM HOLE LOCATION (BHL):	NORTHING: 4,367,268.81 EASTING: 590,493.86
AS-DRILLED COORDINATES UTM (NAD83, ZONE 17, METERS):	
SURFACE HOLE LOCATION (SHL):	NORTHING: 4,365,467.27 EASTING: 590,895.35
LANDING POINT LOCATION (LPL):	NORTHING: 4,365,467.27 EASTING: 590,895.35
BOTTOM HOLE LOCATION (BHL):	NORTHING: 4,365,525.98 EASTING: 591,061.59

8:07/20/16

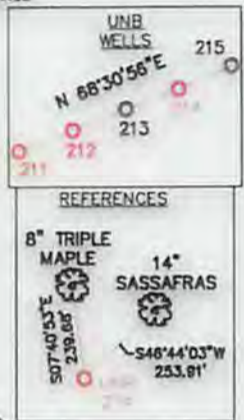
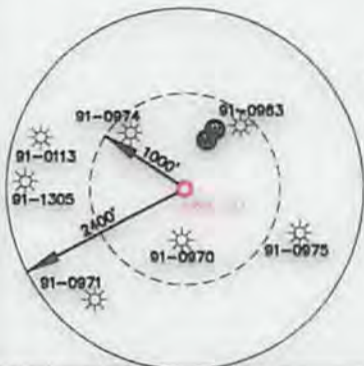

ID	TM	PAR	OWNER	ACRES
A	3	16	N/F CHARLES E. MacDONALD	222.75
B	3	22	N/F MARY ERICKSON	3.00
C	3	17	N/F TRUSTEES FAIRMONT DIST. OF FREE METHODIST CHURCH	7.50
D	3	15.1	N/F WILLIAM J. LOGAR	4.64
E	3	1.1	N/F JOHN V. ZINN II	14.95
F	3	1.40	N/F JAMES O. GWENDOLYN J. & RICHARD L. POWELL & SURV	0.98
G	3	1.26	N/F JAMES O. GWENDOLYN J. & RICHARD L. POWELL & SURV	1.02
H	3	1.48	N/F MICHAEL A. & MARJORIE A. DARRAH & SURV	3.00
I	3	1.22	N/F RANDALL D. & KIMBERLY N. McNEELY & SURV	5.00
J	3	1.12	N/F KENNETH E. RICHARDS	2.25
K	3	1	N/F KIMBERLY BRYAN	14.78
L	3	1.53	N/F HARRIET J. STUMP & SURV & DEBORAH BHIVABHOTLA	2.00
M	3	1.16	N/F MARY A. DAVIDSON	2.00
N	3	1.31	N/F RICHARD A. & ANGELA M. DOWLING & SURV	2.00
O	3	1.28	N/F STEPHEN M. & AMY L. FORD & SURV	1.13
P	3	1.39	N/F PNC BANK TRUSTEE	1.00
Q	3	1.41	N/F FIRST UNITED BANK & TRUST	1.00
R	3	1.50	N/F RONALD L. STROUPE	1.15
S	3	1.46	N/F TRISH J. HERN	1.00
T	3	1.44	N/F DAVID & JOSEPHINE BIGGIN & SURV	1.00
U	3	1.43	N/F CALEB J. SISLER & SURV & KAY LEIGH B. LUNDE	1.21
V	27	5.9	N/F ONA P. DINGESS	2.00
W	27	4	N/F BEVERLY HORNBECK TRUSTEE OF THE BEVERLY HORNBECK LIV TR	152.00

I, THE UNDERSIGNED, HEREBY CERTIFY THAT THIS PLAT IS CORRECT TO THE BEST OF MY KNOWLEDGE AND BELIEF AND SHOWS ALL THE INFORMATION REQUIRED BY LAW AND REGULATIONS ISSUED AND PRESCRIBED BY THE DEPARTMENT OF ENVIRONMENTAL PROTECTION.



P.S. 2270 *[Signature]*

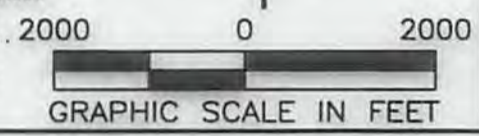

(+) DENOTES LOCATION OF WELL ON UNITED STATES TOPOGRAPHIC MAPS WVDEP OFFICE OF OIL & GAS 601 57TH STREET CHARLESTON, WV 25034	MINIMUM DEGREE ACCURACY: PROVEN SURVEY SOURCE OF GRADE GPS ELEVATION: (NAVD 88, US FT)	UNB NO. 214 OPERATOR'S WELL #: 214 API WELL #: 47 091 STATE COUNTY PERMIT
---	--	--

WELL TYPE: OIL	WASTE DISPOSAL	PRODUCTION	DEEP	GAS	LIQUID INJECTION	STORAGE	SHALLOW
WATERSHED: WHITE DAY CREEK				ELEVATION: 1878'			
DISTRICT: FETTERMAN				QUADRANGLE: GLADESVILLE 7.5'			
SURFACE OWNER: CHARLES MacDONALD				ACREAGE: ± 222.75			
OIL & GAS ROYALTY OWNER: JP MORGAN				ACREAGE: ± 447.36 (LEASE)			
DRILL	DRILL DEEPER	REDRILL	FRACTURE OR STIMULATE	PLUG OFF OLD FORMATION	PERFORATE NEW FORMATION		
CONVERT	PLUG & ABANDON		CLEAN OUT & REPLUG	OTHER CHANGE X (SPECIFY)			
TARGET FORMATION: MARCELLUS SHALE				ESTIMATED DEPTH: TVD			

WELL OPERATOR: ARSENAL RESOURCES	DESIGNATED AGENT: WILLIAM VEIGEL
ADDRESS: 6031 WALLACE ROAD EXTENSION #300	ADDRESS: 65 PPROFESSIONAL PLACE, SUITE 200
CITY: WEXFORD STATE: PA ZIP CODE: 15090	CITY: BRIDGEPORT STATE: WV ZIP CODE: 26330

LEGEND: ○ PROPOSED SURFACE HOLE / BOTTOM HOLE * EXISTING / PRODUCING WELLHEAD LPL * LANDING POINT LOCATION * EXISTING WATER WELL * EXISTING SPRING	— LEASE BOUNDARY — AS-DRILLED PATH — PROPOSED PATH	REVISIONS: DATE: 09-29-2017 DRAWN BY: R.DOERR SCALE: 1" = 2000' DRAWING NO: XXXXX WELL LOCATION PLAT
--	--	--

2,994' BHL

8,916' SHL

Longitude: 79°55'00"