

SURFACE HOLE SURVEYED 39° 17' 30" (NAD27)
 BOTTOM HOLE SURVEYED 39° 15' 00" (NAD27)

9,801'

822'

Latitude: (NAD27)



(NAD83-WVN) US SURVEY FT.

TOP HOLE
 N) 276971.722
 E) 1779051.662
 LANDING POINT
 N) 275876.630
 E) 1777228.570
 BOTTOM HOLE
 N) 262913.040
 E) 1781704.490

(NAD83-LAT/LONG) DECIMAL

TOP HOLE
 N) 39.258499
 E) -80.163059
 LANDING POINT
 N) 39.255463
 E) -80.175472
 BOTTOM HOLE
 N) 39.219963
 E) -80.159330

(UTM, NAD83) METER

TOP HOLE
 N) 4345792.144
 E) 571690.548
 LANDING POINT
 N) 4345449.270
 E) 571140.660
 BOTTOM HOLE
 N) 4341522.360
 E) 572569.980

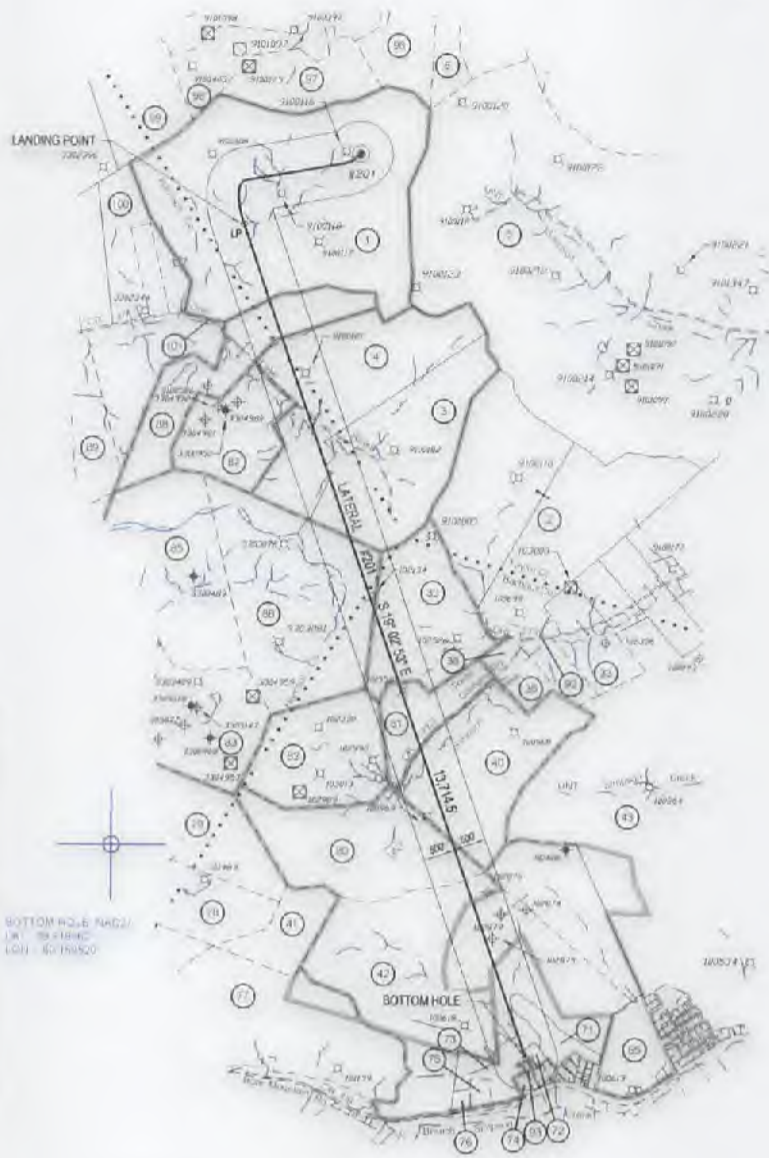
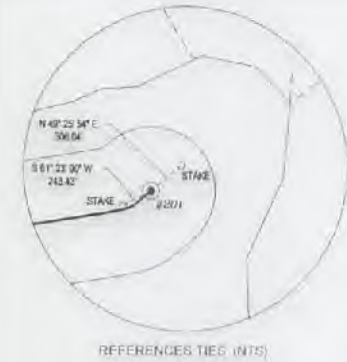

BOTTOM HOLE NAD27
 LAT: 39.219963
 LONG: -80.159330

SURFACE HOLE NAD27
 LAT: 39.258499
 LONG: -80.163059

Longitude: (NAD27)

10,873'
 12,108'

REFERENCE NOTES

- Property lines as shown taken from deeds, tax maps, and field locations. A full boundary survey is not expressed or implied. All bearings are based on grid North. Ownership taken from public records Taylor County, West Virginia, Date 2022.
- State Plane Coordinates & NAD83 Lat/Long by differential submeter mapping grade GPS.
- There are no railroads, dwellings, or agricultural buildings within 525 feet of center of pad.
- No water wells found within 250' of the center of well pad.

LEGEND

- PROPOSED WELL LATERAL
- - - PROPOSED WELL TIE LINE
- STREAM
- EXISTING ROAD
- BUFFER
- PROPERTY LINE
- MINERAL TRACT BOUNDARY
- COUNTY BOUNDARY LINE
- #11 PROPOSED WELL HEAD
- EXISTING WELL HEAD (Active)
- EXISTING WELL HEAD (Proposed)
- EXISTING WELL HEAD (Abandoned)
- EXISTING WELL HEAD (Leaves Drilled)
- EXISTING WELL HEAD (Future Drill)
- LANDING POINT/BOTTOM HOLE
- ⊙ SURFACE OWNER

FILE#: 22078-001
 SHEET#: 1 of 2
 SCALE: 1" = 3000'
 TICK SCALE: 1" = 2000'
 MINIMUM DEGREE OF ACCURACY: 1/200

PROVEN SOURCE OF ELEVATION: WV-RTN CORS STATION

I, THE UNDERSIGNED, HEREBY CERTIFY THAT THIS PLAT IS CORRECT TO THE BEST OF MY KNOWLEDGE AND BELIEF AND SHOWS ALL THE INFORMATION REQUIRED BY LAW AND THE REGULATIONS ISSUED AND PRESCRIBED BY THE DEPARTMENT OF ENVIRONMENTAL PROTECTION.

Signed: *Herbert L. Parsons, III* 3/11/2022
 P.S. #2361: Herbert L. Parsons, III P.S.



(+) DENOTES LOCATION OF WELL ON UNITED STATES TOPOGRAPHIC MAPS
 WVDEP
 OFFICE OF OIL & GAS
 601 57TH STREET
 CHARLESTON, WV 25304



DATE: MARCH 11, 2022
 JOHNSON TFP-40
 OPERATOR'S WELL #: # 201
 API WELL #: 47 091 01367
 STATE COUNTY PERMIT

Well Type: Oil Waste Disposal Production Deep
 Gas Liquid Injection Storage Shallow
 WATERSHED: SIMPSON CREEK
 COUNTY / DISTRICT: TAYLOR CO. FLEMINGTON DISTRICT
 SURFACE OWNER: RENEE JOHNSON
 OIL & GAS ROYALTY OWNER: SEE WW-6A1

ELEVATION: 1,332.5
 QUADRANGLE: ROSEMONT, WV
 ACREAGE: 284 ±
 ACREAGE: 284 ±

04/22/2022

- DRILL CONVERT DRILL DEEPER REDRILL FRACTURE OR STIMULATE
- PLUG OFF FORMATION PERFORATE NEW FORMATION PLUG & ABANDON
- CLEAN OUT & REPLUG OTHER CHANGE SPECIFY:

TARGET FORMATION: MARCELLUS ESTIMATED DEPTH: TVD: 7,903.5' TMD: 22,343'

WELL OPERATOR: ARSENAL RESOURCES DESIGNATED AGENT: NATHAN SKEEN
 ADDRESS: 6031 WALLACE ROAD EXTENSION # 300 ADDRESS: 633 MAIN STREET
 CITY: WEXFORD STATE: PA ZIP: 15090 CITY: BRIDGEPORT STATE: WV ZIP: 26330

BOTTOM HOLE SURVEYED 80° 07' 30" (NAD27)
 SURFACE HOLE SURVEYED 80° 10' 00" (NAD27)

SURFACE PARCEL OWNER INFORMATION

ADJOINER PARCEL OWNER INFORMATION

ID#	PARCEL NUMBER	OWNER NAME
1	033-15-331-27	JOHNSON RENEE
88	033-15-351-10	JOHNSON RENEE
4	033-15-351-12	GCSTREAM LLC
3	033-15-351-13	GCSTREAM LLC
86	033-15-351-24	GCSTREAM LLC
39	001-09-9-1	STEWART FARM LLC
81	001-09-9-19	STEWART FARM LLC
40	001-09-9-20	SEESE ROBERT & BRENDA HWS
80	001-09-10-2	SMITH JO ANN V & GARY M BROWN JR (WS)
42	001-09-11-1	POLINO ENTERPRISES INC
73	001-09-12-42	FOSTER ERIC M & TRACI D WS

ID#	PARCEL NUMBER	OWNER NAME
2	001-09-9-2	STEWART FARM LLC
5	091-04-11-1	CPS FARMS LIMITED LIABILITY CO
6	091-04-8-22	GRIPPIN JAMES S & ELAINE M
33	001-09-9-7	CROUSE STEPHEN DALE &
35	001-09-9-20.1	CROUSE STEPHEN DALE & MICHAEL LYNN
38	001-09-9-3	STEWART FARM LLC
41	001-09-12-1	POLINO ENTERPRISES INC
43	001-09-9-22	WOLFE LARRY, ROBERT WOLFE &
65	001-09-12-27	WOLFE LARRY MICHAEL
71	001-09-12-61	CHARLTON-FRYER AMANDA S & TIMOTHY R CHARLTON L/E
72	001-09-12-60	SCHIMANSKY STEVEN & DEBRA HWS
74	001-09-12C-2	FOSTER ERIC M & TRACI D WS
75	001-09-12-43	TRADER PAUL L
76	001-09-12-41	TRADER PAUL & LORETTA WRS
77	001-09-11-1.2	BECKWITH LUMBER CO INC
78	033-15-351-31	GCSTREAM LLC
79	033-15-351-22	GCSTREAM LLC
82	001-09-10-1	SMITH JO ANN V & GARY M BROWN JR (WS)
83	033-15-351-31	GCSTREAM LLC
85	033-15-351-23	GCSTREAM LLC
87	033-15-351-11	GCSTREAM LLC
89	033-15-351-7	WARDER ORAN LEE 2/3 INT & ORAN
92	RIGHT OF WAY	COUNTY ROUTE 77/8 BARBOUR CORNER
93	001-09-12C-1	COSTELLO HUGO, HRS
96	091-04-8-21	MILLARD CARLYLE G
97	091-04-7-27	CEQUEL III COMMUNICATIONS
98	091-04-7-9	CEQUEL III COMMUNICATIONS
99	091-04-7-8	FRUM SHIRLEY A
100	033-15-351-9	JOHNSON RENEE
101	RIGHT OF WAY	COUNTY ROUTE 17 ORAL LAKE ROAD

REFERENCE NOTES

- Property lines as shown taken from deeds, tax maps, and field locations. A full boundary survey is not expressed or implied. All bearings are based on grid North. Ownership taken from public records Taylor County, West Virginia Date: 2022
- State Plane Coordinates & NAD83 Lat/Long by differential submeter mapping grade GPS.
- There are no railroads, dwellings, or agricultural buildings within 625 feet of center of pad.
- No water wells found within 250' of the center of well pad.

LEGEND

- PROPOSED WELL LATERAL
- PROPOSED WELL TIE LINE
- STREAM
- EXISTING ROAD
- BUFFER
- PROPERTY LINE
- MINERAL TRACT BOUNDARY
- COUNTY BOUNDARY LINE
- PROPOSED WELL HEAD
- EXISTING WELL HEAD (Active)
- EXISTING WELL HEAD (Plugged)
- EXISTING WELL HEAD (Abandoned)
- EXISTING WELL HEAD (Water Drift)
- EXISTING WELL HEAD (Fracture Drift)
- LANDING POINT/BOTTOM HOLE
- SURFACE OWNER

FILE#: 22078-001
 SHEET#: 2 of 2
 SCALE: 1" = 3000'
 TICK SCALE: 1" = 2000'
 MINIMUM DEGREE OF ACCURACY: 1/200
 PROVEN SOURCE OF ELEVATION: WV-RTN CORS STATION

I, THE UNDERSIGNED, HEREBY CERTIFY THAT THIS PLAT IS CORRECT TO THE BEST OF MY KNOWLEDGE AND BELIEF AND SHOWS ALL THE INFORMATION REQUIRED BY LAW AND THE REGULATIONS ISSUED AND PRESCRIBED BY THE DEPARTMENT OF ENVIRONMENTAL PROTECTION.

Signed: *Herbert L. Parsons, III* 3/11/2022
 P.S. #2361: Herbert L. Parsons, III P.S.



(+) DENOTES LOCATION OF WELL ON UNITED STATES TOPOGRAPHIC MAPS
 WVDEP
 OFFICE OF OIL & GAS
 601 57TH STREET
 CHARLESTON, WV 25304



DATE: MARCH 11, 2022
 JOHNSON TFP-40
 OPERATOR'S WELL #: # 201
 API WELL #: 47 091
 STATE COUNTY PERMIT

Well Type: Oil Waste Disposal Production Deep
 Gas Liquid Injection Storage Shallow
 WATERSHED: SIMPSON CREEK
 COUNTY / DISTRICT: TAYLOR CO. FLEMINGTON DISTRICT
 SURFACE OWNER: RENEE JOHNSON
 OIL & GAS ROYALTY OWNER: SEE WW-6A1

ELEVATION: 1,332.5
 QUADRANGLE: ROSEMONT, WV
 ACREAGE: 284 ±
 ACREAGE: 284 ±

04/22/2022

- DRILL CONVERT DRILL DEEPER REDRILL FRACTURE OR STIMULATE
- PLUG OFF FORMATION PERFORATE NEW FORMATION PLUG & ABANDON
- CLEAN OUT & REPLUG OTHER CHANGE SPECIFY:

TARGET FORMATION: MARCELLUS ESTIMATED DEPTH: TVD: 7,903.5' TMD: 22,343'
 WELL OPERATOR: ARSENAL RESOURCES DESIGNATED AGENT: NATHAN SKEEN
 ADDRESS: 6031 WALLACE ROAD EXTENSION # 300 ADDRESS: 633 MAIN STREET
 CITY: WEXFORD STATE: PA ZIP: 15090 CITY: BRIDGEPORT STATE: WV ZIP: 26330