

LATITUDE 39° 22' 30 (7 1/2)

80° 05' (7 1/2)

LONGITUDE

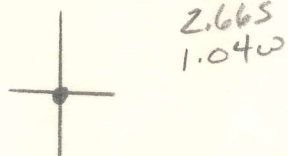

7'5 OGIS topo location

7.5' loc _____ 15' loc _____
 _____ (calc.) _____

on Equitable 7 1/2 - Grafton

Company Pittsburgh + WV Gas

Farm J.T. Gawthrop (6008)

Quad Grafton 7.5

County Taylor

District Booths Creek

WELL LOCATION MAP

File No. 091-11A

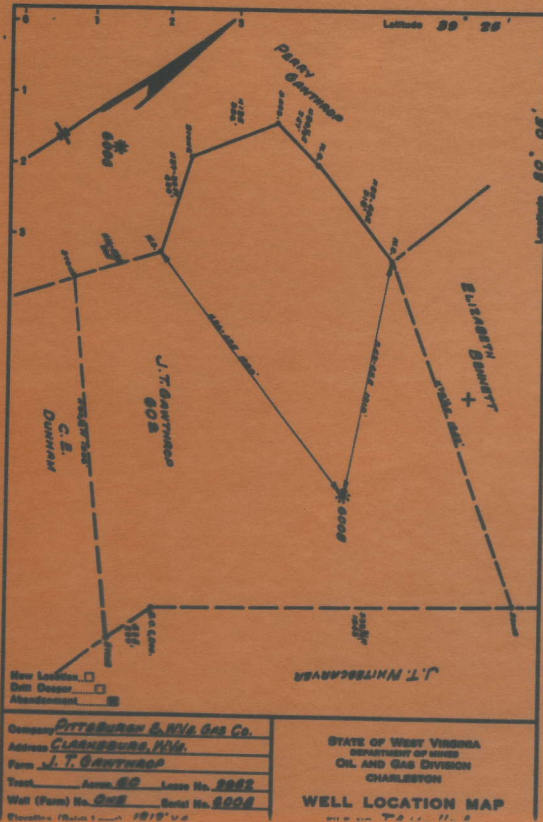

11-A

CRAPTON 75

Company Pittsburgh & West Va Gas Company
 Address Clarksburg, West Va.,
 Farm J. T. Gawthrop Acres 60
 Location (waters) Fairmont S/E. 1-3
 Well No. 6008 Elev. 1312' VA
 District Booths Creek County Taylor
 The surface of tract is owned in fee by G.W. Constable
 R.D.#5 Address Grafton, W. Va.,
 Mineral rights are owned by Geo. W. & Grace Constable
 R.D.#5. Address Grafton, W. Va.,
 Drilling commenced September 8, 1915
 Drilling completed October 13, 1915
 Date Shot From To
 With
 Open Flow /10ths Water in Inch
 /10ths Merc. in Inch
 Volume Cu. Ft.
 Rock Pressure lbs. hrs.
 Oil bbls., 1st 24 hrs.
 Fresh water feet feet
 Salt water feet feet

Casing and Tubing	Used in Drilling	Left in Well	Packers
Size			
16			Kind of Packer
18			
10	360'	360'	Size of
8 1/2	895'	895'	
8 1/8	1460'	1460'	Depth set
5 3/16			
3			Perf. top
2			Perf. bottom
Liners Used			Perf. top
			Perf. bottom

CASING CEMENTED SIZE No. Ft. Date
 COAL WAS ENCOUNTERED AT 660 FEET 36 INCHES
 728 FEET 48 INCHES FEET INCHES
 FEET INCHES FEET INCHES

Formation	Color	Hard or Soft	Top	Bottom	Oil, Gas or Water	Depth Found	Remarks
Clay	Yellow	Soft	0	20			
Sand	Dark	Hard	20	45			
Lime	"	"	45	145			
Red Rock	Red	Soft	145	170			
Sand	White	Hard	170	185			
Shells	Dark	"	185	300			
Slate	"	Soft	300	315			
Big Dunkard	White	Hard	315	360			
Lime	Dark	"	360	540			
Gas Sand	White	"	540	595			
Lime	Dark	"	595	620			
Slate	Black	Soft	620	640			
Lime	Dark	Hard	640	660			
Coal	Black	Soft	660	663			
Lime	Dark	Hard	663	670			
1st. Salt Sand	"	"	670	690			
Slate	"	Soft	690	728			
Coal	Black	"	728	732			
Slate	Dark	Soft	732	764			
2nd. Salt Sand	White	Hard	764	805			
Lime	Dark	Hard	805	815			
Slate	"	Soft	815	852			
Sand	White	Hard	852	872	Water	856'	3 Bailers.
Slate	Dark	Soft	872	905			
3rd. Salt Sand	White	Hard	905	985			
Shells	"	"	985	1045			
Sand	"	"	1045	1075			
Slate	Dark	Soft	1075	1100			
Sand	White	Hard	1100	1125			
Red Rock	Red	"	1125	1195			
Lime	Dark	"	1195	1210			
Maxon Sand	"	"	1210	1255			
Lime	Red	"	1255	1310			
"	Dark	"	1310	1325			
Red Rock	Red	Soft	1325	1345			
Lime	Dark	Hard	1345	1365			
Slate	Dark	Soft	1365	1390			

30 Ft. Sand	White	"	1870	1961		
Slate	Dark	Soft	1961	1965		
30 Ft. Sand	White	Hard	1965	2018		
Shells	Dark	"	2018	2080		
Garden Stray	"	"	2080	2090		
Slate	"	Soft	2090	2098		
Garden Sand	White	Hard	2098	2105		
Lime	Red	"	2105	2130		
Shells	Dark	"	2130	2175		
Red Rock	Red	"	2175	2280		
Sand	Brown	Soft	2280	2292		
Red Rock	Red	Hard	2292	2365		
5th Sand	Brown	Soft	2365	2387	Gas	2372'
Slate	Dark	"	2387	2393		
Red Rock	Red	"	2393	2407		
Bayard Sand	Brown	"	2407	2431		
Slate	Dark	"	2431	2435		
Total Depth				2435		

Record of Well No. 6008 Located on John T. Hawthrop Farm Aug 18 1915
Booths Creek District Taylor County West Va State
 Division A District No. _____ Drilled under well Order 304
 Rig built by John Craig Began Sept 2 1915 Completed Sept 7 1915
 Well drilled by W. M. Barubart Began Sept 8 1915 Completed Oct 13 1915
 Depth of Well 2435 feet Size of Hole 6 5/8 Producing Gas

CASED WITH			REMARKS
AMOUNT	SIZE	KIND	
16'	13"	Wood	
360'	10'	Steel	18 ft
895'	8 1/4"	"	43 ft
1460'	6 5/8"	"	67 ft
Flow limited to 300,000 cu ft per year 11-1-34			

COAL VEINS

FORMATIONS					
FORMATION	COLOR	OPEN OR CLOSE HARD OR SOFT	TOP	BOTTOM	REMARKS GAS-OIL-WATER (THICKNESS OF PAY)
<u>Big Sand</u>			<u>315</u>	<u>360</u>	
<u>Chas Sand</u>			<u>540</u>	<u>595</u>	
<u>1st Salt Sand</u>			<u>670</u>	<u>690</u>	
<u>2nd " "</u>			<u>764</u>	<u>805</u>	
<u>3rd " "</u>			<u>805</u>	<u>985</u>	
<u>Main Sand</u>			<u>1201</u>	<u>1353</u>	
<u>Big Lime</u>			<u>1408</u>	<u>1479</u>	
<u>Big Limestone</u>			<u>1479</u>	<u>1590</u>	
<u>Fifty Foot</u>			<u>1870</u>	<u>1961</u>	
<u>Twenty "</u>			<u>1965</u>	<u>2018</u>	
<u>Woodstock</u>			<u>2080</u>	<u>2090</u>	
<u>Hard</u>			<u>2098</u>	<u>2105</u>	
<u>Red Sand</u>			<u>2365</u>	<u>2387</u>	<u>Gas 2372</u>
<u>Payard</u>			<u>2407</u>	<u>2431</u>	

FIRST PRESSURE TEST IN 6 5/8 CASING

REMARKS

30 Sec. 3 lbs.

1 Min. 5 "

2 " 10 "

5 " 19 "

10 " 33 "

15 " 52 "

30 " 97 "

Rock Pressure 540 " in 24 hrs.

Taken October 13 1915

By Lloyd Evans

WELL TUBED AND PACKED Oct 16 1915

VIZ: Used 102 Jts. 2128 ft. 3" Tubing
1-6 5/8 x 3 Hook Tool Packer
Packer set at 2101-6' in thirty foot

FIRST PRESSURE TEST IN 3" TUBING

REMARKS

30 Sec. 9 lbs.

1 Min. 16 "

2 " 24 "

5 " 54 "

10 " 100 "

15 " 142 "

30 " 248 "

Rock Pressure 540 " in 24 hrs.

Taken October 16 1915

By Lloyd Evans.

MATERIAL FOR THIS WELL RECEIVED FROM FOLLOWING SOURCES:

Blank lined area for recording material sources.

NAME	TOP	BOTTOM	OIL	GAS	WATER	REMARKS
Clay		20				
Sand	20	45				
Slime	45	145				
Red Rock	145	170				
Sand	170	185				
Shells	185	300				
Slate	300	315				
Big Lumber	315	360				
Slime	360	540				
Sand	540	595				
Slime	595	620				
Slate	620	640				
Slime	640	660				
Coal	660	663				
Slime	663	670				
1st. Salt Sand	670	690				
Slate	690	728				
Coal	728	732				
Slate	732	764				
2nd. Salt Sand	764	805				
Slime	805	815				
Slate	815	852				
Sand	852	872			856	3 Bails
Slate	872	905				
3rd. Salt Sand	905	985				
Shells	985	1045				
Sand	1045	1095				
Slate	1095	1100				
Sand	1100	1125				
Red Rock & Shells	1125	1195				
Slime	1195	1210				
Marl Sand	1210	1255				
Slime	1255	1310				
Slime	1310	1325				
Red Rock	1325	1345				
Slime	1345	1365				
Slate	1365	1390				
Red Rock	1390	1400				
Slate	1400	1408				
Big Slime	1408	1479				
Big Slime	1479	1590				
Slate	1590	1610				
Shells	1610	1870				
Heavy Wood	1870	1961				
Slate	1961	1965				
Heavy Wood	1965	2018				
Shells	2018	2080				
Gordon Stray	2080	2090				
Slate	2090	2098				
Gordon Sand	2098	2115				
Slime	2105	2130				
Shells	2130	2175				
Red Rock & Shells	2175	2280				
Sand	2280	2292				
Red Rock & Shells	2292	2365				
4th. Salt Sand	2365	2387			2372	
Slate	2387	2393				
Red Rock	2393	2407				
Bayard	2407	2431				
Slate	2431	2435				
Total Depth		2435				