

LATITUDE

39° 20 (7 1/2)

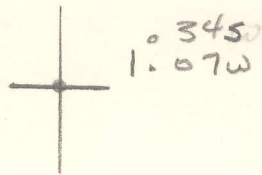

80° 08

LONGITUDE

7.5 OGIS topo location

714 on MMT Co. Rept Map

7.5' loc _____

15' loc _____

Grafted 7 1/2 Equilateral Map

(calc.) _____

Company Pittsburgh: WV Gas

Farm Hugh Evans 1 (2329)

WELL LOCATION MAP

File No. 091-14A ✓

Quad GRAFTON 7.5

County Taylor

District Booths Creek

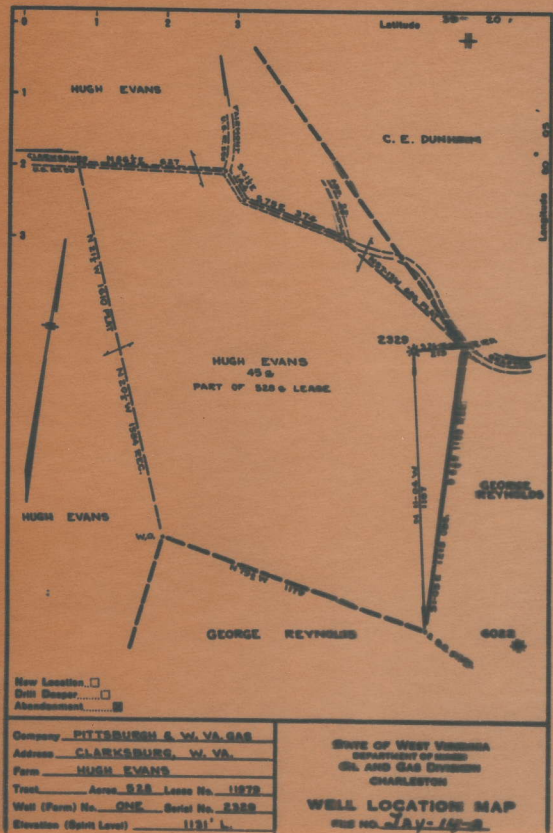

Grafton 75

High Evans
 Location (Township) Fairmont S/E. 1-3
 Well No. 2329 Elev. 1131' 1
 District Court House County Taylor
 The surface of tract is owned in fee by T. Va., Industrial School for Boys. Address Grafton, W. Va.,
 Mineral rights are owned by T. Va. Industrial School Address Grafton, W. Va.,
 Drilling commenced No Record.
 Drilling completed No Record.
 Date shut
 Open Flow 10ths Water in Inch
 10ths Merc. in Inch
 Volume Cu. Ft.
 Back Pressure lbs.
 Oil bbls. in 24 hrs.
 Fresh water feet
 Salt water feet
 No Casing Record.
 810'
 1100'
 Kind of Drucker ?
 Size of 6-5/8" I 2"
 Depth set ?
 Perf. top
 Perf. bottom
 Perf. top
 Perf. bottom

Volume	Cu. Ft.	CASING CEMENTED	SIZE	No. Ft.	Date
Back Pressure	lbs.				
Oil	bbls. in 24 hrs.	COAL WAS ENCOUNTERED AT			
Fresh water	feet	315 FEET	48 INCHES	105 FEET	? INCHES
Salt water	feet			560 FEET	60 INCHES

Formation	Color	Hard or Soft	Top	Bottom	Oil, Gas or Water	Depth Found	Remarks
Un-recorded			0	105			
Coal			105	?			
Un-recorded			?	315			
Coal			315	319			
Un-recorded			319	560			
Coal			560	565			
Un-recorded			565	891			
Salt Sand			891	?			
Un-recorded				1333			
Big Injun			1333	1454			
Un-recorded			1454	1725			
Sand			1725	1805			
Un-recorded			1805	1825			
Sand			1825	1864			
Un-recorded			1864	1867			
Sand			1867	1889			
Un-recorded			1889	1914			
Sand			1914	1964			
Un-recorded			1964	2116			
Garden Sand			2116	2140	Gas	2140'	
Un-recorded			2140	2206			
Sand			2206	2211	Gas	2207'	
Red Sand			2211	2266			
Un-recorded			2266	2300			
Sand & Lime			2300	2340			
Un-recorded			2340	2380			
5th. Sand			2380	2385	Gas	2380'	
Slate			2385	2630	Gas	2385'	
Total Depth				2630			



AFFIDAVIT SHOULD BE MADE IN TRIPPLICATE. ONE COPY TO BE FILED IN THE DEPARTMENT ONE COPY TO BE RETAINED BY THE WELL OPERATOR AND THE THIRD COPY, AND OTHER COPIES IF REQUIRED, SHOULD BE MAILED TO EACH COAL OPERATOR AT THEIR RESPECTIVE ADDRESSES.

West Virginia Industrial School
For Boys COAL OPERATOR OR OWNER
Grafton, West Va.
ADDRESS

Pittsburgh & West Virginia Gas Co.
NAME OF WELL OPERATOR
Clarksburg, W. Va.
COMPLETE ADDRESS

COAL OPERATOR OR OWNER

August 30th, 1945
WELL AND LOCATION

West Virginia Industrial School
For Boys
LEASE OR PROPERTY OWNER
Grafton, West Va.
ADDRESS

Well No. 2309

Court House District

Taylor County

High Evans Farm

STATE INSPECTOR SUPERVISING PLUGGING Not Inspected

AFFIDAVIT

STATE OF WEST VIRGINIA

County of Harrison

Rildo Brainer

and

Stephen B. Moore

being first duly sworn according to law depose and say that they are experienced in the work of plugging and filling oil and gas wells and were employed by Pittsburgh & West Va. Gas Co., well operator, and participated in the work of plugging and filling the above well, that said work was commenced on the 6th, day of August, 1945, and that the well was plugged and filled in the following manner:

BAND OR ZONE RECORD	FILLING MATERIAL		PLUGS USED	CASING				
	FORMATION	CONTENT		FROM	TO	SIZE & KIND	CSG PULLED	CSG LEFT IN
Slat	Fifth Sand	Un-recorded	Total Depth	2830	Feet			
Un-recorded	Sand & Lime	Clay		2830	2861			
Sand		Cement		2866	2866			
Un-recorded		6-5/8" Wood Plug		2866	2866			
Un-recorded		Clay		1928	1928	4"	1241'	
Sand		6-5/8" Wood Plug		1928	1928	6-1/4"	139'	
Sand		6-5/8" Lead Plug		1928	1928			
Sand		Cement		1914	1914			
Un-recorded		6-5/8" Wood Plug		1914	1914			
Salt Sand		Hole Bridges		975				
Salt Sand		Cement		975	975			
Slat Sand	Un-recorded	Clay		975	830			
Un-recorded		Cement		836	836			
Un-recorded		3-1/4" Wood Plug		825	825			
Un-recorded		Clay		825	595			
Un-recorded	& Coal	Cement		595	540			
Un-recorded		10" Wood Plug		540	537			
Un-recorded	& Coal	Clay		537	539			
Un-recorded		Cement		530	530			
Un-recorded		10" Wood Plug		530	527			
Un-recorded	& Coal	Clay		527	185			
Un-recorded		Cement		140	85			
Un-recorded		10" Wood Plug		85	85			
Un-recorded		Clay		85	5			
Un-recorded	COAL BEAMS	Cement		5	Surface			
(NAME)	Coal Beams							
(NAME)	Coal		105	7				
(NAME)	Coal		315	319				
(NAME)	Coal		560	565				

and that the work of plugging and filling said well was completed on the 27th, day of August, 1945.

And further deponents saith not.

Sworn to and subscribed before me this 12 day of August, 1945.

Rildo Brainer
Stephen B. Moore
T. Howard Davis

My commission expires:

Record of Well No. 2329 Located on Hugh Evans Farm _____ 19____
 District Taylor County West Va State _____
 Division A District No. _____ Drilled under well Order _____
 Rig built by _____ Began _____ 19____ Completed _____ 19____
 Well drilled by _____ Began _____ 19____ Completed _____ 19____
 Depth of Well 2620 feet Size of Hole _____ Producing Gas

CASED WITH			REMARKS
AMOUNT	SIZE	KIND	
			Elev. 1131' G.L.
			This Record is the same as the one in City office
1400	2		

COAL VEINS Off. Coal 150

FORMATIONS

FORMATION	COLOR	OPEN OR CLOSE HARD OR SOFT	TOP	BOTTOM	REMARKS GAS-OIL-WATER (THICKNESS OF PAY)
Coal			215		No casing in hole.
"			560		Casings blown out.
Salt sand			891		Hole full of water.
Big silt			1333	1454	Casings set in 50 ft.
"			1785	1805	
"			1825	1864	
"			1867	1887	
"			1914	1964	
Work sand			2116	2140	Gas 2140
Sand			2206	2211	" 2207
Sand			2211	2266	" 2280
Sand			2300	2345	" 2385
Red sand			2380	2385	

