

LATITUDE 39° 20'

80° 05'

LONGITUDE

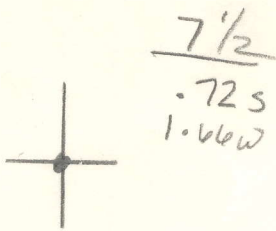

704A in MMT 1913 Co. left (see Summary Table)
 Grafton 7.5 Equitable map *not on map* 7.5' loc _____ 15' loc _____
 (calc.) _____

7.5 OGIS topo location

Company Pittsburgh - WV Gas

Farm CA Gauthrop (6075)

WELL LOCATION MAP

File No. 091-17A

Quad Grafton 7.5

County Taylor

District Booths Creek

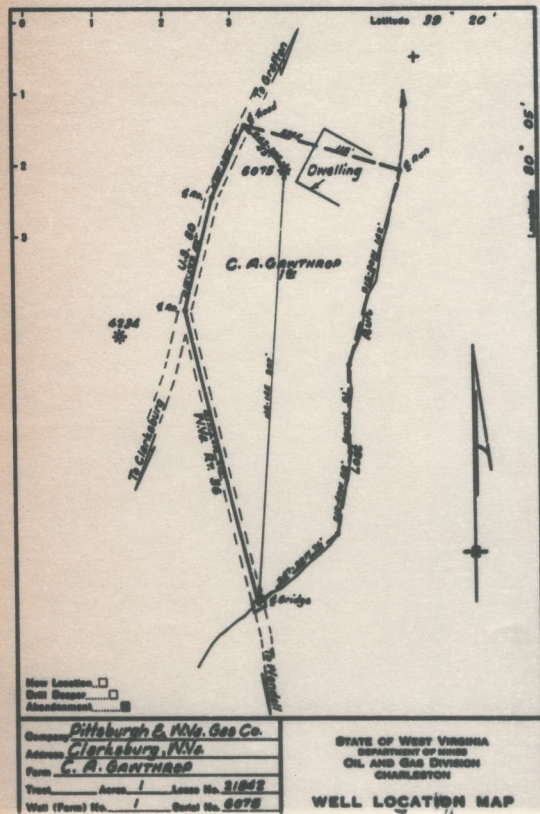

TARD Booths Creek

17A

Grafton 7.5

Company Pittsburgh & West Va Gas Company,
 Address Clarksburg, West Va.,
 Farm C. A. Gawthrop Acres 1
 Location (waters) Farmont S/E. 1-3
 Well No. 6075 Elev. 1108' L
 District Booths Creek County Taylor
 The surface of tract is owned in fee by Hasel Isaac
R.D. #2 Address Grafton, W. Va.
 Mineral rights are owned by F. A. ~~Wagoner~~ Alcorn
R.D. #1 Address Flemington, W. Va.
 Drilling commenced _____
 Drilling completed April 28th, 1913
 Date Shot _____ From _____ To _____
 With _____

Casing and Tubing	Used in Drilling	Left in Well	Packers
Size			
16			Kind of Packer
13			
10			Size of
8 1/4	758'	758'	
6 1/2	1176'	1176'	Depth set
5 3/16			
3			Perf. top
2			Perf. bottom
Liners Used			Perf. top
			Perf. bottom

Open Flow _____ /10ths Water in _____ Inch
 _____ /10ths Merc. in _____ Inch
 Volume _____ Cu. Ft.
 Rock Pressure _____ lbs. _____ hrs.
 Oil _____ bbls., 1st 24 hrs.
 Fresh water _____ feet
 Salt water _____ feet

CASING CEMENTED _____ SIZE _____ No. Ft. _____ Date _____

COAL WAS ENCOUNTERED AT 324 FEET 48 INCHES
470 FEET 48 INCHES 500 FEET 72 INCHES
590 FEET 72 INCHES _____ FEET _____ INCHES

Formation	Color	Hard or Soft	Top	Bottom	Oil, Gas or Water	Depth Found	Remarks
Un-recorded Sand			0	285	Water	165'	
Coal			285	324			
Un-recorded Coal			324	328			
Coal			328	470			
Un-recorded Coal			470	474			
Coal			474	500			
Un-recorded Coal			500	506			
Sand			506	510			
Un-recorded Sand			510	535			
Coal			535	580			
Un-recorded Coal			580	586			
Sand			586	635			
Un-recorded Sand			635	864			
Big Lime			864	1170	Water	690'	
Un-recorded Big Lime			1170	1265			
Big Injun			1265	1380			
Un-recorded Big Injun			1380	1695			
Fifty Foot Sand			1695	1765			
Un-recorded Fifty Foot Sand			1765	2097			
Fifth Sand			2097	2143	Gas	2095'	
Un-recorded Fifth Sand			2143	2148	Gas	2107'	
Total Depth			2148	2148	Gas	2110	

AFFIDAVIT OF PLUGGING AND FILLING WELL

AFFIDAVIT SHOULD BE MADE IN TRIPLICATE. ONE COPY MAILED TO THE DEPARTMENT, ONE COPY TO BE RETAINED BY THE WELL OPERATOR AND THE THIRD COPY (AND EXTRA COPIES IF ASSURED) SHOULD BE MAILED TO EACH COAL OPERATOR AT THEIR RESPECTIVE ADDRESSES.

COAL OPERATOR OR OWNER ADDRESS ADDRESS	NAME OF WELL OPERATOR COMPLETE ADDRESS WELL AND LOCATION District County Farm
LEASE OR PROPERTY OWNER ADDRESS	Well No. _____

STATE INSPECTOR SUPERVISING PLUGGING _____

AFFIDAVIT

STATE OF WEST VIRGINIA,

County of _____

SS:

_____ and _____
 being first duly sworn according to law depose and say that they are experienced in the work of plugging and filling oil and gas wells and were employed by _____ well operator, and participated in the work of plugging and filling the above well, that said work was commenced on the _____ day of _____, 1947, and that the well was plugged and filled in the following manner:

SAND OR ZONE RECORD	FILLING MATERIAL	PLUGS USED	CASING
Un-recorded-Prep. sand	Total content 2178 feet		
2 Fifty Foot Sand	Clay 1770		
Fifty Foot Sand	Clay 1770		
Fifty Foot Sand	6-5/8" Wood Plug 1770		
Fifty Foot Sand	Cement 1770		
Fifty Foot Sand	6-5/8" Wood Plug 1770	(slipped 6-5/8" casing 583' to 520'-	
50 Ft. Sand & Un-recorded	Clay 1770	" 6-5/8" casing 503' to 500'-	
Un-recorded	Clay 1770	" 6-5/8" casing 473' to 470'-	
Un-recorded-Dig Injun. L.	Cement 1770	" 6-5/8" casing 327' to 324'-	
Dig Lime	Clay 1770		
Dig Lime	Cement 1770		
Dig Lime	6-5/8" Wood Plug 1770	Two rips in each coal.)	
Sand	Hole Bridged 750		
Sand	Cement 750		
Sand & Un-recorded	Clay 750	(750 feet 8-1/4" casing previously	
Un-recorded & Coal	Cement 750	pulled.)	
Un-recorded	6-5/8" Wood Plug 750		
Un-recorded	Clay 750		
Un-recorded-Sand & Coal	Cement 750		
Un-recorded	6-5/8" Wood Plug 750		
Un-recorded	Clay 750		
Un-recorded-Coal & Sand	Cement 750		
Sand	6-5/8" Wood Plug 750		
Sand & Un-recorded	Clay 750		
Un-recorded	Cement 750		
(NAME) Coal	750	Cast Iron Plate Lettered	
(NAME) Coal	750	Reinforced Va. Gas Co. #6075	
(NAME) Coal	750	Bolted in top of cement block.	
(NAME) Coal	750		

and that the work of plugging and filling said well was completed on the _____ day of _____, 1947.

And further deponents saith not.

Sworn to and subscribed before me this _____ day of _____, 1947.

 James A. Shiner

FORM: G 38-14263

Record of Well No. 6095 Located on Thomas A. Hawthrop Farm 19
Booths Creek District Taylor County West Va State
 Division W District No. _____ Drilled under well Order _____
 Rig built by _____ Began _____ 19 _____ Completed _____ 19 _____
 Well drilled by _____ Began _____ 19 _____ Completed April 28 1913
 Depth of Well 2148 feet Size of Hole _____ Producing Gas
Purchased from Comet Oil & Gas Co. June 1-1935

GASED WITH			REMARKS
AMOUNT	SIZE	KIND	
<u>758'</u>	<u>8 1/4"</u>	<u>Casing</u>	
<u>1176'</u>	<u>6 5/8"</u>	<u>"</u>	
<u>2148'</u>	<u>3"</u>	<u>Packing</u>	<u>Packer set at 1935 ft.</u>

FORMATIONS					
FORMATION	COLOR	OPEN OR CLOSE HARD OR SOFT	TOP	BOTTOM	REMARKS GAS-OIL-WATER (THICKNESS OF PAY)
<u>Speed</u>			<u>635</u>	<u>864</u>	
<u>Big lime</u>			<u>1170</u>	<u>1265</u>	
<u>Big lime</u>			<u>1265</u>	<u>1380</u>	
<u>Little foot</u>			<u>1695</u>	<u>1765</u>	
<u>Clarion sand</u>			<u>2097</u>	<u>2143</u>	<u>Gas 2098-2107-2110</u>
<u>Clarion</u>			<u>2148</u>		

70027 T. A. Gawthrop No. 1 Well Record (704A).

17A Booths Creek district, 2 miles southwest of Pruntytown. Authority, Comet Oil and Gas Company. Completed in May, 1913.

	Thickness. Feet.	Total. Feet.
Conductor	25	25
Unrecorded (Water, 25' and 165')	260	285
Sand, Little Dunkard	21	306
Unrecorded	18	324
Coal, (Upper Freeport)	4	328
Unrecorded	142	470
Coal (Lower Kittanning)	4	474
Unrecorded	26	500
Coal (Clarion) (water)	6	506
Unrecorded	4	510
Sand	25	535
Unrecorded	45	580
Coal (Upper Mercer)	6	586
Unrecorded	49	635
Sand (Salt) (water, 690')	129	864
Unrecorded	306	1170
Big Lime	95	1265
Big Injun sand	115	1380

	Thickness. Feet.	Total. Feet.
Unrecorded	315	1695
Sand, Fifty-foot	70	1765
Unrecorded	332	2097
Sand, Fifth (Gas, 2098', 2107', 2110')	46	2143
Unrecorded to bottom	2	2145

This well made about 1,500,000 cu. ft. of gas daily, with a rock pressure of 700 pounds.

FORMATIONS
FORM: 032-5170

Well # 6095. Thomas A. Hawthorn

NAME	TOP	BOTTOM	OIL	GAS	WATER	REMARKS
<i>Conductor</i>	<i>20</i>					
<i>Water</i>	<i>165</i>					
<i>Sand</i>	<i>285</i>	<i>324</i>				
<i>Coal</i>	<i>470</i>	<i>474</i>				
<i>Coal</i>	<i>500</i>	<i>526</i>				
<i>Sand</i>	<i>510</i>	<i>535</i>				
<i>Coal</i>	<i>580</i>	<i>586</i>				
<i>Sand</i>	<i>635</i>	<i>864</i>				
<i>Water</i>	<i>690</i>					
<i>Big lime</i>	<i>1190</i>	<i>1265</i>				
<i>Big lime</i>	<i>1265</i>	<i>1380</i>				
<i>Stiff root sand</i>	<i>1695</i>	<i>1765</i>				
<i>Stiff sand</i>	<i>2097</i>	<i>2142</i>				<i>2098-2107-2110</i>
<i>Clay</i>						
<i>Total Depth</i>	<i>2148</i>					