

Latitude 39° 25'

Longitude 80° 45'

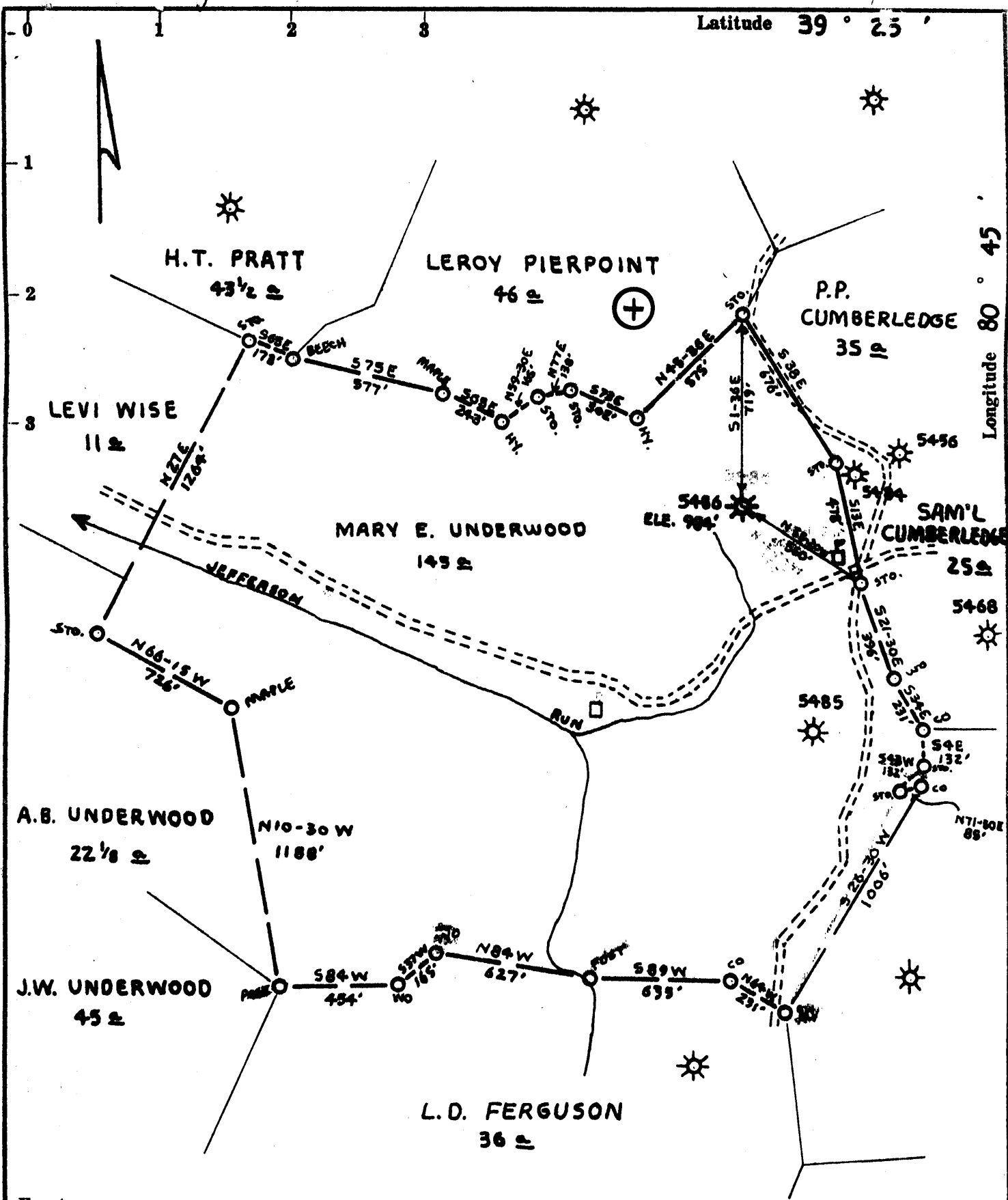

- Fracture...
- Rodriguez...
- New Location...
- Drill Deeper...
- Abandonment...  *Issued 3/14/74*

Source of Elevation ROAD FMS. @ LOW GAP SCHOOL ELEV. 995'

I, the undersigned, hereby certify that this map is correct to the best of my knowledge and belief and shows all the information required by paragraph 6 of the rules and regulations of the oil and gas section of the mining laws of West Virginia.

Minimum accuracy, one part in 200

Company	<b>EQUITABLE GAS CO. W.VA. DIV.</b>
Address	<b>PITTSBURGH PA.</b>
Farm	<b>MARY E. UNDERWOOD</b>
Tract	Acres <b>145</b> Lease No. <b>26211</b>
Well (Farm) No.	<b>1</b> Serial No. <b>5486</b>
Elevation (Spirit Level)	<b>984'</b>
Quadrangle	<b>WEST UNION 43-4 EC</b>
County	<b>TYLER District M<sup>c</sup>ELROY</b>
Engineer	<b>R. A. McMillan</b>
Engineer's Registration No.	<b>105 L.L.S.</b>
File No.	<b>222-16</b> Drawing No.
Date	<b>7-10-73</b> Scale <b>1" = 500'</b>

STATE OF WEST VIRGINIA  
DEPARTMENT OF MINES  
OIL AND GAS DIVISION  
CHARLESTON

WELL LOCATION MAP  
FILE NO. **TYL-463-RED-P**

+ Denotes location of well on United States Topographic Maps, scale 1 to 62,500, latitude and longitude lines being represented by border lines as shown.

— Denotes one inch spaces on border line of original tracing.

**47 095**

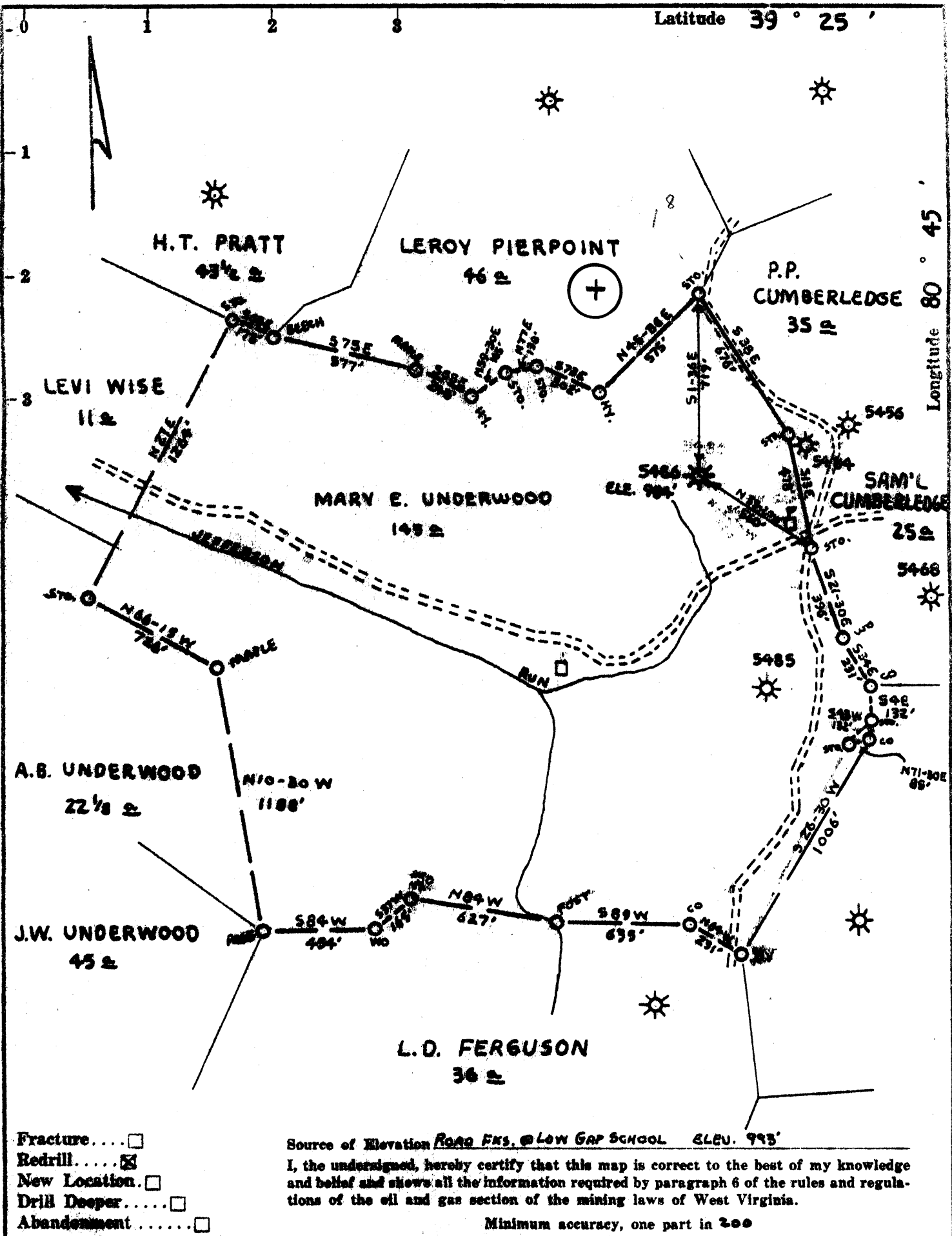

- Fracture.....
- Redrill.....
- New Location.....
- Drill Deeper.....
- Abandonment.....

Source of Elevation ROAD FMS. @ LOW GAP SCHOOL ELEV. 993'

I, the undersigned, hereby certify that this map is correct to the best of my knowledge and belief and shows all the information required by paragraph 6 of the rules and regulations of the oil and gas section of the mining laws of West Virginia.

Minimum accuracy, one part in 200

Company	<b>EQUITABLE GAS CO. W.VA. DIV.</b>
Address	<b>PITTSBURGH PA.</b>
Farm	<b>MARY E. UNDERWOOD</b>
Tract	Acres <b>145</b> Lease No. <b>26211</b>
Well (Farm) No.	<b>1</b> Serial No. <b>5485</b>
Elevation (Spirit Level)	<b>994'</b>
Quadrangle	<b>WEST UNION 4<sup>2</sup>+ EC</b>
County	<b>TYLER District M<sup>c</sup>ELROY</b>
Engineer	<b>R. A. McWilliams</b>
Engineer's Registration No.	<b>105 L.L.S.</b>
File No.	<b>228-16</b> Drawing No.
Date	<b>7-10-73</b> Scale <b>1" = 500'</b>

**STATE OF WEST VIRGINIA**  
**DEPARTMENT OF MINES**  
**OIL AND GAS DIVISION**  
**CHARLESTON**

**WELL LOCATION MAP**  
 FILE NO. **TYL-463-RED**

+ Denotes location of well on United States Topographic Maps, scale 1 to 62,500, latitude and longitude lines being represented by border lines as shown.

— Denotes one inch spaces on border line of original tracing.

**47 095**



**RECEIVED**  
APR 11 1974

STATE OF WEST VIRGINIA  
DEPARTMENT OF MINES

**Oil and Gas Division**

OIL & GAS DIVISION  
DEPT. OF MINES

**WELL RECORD**

Rotary  Oil  
Cable \_\_\_\_\_ Gas  
Recycling \_\_\_\_\_ Comb.  
Water Flood \_\_\_\_\_ Storage  
Disposal \_\_\_\_\_ (Kind)

Quadrangle West Union NE 4.3-4

Permit No. TYL-463-Red (W)

Company Equitable Gas Co.  
Address Pittsburgh, Pa. 15219  
Farm Mary E. Underwood Acres 145  
Location (waters) Jefferson Run  
Well No. 5486 Elev. 984  
District McElroy County Tyler  
The surface of tract is owned in fee by  
Clarence G. Dillon  
Address Wilbur, W. Va. 26459  
Mineral rights are owned by Mary S. Keys  
Address Wilbur, W. Va. 26459

Casing and Tubing	Used in Drilling	Left in Well	Cement fill up Cu. ft. (Sks.)
Size			
20-16			
Cond.			
13-10"			
9 5/8			
8 5/8			
7		1853	
5 1/2			
4 1/2			
3			
2			
Liners Used			

ReDrilling Commenced 2-4-74  
ReDrilling Completed 3-14-74  
Initial open flow \_\_\_\_\_ cu. ft. \_\_\_\_\_ bbls.  
Final production \_\_\_\_\_ cu. ft. per day \_\_\_\_\_ bbls.  
Well open \_\_\_\_\_ hrs. before test \_\_\_\_\_ RP.  
Well treatment details:

Attach copy of cementing record.

Coal was encountered at 652-654 Feet \_\_\_\_\_ Inches  
Fresh water \_\_\_\_\_ Feet \_\_\_\_\_ Salt Water \_\_\_\_\_ Feet \_\_\_\_\_  
Producing Sand \_\_\_\_\_ Depth \_\_\_\_\_

Formation	Color	Hard or Soft	Top Feet	Bottom Feet	Oil, Gas or Water	* Remarks
Gamma Log from surface to 2680						
Pittsburgh Coal (Est.)			652	654		
Gas Sand			1124	1164		
Salt Sand			1230	1627		
Little Lime			1812	1824		
Big Lime			1842	1906		
Big Injun Sand			1909	2058		
Weir Sand			2218	2313		
Gordon Sand			2640	2653		
Total Depth				2691		
Well is not suitable for storage.						
Abandoned 3-14-74						
Verbal permission to plug well was received from R. L. Dodd on 3-18-74.						
Plugged 3-25-74						

1842  
984  
-----  
858

(over)

\* Indicates Electric Log tops in the remarks section.



STATE OF WEST VIRGINIA  
DEPARTMENT OF MINES

RECEIVED

AUG 23 1973

OIL & GAS DIVISION  
DEPT. OF MINES

Oil and Gas Division

OIL AND GAS WELL PERMIT APPLICATION

TO THE DEPARTMENT OF MINES,  
Charleston, W. Va.

DATE August 20, 1973

Surface Owner Clarence G. Dillon  
Address Wilbur, W. Va. 26459  
Mineral Owner Mary S. Keys, Agent  
Address Wilbur, W. Va. 26459  
Coal Owner Same as surface.  
Address \_\_\_\_\_  
Coal Operator \_\_\_\_\_  
Address \_\_\_\_\_

Company Equitable Gas  
Address Pittsburgh, Pa. 15219  
Farm Mary E. Underwood Acres 145  
Location (waters) Jefferson Run  
Well No. 5486 Elevation 984  
District McElroy County Tyler  
Quadrangle West Union NE 4.3-4

THIS PERMIT MUST BE POSTED AT THE WELL SITE  
All provisions being in accordance with Chapter 22,  
of the W. Va Code, the location is hereby approved  
for redrilling. This permit shall expire if  
operations have not commenced by 12-23-73.

Robert L. [Signature]  
Deputy Director - Oil & Gas Division

INSPECTOR TO BE NOTIFIED Paul Garrett  
Paden City, W. Va. PH: 337-9386

GENTLEMEN:

The undersigned well operator is entitled to drill upon the above named farm or tract of land for oil and gas, having fee title thereto, (or as the case may be) under grant or lease dated Nov. 26 1909 by Mary E. Underwood made to Hope Nat. Gas Co. and recorded on the 2nd day of May 1911 in Tyler County, Book 70 Page 77

\_\_\_\_\_ NEW WELL \_\_\_\_\_ DRILL DEEPER \_\_\_\_\_ XX REDRILL \_\_\_\_\_ FRACTURE OR STIMULATE  
\_\_\_\_\_ OIL AND GAS WELL ORIGINALLY DRILLED BEFORE JUNE 5, 1969.

The enclosed plat was prepared by a registered engineer or licensed land surveyor and all coal owners and/or operators have been notified as of the above date.

The above named coal owners and/or operator are hereby notified that any objection they wish to make, or are required to make by Section 3 of the Code, must be received by, or filed with the Department of Mines within ten (10) days. \*

Copies of this notice and the enclosed plat were mailed by registered mail, or delivered to the above named coal operators or coal owners at their above shown respective address \_\_\_\_\_ day \_\_\_\_\_ before, or on the same day with the mailing or delivery of this copy to the Department of Mines at Charleston, West Virginia.

Very truly yours, S. M. Linger  
(Sign Name) Equitable Gas Co.  
Well Operator

Address  
of  
Well Operator

420 Blvd. of the Allies  
Street  
Pittsburgh,  
City or Town  
Pa. 15219  
State

\*SECTION 3 . . . . If no objections are filed or found by the Department of mines, within said period of ten days from the receipt of notice and plat by the department of mines, to said proposed location, the department shall forthwith issue to the well operator a permit reciting the filing of such plat, that no objections have been made by the coal operators or found thereto by the department and that the same is approved and the well operator authorized to proceed.

TYL-463-RED.(W) PERMIT NUMBER

**THIS IS AN ESTIMATE ONLY  
ACTUAL INFORMATION WILL BE SUBMITTED ON OG-10 UPON COMPLETION**

PROPOSED WORK ORDER TO Re DRILL \_\_\_\_\_ DEEPEN \_\_\_\_\_ FRACTURE-STIMULATE \_\_\_\_\_  
 DRILLING CONTRACTOR: (If Known) \_\_\_\_\_ RESPONSIBLE AGENT: \_\_\_\_\_  
 NAME \_\_\_\_\_ NAME H. E. Gardner, Div. Supt.  
 ADDRESS \_\_\_\_\_ ADDRESS Box 1550, Clarksburg, W.Va.  
 TELEPHONE \_\_\_\_\_ TELEPHONE (304)624-6576  
 ESTIMATED DEPTH OF COMPLETED WELL: 1950 ROTARY \_\_\_\_\_ CABLE TOOLS XX  
 PROPOSED GEOLOGICAL FORMATION: Big Injun  
 TYPE OF WELL: OIL \_\_\_\_\_ GAS \_\_\_\_\_ COMB. \_\_\_\_\_ STORAGE XX DISPOSAL \_\_\_\_\_  
 RECYCLING \_\_\_\_\_ WATER FLOOD \_\_\_\_\_ OTHER \_\_\_\_\_

TENTATIVE CASING PROGRAM:

CASING AND TUBING SIZE	USED FOR DRILLING	LEFT IN WELL	CEMENT FILL UP OR SACKS - CUBIC FT.
20 - 16			
<del>18</del> - 10	282	282	
9 - 5/8			
8 - 5/8	1138	1138	
7	1868	Pull 1868	
5 1/2		Run 1920	Cem. to surface
4 1/2			
3			Perf. Top
2			Perf. Bottom
Liners			Perf. Top
			Perf. Bottom

APPROXIMATE FRESH WATER DEPTHS \_\_\_\_\_ FEET \_\_\_\_\_ SALT WATER \_\_\_\_\_ FEET \_\_\_\_\_  
 APPROXIMATE COAL DEPTHS No mineable coal \_\_\_\_\_  
 IS COAL BEING MINED IN THE AREA? No BY WHOM? \_\_\_\_\_

TO DRILL:

SUBMIT FIVE (5) COPIES OF OG - 1, \$100.00 PERMIT FEE, PERFORMANCE BOND AND PERMANENT COPY OF PLAT.

TO DRILL DEEPER OR REDRILL:

SUBMIT FIVE (5) COPIES OF OG - 1, SHOWING ORIGINAL PERMIT NUMBER AND PERFORMANCE BOND. ON WELLS DRILLED PRIOR TO 1929, A PERMANENT COPY OF THE PLAT AND THE ORIGINAL WELL RECORD MUST ALSO BE SUBMITTED.

TO FRACTURE - STIMULATE:

OIL AND/OR GAS WELL ORIGINALLY DRILLED BEFORE JUNE 5, 1929, FIVE (5) COPIES OG - 1, PERFORMANCE BOND, PERMANENT PLAT AND ORIGINAL WELL RECORD.

OIL AND/OR GAS WELL ORIGINALLY DRILLED ON AND/OR AFTER JUNE 5, 1929, FIVE COPIES OG - 1, SHOWING ORIGINAL PERMIT NUMBER, AND PERFORMANCE BOND.

Required forms must be filed within ninety (90) days of completion for bond release. Inspector to be notified twenty-four (24) hours in advance.

The following waiver must be completed by the coal operator if the permit is to be issued within ten days of receipt thereof.

WAIVER: I the undersigned, Agent for \_\_\_\_\_ Coal Company, Owner or Operator of the coal under this lease have examined and place on our mine maps this proposed well location.

We the \_\_\_\_\_ Coal Company have no objections to said well being drilled at this location, providing operator has complied with all rules and regulations in Articles 4, 5, and 7, Chapter 22 of the West Virginia Code.

\_\_\_\_\_  
For Coal Company

\_\_\_\_\_  
Official Title