

LATITUDE 39° 32' 30"

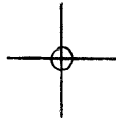

00,05,08 LONGITUDE

7'5 OGIS topo location

7.5' loc	<u>1.10 S</u>	15' loc	<u>3.98 S</u>
	<u>1.58 W</u>	(calc.)	<u>1.58 W</u>

Company \_\_\_\_\_

Farm \_\_\_\_\_

New Martinsville SC

Quad PORTERS FALLS 7 1/2'

County TYLER

District ELLSWORTH

WELL LOCATION MAP

File No. 095 - 627

(030)

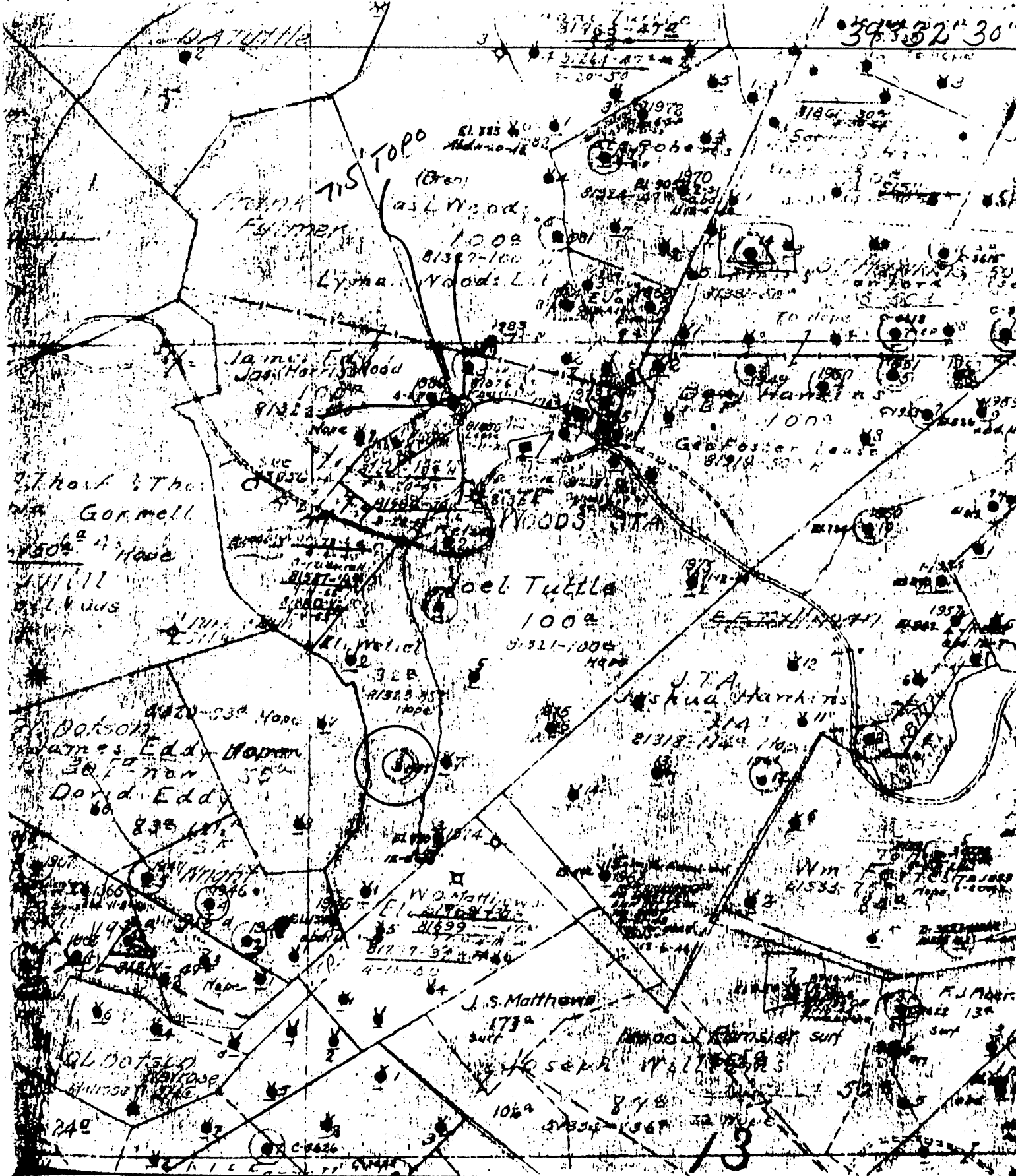

(+) DENOTES LOCATION OF WELL ON UNITED STATES TOPOGRAPHIC MAPS

FORM IV-6  
(8-78)  
N56 N6 W13



STATE OF WEST VIRGINIA  
DEPARTMENT OF MINES  
OIL AND GAS DIVISION

DATE Jan 2, 1979  
OPERATOR'S WELL NO. 3  
API WELL NO. 47-095-627  
STATE COUNTY PERMIT

WELL TYPE: OIL  GAS \_\_\_\_\_ LIQUID INJECTION \_\_\_\_\_ WASTE DISPOSAL \_\_\_\_\_  
(IF "GAS", PRODUCTION \_\_\_\_\_ STORAGE \_\_\_\_\_ DEEP \_\_\_\_\_ SHALLOW   
LOCATION: ELEVATION N/A WATER SHED ELK FORK  
DISTRICT Ellsworth COUNTY Tyler  
QUADRANGLE PORTERS FALLS 7.5'  
SURFACE OWNER \_\_\_\_\_ ACREAGE \_\_\_\_\_  
OIL & GAS ROYALTY OWNER \_\_\_\_\_ LEASE ACREAGE \_\_\_\_\_  
LEASE NO. \_\_\_\_\_  
PROPOSED WORK: DRILL \_\_\_\_\_ CONVERT \_\_\_\_\_ DRILL DEEPER \_\_\_\_\_ REDRILL \_\_\_\_\_ FRACTURE OR  
STIMULATE \_\_\_\_\_ PLUS OFF OLD FORMATION \_\_\_\_\_ PERFORATE NEW  
FORMATION \_\_\_\_\_ OTHER PHYSICAL CHANGE IN WELL (SPECIFY) \_\_\_\_\_  
PLUS AND ABANDON \_\_\_\_\_ CLEAN OUT AND REPLUS \_\_\_\_\_  
TARGET FORMATION \_\_\_\_\_ ESTIMATED DEPTH \_\_\_\_\_  
WELL OPERATOR Pennzoil Company DESIGNATED AGENT James A. Green  
ADDRESS P. O. Box 1588 ADDRESS P. O. Box 1588  
Parkersburg, WV 26101 Parkersburg, WV 26101

Eli WETZEL-3

NO 1

# SOUTH PENN OIL COMPANY—COMPLETION

SERIAL NO. \_\_\_\_\_ FARM E. J. WETZEL WELL NO. 3  
ELEVATION \_\_\_\_\_ N 5 S \_\_\_\_\_ E. \_\_\_\_\_ W. 13  
LEASE NO. \_\_\_\_\_ ACRES \_\_\_\_\_

WATERS OF Elk Fork  
DISTRICT Ellsworth COUNTY Tyler STATE West Va.

DRILLING COMMENCED \_\_\_\_\_ COMPLETED \_\_\_\_\_ DEPTH 2132

SANDS	TOP	BOTTOM	ELEV. TOP	CASING
PSH. COAL OR BIG LIME <u>Keener</u>	<u>2105</u>			<u>6 5/8</u> <u>2035</u>
				PACKERS AND DEPTH SPT

INITIAL PROD. \_\_\_\_\_  
GAB TO 8/6/99 \_\_\_\_\_ SAND. Keener DEPTH 2115  
SHOT 9/26/99 QUARTS 5 20 \_\_\_\_\_ No Rec.  
REMARKS \_\_\_\_\_ No Rec.

REPORTED BY W. H. HART \_\_\_\_\_ ABANDONED \_\_\_\_\_