

Latitude (15') 30° 23' 30"

13,000' SOUTH
1500' WEST

110 ACRES
SURFACE: W. PAUL McCUTCHAN
MINERALS: 1/2 W. P. McCUTCHAN
1/2 HATTIE BRADFORD HEIRS

WELL 1 = 085-0676-18
WELL 2 = 085-0679-18

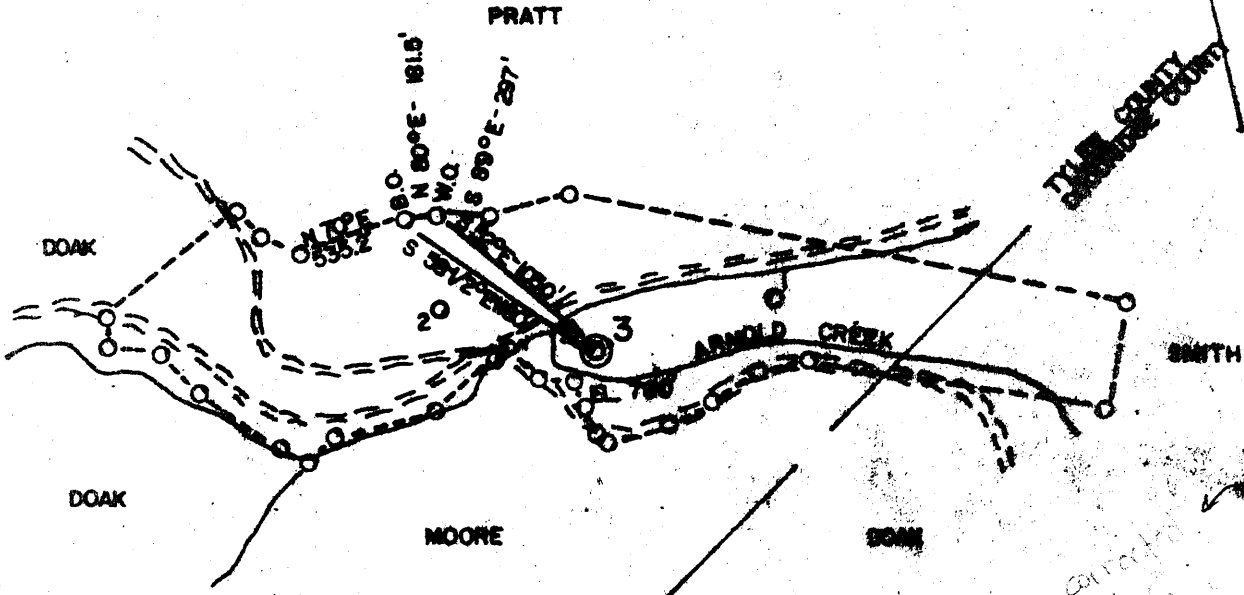

Handwritten notes: 5,345, 0.24W, 5,245, 0.24W



ACCURACY: 1'/200'

- New Location
Drill Deeper
Abandonment
Fracture
Redrill
Other

Formation CONG RIM
Est. Depth 1080'

Source of Elevation DEEP VALLEY (780')

I, the undersigned, hereby certify that this map is correct to the best of my knowledge and belief and shows all the information required by paragraph 1 of the regulations of the oil and gas section of the mining laws of West Virginia.

Signature of Chet Waterman



Company INDUSTRIAL GAS ASSOCIATES
Address GREENWICH, CONN.
Surface Owner W. PAUL McCUTCHAN
Mineral Owner 1/2 W. P. McCUTCHAN
1/2 HATTIE BRADFORD HEIRS
Well No. 3 Acres 110
Elevation 780' 671 1335
Quadrangle WEST UNION Series 7.5, 15'
County TYLER District CENTERVILLE
Date 7/3/79 Scale 1" = 1000'

STATE OF WEST VIRGINIA
DEPARTMENT OF MINES
OIL AND GAS DIVISION
CHARLESTON

WELL LOCATION MAP
47 - 085 - 0715
STATE COUNTY PERMIT

+ Denotes location of well on United States Topographic Maps.
Engineer CHET WATERMAN AUG 7 1979
Engineer's Registration No. 5785 File No. 79-435

FORM IV-35 (Obverse)

WELL OPERATOR'S REPORT OF

[08-78]

DRILLING, FRACTURING AND/OR STIMULATING, OR PHYSICAL CHANGE

WELL TYPE: Oil X / Gas ___ / Liquid Injection ___ / Waste Disposal ___
(If "Gas", Production ___ / Underground storage ___ / Deep ___ / Shallow ___)

LOCATION: Elevation: 780' Watershed: Arnolds Creek
District: Centerville County: Tyler Quadrangle: _____

OPERATOR Industrial Gas Assoc. DESIGNATED AGENT Dallas Frederick
Address Box 1610 Address Box 13
Greenwich, CT 06830 Nobe, WV 26158

PERMITTED WORK: Drill X / Convert ___ / Drill deeper ___ / Redrill ___ / Fracture or stimulate ___
Plug off old formation ___ / Perforate new formation ___
Other physical change in well (specify) _____

PERMIT ISSUED ON July 13, 19 79 OIL & GAS INSPECTOR FOR THIS WORK:
Name Philip Tracy
Address Box 173 Dodd St.

IF APPLICABLE: PLUGGING OF DRY HOLE OR CONTINUOUS PROGRESSION FROM DRILLING OR REWORKING. VERBAL PERMISSION OBTAINED _____
Well suspended awaiting further evaluation. Middlebourne, WV

GEOLOGICAL TARGET FORMATION: Cow Run Depth 948' feet
Depth of completed well, 948 feet Rotary ___ / Cable Tools ___
Water strata depth: Fresh, ___ feet; salt, ___ feet.
Coal seam depths: none Is coal being mined in the area? no
Work was commenced July 20, 19 79, and completed July 31, 19 79 ✓

LOGGING AND TUBING PROGRAM

LOGGING OR TUBING TYPE	SPECIFICATIONS					FOOTAGE INTERVALS		CEMENT FILL-UP OR SACKS (Cubic feet)	PACKERS
	Size	Grade	Weight per ft	New	Used	For drilling	Left in well		
Drill pipe									Kinds
Surface water	7"		24/17	X			157'	50 sks.	
Log									Sizes
Intermediate									
Production	4 1/2"		10.5				920'	60 sks	Depth set
Case									
Tools									Perforations:
									Top Bottom

RECEIVED
FEB 25 1981

DIVISION OF OIL & GAS
DEPARTMENT OF ENERGY

FLOW DATA

Producing formation Dry-Cow Run Pay zone depth 860-890 feet
Gas: Initial open flow, ___ Mcf/d Oil: Initial open flow, none Bbl/d
Final open flow, ___ Mcf/d Final open flow, ___ Bbl/d
Time of open flow between initial and final tests, ___ hours
Static rock pressure, ___ psig (surface measurement) after ___ hours shut in

[If applicable due to multiple completion--]

Second producing formation none Pay zone depth ___ feet
Gas: Initial open flow, ___ Mcf/d Oil: Initial open flow, ___ Bbl/d
Final open flow, ___ Mcf/d Final open flow, ___ Bbl/d
Time of open flow between initial and final tests, ___ hours
Static rock pressure, ___ psig (surface measurement) after ___ hours shut in

MAR 02 1981

WELLS OF PERFORATED INTERVALS, FRACTURING OR STIMULATING, PHYSICAL CHANGE, ETC.

From 860' to 890' (total of 14 shots)

LOG

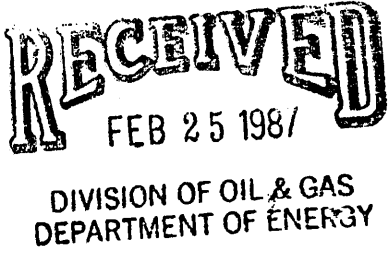
FORMATION	Color	Hard or Soft	Top Feet	Bottom Feet	Remarks Including indication of all fresh and salt water, coal, oil and gas
Horse Neck			222	268	
<u>2nd Cow Run</u>			855	909	
				TD 948	

(Attach separate sheets to complete as necessary)

Industrial Gas Associates

Well Operator

By

General Partner

NOTE: Regulation 2.02(i) provides as follows:

"The term 'log' or 'well log' shall mean a systematic, detailed geological record of all formations, including coal, encountered in the drilling of a well."

Well suspended awaiting further evaluation.

**THIS IS AN ESTIMATE ONLY
ACTUAL INFORMATION WILL BE SUBMITTED ON OG-10 UPON COMPLETION**

PROPOSED WORK ORDER TO XXX DRILL _____ DEEPEN _____ FRACTURE-STIMULATE _____
 DRILLING CONTRACTOR: (If Known) _____ RESPONSIBLE AGENT: _____
 NAME Quest Drilling Co. NAME Dallas Frederick
 ADDRESS New Concord, Ohio ADDRESS Box 13, Nobe, WV
 TELEPHONE 614-826 4144 TELEPHONE 354-7484
 ESTIMATED DEPTH OF COMPLETED WELL: 1,000 ROTARY XX CABLE TOOLS _____
 PROPOSED GEOLOGICAL FORMATION: Cow Run
 TYPE OF WELL: OIL _____ GAS _____ COMB. XX STORAGE _____ DISPOSAL _____
 RECYCLING _____ WATER FLOOD _____ OTHER _____

TENTATIVE CASING PROGRAM:

CASING AND TUBING SIZE	USED FOR DRILLING	LEFT IN WELL	CEMENT CH. UP OR SACKS - CUBIC FT.
20 - 16			
13 - 10			
9 - 5/8			
8 - 5/8			
7	150	150	Cir.
5 1/2			
4 1/2	1000	1000	40 sks
3			Perf. Top
2			Perf. Bottom
Liners			Perf. Top
			Perf. Bottom

APPROXIMATE FRESH WATER DEPTHS 50 FEET _____ SALT WATER _____ FEET _____
 APPROXIMATE COAL DEPTHS N/A _____
 IS COAL BEING MINED IN THE AREA? NO BY WHOM? _____

TO DRILL:

SUBMIT FIVE (5) COPIES OF OG - 1, \$100.00 PERMIT FEE, PERFORMANCE BOND AND PERMANENT COPY OF PLAT.

TO DRILL DEEPER OR REDRILL:

SUBMIT FIVE (5) COPIES OF OG - 1, SHOWING ORIGINAL PERMIT NUMBER AND PERFORMANCE BOND. ON WELLS DRILLED PRIOR TO 1929, A PERMANENT COPY OF THE PLAT AND THE ORIGINAL WELL RECORD MUST ALSO BE SUBMITTED.

TO FRACTURE - STIMULATE:

OIL AND/OR GAS WELL ORIGINALLY DRILLED BEFORE JUNE 5, 1929, FIVE (5) COPIES OG - 1, PERFORMANCE BOND, PERMANENT PLAT AND ORIGINAL WELL RECORD.

OIL AND/OR GAS WELL ORIGINALLY DRILLED ON AND/OR AFTER JUNE 5, 1929, FIVE COPIES OG - 1, SHOWING ORIGINAL PERMIT NUMBER, AND PERFORMANCE BOND.

Required forms must be filed within ninety (90) days of completion for bond release. Inspector to be notified twenty-four (24) hours in advance.

The following waiver must be completed by the coal operator if the permit is to be issued within ten days of receipt thereof.

WAIVER: I the undersigned, Agent for _____ Coal Company, Owner or Operator of the coal under this lease have examined and place on our mine maps this proposed well location.

We the _____ Coal Company have no objections to said well being drilled at this location, providing operator has complied with all rules and regulations in Articles 4, 5, and 7, Chapter 22 of the West Virginia Code.

For Coal Company

Official Title