



1) Date: MAY 23, 19 84
 2) Operator's Well No. JK-989
 3) API Well No. 47 - 095 - 1081
 State _____ County _____ Permit _____

STATE OF WEST VIRGINIA
 DEPARTMENT OF MINES, OIL AND GAS DIVISION
 APPLICATION FOR A WELL WORK PERMIT

- 4) WELL TYPE: A Oil / Gas /
 B (If "Gas", Production / Underground storage / Deep / Shallow
 5) LOCATION: Elevation: 1004' / Watershed: STRAIGHT RUN (LKHHIONN)
 District: CENTERVILLE / County: TYLER / Quadrangle: PENNSBORO 7.5'
 6) WELL OPERATOR J & J ENTERPRISES, INC.
 Address P.O. BOX 48
BUCKHANNON, WV 26201
 7) DESIGNATED AGENT RICHARD M. REDDECLIFF
 Address P.O. BOX 48
BUCKHANNON, WV 26201
 8) OIL & GAS INSPECTOR TO BE NOTIFIED
 Name ROBERT A. LOWTHER
 Address GENERAL DELIVERY
MIDDLEBORNE, WV 26149
 9) DRILLING CONTRACTOR:
 Name S.W. JACK DRILLING CO.
 Address P.O. BOX 48
BUCKHANNON, WV 26201
 10) PROPOSED WELL WORK: Drill / Drill deeper / Redrill / Stimulate /
 Plug off old formation / Perforate new formation /
 Other physical change in well (specify) _____
 11) GEOLOGICAL TARGET FORMATION, ALEXANDER
 12) Estimated depth of completed well, 5300' feet
 13) Approximate strata depths: Fresh, 80' feet; salt, N/A feet.
 14) Approximate coal seam depths: 650'-651' Is coal being mined in the area? Yes / No

15) CASING AND TUBING PROGRAM

CASING OR TUBING TYPE	SPECIFICATIONS					FOOTAGE INTERVALS		CEMENT FILL-UP OR SACKS (Cubic feet)	PACKERS
	Size	Grade	Weight per ft.	New	Used	For drilling	Left in well		
Conductor	11 3/4	H-40	42	X		30	0	0 Sacks	Kinds <u>NEAT</u> Sizes Depths set Perforations: Top _____ Bottom _____
Fresh water	8 5/8	ERW	23	X		1104'	1104'	To surface	
Coal	8 5/8	ERW	23	X		1104'	1104'	To surface	
Intermediate									
Production	4 1/2	J-55	10.5	X		5200'	5200'	225 Sacks	
Tubing								or as required by Rule 15-01	
Liners									

OFFICE USE ONLY
 DRILLING PERMIT

Permit number 47-095-1081 Date June 12, 19 84

This permit covering the well operator and well location shown below is evidence of permission granted to drill in accordance with the pertinent legal requirements subject to the conditions contained herein and on the reverse hereof. **Notification must be given to the District Oil and Gas Inspector, (Refer to No. 8) Prior to the construction of roads, locations and pits for any permitted work.** In addition, the well operator or his contractor shall notify the proper district oil and gas inspector 24 hours before actual permitted work has commenced.)

The permitted work is as described in the Notice and Application, plat, and reclamation plan, subject to any modifications and conditions specified on the reverse hereof.

Permit expires June 12, 1986 unless well work is commenced prior to that date and prosecuted with due diligence.

Bond: <u>BB</u>	Agent: <u>MH</u>	Plat: <u>MH</u>	Casing: <u>MH</u>	Fee: <u>1559</u>
-----------------	------------------	-----------------	-------------------	------------------

[Signature]

Administrator, Office of Oil and Gas

NOTE: Keep one copy of this permit posted at the drilling location.

See the reverse side of the APPLICANT'S COPY for instructions to the well operator.

File 12/22/2023



OFFICE USE ONLY

PERMIT MODIFICATIONS AND CONDITIONS (IF ANY) TO THE PROPOSED WELL WORK

1) LOCATION: District: CANTONVILLE County: PUTNAM Elevation: 1900 Wellhead: STATION #1 Station: CANTONVILLE

2) WELL OPERATOR: Name: ROBERT A. FOSTER Address: P.O. BOX 48

3) OIL & GAS INSPECTOR TO BE NOTIFIED: Name: ROBERT A. FOSTER Address: P.O. BOX 48

4) PROPOSED WELL WORK: Drill Drill & deepen Re-drill Submit

5) DRILLING CONTRACTOR: Name: BLACK DRILLING CO. Address: P.O. BOX 48

6) DESIGNATED AGENT: Name: RICHARD J. FOSTER Address: P.O. BOX 48

7) OTHER PHYSICAL CHANGE TO WELL (Specify):

8) GEOLOGICAL TARGET FORMATION: COAL

9) APPROXIMATE TIE-IN DEPTH: 80'

10) APPROXIMATE TIE-IN DEPTH: 80'

11) APPROXIMATE COAL SEAM DEPTH: 80'

12) CASING AND TUBING PROGRAM:

Casing or Tubing Type	Size	Depth	Casing		Tubing	
			Material	Weight	Material	Weight
Conductor	8 1/2"	23'	X	23	X	23
Production	8 1/2"	23'	X	23	X	23
Production	8 1/2"	23'	X	23	X	23

OFFICE USE ONLY

This part of Form IV-2(b) is to record the dates of certain occurrences and any follow-up inspections.

	Date	Date(s)
Application received		
Well work started		
Completion of the drilling process		
Well Record received		
Reclamation completed		

OTHER INSPECTIONS

Reason: _____

Reason: _____

Agent	Plan	Casing	Test
<u>RB</u>	<u>RB</u>	<u>RB</u>	<u>RB</u>

#2278



IV-9
(Rev 8-81)

DATE May 11, 1984

WELL NO. JK-989

State of West Virginia API NO. 47-095-1081

Department of Mines
Oil and Gas Division

CONSTRUCTION AND RECLAMATION PLAN

COMPANY NAME J & J Enterprises, Inc. DESIGNATED AGENT Richard Reddècliff
 Address P.O. Box 48 Buckhannon, WV 26201 Address P.O. Box 48 Buckhannon, WV 26201
 Telephone 304-472-9403 Telephone 304-472-9403
 LANDOWNER Edith Griffin SOIL CONS. DISTRICT Upper Ohio
 Revegetation to be carried out by J & J Enterprises, Inc. (Agent)

This plan has been reviewed by Upper Ohio SCD. All corrections
 and additions become a part of this plan: 5/18/84
 (Date)
Renneth R. Mason
 (SCD Agent)

ACCESS ROAD	LOCATION
Structure <u>Drainage Ditch</u> (A)	Structure <u>Diversion Ditch</u> (1)
Spacing <u>To be constructed along road</u>	Material <u>Soil</u>
Page Ref. Manual <u>2-12</u>	Page Ref. Manual <u>2-12</u>
Structure <u>Road Culvert</u> (B)	Structure <u>Rip-Rap</u> (2)
Spacing <u>Min. size 15"</u>	Material <u>Logs or Brush</u>
Page Ref. Manual <u>2-7</u>	Page Ref. Manual <u>N/A</u>
Structure <u>Cross Drain</u> (C)	Structure _____ (3)
Spacing <u>40'-250' apart depending upon grade</u>	Material _____
Page Ref. Manual <u>2-1</u>	Page Ref. Manual _____

All structures should be inspected regularly and repaired if necessary. All commercial timber is to be cut and stacked and all brush and small timber to be cut and removed from the site before dirt work begins.

REVEGETATION

Treatment Area I

Lime 3 Tons/acre
 or correct to pH 6.5
 Fertilizer 600 lbs/acre
 (10-20-20 or equivalent)
 Mulch Hay 2 Tons/acre
 Seed* KY-31 30 lbs/acre
Annual Rye 10 lbs/acre
Red Clover 5 lbs/acre

Treatment Area II

Lime 3 Tons/acre
 or correct to pH 6.5
 Fertilizer 600 lbs/acre
 (10-20-20 or equivalent)
 Mulch Hay 3 Tons/acre
 Seed* Orchard Grass 30 lbs/acre
Ladino Clover 5 lbs/acre
Red Clover 5 lbs/acre

*Inoculate all legumes such as vetch, trefoil and clovers with the proper bacterium. Inoculate with 3X recommended amount.

PLAN PREPARED BY Smith Land Surveying Co.

ADDRESS 111 South Street

Glenville, WV 26351

PHONE NO. 304-462-5634

12/22/2023

NOTES: Please request landowner's cooperation to protect new seedling for one growing season. Attach separate sheets as necessary for comments.

RECEIVED
 MAY 25 1984
 OIL & GAS DIVISION
 DEPT. OF MINES

ATTACH OR PHOTOCOPY SECTION OF INVOLVED TOPOGRAPHIC MAP.

QUADRANGLE Pennsboro 7.5'

LEGEND

Well Site 



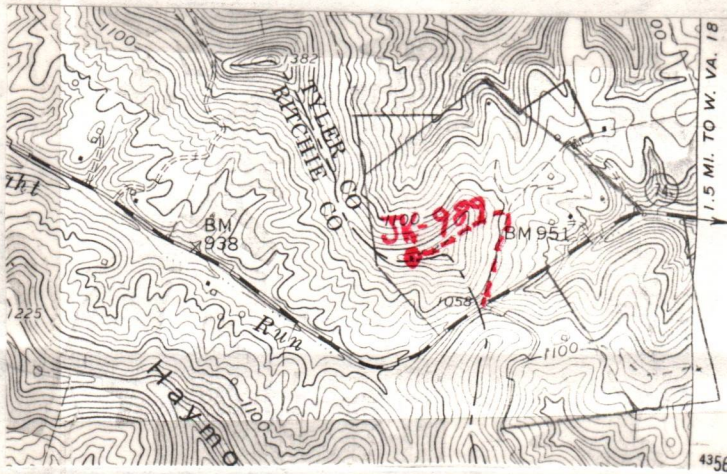







Access Road 



WELL SITE PLAN

Sketch to include well location, existing access road, roads to be constructed, wellsite, drilling pits and necessary structures numbered or lettered to correspond with the first part of this plan. Include all natural drainage.

LEGEND

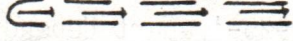
Property boundary 	Diversion 
Road 	Spring 
Existing fence 	Wet spot 
Planned fence 	Building 
Stream 	Drain pipe 
Open ditch 	Waterway 

Access road subject to change between company and land owner, or aquirement of right-of-way. If change is made, a revised reclamation plan will be submitted. All cuts 2:1 slope. All topsoil to be stockpiled and used in reclamation. All grades for roads and locations as well as sediment structures shown on drawing.

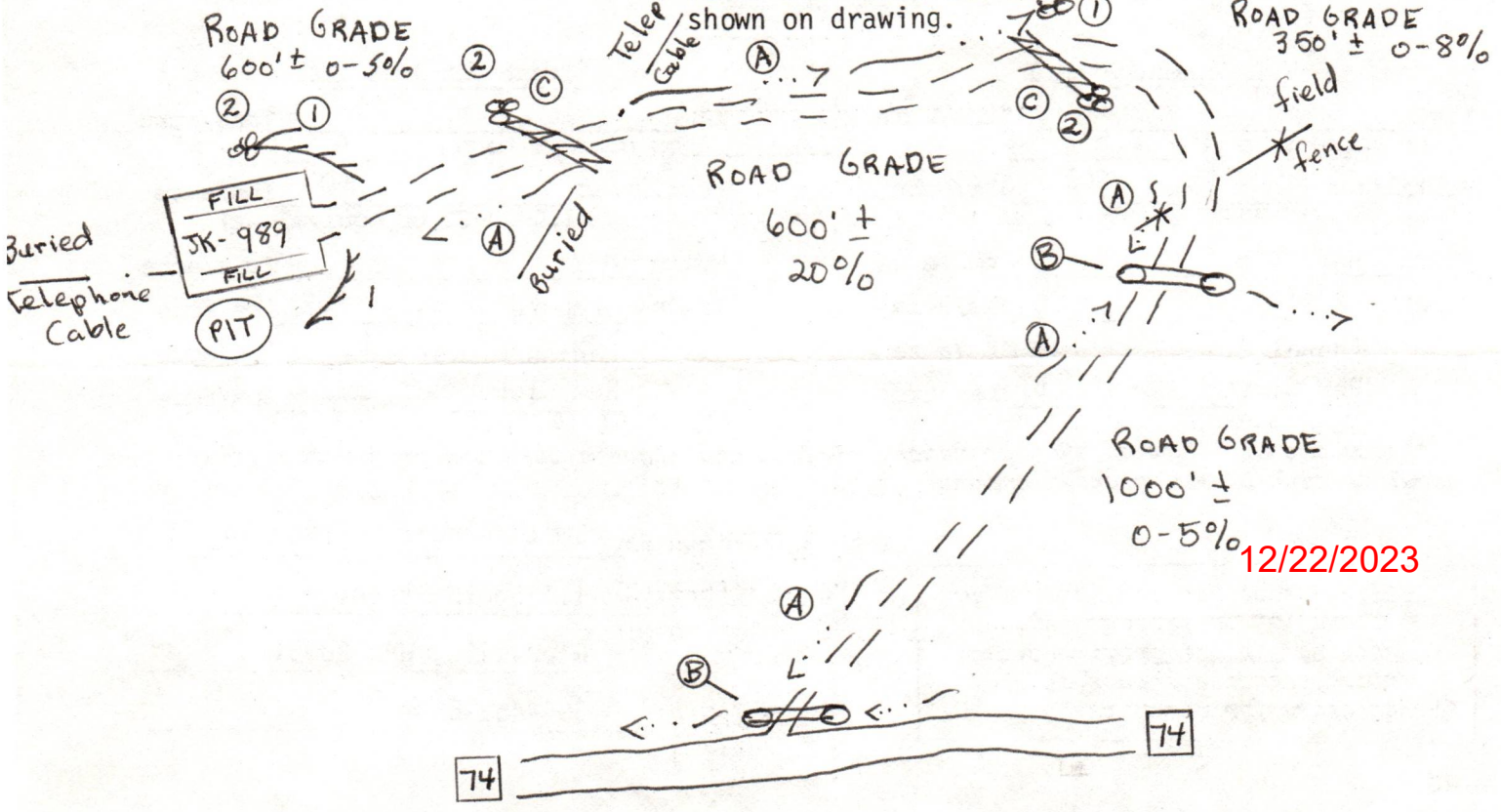

12/22/2023

1) Date: MAY 23, 19 84
2) Operator's Well No. JK-989
3) API Well No. 47-095-1081
State County Permit

STATE OF WEST VIRGINIA
DEPARTMENT OF MINES, OFFICE OF OIL & GAS
NOTICE OF APPLICATION FOR A WELL WORK PERMIT

4) SURFACE OWNER(S) OF RECORD TO BE SERVED
(i) Name EDITH HESS GRIFFIN
Address P.O. BOX 3025
PARKERSBURG, WV 26101
(ii) Name _____
Address _____
(iii) Name _____
Address _____

5 (i) COAL OPERATOR N/A
Address _____
5 (ii) COAL OWNER(S) WITH DECLARATION ON RECORD:
Name same as surface
Address _____
Name _____
Address _____
5 (iii) COAL LESSEE WITH DECLARATION ON RECORD:
Name N/A
Address _____

TO THE PERSON(S) NAMED ABOVE: You should have received this Form and the following documents:

- (1) The Application for a Well Work Permit on Form IV-2(B) (or Form IV-4 if the well is to be plugged, which sets out the parties involved in the drilling or other work, and describes the well and its location and, if applicable, the proposed casing and cementing program;
- (2) The plat (surveyor's map) showing the well location on Form IV-6; and
- (3) The Construction and Reclamation Plan on Form IV-9 (unless the well work is only to plug a well), which sets out the plan for erosion and sediment control and for reclamation for the site and access road.

THE REASON YOU RECEIVED THESE DOCUMENTS IS THAT YOU HAVE RIGHTS REGARDING THE APPLICATION WHICH ARE SUMMARIZED IN THE "INSTRUCTIONS" ON THE REVERSE SIDE OF THE COPY OF THE APPLICATION (FORM IV-2(B) OR FORM 4, DESIGNATED FOR YOU. HOWEVER, YOU ARE NOT REQUIRED TO TAKE ANY ACTION AT ALL.

Take notice that under Chapter 22 of the West Virginia Code, the undersigned well operator proposes to file or has filed this Notice and Application and accompanying documents for a Well Work Permit with the Administrator of the Office of Oil and Gas, West Virginia Department of Mines, with respect to a well at the location described on attached Application and depicted on attached Form IV-6. Copies of this Notice, the Application, the plat, and the Construction and Reclamation Plan have been mailed by registered or certified mail or delivered by hand to the person(s) named above (or by publication in certain circumstances) on or before the day of mailing or delivery to the Administrator.

6) EXTRACTION RIGHTS

Check and provide one of the following:
 Included is the lease or leases or other continuing contract or contracts by which I hold the right to extract oil or gas.
 The requirement of Code 22-4-1-(c) (1) through (4). (See reverse side for specifics.)

7) ROYALTY PROVISIONS

Is the right to extract, produce or market the oil or gas based upon a lease or leases or other contract or contracts providing for flat well royalty or any similar provision for compensation to the owner of the oil or gas in place which is not inherently related to the volume of oil or gas so extracted, produced or marketed? Yes No

If the answer above is No, nothing additional is needed. If the answer is Yes, you may use Affidavit Form IV-60.

See the reverse side for line item instructions, and for instructions concerning the required copies of the Notice and Application, plat, and Construction and Reclamation Plan.

The truth of the information on the Notice and Application is verified and sworn to and the Notice is signed on behalf of the Well Operator in my County and State by
RICHARD M. REDDECLIFF

this 23 day of May, 1984.
My commission expires 12-7, 1992.

Gregory A. Smith
Notary Public, Gilmer County,
State of West Virginia

WELL OPERATOR J & J ENTERPRISES, INC.
By [Signature]
Its DESIGNATED AGENT
Address P.O. BOX 48
EUCKHANNON, WV 26201
Telephone 472 - 9403

OIL & GAS DIVISION
DEPT. OF MINES

RECEIVED
MAY 25 1984

I N S T R U C T I O N S T O A P P L I C A N T

CONCERNING THE LINE ITEMS:

- 1) Date of Notice.
- 2) Your well name and number.
- 3) To be filled out by the Office of Oil & Gas.
- 4) & 5) Use separate sheet if necessary.
- 4) Surface owner(s) of record to be served with Notice and Application. However, see also Code § 22-4-1b(b) if "more than three tenants in common or other co-owners of interest described in subsection (a) of this section hold interests in such lands".
- 5(i) "Coal Operator" means any person, firm, partnership, partnership association or corporation that proposes to or does operate a coal mine.
- 5(ii, iii) See Code § 22-4-20.
- 6) See Code § 22-4-11(c). However, in lieu of filing the lease(s) or other continuing contract(s), the Applicant may fill out the information in the space provided below.
- 7) See Code § 22-4-11(d, e).

CONCERNING THE REQUIRED COPIES FOR FILING AND SERVICE:

Filing. Code § 22-4-1k and Regulation 7.02 provide that the original and required copies of the Notice and Application must be filed with the Administrator, accompanied by (i) a plat in the form prescribed by Regulation 11, (ii) a bond in one of the forms prescribed by Regulation 12, or in lieu thereof the other security allowed by Code § 22-4-1k(d) and the reclamation required by Code § 22-4-12b and Regulation 23, (iv) unless previously paid on the same well, the fees required by Code § 22-4-1a(c) and 22-3-12a, and (v) if applicable, the consent required by Code § 22-4-8a from the owner of any water well on dwelling within 200 feet of the proposed well.

Service. In addition, service must be made on the surface owner(s) and the person(s) with an interest in the coal. See Code § 22-4-1m, 22-4-2, 22-4-2a, and 22-4-2b.

INFORMATION SUPPLIED UNDER CODE § 22-4-11(d)

IN LIEU OF FILING LEASE(S) AND OTHER CONTINUING CONTRACT(S)

Under the oath required to make the verification on the obverse side of this Notice, I depose and say that I am the person who signed the Notice for the Applicant, and that--

- (1) the tract of land is the same tract described in the Application to which this Notice applies, partly or wholly depicted in the accompanying plat, and described in the Construction and Reclamation Plan;
- (2) the parties and recordation data (if recorded) for lease(s) or other continuing contract(s) by which the Applicant claims the right to extract, produce or market the oil or gas are as follows:

<u>Grantor, lessor, etc.</u>	<u>Grantee, lessee, etc.</u>	<u>Royalty</u>	<u>Book Page</u>
EDITH A. & O.W. GRIFFIN	J & J ENTERPRISES, INC.	$\frac{1}{8}$ 100%	247/55

P 574 015 741

RECEIPT FOR CERTIFIED MAIL

NO INSURANCE COVERAGE PROVIDED
NOT FOR INTERNATIONAL MAIL

(See Reverse)

* U.S.G.P.O. 1983-403-517

PS Form 3800, Feb. 1982

Sent to O.W. & EDITH H. GRIFFIN	
Street and No. P.O. BOX 3025	
P.O., State and ZIP Code PARKERSBURG, WV 26101	
Postage	\$ 1.05
Certified Fee	.75
Special Delivery Fee	
Restricted Delivery Fee	
Return Receipt Showing to whom and Date Delivered	.60
Return receipt showing to whom, Date, and Address of Delivery.	
TOTAL Postage and Fees	\$ 2.40



DEPT. OF MINES
OIL & GAS DIVISION

RECEIVED
MAY 25 1984



RECEIVED
AUG 29 1984

OIL & GAS DIVISION
DEPT. OF MINES

State of West Virginia
Department of Mines
Oil and Gas Division

Date August 27, 1984
Operator's Well No. JK-989
Farm Edith Griffin
API No. 47-095-1081

WELL OPERATOR'S REPORT
OF
DRILLING, FRACTURING AND/OR STIMULATING, OR PHYSICAL CHANGE

WELL TYPE: Oil ___ / Gas x / Liquid Injection ___ / Waste Disposal ___ /
(If "Gas," Production x / Underground Storage ___ / Deep ___ / Shallow x /)

LOCATION: Elevation: 1204 Watershed Straight Run
District: Centerville County Tyler Quadrangle Pennsboro 7.5

COMPANY J&J Enterprises, Inc.

ADDRESS P.O. Box 48, Buckhannon, WV 26201

DESIGNATED AGENT Richard Reddecliff

ADDRESS P.O. Box 48, Buckhannon, WV 26201

SURFACE OWNER Edith Hess Griffin

ADDRESS P.O. Box 3025, Parkersburg, WV 26101

MINERAL RIGHTS OWNER Same as surface

ADDRESS _____

OIL AND GAS INSPECTOR FOR THIS WORK Robert

Lowther ADDRESS Gen. Del., Middlebourne, WV 26149

PERMIT ISSUED 6/12/84

DRILLING COMMENCED 8/4/84

DRILLING COMPLETED 8/10/84

IF APPLICABLE: PLUGGING OF DRY HOLE ON CONTINUOUS PROGRESSION FROM DRILLING OR REWORKING. VERBAL PERMISSION OBTAINED ON _____

Casing & Tubing	Used in Drilling	Left in Well	Cement fill up Cu. ft.
Size 20-16 Cond.			
13-10"	30	0	0 sks.
9 5/8			
8 5/8	1312.10	1312.10	325 sks.
7			
5 1/2			
4 1/2	5202.70	5202.70	225 sks.
3			
2			
Liners used			

GEOLOGICAL TARGET FORMATION Alexander Depth 5345-5410 feet

Depth of completed well 5995 feet Rotary x / Cable Tools _____

Water strata depth: Fresh 95,1445 feet; Salt 0 feet

Coal seam depths: None Is coal being mined in the area? No

OPEN FLOW DATA

Producing formation Benson Pay zone depth 5099-5101 feet

Gas: Initial open flow _____ Mcf/d Oil: Initial open flow _____ Bbl/d

Combined Final open flow 600 Mcf/d Final open flow _____ Bbl/d

Time of open flow between initial and final tests 4 hours

Static rock pressure 1800 psig (surface measurement) after 96 hours shut in
(If applicable due to multiple completion--)

Second producing formation Riley Pay zone depth 4694-4740 feet

Gas: Initial open flow _____ Mcf/d Oil: Initial open flow _____ Bbl/d

Final open flow _____ Mcf/d Oil: Final open flow _____ Bbl/d

Time of open flow between initial and final tests _____ hours

Static rock pressure _____ psig (surface measurement) after _____ hours shut in

(Continue on reverse side)

1081

DETAILS OF PERFORATED INTERVALS, FRACTURING OR STIMULATING, PHYSICAL CHANGE, ETC.

Benson: Perforations: 5099-5101(8 holes)

Fracturing: 300 sks. 20/40 sand:520 Bbls. fluid.

Riley: Perforations: 4694-95(2 holes) 4709-13(6 holes) 4718-19(3 holes)4727-29(3 holes)
4738-40(3 holes)

Fracturing: 300 sks. 20/40 sand:500 gal. acid:510 Bbls. fluid.

BOTTOM HOLE PRESSURE $P_f = P_{we}^{XGLS}$

$$t = 60 + (0.0075 \times 5203) + 459.7 = 559 \quad X = \frac{1}{53.35} \times 559 = \frac{1}{29823} = 0.000034 \quad P_f = 1800 \times 2.72^{(0.000034)}$$

$$(0.735)(4898)(0.9) = 1800 \times 2.72^{0.11} = 1800 \times 1.1$$

$P_f = 1980$ psi

WELL LOG

FORMATION	COLOR	HARD OR SOFT	TOP FEET	BOTTOM FEET	REMARKS Including indication of all fresh and salt water, coal, oil and gas
Sand			0	50	
Sand & shale			50	300	
Sand & shale			300	1350	½" stream @ 95'
1st Salt sand			1350	1520	
Sandy shale			1520	1585	Wet @ 1445'
2nd salt sand			1585	1730	
Sand & shale			1730	1870	Gas ck @ 3058 10/10-2" w/water 133,000 cu.ft.
3rd salt sand			1870	1930	
Shale			1930	1975	
Maxton sand			1975	2000	Gas ck @ 3677 10/10-2" w/water 133,000 cu.ft.
Sandy shale			2000	2038	
Little lime			2038	2055	
Shale			2055	2075	Gas ck @ 4599 8/10-2" w/water 119,000 cu.ft.
Big Lime			2075	2150	
Big Injun			2150	2240	
Shale			2240	2260	Gas ck @ 4999 24/10-2" w/water 207,000 cu.ft.
Squaw			2260	2280	
Sandy shale			2280	2450	
Weir			2450	2560	Gas ck @ 5307 12/10-2" w/water 152,000 cu.ft.
Sand & shale			2560	3560	
Warren			3560	3610	
Sand & shale			3610	4694	Gas ck @ collars 12/10-2" w/water 152,000 cu.ft.
Riley			4694	4740	
Sandy shale			4740	5099	
Benson			5099	5101	
Sandy shale			5101	5345	
Alexander			5345	5410	
Sandy shale			5410	5995	
					TD.

(Attach separate sheets as necessary)

J&J Enterprises, Inc.

Well Operator

By: 

12/22/2023

Robert Dahlin-Geologist

Date: 8/27/84

Note: Regulation 2.02(i) provides as follows:

"The term 'log' or 'well log' shall mean a systematic detailed geological record of all formations, including coal, encountered in the drilling of a well."

STATE OF WEST VIRGINIA
DEPARTMENT OF MINES
OIL AND GAS WELLS DIVISION

RECEIVED

AUG 20 1984

OIL & GAS DIVISION
DEPT. OF MINES

INSPECTOR'S WELL REPORT

Permit No. 095-1081

Oil or Gas Well _____
(KIND)

Company J D Enterprises
 Address Buckhannon W. Va.
 Farm Edith Griffen
 Well No. JK 989
 District Centerville County Tyler
 Drilling commenced _____
 Drilling completed 8-11-84 Total depth 5995
 Date shot _____ Depth of shot _____
 Initial open flow _____ /10ths Water in _____ Inch
 Open flow after tubing _____ /10ths Merc. in _____ Inch
 Volume _____ Cu. Ft.
 Rock pressure _____ lbs. _____ hrs.
 Oil _____ bbls., 1st 24 hrs.
 Fresh water _____ feet _____ feet
 Salt water _____ feet _____ feet

CASING AND TUBING	USED IN DRILLING	LEFT IN WELL	PACKERS
Size			
16			Kind of Packer _____
13			
10			Size of _____
8 1/4			
6 3/8			Depth set _____
5 3/16	<u>4 1/2</u>	<u>5202</u>	<u>5202</u>
3			Perf. top _____
2			Perf. bottom _____
Liners Used			Perf. top _____
			Perf. bottom _____

CASING CEMENTED 4 1/2 SIZE 5202 No. FT. 870-84 Date
 NAME OF SERVICE COMPANY Halliburton
 COAL WAS ENCOUNTERED AT _____ FEET _____ INCHES
 _____ FEET _____ INCHES FEET _____ INCHES
 _____ FEET _____ INCHES FEET _____ INCHES

Drillers' Names _____

Remarks: SW Jack Rig 19

Aug 14, 1984
DATE

R. A. Lowther
DISTRICT WELL INSPECTOR



RECEIVED
JUN 5 - 1985
OIL & GAS DIVISION
DEPT. OF MINES

State of West Virginia
Department of Mines
Oil and Gas Division
Charleston 25305

FINAL INSPECTION REPORT
INSPECTORS COMPLIANCE REPORT
October 1, 1984

COMPANY J & J Enterprises, Inc.
P. O. Box 48
Buckhannon, West Virginia 26201

PERMIT NO 095-1081
FARM & WELL NO Edith Griffin #JK-989
DIST. & COUNTY Centerville/Tyler

RULE	DESCRIPTION	IN COMPLIANCE	
		YES	NO
23.06	Notification Prior to Starting Work	<input checked="" type="checkbox"/>	<input type="checkbox"/>
25.04	Prepared before Drilling to Prevent Waste	<input checked="" type="checkbox"/>	<input type="checkbox"/>
25.03	High-Pressure Drilling	<input checked="" type="checkbox"/>	<input type="checkbox"/>
16.01	Required Permits at Wellsite	<input checked="" type="checkbox"/>	<input type="checkbox"/>
15.03	Adequate Fresh Water Casing	<input checked="" type="checkbox"/>	<input type="checkbox"/>
15.02	Adequate Coal Casing	<input checked="" type="checkbox"/>	<input type="checkbox"/>
15.01	Adequate Production Casing	<input checked="" type="checkbox"/>	<input type="checkbox"/>
15.04	Adequate Cement Strenght	<input checked="" type="checkbox"/>	<input type="checkbox"/>
15.05	Cement Type	<input checked="" type="checkbox"/>	<input type="checkbox"/>
23.02	Maintained Access Roads	<input checked="" type="checkbox"/>	<input type="checkbox"/>
25.01	Necessary Equipment to Prevent Waste	<input checked="" type="checkbox"/>	<input type="checkbox"/>
23.04	Reclaimed Drilling Pits	<input checked="" type="checkbox"/>	<input type="checkbox"/>
23.05	No Surface or Underground Pollution	<input checked="" type="checkbox"/>	<input type="checkbox"/>
23.07	Requirements for Production & Gathering Pipelines	<input checked="" type="checkbox"/>	<input type="checkbox"/>
16.01	Well Records on Site	<input checked="" type="checkbox"/>	<input type="checkbox"/>
16.02	Well Records Filed	<input checked="" type="checkbox"/>	<input type="checkbox"/>
7.05	Identification Markings	<input checked="" type="checkbox"/>	<input type="checkbox"/>

I HAVE INSPECTED THE ABOVE CAPTIONED WELL AND RECOMMEND THAT IT BE RELEASED:

SIGNED

R. H. Fowler

DATE

May 30, 1985

Your well record was received and reclamation requirements approved. In accordance with Chapter 22, Article 4, Section 2, the above well will remain under bond coverage for the life of the well.

T. L. ...
Administrator-Oil & Gas Division

June 10, 1985

DATE

12/22/2023

1.0 API well number: (If not available, leave blank. 11 digits.)	47-095-1081			
2.0 Type of determination being sought (Use the codes found on the front of this form.)	108 <small>Section of NGPA</small>	N/A <small>Category Code</small>		
3.0 Depth of the deepest completion location (Only enter well sections 103 or 107 in 2.0 above.)	5101 feet			
4.0 Name, address and code number of applicant (35 letters per line maximum. If code number not available, leave blank.)	J & J Enterprises, Inc. P.O. Box 697 Street Indiana, Pa. 15701 City State Zip Code			009480 <small>Service Code</small>
5.0 Location of this well (Complete (a) or (b).) (a) For onshore wells (35 letters maximum for field name.)	Centerville <small>Field Name</small> Tyler Pa. <small>County State</small>			
(b) For OCS wells:	N/A <small>Area Name</small> <small>Date of Lease:</small> Mo. Day Yr. <small>OCS Lease Number</small>			
(c) Name and identification number of this well (35 letters and digits maximum.)	JK-989			
(d) If code 4 or 5 in 2.0 above, name of the reservoir (35 letters maximum.)	N/A			
6.0 (a) Name and code number of the purchaser: (35 letters and digits maximum. If code number not available, leave blank.)	Purchaser to be determined			
(b) Date of the contract.	Mo. Day Yr.			
(c) Estimated annual production:	MMcf			
	(a) Base Price (\$/MMBTU)	(b) Tax	(c) All Other Prices (Indicate (+) or (-).)	(d) Total of (a), (b) and (c)
7.0 Contract price (As of filing date. Complete to 3 decimal places.)	4 4 3 2	2 7 8	---	4 7 1 0
8.0 Maximum lease rate (As of filing date. Complete to 3 decimal places.)	4 4 3 2	2 7 8	---	4 7 1 0
9.0 Person responsible for this application	J. H. McElwain <small>Name</small> <i>James H. McElwain</i> <small>Signature</small>			Exec.V.President <small>Title</small>
Agency Use Only Date filed and the date Agency DEC - 9 1985 Class. determined by FERC	12-6-85 <small>Date registration is completed</small>			(412) 349-6800 <small>File # Number</small> 12/22/2023

COVER SHEET, STATE APPLICATION FOR WELL CLASSIFICATION

DEC 30 1985

Date: Dec 6, 1985 24150

Applicant's Name: J & J ENTERPRISES, INC.

Address: P.O. Box 697

Indiana, PA. 15701

Gas Purchaser Contract No. _____

Date of Contract _____
(Month, day and year)

First Purchaser: Purchaser to be Determined

Address: _____
(Street or P.O. Box)

(City) _____ (State) _____ (Zip Code) _____

FERC Seller Code 009480

AGENCY USE ONLY

WELL DETERMINATION FILE NUMBER

851209-1080-095-1081

Use Above File Number on all Communications Relating to This Well

Designated Agent: Richard Pedderliff

Address: P.O. Box 48

Buckhannon, WVA 26201

FERC Buyer Code _____

NAME AND TITLE OF PERSON TO WHOM QUESTIONS CONCERNING THIS APPLICATION SHALL BE ADDRESSED:

Name: Vicki Vanderberg _____ (Title) _____

Signature: *Vicki Vanderberg* _____

Address: P.O. Box 697 _____
(Street or P.O. Box) _____
Indiana, PA. 15701

Telephone: 412 _____ (Area Code) _____
(City) _____ (State) _____ (Zip Code) _____
349-6800 _____ (Phone Number)

(Certificate of Proof of Service to Purchaser)

NGPA Category Applied For

NGPA SECTION/SUBSECTION

- 02 New Natural Gas
- 102-2 2.5 Mile Test
- 102-3 1000 Foot Deeper Test
- 102-4 New Onshore Reservoir

- 108 Stripper Well Natural Gas
- 108- Stripper Well
- 108-1 Seasonally Affected
- 108-2 Enhanced Recovery
- 108-3 Temporary Pressure Buildup

- 03 New Onshore Production Well
- 103 New Onshore Production Well

- 07 High Cost Natural Gas
- 107-0 Deep (more than 15,000 feet)
- 107-1 Geopressured Brine
- 107-2 Coal Seams
- 107-3 Devonian Shale
- 107-5 Production enhancement
- 107-6 New Tight Formation
- 107-7 Recompletion Tight Formation

AGENCY USE ONLY

QUALIFIED

12/22/2023

RECEIVED

DEC - 9 1985

DIVISION OF OIL & GAS
DEPARTMENT OF ENERGY

JK-989

STATE OF WEST VIRGINIA
DEPARTMENT OF MINES, OIL AND GAS DIVISION

WELL CLASSIFICATION FORM

STRIPPER GAS WELL

NGPA Section 108

Date: Dec 10, 1985

Operator's Well No. JK-989

API Well No. 47 - 045 - 1081
State County Permit

Well Operator: J & J Enterprises, Inc.

Address: P. O. Box 697
Indiana, PA 15701

Gas Purchaser: To Be Determined

Address: _____

Designated Agent: Richard Reddecliff

Address: P.O. Box 48
Buckhannon, WVA 26201

Location: Elevation 1304

Watershed St. Albans River
Centerline
Dist. _____ County Tyler Quad. _____

Gas Purchase Contract No. 243250

Meter Chart Code 25280989

Date of Contract _____

All applicants must complete FERC Form 121, including question No. 2.0 which should state Section 108 of NGPA.

QUALIFICATIONS

1. Rate of Production

- a.) What date did the well have first production? Sept 10, 1984
- b.) What are the beginning and ending dates of the 90-day production period?

From July 1, 1985 to Sept 30, 1985. During this 90-day production period, what was the total and average per-day production? The well produced a total of 1321 MCF or average 14 MCF per day.

2. Maxium Efficient Rate of Flow

The operator must establish that the well produced at its maxium efficient rate of flow by use of one of the following procedures (Check one):

- a.) If the filing date is more than one year from the date of first production, provide production on IV-39 for twelve months prior to the last day of the 90-day production period (2-1 in item 1). This twelve month period is 10 01 85 through 09 30 85 and produced a total of 2020 MCF or average 19 per day. 12/22/2023

b.) If the well does not have a 12-month history of production; but has recently

produced an average of 60 Mcf or less per production day for the 90-day period (item 1). All available months of production preceding the filing date are shown on Form IV-39.

c.) Will the maximum efficient rate of flow be established by other evidence? NO

Dates

a.) List the dates during the production period (including the 90-day production period) which gas was not produced. N/A

b.) Why was no gas produced on these dates? N/A

Crude Oil

How much oil did the well produce during the 90-day production period? NONE
How much oil per day? _____ (total bbls)

List all records reasonably available to you which contain information relevant to a determination of eligibility (including production records, B&O Tax records and royalty payment records) and indicate the location of such records.

Describe the search made of any records listed above:

AFFIDAVIT

I, James H. McElwain, having been first sworn according to law, state that I have caused to be made a diligent search of those records hereinbefore indicated in the manner herein described, that the information contained in this document is true and accurate and that on the basis of the records and examinations hereinbefore described, and to the best of my information, knowledge and belief, the well for which certification is sought qualifies as a stripper well.

James H. McElwain
Executive Vice President

OF Pennsylvania
OF Indiana, TO-WIT:

Vicki L. Vanderberg, a Notary Public in and for the state and county of Indiana, do certify that James H. McElwain, whose name is signed to the document above, bearing date the 6th day of Dec, 1985, has acknowledged the same before me, in my county aforesaid.

12/22/2023

Given under my hand and official seal this 6th day of Dec, 1985
My term of office expires on the 23 day of Jan, 1988.

Vicki L. Vanderberg
Notary Public
WICKI L. VANDERBERG, NOTARY PUBLIC
INDIANA BOROUG, INDIANA COUNTY
MY COMMISSION EXPIRES JAN. 23, 1988
Member, Pennsylvania Association of Notaries

2,910'

LATITUDE 39° 22' 30"

GRIFFIN LEASE WELL NO.

JK-989

UNDERWOOD

1716'

S 47 E
594'

JK - 987

N 51-30 E
495'

S 24 E
499.12'

24" SCARLET
OAK

HADLEY

S 60 W 280.5'

GRIFFIN
N 46 E

S 47 E
1188'

N 43-18 E
1907.38'

JK-9880

LONGITUDE 80° 52' 30"

74

108 ACRES ±

WELL NO. JK - 989

S 54-19 E 899.04'

49.5' E / C

S 53-30 W
1072.5'

GRIFFIN

N 33 W
858'

S 69-30 W
618.75'

JUNCT. OF ROADS 1281-P(01)

REFERENCES

S 71-53 W 143.21'	S 88-50 E 252.54'
NAIL ON KNOB	WELL NO. JK-989
	6" WILD BLACK CHERRY

1" = 400'

74

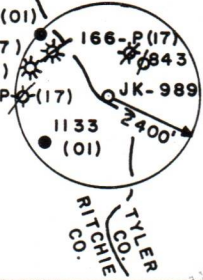

FILE NO. 13 - 36
 DRAWING NO. _____
 SCALE 1" = 500'
 MINIMUM DEGREE OF ACCURACY 1 / 200
 PROVEN SOURCE OF ELEVATION BM ELEV. 951'

I THE UNDERSIGNED, HEREBY CERTIFY THAT THIS PLAT IS CORRECT TO THE BEST OF MY KNOWLEDGE AND BELIEF AND SHOWS ALL THE INFORMATION REQUIRED BY LAW AND THE REGULATIONS ISSUED AND PRESCRIBED BY THE DEPARTMENT OF MINES.
 (SIGNED) Gregory A. Smith
 R.P.E. _____ L.L.S. 677

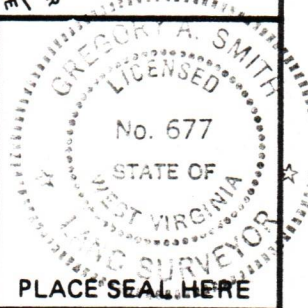

(+) DENOTES LOCATION OF WELL ON UNITED STATES TOPOGRAPHIC MAPS
 FORM IV-6 (8-78)



DATE MAY 10, 19 84
 OPERATOR'S WELL NO. JK-989
 API WELL NO. 47-095-1081
 STATE COUNTY PERMIT

STATE OF WEST VIRGINIA
 DEPARTMENT OF MINES
 OIL AND GAS DIVISION

WELL TYPE: OIL ___ GAS X LIQUID INJECTION ___ WASTE DISPOSAL ___
 (IF "GAS,") PRODUCTION X STORAGE ___ DEEP ___ SHALLOW X
 LOCATION: ELEVATION 1004' WATER SHED ___ STRAIGHT RUN ___
 DISTRICT CENTERVILLE COUNTY TYLER
 QUADRANGLE PENNSBORO 7.5'
 SURFACE OWNER EDITH H. GRIFFIN ACREAGE 108
 OIL & GAS ROYALTY OWNER EDITH H. GRIFFIN LEASE ACREAGE 12/22/2023
 LEASE NO. JJ-1478
 PROPOSED WORK: DRILL X CONVERT ___ DRILL DEEPER ___ REDRILL ___ FRACTURE OR STIMULATE X PLUG OFF OLD FORMATION ___ PERFORATE NEW FORMATION ___ OTHER PHYSICAL CHANGE IN WELL (SPECIFY) _____
 PLUG AND ABANDON ___ CLEAN OUT AND REPLUG ___
 TARGET FORMATION ALEXANDER ESTIMATED DEPTH 5300'
 WELL OPERATOR J & J ENTERPRISES, INC. DESIGNATED AGENT RICHARD M. REDDECLIFF
 ADDRESS P. O. BOX 48 ADDRESS P. O. BOX 48
BUCKHANNON, WV 26201 BUCKHANNON, WV 26201