

James 7/6/88

11,340'

LATITUDE 39° 25' 00"

WELL REFERENCES:  
N38°45'W, 82' TO POWER POLE  
S70°15'E, 112' TO 3" YELLOW GAS LINE MARKER

TIE LINES:  
A - N11°27'E, 162.59'  
B - S78°36'E, 149.16'  
C - S53°57'W, 220.75'

NOTE: BOTH TIE CORNERS ARE 5/8" IRON REBAR

JACKMAN

0.60S  
2.13W

0.60  
2.13

J. GRIFFIN  
236 AC.

NICHOLS

WALLACE

NORTH

LONGITUDE

23

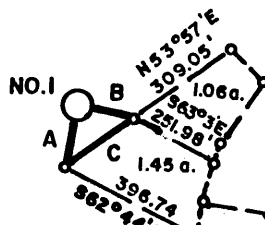

506(17)  
2280'

2400' NO. 1

507(16)  
1518'

ORR

LAND SURVEYING SERVICES  
21 CEDAR LANE  
BRIDGEPORT, WV 26330  
PHONE: 304-842-2018

(+) DENOTES LOCATION OF WELL ON UNITED STATES TOPOGRAPHIC MAPS

FILE NO. \_\_\_\_\_  
DRAWING NO. \_\_\_\_\_  
SCALE 1" = 500'  
MINIMUM DEGREE OF ACCURACY 1 in 200  
PROVEN SOURCE OF ELEVATION BM 1000' S.E. OF LOCATION ELEV. - 731'

I THE UNDERSIGNED, HEREBY CERTIFY THAT THIS PLAT IS CORRECT TO THE BEST OF MY KNOWLEDGE AND BELIEF AND SHOWS ALL THE INFORMATION REQUIRED BY LAW AND THE REGULATIONS ISSUED AND PRESCRIBED BY THE DEPARTMENT OF ENERGY.

(SIGNED) *Stephen D. Losh*  
R.P.E. \_\_\_\_\_ L.L.S. 674

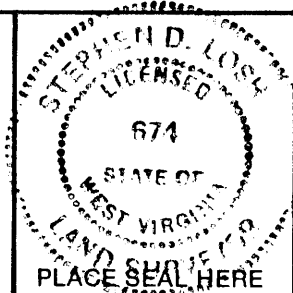

STATE OF WEST VIRGINIA  
DEPARTMENT OF ENERGY  
OIL AND GAS DIVISION



DATE JUNE 16, 19 88  
OPERATOR'S WELL NO. GRIFFIN NO. 1  
API WELL NO.

47 - 095 - 1251  
STATE COUNTY PERMIT

WELL TYPE: OIL \_\_\_ GAS  LIQUID INJECTION \_\_\_ WASTE DISPOSAL \_\_\_  
(IF "GAS,") PRODUCTION  STORAGE \_\_\_ DEEP \_\_\_ SHALLOW

LOCATION: ELEVATION 804' WATER SHED McELROY CREEK

DISTRICT McELROY 5 COUNTY TYLER

QUADRANGLE SHIRLEY 7.5 min. 607 133 206 West Union

SURFACE OWNER JIMMY GRIFFIN ACREAGE 233.49

OIL & GAS ROYALTY OWNER JIMMY GRIFFIN LEASE ACREAGE 236

LEASE NO. \_\_\_\_\_

PROPOSED WORK: DRILL  CONVERT \_\_\_ DRILL DEEPER \_\_\_ REDRILL \_\_\_ FRACTURE OR STIMULATE \_\_\_ PLUG OFF OLD FORMATION \_\_\_ PERFORATE NEW FORMATION \_\_\_ OTHER PHYSICAL CHANGE IN WELL (SPECIFY) \_\_\_\_\_

PLUG AND ABANDON \_\_\_ CLEAN OUT AND REPLUG \_\_\_

TARGET FORMATION BENSON ESTIMATED DEPTH 5000'

WELL OPERATOR STONEWALL GAS COMPANY DESIGNATED AGENT CHARLES CANFIELD

ADDRESS P.O. DRAWER R 847 ADDRESS P.O. DRAWER R  
JANE LEW, WV 26378 JANE LEW, WV 26378

66 Wilbur

(92)

JUL 22 1988

FORM WW-6  
H.T. HALL 48673

COUNTY NAME

PERMIT

WR-35

RECEIVED  
OCT 21 1988



DIVISION OF OIL & GAS  
DEPARTMENT OF ENERGY

State of West Virginia  
DEPARTMENT OF ENERGY  
Oil and Gas Division

Date OCTOBER 17, 88  
Operator's Well No. GRIFFIN #1  
Farm 388-S  
API No. 47 095 1251

WELL OPERATOR'S REPORT  
OF  
DRILLING, FRACTURING AND/OR STIMULATING, OR PHYSICAL CHANGE

WELL TYPE: Oil \_\_\_ / Gas X / Liquid Injection \_\_\_ / Waste Disposal \_\_\_  
(If "Gas," Production X / Underground Storage \_\_\_ / Deep \_\_\_ / Shallow X /)

LOCATION: Elevation: 804 Watershed MC ELROY CREEK  
District: MC ELROY County TYLER Quadrangle SHIRLEY 7.5

COMPANY STONEWALL GAS COMPANY  
ADDRESS PO DRAWER R, JANE LEW, WV 26378  
DESIGNATED AGENT CHARLES W. CANFIELD  
ADDRESS PO DRAWER R, JANE LEW, WV 26378  
SURFACE OWNER JIMMY GRIFFIN  
ADDRESS ALMA, WV 26320  
MINERAL RIGHTS OWNER SAME AS SURFACE  
ADDRESS \_\_\_\_\_  
OIL AND GAS INSPECTOR FOR THIS WORK GLEN ROBINSON  
ADDRESS RT 1, MINERAL WELLS, WV  
PERMIT ISSUED 07-18-88  
DRILLING COMMENCED 07-21-88  
DRILLING COMPLETED 08-20-88  
IF APPLICABLE: PLUGGING OF DRY HOLE ON CONTINUOUS PROGRESSION FROM DRILLING OR REWORKING. VERBAL PERMISSION OBTAINED ON \_\_\_\_\_

Casing Tubing	Used in Drilling	Left in Well	Cement fill up Cu. ft.
Size 20-16 Cond.			
11 3/4 13-10"	141	141	80 SKS
9 5/8			
8 5/8	1090	1090	265 SKS
7			
5 1/2			
4 1/2	4966	4966	710 SKS
3			
2		4770	
Liners used			

GEOLOGICAL TARGET FORMATION BENSON Depth 4800 feet  
Depth of completed well 4966 feet Rotary X / Cable Tools \_\_\_\_\_  
Water strata depth: Fresh 352 feet; Salt 970 feet  
Coal seam depths: 183 TO 185 Is coal being mined in the area? X

OPEN FLOW DATA

Producing formation BENSON Pay zone depth 4800 feet  
Gas: Initial open flow 110 Mcf/d Oil: Initial open flow NA Bbl/d  
Final open flow 211 Mcf/d Final open flow NA Bbl/d  
Time of open flow between initial and final tests 72 hours  
Static rock pressure 1040 psig (surface measurement) after 72 hours shut in  
(If applicable due to multiple completion--)  
Second producing formation RILEY Pay zone depth 4360 feet  
Gas: Initial open flow 110 Mcf/d Oil: Initial open flow NA Bbl/d  
Final open flow 211 Mcf/d Oil: Final open flow NA Bbl/d  
Time of open flow between initial and final tests 72 hours  
Static rock pressure 1040 psig (surface measurement) after 72 hours shut in

(Continue on reverse side)

DETAILS OF PERFORATED INTERVALS, FRACTURING OR STIMULATING, PHYSICAL CHANGE, ETC.  
 FRAC TWO STAGES 10/05/88

PERFS	HOLE	BBL	SAND	BD	ISIP
<u>BENSON</u> 4800-4804	16	740	60,000	2000	1800
<u>RILEY</u> 4363-4369	18	735	60,000	2700	1800
<u>BIG INJUN</u> 1836-1846	24				

PERFORATED ONLY  
WELL LOG

FORMATION	COLOR	HARD OR SOFT	TOP FEET	BOTTOM FEET	REMARKS Including indication of all fresh and salt water, coal, oil and gas
GROUND LEVEL			0	10	
SAND & SHALE	GRAY	SOFT	10	183	COAL
COAL					
SHALE	BLACK GRAY	SOFT SOFT	183 185	185 352	1/2" STEAM H <sub>2</sub> O 351"
SAND & SHALE	GRAY	SOFT	352	1680	GAS CK @ 2400 NO SHOW
BIG LIME	WHITE	HARD	1680	1740	GAS CK @ 2500 16/10 2" H <sub>2</sub> O
BIG INJUN	GRAY	SOFT	1740	1900	GAS CK @ 3368 10/10 2" H <sub>2</sub> O
WEIR	GRAY	SOFT	2070	2200	GAS CK @ 3652 10/10 2" H <sub>2</sub> O
GORDON	GRAY	SOFT	2510	2530	
RILEY	BROWN	SOFT	4370	4430	GAS CK @ TD 20/10 2" H <sub>2</sub> O
✓ BENSON	GRAY	HARD	4800	4850	
	TD		<u>5025</u>		

**RECEIVED**  
 OCT 21 1988  
 DIVISION OF OIL & GAS  
 DEPARTMENT OF ENERGY

(Attach separate sheets as necessary)

STONEWALL GAS COMPANY  
 Well Operator

By: Benjamin A. Hardesty  
 BENJAMIN A. HARDESTY, VICE PRESIDENT

Date: OCTOBER 18, 1988

Note: Regulation 2.02(i) provides as follows:  
 "The term 'log' or 'well log' shall mean a systematic detailed geological record of all formations, including ... of a well."

7325

STATE OF WEST VIRGINIA  
DEPARTMENT OF ENERGY, DIVISION OF OIL AND GAS  
WELL WORK PERMIT APPLICATION

- 1) Well Operator: STONEWALL GAS COMPANY 47850, 5, 606
- 2) Operator's Well Number: GRIFFIN #1 388-S 3) Elevation: 804
- 4) Well type: (a) Oil  / or Gas  /  
(b) If Gas: Production  / Underground Storage  /  
Deep  / Shallow  /
- 5) Proposed Target Formation(s): BENSON
- 6) Proposed Total Depth: 4900' feet
- 7) Approximate fresh water strata depths: 50', 250-275'
- 8) Approximate salt water depths: 1050'
- 9) Approximate coal seam depths: NA 305'-366-437-440'
- 10) Does land contain coal seams tributary to active mine? Yes  / No  /
- 11) Proposed Well Work: Drill & Frac new well
- 12)

CASING AND TUBING PROGRAM

TYPE	SPECIFICATIONS			FOOTAGE INTERVALS		CEMENT
	Size	Grade	Weight per ft.	For drilling	Left in well	Fill-up (cu. ft.)
<u>OK R.A.L.</u> Conductor	11 3/4	ERW	42#	70'	70'	38 CSR 18-11.3
Fresh Water						
Coal						38 CSR 18-11.2.2
Intermediate	8 5/8	ERW	23#	1100'	1100'	38 CSR 18-11.3
Production	4 1/2	ERW	10.5#	4850'	4850'	38 CSR 18-11.1
Tubing						
Liners						

RECEIVED  
JUL 01 1988

PACKERS : Kind \_\_\_\_\_  
Sizes \_\_\_\_\_  
Depths set \_\_\_\_\_

For Division of Oil and Gas Use Only

DIVISION OF OIL & GAS  
DEPARTMENT OF ENERGY

Fee(s) paid: 20 Well Work Permit 20 Reclamation Fund 20 WPCP

Plat 50 Blanket Agent 50 Blanket  
(Type)

4579  
20  
50

**RECEIVED**  
JUL 01 1988

Page 1 of 1  
Form WW2-A  
(09/87)  
File Copy

DIVISION OF OIL & GAS 3)  
DEPARTMENT OF ENERGY

Date: JUNE 23, 1988  
Operator's well number  
GRIFFIN #1 388-S  
API Well No: 47 - 095 - 1251  
State - County - Permit

STATE OF WEST VIRGINIA  
DEPARTMENT OF ENERGY, DIVISION OF OIL AND GAS

NOTICE AND APPLICATION FOR A WELL WORK PERMIT

4) Surface Owner(s) to be served:  
(a) Name Jimmy Griffin  
Address Alma, WV 26320  
  
(b) Name \_\_\_\_\_  
Address \_\_\_\_\_  
  
(c) Name \_\_\_\_\_  
Address \_\_\_\_\_

5) (a) Coal Operator:  
Name N/A  
Address \_\_\_\_\_  
  
(b) Coal Owner(s) with Declaration  
Name Jimmy Griffin  
Address Alma, WV 26320  
  
Name \_\_\_\_\_  
Address \_\_\_\_\_

6) Inspector Robert Lowther  
Address General Delivery  
Middlebourne, WV 26149  
Telephone (304)-758-4764

(c) Coal Lessee with Declaration  
Name N/A  
Address \_\_\_\_\_

TO THE PERSON(S) NAMED ABOVE TAKE NOTICE THAT:

\_\_\_\_\_ Included is the lease or leases or other continuing contract or contracts by which I hold the right to extract oil and gas OR  
 Included is the information required by Chapter 22B, Article 1, Section 8(d) of the Code of West Virginia (see page 2)

I certify that as required under Chapter 22B of the West Virginia Code I have served copies of this notice and application, a location plat, and accompanying documents pages 1 through \_\_\_\_\_ on the above named parties, by:

- \_\_\_\_\_ Personal Service (Affidavit attached)
- Certified Mail (Postmarked postal receipt attached)
- \_\_\_\_\_ Publication (Notice of Publication attached)

I have read and understand Chapter 22B and 38 CSR 11-18, and I agree to the terms and conditions of any permit issued under this application.

I certify under penalty of law that I have personally examined and am familiar with the information submitted on this application form and all attachments, and that based on my inquiry of those individuals immediately responsible for obtaining the information, I believe that the information is true, accurate, and complete.

I am aware that there are significant penalties for submitting false information, including the possibility of fine and imprisonment.

Well Operator STONEWALL GAS COMPANY  
By: [Signature]  
Its: VICE PRESIDENT  
Address P.O. DRAWER R  
JANE LEW, WV 26378  
Telephone 304-884-7881

Subscribed and sworn before me this 23 day of JUNE, 1988

[Signature]  
My commission expires OCT. 14, 1993

[Signature]  
Commissioner of West Virginia