

Janice 8/21/89

25 300

LATITUDE 39° 22' 30"

STEWART

NICHOLAS

PRUNTY 2

0.525
0.05

7.5'
LONGITUDE 80° 47' 30"

WEEKLEY

S19°54'E,
3206.42'

PETROVICH

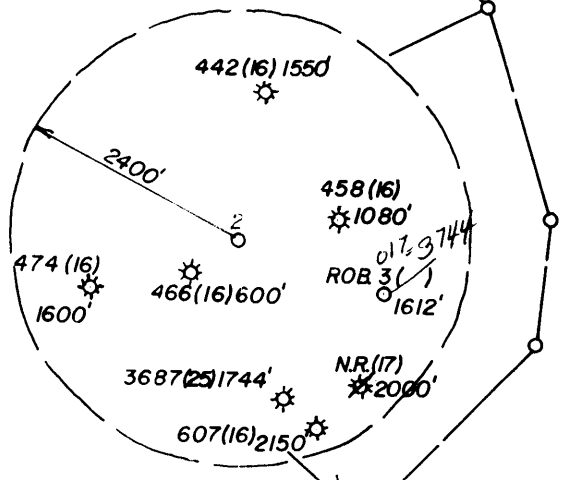

N15°25'W,
2622.32'

3.40 S
2.28 W

NORTH

WEEKLEY

N17°W, 594'

STONE

SIMPSON

N39°W,
626.66'

N42°45'E,
252.45'

STONE

WELL REFERENCES:
N24°W, 116' TO 9" AILANTHUS
N73°E, 118.50' TO 8" POPLAR

SIMPSON

BAGLEY, ET. AL.

BUCK

LAND SURVEYING SERVICES
21 CEDAR LANE
BRIDGEPORT, WV 26330
PHONE: 304-842-2018

(+) DENOTES LOCATION OF WELL ON UNITED STATES TOPOGRAPHIC MAPS

FILE NO. _____
DRAWING NO. _____
SCALE 1" = 500'
MINIMUM DEGREE OF ACCURACY 1 IN 200
PROVEN SOURCE OF ELEVATION TOP OF KNOB 985'
WEST OF LOC. AT ELEV. 1335'

I THE UNDERSIGNED, HEREBY CERTIFY THAT THIS PLAT IS CORRECT TO THE BEST OF MY KNOWLEDGE AND BELIEF AND SHOWS ALL THE INFORMATION REQUIRED BY LAW AND THE REGULATIONS ISSUED AND PRESCRIBED BY THE DEPARTMENT OF ENERGY.
(SIGNED) _____

R.P.E. _____ L.L.S. NO. 674
STEPHEN D. LOSH

PLACE SEAL HERE

STATE OF WEST VIRGINIA
DEPARTMENT OF ENERGY
OIL AND GAS DIVISION



DATE MARCH 31, 19 89
OPERATOR'S WELL NO. PRUNTY 2
API WELL NO.

WELL TYPE: OIL ___ GAS X LIQUID INJECTION ___ WASTE DISPOSAL ___
(IF "GAS,") PRODUCTION X STORAGE ___ DEEP ___ SHALLOW X
LOCATION: ELEVATION 1222' WATER SHED CAMP MISTAKE RUN
DISTRICT McELROY S COUNTY TYLER
QUADRANGLE WEST UNION 7.5' 671 1336 +15' EC
SURFACE OWNER DAVE BEVERAGE ACREAGE 137.
OIL & GAS ROYALTY OWNER S. PRUNTY LEASE ACREAGE 138.
LEASE NO. _____

PROPOSED WORK: DRILL X CONVERT ___ DRILL DEEPER ___ REDRILL ___ FRACTURE OR STIMULATE ___ PLUG OFF OLD FORMATION ___ PERFORATE NEW FORMATION ___ OTHER PHYSICAL CHANGE IN WELL (SPECIFY) _____

PLUG AND ABANDON ___ CLEAN OUT AND REPLUG ___
TARGET FORMATION BENSON ESTIMATED DEPTH 5150'
WELL OPERATOR STONEWALL GAS CO. DESIGNATED AGENT CHARLES CANFIELD
ADDRESS P.O. DRAWER R ADDRESS P.O. DRAWER R
JANE LEW, WV 26378-0080 847 JANE LEW, WV 26378-0080

SEP 1 1989

6-6 Wilbur (092)

FORM WW-6

COUNTY NAME PERMIT

State of West Virginia
DEPARTMENT OF ENERGY
Division of Oil and Gas

Well Operator's Report of Well Work

Farm name: BEVERIDGE, DAVID R. Operator Well No.: PRUNTY 2-S-399

LOCATION: Elevation: 1222.00 Quadrangle: WEST UNION

District: MCELROY County: TYLER
Latitude: 2800 Feet South of 39 Deg. 22Min. 30 Sec.
Longitude 300 Feet West of 80 Deg. 47 Min. 30 Sec.

Company: STONEWALL GAS CO.
P. O. BOX 1575
RICHMOND, VA 23213-1575

Agent: JESSE A. SHELL

Inspector: GLEN P. ROBINSON
Permit Issued: 08/28/89
Well work Commenced: 01-06-90
Well work Completed: 01-12-90
Verbal Plugging
Permission granted on: _____
Rotary X Cable _____ Rig
Total Depth (feet) 5350
Fresh water depths (ft) 50

Salt water depths (ft) 2025

Is coal being mined in area (Y/N)? N
Coal Depths (ft): _____ N/A

Casing & Tubing Size	Used in Drilling	Left in Well	Cement Fill Up Cu. Ft.
11 3/4	136	136	80 SKS
8 5/8	1479	1479	385 SKS
4 1/2	5240	5240	720 SKS

RECEIVED
FEB 18 1990

DIVISION OF OIL & GAS
DEPARTMENT OF ENERGY

OPEN FLOW DATA

Producing formation BENSON Pay zone depth (ft) 5146
Gas: Initial open flow 163 MCF/d Oil: Initial open flow 0 Bbl/d
Final open flow 1704 MCF/d Final open flow 0 Bbl/d
Time of open flow between initial and final tests 1 Hours
Static rock Pressure 1525 psig (surface pressure) after 168 Hours

Second producing formation _____ Pay zone depth (ft) _____
Gas: Initial open flow _____ MCF/d Oil: Initial open flow _____ Bbl/d
Final open flow _____ MCF/d Final open flow _____ Bbl/d
Time of open flow between initial and final tests _____ Hours
Static rock Pressure _____ psig (surface pressure) after _____ Hours

NOTE: ON BACK OF THIS FORM PUT THE FOLLOWING: 1). DETAILS OF PERFORATED INTERVALS, FRACTURING OR STIMULATING, PHYSICAL CHANGE, ETC. 2). THE WELL LOG WHICH IS A SYSTEMATIC DETAILED GEOLOGICAL RECORD OF ALL FORMATIONS, INCLUDING COAL ENCOUNTERED BY THE WELLBORE.

For: STONEWALL GAS CO.

By: [Signature] PETROLEUM ENGINEER
Date: FEBRUARY 5, 1990

FEB 23 1990

095-1327

STAGE	WATER	DATE	30# GAL			
1	FRAC	01-18-90		SAND	BP	ISIP
ZONES	PERFS	HOLES	BBL			
BENSON	5143-5149	18	800	80,000	2100	1580

FORMATION	COLOR	HARD/SOFT	TOP	BOTTOM	REMARKS
FILL & TOP SOIL	BROWN	HARD	0	20	GAS CK 2160 NO SHOW
SAND	GRAY	SOFT	20	50	
RED ROCK	RED	HARD	50	80	GAS CK 2191 NO SHOW
SANDY SHALE	GRAY	SOFT	80	110	
RR & SHALE	BROWN	HARD	110	185	GAS CK 2222 10/10 1" H ₂ O
SAND	BROWN	HARD	185	205	
SHALE & RR	GRAY	HARD	205	375	GAS CK 2283 8/10 1" H ₂ O
SANDY SHALE	BROWN	SOFT	375	1045	
SAND	GRAY	SOFT	1045	1050	GAS CK 2897 10/10 2" H ₂ O
SANDY SHALE	GRAY	SOFT	1050	1090	
SAND	GRAY	HARD	1090	1130	GAS CK 3266 8/10 2" H ₂ O
SANDY SHALE	BROWN	SOFT	1130	1290	
SAND	BROWN	SOFT	1290	1335	GAS CK 3633 6/60 2" H ₂ O
SANDY SHALE	BROWN	SOFT	1335	2000	
SAND	BROWN	SOFT	2000	2030	GAS CK 4500 20/10 2" H ₂ O
SANDY SHALE	GRAY	HARD	2030	2070	
LIME	GRAY	HARD	2070	2158	GAS CK 4775 10/10-30/10 2" H ₂ O
SAND	GRAY	HARD	2158	2267	
SANDY SHALE	BROWN	SOFT	2267	2795	
SAND	BROWN	SOFT	2795	2850	GAS CK 5206 8/10 2" H ₂ O
SANDY SHALE	GRAY	SOFT	2850	3173	
SAND	GRAY	SOFT	3173	3205	GAS CK TD 4/10 2" H ₂ O
SANDY SHALE	GRAY	SOFT	3205	3540	
SAND	GRAY	HARD	3540	3570	
SANDY SHALE	GRAY	HARD	3570	4675	
SAND	BROWN	SOFT	4675	4745	
SANDY SHALE (BENSON)	BROWN	SOFT	4745	5140	
SAND (BENSON)	BROWN	SOFT	5140	5176	
SANDY SHALE	GRAY	SOFT	5176	5350	
	TD	5350			

RECEIVED
FEB 13 1990

DIVISION OF OIL & GAS
DEPARTMENT OF ENERGY

STATE OF WEST VIRGINIA
DEPARTMENT OF ENERGY, DIVISION OF OIL AND GAS
WELL WORK PERMIT APPLICATION

- 1) Well Operator: STONEWALL GAS COMPANY ⁵⁴⁷ 47850 (15) 670
- 2) Operator's Well Number: PRUNTY #2 (399-S) 3) Elevation: 1222'
- 4) Well type: (a) Oil or Gas
(b) If Gas: Production Underground Storage
Deep Shallow
- 5) Proposed Target Formation(s): BENSON 435
- 6) Proposed Total Depth: 5500' feet
- 7) Approximate fresh water strata depths: 160'
- 8) Approximate salt water depths: 1360'
- 9) Approximate coal seam depths: possibly 317'-322' NA 744'-746' 532'-537'
- 10) Does land contain coal seams tributary to active mine? Yes No
- 11) Proposed Well Work: Drill & Stimulate New Well
- 12)

CASING AND TUBING PROGRAM

TYPE	SPECIFICATIONS			FOOTAGE INTERVALS		CEMENT
	Size	Grade	Weight per ft.	For drilling	Left in well	Fill-up (cu. ft.)
<u>4 1/2" 189</u> <u>OK</u> Conductor	11 3/4	ERW	42#	<u>120 ft</u> <u>175</u>	<u>120 ft</u> <u>175</u>	38 CSR 18-11.3
Fresh Water						
Coal						<u>38 CSR 11.2.2</u>
Intermediate	8 5/8	ERW	23#	1400'	1400'	38 CSR 18-11.3
Production	4 1/2	ERW	10.5#	5500'	5500'	38 CSR 18-11.1
Tubing						<u>38 CSR</u>
Liners						

PACKERS : Kind _____
Sizes _____
Depths set _____

RECEIVED
AUG 11 1989

For Division of Oil and Gas Use Only

Fee(s) paid: Well Work Permit Reclamation Fund WPCP

Plat WW-9 WW-2B Bond Blanket Sure Agent

RECEIVED
AUG 11 1989

Page 1 of _____
Form WW2-A
(09/87)
File Copy

DIVISION OF OIL & GAS
DEPARTMENT OF ENERGY

Date: JUNE 19, 1989
Operator's well number
PRUNTY #2 (399-S)
API Well No: 47 - 095 - 1327
State - County - Permit

STATE OF WEST VIRGINIA
DEPARTMENT OF ENERGY, DIVISION OF OIL AND GAS

NOTICE AND APPLICATION FOR A WELL WORK PERMIT

4) Surface Owner(s) to be served:
(a) Name DAVID R. BEVERIDGE
Address 5618 TREMONT DRIVE
ALEXANDRIA, VA 22303
(b) Name _____
Address _____
(c) Name _____
Address _____

5) (a) Coal Operator:
Name N/A
Address _____
(b) Coal Owner(s) with Declaration
Name JAMES S. & WANDA BUCK
Address RT 1, BOX 32A
ALDIE, VA 22001
Name _____
Address _____

6) Inspector GLEN ROBINSON
Address RT 1, #6 MT PLEASANT EST
MINERAL WELLS, WV 26150
Telephone (304)- 489-9162

(c) Coal Lessee with Declaration
Name N/A
Address _____

TO THE PERSON(S) NAMED ABOVE TAKE NOTICE THAT:

_____ Included is the lease or leases or other continuing contract or contracts by which I hold the right to extract oil and gas OR
X Included is the information required by Chapter 22B, Article 1, Section 8(d) of the Code of West Virginia (see page 2)

I certify that as required under Chapter 22B of the West Virginia Code I have served copies of this notice and application, a location plat, and accompanying documents pages 1 through _____ on the above named parties, by:

- _____ Personal Service (Affidavit attached)
- X Certified Mail (Postmarked postal receipt attached)
- _____ Publication (Notice of Publication attached)

I have read and understand Chapter 22B and 38 CSR 11-18, and I agree to the terms and conditions of any permit issued under this application.

I certify under penalty of law that I have personally examined and am familiar with the information submitted on this application form and all attachments, and that based on my inquiry of those individuals immediately responsible for obtaining the information, I believe that the information is true, accurate, and complete.

I am aware that there are significant penalties for submitting false information, including the possibility of fine and imprisonment.

Well Operator STONEWALL GAS COMPANY
By: [Signature]
Its: PRESIDENT
Address PO DRAWER R
JANE LEW, WV 26378-0080
Telephone 304-884-7881

Subscribed and sworn before me this 19TH day of JUNE, 1989

Richard K. Elowitz

My commission expires OCTOBER 14, 1993

XXXXXXXXXXXX