

7320'

LATITUDE 39°25'00"

WELL REFERENCES:

Jamie 12/15/89

S36°W, 131' TO 2" SUGAR MAPLE
N27°E, 123' TO 5" POPLAR

58

MILLER

UNDERWOOD

CLOSURE

N10°57'E, 287.47'

N56°15'E, 330'

12" OAK STUMP

22" OAK STUMP

S28°39'E, 298.94'

S74°30'E, 309'

S84°41'W, 203.67'

NO. 2

STACK

LeGRANDE

NORTH

*W. Underwood
2010
2010*

HAUGHT

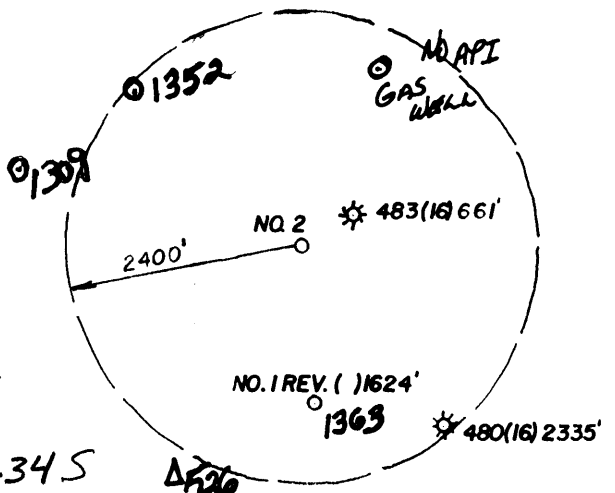

2.345
1.37 W

SMITH

WEEKLEY

HELMRICH

NO. 1 REV.

KEYS

MERCER

58

LAND SURVEYING SERVICES
21 CEDAR LANE
BRIDGEPORT, WV 26330
PHONE: 304-842-2018

(+) DENOTES LOCATION OF WELL ON UNITED STATES TOPOGRAPHIC MAPS

FILE NO. _____
DRAWING NO. _____
SCALE 1" = 400'
MINIMUM DEGREE OF ACCURACY 1 IN 200
PROVEN SOURCE OF ELEVATION ROAD INT. 2583' SW. OF LOC. AT ELEV. 1038'

I THE UNDERSIGNED, HEREBY CERTIFY THAT THIS PLAT IS CORRECT TO THE BEST OF MY KNOWLEDGE AND BELIEF AND SHOWS ALL THE INFORMATION REQUIRED BY LAW AND THE REGULATIONS ISSUED AND PRESCRIBED BY THE DEPARTMENT OF ENERGY.

(SIGNED) *[Signature]*

R.P.E. _____ L.L.S. NO. 674
STEPHEN D. LOSH



STATE OF WEST VIRGINIA
DEPARTMENT OF ENERGY
OIL AND GAS DIVISION



DATE NOV. 29, 19 89
OPERATOR'S WELL NO. FAYE ANN 2
API WELL NO. _____

WELL TYPE: OIL ___ GAS X LIQUID INJECTION ___ WASTE DISPOSAL ___
(IF "GAS,") PRODUCTION X STORAGE ___ DEEP ___ SHALLOW X
LOCATION: ELEVATION 1055' WATER SHED JEFFERSON RUN
DISTRICT McELROY 5 COUNTY TYLER
QUADRANGLE SHIRLEY 7.5'
SURFACE OWNER RICHARD MILLER ACREAGE 65.88
OIL & GAS ROYALTY OWNER ROBERT MORRIS HRS. LEASE ACREAGE 66.

PROPOSED WORK: DRILL X CONVERT ___ DRILL DEEPER ___ REDRILL ___ FRACTURE OR STIMULATE ___ PLUG OFF OLD FORMATION ___ PERFORATE NEW FORMATION ___ OTHER PHYSICAL CHANGE IN WELL (SPECIFY) _____

PLUG AND ABANDON ___ CLEAN OUT AND REPLUG ___
TARGET FORMATION BENSON ESTIMATED DEPTH 5400'
WELL OPERATOR STONEWALL GAS CO. DESIGNATED AGENT JESSE SHELL
ADDRESS P. O. DRAWER R ADDRESS P. O. DRAWER R
JANE LEW, WV 26378-0080 847 JANE LEW, WV 26378-0080

6-6 Wilbur

(092)

DEC 22 1989

LONGITUDE 80° 47' 30"

12415'

COUNTY NAME

PERMIT

State of West Virginia
DEPARTMENT OF ENERGY
Division of Oil and Gas

OCT 22 90

Permitting
Oil and Gas Section

Well Operator's Report of Well Work

Farm name: MILLER, RICHARD G. Operator Well No.: FAYE ANN#2-434S

LOCATION: Elevation: 1055.00 Quadrangle: SHIRLEY

District: MCELROY County: TYLER
Latitude: 12415 Feet South of 39 Deg. 25Min. 0 Sec.
Longitude 7320 Feet West of 80 Deg. 47 Min. 30 Sec.

Company: STONEWALL GAS CO.
P. O. BOX 1575
RICHMOND, VA 23213-1575

Agent: JESSE A. SHELL

Inspector: GLEN P. ROBINSON
Permit Issued: 12/22/89
Well work Commenced: 09-11-90
Well work Completed: 09-17-90
Verbal Plugging
Permission granted on: _____
Rotary x Cable _____ Rig
Total Depth (feet) 5200
Fresh water depths (ft) 60
Salt water depths (ft) 900

Casing & Tubing Size	Used in Drilling	Left in Well	Cement Fill Up Cu. Ft.
11 3/4	128	128	75 sks
8 5/8	1323	1323	300 SKS
4 1/2	5100	5100	710 SKS

Is coal being mined in area (Y/N)? N
Coal Depths (ft): 215

OPEN FLOW DATA

Producing formation BENSON Pay zone depth (ft) 5003
Gas: Initial open flow 60 MCF/d Oil: Initial open flow 0 Bbl/d
Final open flow 696 MCF/d Final open flow 0 Bbl/d
Time of open flow between initial and final tests 1 Hours
Static rock Pressure 1475 psig (surface pressure) after 168 Hours

Second producing formation RILEY Pay zone depth (ft) 4577
Gas: Initial open flow 60 MCF/d Oil: Initial open flow 0 Bbl/d
Final open flow 696 MCF/d Final open flow 0 Bbl/d
Time of open flow between initial and final tests 1 Hours
Static rock Pressure 1475 psig (surface pressure) after 168 Hours

NOTE: ON BACK OF THIS FORM PUT THE FOLLOWING: 1). DETAILS OF PERFORATED INTERVALS, FRACTURING OR STIMULATING, PHYSICAL CHANGE, ETC. 2). THE WELL LOG WHICH IS A SYSTEMATIC DETAILED GEOLOGICAL RECORD OF ALL FORMATIONS, INCLUDING COAL ENCOUNTERED BY THE WELLBORE.

For: STONEWALL GAS CO.

By: Ray M. Frear, Jr. RAY M. FREAR, JR.
Date: OCTOBER 18, 1990 PETROLEUM ENGINEER

1990

STAGE 2	FRAC	WATER	DATE	09-26-90		
ZONES	PERFS		HOLES	BBL	BP	ISIP
BENSON	5003-5007		16	600	1810	1560
RILEY	4577-4598		18	600	2010	1780
FORMATION	COLOR		HARD/SOFT	TOP	BOTTOM	REMARKS
RED ROCK	RED	HARD	0	8	GAS CK 2026	6/10 W/W
SAND & SHALE	GRAY	HARD	8	20		
RR & SHALE	GRAY	HARD	20	40	GAS CK @ 2058	6/10 2 W/W
SAND & SHALE	GRAY	HARD	40	90		
SAND	BROWN	SOFT	90	160	GAS CK @ 2184	6/10 2" W/W
SAND & SHALE	BROWN	SOFT	160	215		
COAL	BLACK	SOFT	215	220	GAS CK @ 2771	8/10 2" W/W
SAND & SHALE	BROWN	SOFT	220	400		
SAND	BROWN	HARD	400	425	GAS CK 3485	8/10 2" W/W
SAND & SHALE	GRAY	HARD	425	680	GAS CK 4606	6/10 2" W/W
SAND	BROWN	SOFT	680	705		
SAND & SHALE	GRAY	SOFT	705	1200	GAS CK 5071	10/10 2" W/W
RR & SHALE	GRAY	SOFT	1200	1434	GAS CK DC 4/10	2" W/W
SAND	BROWN	HARD	1434	1520		
SAND & SHALE	BROWN	HARD	1520	1580		
SAND	TAN	HARD	1580	1670		
SAND & SHALE	GRAY	SOFT	1670	1892		
L-LIME	GRAY	SOFT	1892	1905		
SAND & SHALE	GRAY	SOFT	1905	1924		
B-LIME	GRAY	SOFT	1924	2010		
BIG INJUN	BROWN	HARD	2016	2145		
SAND & SHALE	BROWN	HARD	2145	2668		
GORDON	GRAY	SOFT	2668	2715		
SAND & SHALE	GRAY	SOFT	2715	4535		
RILEY	BROWN	SOFT	4535	4565		
SAND & SHALE	GRAY	SOFT	4565	5015		
BENSON	GRAY	HARD	5015	5030		
SAND & SHALE	GRAY	HARD	5030	5200		
TD			5200			

9965

STATE OF WEST VIRGINIA
 DEPARTMENT OF ENERGY, DIVISION OF OIL AND GAS
 WELL WORK PERMIT APPLICATION

- 1) Well Operator: ⁸⁴⁷ STONEWALL GAS COMPANY 47850 (5) 606
- 2) Operator's Well Number: FAYE ANN #2 (434-5) 3) Elevation: 1055'
- 4) Well type: (a) Oil ___ / or Gas X /
 (b) If Gas: Production X / Underground Storage ___ /
 Deep ___ / Shallow X /
- 5) Proposed Target Formation(s): BENSON 435
- 6) Proposed Total Depth: 5200' feet
- 7) Approximate fresh water strata depths: 90' ^{304'} ^{295'}
- 8) Approximate salt water depths: [?] 480', 840', 1230' ^{1008'}
- 9) Approximate coal seam depths: N/A ^{691'-693'}
- 10) Does land contain coal seams tributary to active mine? Yes ___ / No X /
- 11) Proposed Well Work: DRILL & STIMULATE *New Well*
- 12)

CASING AND TUBING PROGRAM

TYPE	SPECIFICATIONS			FOOTAGE INTERVALS		CEMENT
	Size	Grade	Weight per ft.	For drilling	Left in well	Fill-up (cu. ft.)
<i>gpc</i> Conductor	11 3/4"		28#	125'	125' CTS	38CSR18-11.3
Fresh Water						
Coal						
Intermediate	8 5/8"		20#	1325'	1325' CTS	38CSR18-11.2.2
Production	4 1/2"		10.5#	5150'	5150'	38CSR18-11.1
Tubing						
Liners						

PACKERS : Kind _____
 Sizes _____
 Depths set _____

RECEIVED
 DEC 07 1989

For Division of Oil and Gas Use Only

DIVISION OF OIL & GAS
 DEPARTMENT OF ENERGY

Fee(s) paid: ✓ Well Work Permit ✓ Reclamation Fund ✓ WPCP
✓ Plat ✓ WW-9 ✓ WW-2B ✓ Bond Blanket CD ✓ Agent

646
33

RECEIVED
DEC 07 1989

Date: DECEMBER 5, 1989
Operator's well number
FAYE ANN #2 (434-S)
API Well No: 47 - 095 - _____
State - County - Permit

DIVISION OF OIL & GAS
DEPARTMENT OF ENERGY

STATE OF WEST VIRGINIA
DEPARTMENT OF ENERGY, DIVISION OF OIL AND GAS

NOTICE AND APPLICATION FOR A WELL WORK PERMIT

4) Surface Owner(s) to be served:
(a) Name RICHARD G. MILLER
Address BOX 3087
LARADO, TEXAS 78044
(b) Name _____
Address _____
(c) Name _____
Address _____

5) (a) Coal Operator:
Name N/A
Address _____
(b) Coal Owner(s) with Declaration
Name DODDRIDGE LAND & DEVELOPMENT CORP
Address C/O DAVID E. BOWSER
PO BOX 67
Name WEST UNION, WV 26456
Address _____

6) Inspector GLEN P. ROBINSON
Address RT 1, #6 MT. PLEASANT EST.
MINERAL WELLS, WV 26150
Telephone (304)-489-2736

(c) Coal Lessee with Declaration
Name N/A
Address _____

TO THE PERSON(S) NAMED ABOVE TAKE NOTICE THAT:

_____ Included is the lease or leases or other continuing contract or contracts by which I hold the right to extract oil and gas OR

X Included is the information required by Chapter 22B, Article 1, Section 8(d) of the Code of West Virginia (see page 2)

I certify that as required under Chapter 22B of the West Virginia Code I have served copies of this notice and application, a location plat, and accompanying documents pages 1 through _____ on the above named parties, by:

- _____ Personal Service (Affidavit attached)
- X Certified Mail (Postmarked postal receipt attached)
- _____ Publication (Notice of Publication attached)

I have read and understand Chapter 22B and 38 CSR 11-18, and I agree to the terms and conditions of any permit issued under this application.

I certify under penalty of law that I have personally examined and am familiar with the information submitted on this application form and all attachments, and that based on my inquiry of those individuals immediately responsible for obtaining the information, I believe that the information is true, accurate, and complete.

I am aware that there are significant penalties for submitting false information, including the possibility of fine and imprisonment.

Well Operator STONEWALL GAS COMPANY
By: *Bijan G. Shrestha*
Its: PRESIDENT
Address PO DRAWER R
JANE LEW, WV 26378
Telephone 304-884-7881

Subscribed and sworn before me this 5TH day of DECEMBER, 1989

[Signature] Notary Public
My commission expires JANUARY 16, 1991