

Jamie 12/7/89  
WILCOX LEASE

LATITUDE 39-25-00

LEASBURG

28" WHITE OAK

34.5 ACRES ±

NOLAN

N44-30W  
1138.5'

WILCOX WELL NO.3

168 ACRES ±  
TOTAL

FAMILY

14" BLACK WALNUT

50 ACRES ±

N27 E  
330'

N27 E  
82.5'

N46 E  
375.38'

STEPHENS

N13 W  
486.75'

84.25 ACRES ±

N35-30W  
660'

N35-30W  
660'

SHUMAN HRS.

STEVENS

ASH

JOHNSTON

NO. 3

N83-20E 184.46'

UNDERWOOD

REFERENCES

12" SHAGBARK HICKORY  
FENCE LINE

NO. 3

N83-20E 184.46'

S 29-46 E  
154.63'

FENCE &  
BOUNDARY  
LINE

36" RED OAK

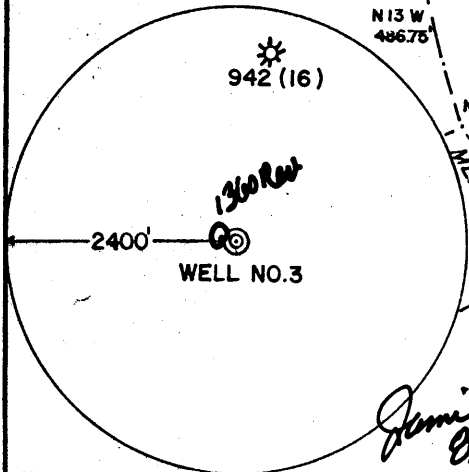

Jamie 8/2/90

**SLS**

This well is the twisted off of  
Well to 1360 Revival of Rig # 1360

I THE UNDERSIGNED, HEREBY CERTIFY THAT  
THIS PLAT IS CORRECT TO THE BEST OF MY  
KNOWLEDGE AND BELIEF AND SHOWS ALL  
THE INFORMATION REQUIRED BY LAW AND  
THE REGULATIONS ISSUED AND PRESCRIBED  
BY THE DEPARTMENT OF ENERGY.

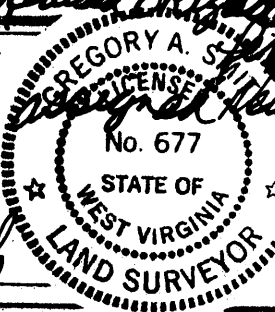

14 DENOTES LOCATION OF WELL ON UNITED STATES TOPOGRAPHIC MAPS.

DATE NOVEMBER 27, 1989

OPERATORS WELL NO. WILCOX NO.3

API WELL NO. 47 - 095 - 1421-P  
STATE COUNTY PERMIT

MINIMUM DEGREE OF ACCURACY 1 / 200 FILE NO. 2192 (30-34)  
PROVEN SOURCE OF ELEVATION TOP OF KNOB ELEVATION 1155'  
SCALE 1" = 800'

STATE OF WEST VIRGINIA  
DEPARTMENT OF ENERGY  
OIL AND GAS DIVISION



WELL TYPE: OIL \_\_\_ GAS X LIQUID INJECTION \_\_\_ WASTE DISPOSAL \_\_\_ IF "GAS" PRODUCTION X STORAGE \_\_\_ DEEP \_\_\_ SHALLOW X

LOCATION: ELEVATION 1103' WATERSHED PURGATORY RUN

DISTRICT CENTERVILLE COUNTY TYLER QUADRANGLE SHIRLEY 7.5' West U

SURFACE OWNER BURNELL WELLS ACREAGE 84.25

ROYALTY OWNER EMORY J. WILCOX LEASE ACREAGE 84.25 OF 168

PROPOSED WORK: DRILL X CONVERT \_\_\_ DRILL DEEPER \_\_\_ REDRILL \_\_\_ FRACTURE OR STIMULATE X PLUG OFF OLD

FORMATION \_\_\_ PERFORATE NEW FORMATION \_\_\_ PLUG AND ABANDON \_\_\_ CLEAN OUT AND REPLUG \_\_\_ OTHER

PHYSICAL CHANGE IN WELL (SPECIFY) \_\_\_ TARGET FORMATION BENSON

ESTIMATED DEPTH 5450'

WELL OPERATOR Pardee Gas Co. DESIGNATED AGENT WILLIAM CARPENTER

ADDRESS PO BOX 4119 PARKERSBURG, WV 26101 ADDRESS PO BOX 4119 PARKERSBURG, WV 26101

AUG 6 1990

LONGITUDE 80-50-00

COUNTY NAME TYLER

PERMIT 1360

095-1421-P

08-Dec-89  
API # 47-95-01300

State of West Virginia  
DEPARTMENT OF ENERGY  
Division of Oil and Gas

*Twisted  
Hole.*

Well Operator's Report of Well Work

Farm name: WELLS, BURNELL Operator Well No.: WILCOX #3

LOCATION: Elevation: 1103.00 Quadrangle: SHIRLEY

District: CENTERVILLE County: TYLER  
Latitude: 1070 Feet South of 39 Deg. 25Min. 0 Sec.  
Longitude 6720 Feet West of 80 Deg. 50 Min. 0 Sec.

Company: COASTAL CORP., THE  
P. O. BOX 4119  
PARKERSBURG, WV 26104-0000

Agent: WILLIAM E. CARPENTER

Inspector: GLEN P. ROBINSON  
Permit Issued: 12/05/89  
Well work Commenced: 12/27/89  
Well work Completed: 1/14/90  
Verbal Plugging  
Permission granted on: 1/14/90  
Rotary X Cable Rig  
Total Depth (feet) 4390'  
Fresh water depths (ft) 675'  
Salt water depths (ft) 1250  
Is coal being mined in area (Y/N)? N  
Coal Depths (ft):

Casing & Tubing Size	Used in Drilling	Left in Well	Cement Fill Up Cu. Ft.
11 3/4	126'	126'	118 cuft
8 5/8	1131	1131	289 cuft

RECEIVED  
FEB 07 1990

DIVISION OF OIL & GAS  
DEPARTMENT OF ENERGY

OPEN FLOW DATA

Producing formation \_\_\_\_\_ Pay zone depth (ft) \_\_\_\_\_  
 Gas: Initial open flow \_\_\_\_\_ MCF/d Oil: Initial open flow \_\_\_\_\_ Bbl/d  
 Final open flow \_\_\_\_\_ MCF/d Final open flow \_\_\_\_\_ Bbl/d  
 Time of open flow between initial and final tests \_\_\_\_\_ Hours  
 Static rock Pressure \_\_\_\_\_ psig (surface pressure) after \_\_\_\_\_ Hours

Second producing formation \_\_\_\_\_ Pay zone depth (ft) \_\_\_\_\_  
 Gas: Initial open flow \_\_\_\_\_ MCF/d Oil: Initial open flow \_\_\_\_\_ Bbl/d  
 Final open flow \_\_\_\_\_ MCF/d Final open flow \_\_\_\_\_ Bbl/d  
 Time of open flow between initial and final tests \_\_\_\_\_ Hours  
 Static rock Pressure \_\_\_\_\_ psig (surface pressure) after \_\_\_\_\_ Hours

NOTE: ON BACK OF THIS FORM PUT THE FOLLOWING: 1). DETAILS OF PERFORATED INTERVALS, FRACTURING OR STIMULATING, PHYSICAL CHANGE, ETC. 2). THE WELL LOG WHICH IS A SYSTEMATIC DETAILED GEOLOGICAL RECORD OF ALL FORMATIONS, INCLUDING COAL ENCOUNTERED BY THE WELLBORE.

*Charles M. Davis Jr.*  
For: COASTAL CORP., THE

By: \_\_\_\_\_  
Date: 2/2/90  
AUG 8 1990

A total depth of 4390' was attained prior to twisting drill pipe off. A three day attempt to fish 1080' of drill pipe including collars out of hole was unsuccessful. Called State Inspector Glen Robinson to obtain verbal permission to plug and abandon well. This permission was granted on 1/14/90 at 0900 hours and after a determination of existing formation depths a job schedule was designed, listed below as follows.

3310'	to	3210'	-	100'	cement plug
3210	to	2250'	-	960'	6% gel plug
2250	to	2000'	-	250'	cement plug
2000	to	1700'	-	300'	6% gel plug
1700	to	1550'	-	150'	cement plug
1550'	to	1200'	-	350'	6% gel plug
1200'	to	1100'	-	100'	cement plug
1100	to	100'	-	1000'	6% gel plug
100	to	Surface	-	100'	cement plug
				<u>3310'</u>	

**RECEIVED**  
FEB 07 1990

DIVISION OF OIL & GAS  
DEPARTMENT OF ENERGY

A total of 265 sacks of standard Class A cement was used along with 5,000 lbs of gel. Formation encountered was Little Lime @ 2038', big Lime @ 2088', Big Injun @ 2178', Berea @ 2584', and Gordon @ 3004'. A well log was unattainable due to hole conditions.

STATE OF WEST VIRGINIA  
DEPARTMENT OF ENERGY  
DIVISION OF OIL AND GAS

AFFIDAVIT OF PLUGGING AND FILLING WELL

AFFIDAVITE SHOULD BE IN TRIPLICATE, one copy mailed to the Division, one copy to be retained by the Well Operator and the third copy (and extra copies if required) should be mailed to each coal operator at their respective addresses.

Farm name: WELLS, BURNELL (1ST. HOLE Operator Well No.: WILCOX #3(1ST)

LOCATION: Elevation: 1103.00 Quadrangle: SHIRLEY  
District: County: TYLER  
Latitude: 1070 Feet South of 39 Deg. 25 Min. 0 Sec.  
Longitude 6720 Feet West of 80 Deg. 50 Min. 0 Sec.

Well type: OIL \_\_\_\_\_ GAS \_\_\_\_\_ X \_\_\_\_\_

Company: The Coastal Corporatin Coal Operator N/A  
P. O. Box 4119 or Owner \_\_\_\_\_  
Parkersburg, WV 26104 \_\_\_\_\_

Agent: W. E. Carpenter, Jr. Coal Operator \_\_\_\_\_  
Inspector: Glen Robinson or Owner \_\_\_\_\_  
Permit Issued: 12/05/89 \_\_\_\_\_

AFFIDAVIT

STATE OF WEST VIRGINIA,  
County of Tyler ss:

Halliburton Services and Edsel M. Davis, Jr. being first duly sworn according to law depose and say that they are experienced in the work of plugging and filling oil and gas wells and were employed by The Coastal Corporation, well operator, and participated in the work of plugging and filling the above well, that said work was commenced on the 14th day of January, 1990, and that the well was plugged and filled in the following manner:

TYPE	FROM	TO	PIPE REMOVED	LEFT
Cement Plug	3310	3210	None	None
Gel Plug	3210	2250		
Cement Plug	2250	2000		
Gel Plug	2000	1700		
Cement Plug	1700	1550		
Gel Plug	1550	1200		
Cement Plug	1200	1100		
Gel Plug	1100	100		
Cement Plug	100	0-surf		

Description of monument: 38" - 8 5/8 CSG above ground

and that the work of plugging and filling said well was completed on the 14th day of January, 1990.

And further deponents saith not.

*Edsel M. Davis Jr*

Sworn and subscribe before me this 8th day of August, 1990  
My commission expires: May 24, 1999

*Notary Public*  
Notary Public  
AUG 24 1990