

Janice 10/11/90

WELL REFERENCES:

N70°W, 119' TO 4" GUM
N4°E, 148' TO 10" BLACK OAK

10470'

LATITUDE 39°25'00"

01408

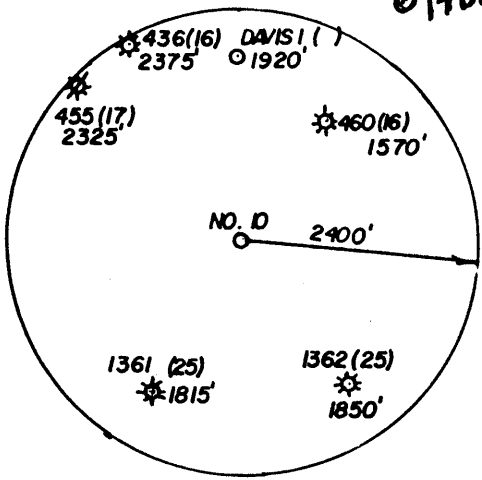

McCULLOUGH

PRATT

SANDY

STEPHEN B. PITTS
72.83 AC. SURF.

DOTSON

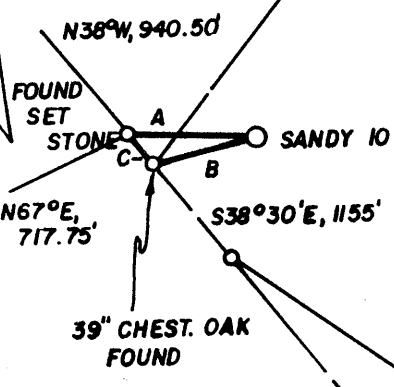

TIE LINES:

- A) S87°27'E, 332.78'
- B) S75°35'W, 274.92'
- C) N38°30'W, 106.34'

15' loc
2.61 S
1.96 W
West Union
EC

2.61 S
1.96 W

LAND SURVEYING SERVICES
21 CEDAR LANE
BRIDGEPORT, WV 26330
PHONE: 304-842-2018

(+) DENOTES LOCATION OF WELL ON UNITED STATES TOPOGRAPHIC MAPS

FILE NO. _____
 DRAWING NO. _____
 SCALE 1" = 500'
 MINIMUM DEGREE OF ACCURACY 1 IN 200
 PROVEN SOURCE OF ELEVATION TOP OF KNOB 1430'
EAST OF LOC. AT ELEV. 1291'

I THE UNDERSIGNED, HEREBY CERTIFY THAT THIS PLAT IS CORRECT TO THE BEST OF MY KNOWLEDGE AND BELIEF AND SHOWS ALL THE INFORMATION REQUIRED BY LAW AND THE REGULATIONS ISSUED AND PRESCRIBED BY THE DEPARTMENT OF ENERGY.
 (SIGNED) _____
 R.P.E. _____ L.L.S. NO. 674
STEPHEN D. LOSH

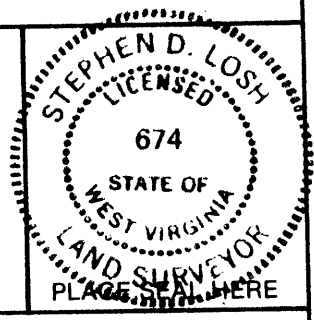

STATE OF WEST VIRGINIA
DEPARTMENT OF ENERGY
OIL AND GAS DIVISION



DATE SEPT. 17, 19 90
 OPERATOR'S WELL NO. SANDY 10
 API WELL NO. _____
47 - 095 - 1436
 STATE COUNTY PERMIT

WELL TYPE: OIL ___ GAS X LIQUID INJECTION ___ WASTE DISPOSAL ___
 (IF "GAS,") PRODUCTION X STORAGE ___ DEEP ___ SHALLOW X
 LOCATION: ELEVATION 1116' WATERSHED SANDY RUN
 DISTRICT McELROY 5 COUNTY TYLER
 QUADRANGLE SHIRLEY
 SURFACE OWNER S. BERNARD PITTS ACREAGE 72.83
 OIL & GAS ROYALTY OWNER WM. SANDY HRS. LEASE ACREAGE 637.
 LEASE NO. _____

PROPOSED WORK: DRILL X CONVERT ___ DRILL DEEPER ___ REDRILL ___ FRACTURE OR
 STIMULATE ___ PLUG OFF OLD FORMATION ___ PERFORATE NEW
 FORMATION ___ OTHER PHYSICAL CHANGE IN WELL (SPECIFY) _____
OCT 15 1990

PLUG AND ABANDON ___ CLEAN OUT AND REPLUG ___
 TARGET FORMATION BENSON ESTIMATED DEPTH 5250'
 WELL OPERATOR STONEWALL GAS COMPANY DESIGNATED AGENT JESSE SHELL
 ADDRESS P.O. DRAWER R 847 ADDRESS P.O. DRAWER R
JANE LEW, WV 26378-0080 66 Wilbur (092) JANE LEW, WV 26378-0080

FORM WW-6

HALLS INC. 068065

COUNTY NAME
PERMIT

RECEIVED
JAN 10 1991

State of West Virginia
DEPARTMENT OF ENERGY
Division of Oil and Gas

DIVISION OF OIL & GAS Well Operator's Report of Well Work
DEPARTMENT OF ENERGY
Farm name: PITTS, STEPHEN B. Operator Well No.: SANDY 10

LOCATION: Elevation: 1116.00 Quadrangle: SHIRLEY

District: MCELROY County: TYLER
Latitude: 13930 Feet South of 39 Deg. 25Min. 0 Sec.
Longitude: 10470 Feet West of 80 Deg. 45 Min. 0 Sec.

Company: STONEWALL GAS COMPANY
909 E. MAIN ST. P.O. BOX 1575
RICHMOND, VA 23219-1575

Agent: JESSE A. SHELL

Inspector: MIKE UNDERWOOD
Permit Issued: 10/11/90
Well work Commenced: 10-27-90
Well work Completed: 11-02-90
Verbal Plugging
Permission granted on: _____
Rotary X Cable _____ Rig
Total Depth (feet) 5280
Fresh water depths (ft) _____
437
Salt water depths (ft) _____
Is coal being mined in area (Y/N)? N
Coal Depths (ft): 494

Casing & Tubing Size	Used in Drilling	Left in Well	Cement Fill Up Cu. Ft.
11 3/4	114	114	70 SKS
8 5/8	1299	1299	250 SKS
4 1/2	5235	5235	710 SKS

OPEN FLOW DATA

Producing formation BENSON Pay zone depth (ft) 5100
Gas: Initial open flow 25 MCF/d Oil: Initial open flow 0 Bbl/d
Final open flow 1632 MCF/d Final open flow 0 Bbl/d
Time of open flow between initial and final tests 1 Hours
Static rock Pressure 1450 psig (surface pressure) after 168 Hours

Second producing formation BEREA Pay zone depth (ft) 2570
Gas: Initial open flow 25 MCF/d Oil: Initial open flow 0 Bbl/d
Final open flow 0 MCF/d Final open flow 0 Bbl/d
Time of open flow between initial and final tests 1 Hours
Static rock Pressure 825 psig (surface pressure) after 168 Hours

NOTE: ON BACK OF THIS FORM PUT THE FOLLOWING: 1). DETAILS OF PERFORATED INTERVALS, FRACTURING OR STIMULATING, PHYSICAL CHANGE, ETC. 2). THE WELL LOG WHICH IS A SYSTEMATIC DETAILED GEOLOGICAL RECORD OF ALL FORMATIONS, INCLUDING COAL ENCOUNTERED BY THE WELLBORE.

For: STONEWALL GAS COMPANY

By: [Signature] RAY M. FREAR, JR.
Date: DECEMBER 31, 90 PETROLEUM ENGINEER

JAN 11 1991

2 STAGE WATER FRAC

DATE NOV 11 & NOV 22, 90

ZONES	PERFS	HOLES	BBL	BP	TSIP
BENSON	5100-5105	20	700	2020	1700
BEREA	2570-2572 2581-2584	15	600	2440	1720

FORMATION	COLOR	HARD/SOFT	TOP	BOTTOM	REMARKS
FILL	BROWN	SOFT	0	15	GAS CK 1961 NO SHOW
RR & SHALE	GRAY	SOFT	15	35	GAS CK 2117 6/10 1" W/
SAND & SHALE	GRAY	SOFT	35	120	GAS CK 2148 6/10 1" W/W
SAND	BROWN	HARD	120	145	GAS CK 2247 6/10 1" W/W
SHALE	GRAY	HARD	145	153	
RR & SHALE	GRAY	HARD	153	184	
SHALE & SAND	GRAY	SOFT	184	490	GAS CK 2830 6/10 1" W/W
COAL	BLACK	SOFT	490	494	GAS CK 3451 6/10 1" W/W
SAND & SHALE	GRAY	SOFT	494	938	GAS CK 4691 10/10 1" W/W
SHALE	GRAY	HARD	938	970	
SAND & SHALE	BROWN	HARD	970	990	GAS CK 5129 18/10 1" W/W
SHALE	GRAY	HARD	990	1150	GAS CK 5280 14/10 1" W/W
SAND & SHALE	GRAY	SOFT	1150	1873	
SAND	BROWN	SOFT	1873	1925	
SAND & SHALE	BROWN	SOFT	1925	1976	
L-LIME	BROWN	HARD	1976	1992	
SAND & SHALE	GRAY	HARD	1992	2010	
B-LIME	GRAY	SOFT	2010	2103	
SAND & SHALE	GRAY	SOFT	2103	2130	
INJUN	BROWN	SOFT	2130	2232	
SAND & SHALE	BROWN	HARD	2232	2750	
GORDON	GRAY	HARD	2750	2772	
SAND & SHALE	GRAY	HARD	2772	4611	
RILEY	BROWN	SOFT	4611	4625	
SAND & SHALE	GRAY	SOFT	4625	5100	
BENSON	GRAY	SOFT	5100	5120	
SAND & SHALE	GRAY	HARD	5120	5280	
TD				5280	

RECEIVED
JAN 10 1991

DIVISION OF OIL & GAS
DEPARTMENT OF ENERGY

11/3/90

SEP 25 1990

DEPT. OF ENERGY

095-1436
Issued 10/11/90

Page ___ of ___

Expires 10/11/92

STATE OF WEST VIRGINIA
DEPARTMENT OF ENERGY, DIVISION OF OIL AND GAS
WELL WORK PERMIT APPLICATION

- 1) Well Operator: STONEWALL GAS COMPANY 47850(5) 606
- 2) Operator's Well Number: SANDY #10 3) Elevation: 1116
- 4) Well type: (a) Oil / or Gas /
(b) If Gas: Production / Underground Storage /
Deep / Shallow /
- 5) Proposed Target Formation(s): BENSON
- 6) Proposed Total Depth: 5250' feet
- 7) Approximate fresh water strata depths: 58' 185'
- 8) Approximate salt water depths: 1125' OK
- 9) Approximate coal seam depths: 690 - 695' ; 715 - 720' OK
- 10) Does land contain coal seams tributary to active mine? Yes / No /
- 11) Proposed Well Work: Drill & Stimulate New Well
- 12)

CASING AND TUBING PROGRAM

11310

TYPE	SPECIFICATIONS			FOOTAGE INTERVALS		CEMENT
	Size	Grade	Weight per ft.	For drilling	Left in well	Fill-up (cu. ft.)
<u>7/19/90</u> Conductor	11 3/4"		27#	100'	100'-CTS	38 CSR 18-11.3
Fresh Water						
Coal						
Intermediate	8 5/8"		20#	1300'	1300'-CTS	38 CSR 18-11.2.2
Production	4 1/2"		10.5#	5190'	5190'	38 CSR 18-11.1
Tubing						
Liners						

PACKERS : Kind _____
Sizes _____
Depths set _____

6971
27

For Division of Oil and Gas Use Only

Fee(s) paid: Well Work Permit Reclamation Fund WPCP
 Plat WW-9 WW-2B Bond (C) Blanket Agent
 (Type)

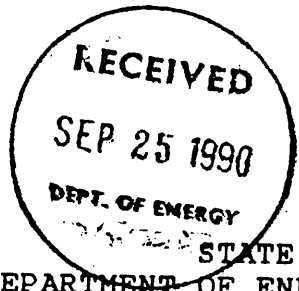

- 1) Date: SEPTEMBER 24, 1990
- 2) Operator's well number SANDY #10 (542-S)
- 3) API Well No: 47 - 095 - 1436
State - County - Permit

STATE OF WEST VIRGINIA
DEPARTMENT OF ENERGY, DIVISION OF OIL AND GAS

NOTICE AND APPLICATION FOR A WELL WORK PERMIT

- 4) Surface Owner(s) to be served:
 - (a) Name STEPHEN B. PITTS
Address CP STAR RT BOX 171
WEST UNION, WV 26456
 - (b) Name _____
Address _____
 - (c) Name _____
Address _____
- 5) (a) Coal Operator:
 - Name N/A
Address _____
 - (b) Coal Owner(s) with Declaration
Name ALICE WRIGHT HRS.
Address C/O W. S. WRIGHT
209 EUCLID AVENUE
Name CLARKSBURG, WV 26301
Address _____
 - (c) Coal Lessee with Declaration
Name N/A
Address _____
- 6) Inspector GLEN P. ROBINSON
Address RT 1 #6 MT PLEASANT EST.
MINERAL WELLS, WV 26150
Telephone (304)-489-2736

TO THE PERSON(S) NAMED ABOVE TAKE NOTICE THAT:

_____ Included is the lease or leases or other continuing contract or contracts by which I hold the right to extract oil and gas OR
 Included is the information required by Chapter 22B, Article 1, Section 8(d) of the Code of West Virginia (see page 2)

I certify that as required under Chapter 22B of the West Virginia Code I have served copies of this notice and application, a location plat, and accompanying documents pages 1 through _____ on the above named parties, by:

- _____ Personal Service (Affidavit attached)
- Certified Mail (Postmarked postal receipt attached)
- _____ Publication (Notice of Publication attached)

I have read and understand Chapter 22B and 38 CSR 11-18, and I agree to the terms and conditions of any permit issued under this application.

I certify under penalty of law that I have personally examined and am familiar with the information submitted on this application form and all attachments, and that based on my inquiry of those individuals immediately responsible for obtaining the information, I believe that the information is true, accurate, and complete.

I am aware that there are significant penalties for submitting false information, including the possibility of fine and imprisonment.

Well Operator STONE WALL GAS COMPANY
By: [Signature]
Its: PRESIDENT
Address PO DRAWER R
JANE LEW, WV 26378
Telephone 304-884-7881
I subscribe and sworn before me this 24TH day of SEPTEMBER, 1990

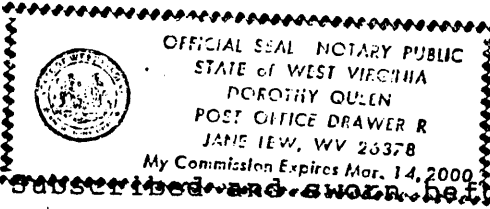

[Signature]
My commission expires MARCH 14, 2000 Notary Public