

LONG. 80° 59' 12.06"

LATITUDE 39° 22' 30"

LONGITUDE 80° 57' 30"

5430'

LAT. 39° 21' 36.48"

NORTH

DAVE HARTLEY

STONE

808
0
807

N88E

313.5

BRUNER LAND CO.

2325

20AC.

DAVID HARTLEY

80

1.03
1.53

ANGLE POST

N88E 957'

HICKORY

N14 1/2 E 225.3'

1619

S31E 363'

APPLE TREE

DAVID HARTLEY
47 1/2 AC. LEASE

DAVE HARTLEY

HARTLEY #3
ELEV. 916'

BUSH RUN

S1 1/2 W 1765.5'

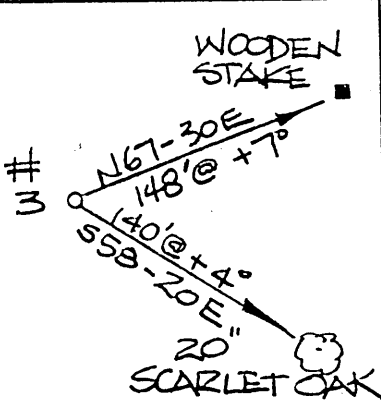

(+) DENOTES LOCATION OF WELL ON UNITED STATES TOPOGRAPHIC MAPS

FILE NO. _____
 DRAWING NO. _____
 SCALE 1" = 500'
 MINIMUM DEGREE OF ACCURACY 1:200
 PROVEN SOURCE OF ELEVATION GPS SURVEY

I THE UNDERSIGNED, HEREBY CERTIFY THAT THIS PLAT IS CORRECT TO THE BEST OF MY KNOWLEDGE AND BELIEF AND SHOWS ALL THE INFORMATION REQUIRED BY LAW AND THE REGULATIONS ISSUED AND PRESCRIBED BY THE DEPARTMENT OF ENERGY.

(SIGNED) _____ R.P.E. _____ L.L.S. 551

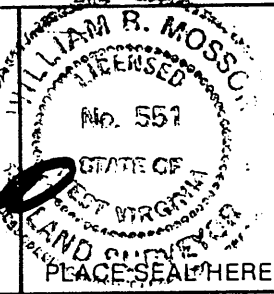

STATE OF WEST VIRGINIA
 DEPARTMENT OF ENERGY
 DIVISION OF OIL AND GAS



DATE 5 DECEMBER, 2000
 OPERATOR'S WELL NO. HARTLEY #3
 API WELL NO. _____

47 - 095 - 1703
 STATE COUNTY PERMIT

WELL TYPE: OIL GAS LIQUID INJECTION _____ WASTE DISPOSAL _____
 (IF "GAS,") PRODUCTION STORAGE _____ DEEP SHALLOW
 LOCATION: ELEVATION 916' WATER SHED BRUSH RUN
 DISTRICT MEADE COUNTY TYLER
 QUADRANGLE PENNSBORO
 SURFACE OWNER DAVID HARTLEY ACREAGE 47 1/2
 OIL & GAS ROYALTY OWNER DAVID HARTLEY LEASE ACREAGE 47 1/2

COUNTY NAME TYLER

PROPOSED WORK: DRILL CONVERT _____ DRILL DEEPER _____ REDRILL _____ FRACTURE OR STIMULATE _____ PLUG OFF OLD FORMATION _____ PERFORATE NEW FORMATION _____ OTHER PHYSICAL CHANGE IN WELL (SPECIFY) _____

PERMIT 1703

PLUG AND ABANDON _____ CLEAN OUT AND REPLUG _____
 TARGET FORMATION ALEXANDER ESTIMATED DEPTH 5500'
 WELL OPERATOR OHIO LEM CO, INC. DESIGNATED AGENT JEFF SAYGER
 ADDRESS P.O. Box 80 ADDRESS 16 FOX HILL TERRACE
RENO, OHIO 45773 PARKERSBURG, WV 26101

6-6 86

DEC 22 2000

Completion:

Perforated Benson Sand With 32 Holes From 4815-4823

Frac Well With 500 Gals. 15% HCL Break - 1400PSI
Treat Well With 760 Bbl. Slick Water - 60,000# 20/40 Sand
N2 Assist - 32 BPM Rate - Aveg. Treat PSI - 2725
ISIP 1218 5 Min - 1102

WELL: Ohio L & M Co., Inc.#3 Hartley.

LOCATION: Meade District, Tyler County, West Virginia.

PERMIT NUMBER: Tyler-1703.

ELEVATION: 916' Ground 926' KB.

STATUS: Preparing to complete as a gas producer.

CASING: 11 3/4" @ 172' 8 5/8" @ 1104'.

TOTAL DEPTH: 4945' Driller 4942' Logger.

CONTRACTOR: Nexus Drilling Co..

TOOLS: Rotary.

SPUD DATE: 1/9/2001.

COMPLETED DRILLING: 1/15/2001.

FORMATION AT TOTAL DEPTH: Devonian shale.

ELECTRICAL SURVEYS: Gamma Ray- Neutron- Compensated Density- Caliper- Induction- Temperature- Noise by Allegheny Wireline Services, Inc..

SHOWS: A very good show of gas was encountered in the Benson Sandstone. Small shows of gas were noted in the 3rd Salt, Big Injun and Weir. Good hydrocarbon fluorescence was recorded in the Weir. Fair hydrocarbon fluorescence was noted in the 3rd Salt and Benson Sandstone. A more detailed description of the above mentioned fluorescence can be found on the attached Formation Evaluation Log.

FORMATION TOPS:	2 nd Cow Run Sandstone	1163'	- 237
	Gas Sand	1325'	- 399
	1st Salt Sand	1410'	- 484
	2nd Salt Sand	1532'	- 606
	3rd Salt Sand	1620'	- 694
	Maxon Sandstone	1730'	- 804
	Little Lime	1759'	- 833
	Big Lime (Greenbrier)	1784'	- 858
	Big Injun Sandstone	1874'	- 948
	Squaw Sandstone	1990'	- 1064
	Weir Sandstone	2250'	- 1324

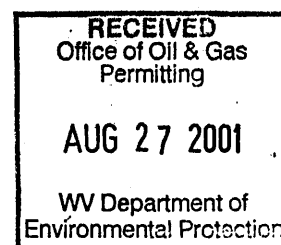

AUG 31 2001

TYL 1703

Berea Sandstone	2510'	- 1584
Gantz Sandstone	2601'	- 1675
30' Sandstone	2681'	- 1755
Gordon Sandstone	2798'	- 1872
4 th Sandstone	2865'	- 1939
5 th Sandstone	2952'	- 2026
Warren Sandstone	3374'	- 2448
Speechley Sandstone	3738'	- 2812
Balltown Sandstone	3906'	- 2980
Riley Sandstone	4625'	- 3699
Benson Sandstone	4810'	- 3884

STRUCTURAL COMPARISON:

	Ohio L&M Co., Inc.	Ohio L&M Co.
	Hartley #3	Hartley #1
Benson Sandstone	- 3884	- 3880

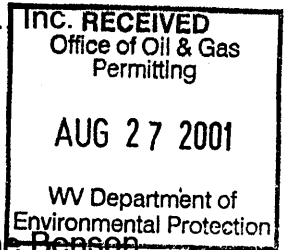

GEOLOGY:

Sample analysis indicated very good sandstone development in the Weir and Gordon. A very good show of gas was encountered in the Benson. Small shows of gas were noted in the 3rd Salt, Big Injun and Weir. Good hydrocarbon fluorescence was recorded in the Weir, while fair hydrocarbon fluorescence was noted in the 3rd Salt and Benson Sandstone.

Based upon the open hole logs, the Benson Sandstone at 4813 to 4822' appears to be well developed with good gas saturations. The Weir and Gordon showed fair development.

The Benson Sandstone should be very good producer of gas in this well. A completion attempt on the Weir and Gordon would also be warranted prior to abandonment.

Respectfully submitted,

NATIONAL MINERALS CORPORATION

By: Douglas L. Core, President

January 16, 2001