

Top Hole Latitude: 39°30'00"

3542'

Bottom Hole Latitude: 39°30'00"

5915'

THRASHER

THE THRASHER GROUP, INC.
800 WHITE OAKS BLVD.
BRIDGEPORT, WV 26330
PHONE 304-624-4108

NOTES ON SURVEY

- COORDINATES SYSTEM IS UTM, NAD 83 DATUM, ZONE 17, U.S. FOOT AND WELL COORDINATES ESTABLISHED USING SURVEY GRADE GPS.
- SURFACE AND ROYALTY OWNER INFORMATION AND THEIR BOUNDARIES SHOWN HEREON WERE PLOTTED FROM DEEDS AND/OR TAX PARCEL MAPS PROVIDED BY CLIENT AND FIELD LOCATIONS.
- THIS PLAT DOES NOT REPRESENT A BOUNDARY SURVEY OF THE PARCELS SHOWN HEREON.
- NO DWELLINGS AND BUILDINGS WITHIN 625 FEET OF PROPOSED OF CENTER OF PAD.
- NO WATER WELLS OR DEVELOPED SPRINGS WITHIN 250 FEET OF PROPOSED WELL.
- NO PERENNIAL STREAMS, LAKES, PONDS, RESERVOIRS OR WETLANDS WITHIN 100 FEET OF THE LIMITS OF DISTURBANCE.
- NO NATURALLY PRODUCING TROUT STREAM WITHIN 300 FEET OF LIMITS OF DISTURBANCE.

AS-DRILLED

TRACT	SURFACE OWNER	TAX PARCEL	ACRES
A	RODNEY & VICKIE TIPPINS	5-7-13	42.25
B	EJ TIPPINS	5-7-11	45.25
C	LEO & NANCY SCHUMACHER	5-3-25	134.00
D	DOMINIC & MICHELE KOWALSKI	5-3-14	86.88
E	GARY GREYLONGS	5-3-8	86.06
F	DOMINIC & MICHELE KOWALSKI	5-3-11	106.94
G	DOMINIC & MICHELE KOWALSKI	5-3-10	43.00
H	DOMINIC & MICHELE KOWALSKI	5-25-1	60.00

GRID NORTH
UTM, NAD83 DATUM, ZONE 17, US FT

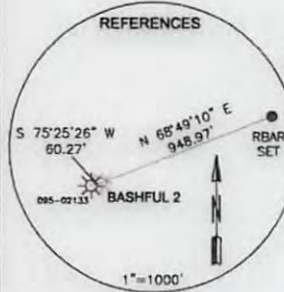
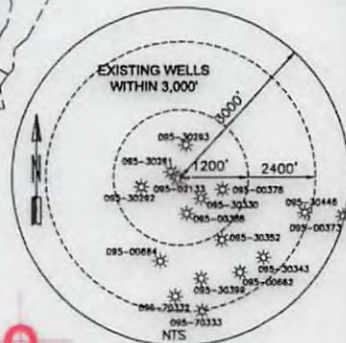
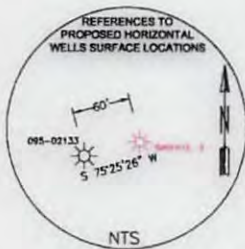

SURFACE HOLE LOCATION (SHL): UTM (NAD83, ZONE 17, METERS): NORTHING: 4,369,319.265 EASTING: 524,005.638
BOTTOM HOLE LOCATION (BHL): UTM (NAD83, ZONE 17, METERS): NORTHING: 4,371,614.919 EASTING: 523,274.301

I, THE UNDERSIGNED, HEREBY CERTIFY THAT THIS PLAT IS CORRECT TO THE BEST OF MY KNOWLEDGE AND BELIEF AND SHOWS ALL THE INFORMATION REQUIRED BY LAW AND REGULATIONS ISSUED AND PRESCRIBED BY THE DEPARTMENT OF ENVIRONMENTAL PROTECTION.

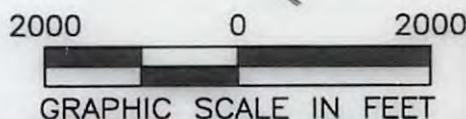

P.S. 2270 *M.S. Wolf 3/16/16*

<p>(+) DENOTES LOCATION OF WELL ON UNITED STATES TOPOGRAPHIC MAPS</p> <p>WVDEP OFFICE OF OIL & GAS 601 57TH STREET CHARLESTON, WV 25034</p>	MINIMUM DEGREE OF ACCURACY: 1/200 PROVEN SOURCE OF ELEVATION: SURVEY GRADE GPS (NAVD 88, US FT)	OPERATOR'S WELL #: BASHFUL 2 API WELL #: 47 095 02140-H6A STATE COUNTY PERMIT
	WELL TYPE: OIL <input type="checkbox"/> WASTE DISPOSAL <input type="checkbox"/> PRODUCTION <input type="checkbox"/> DEEP <input type="checkbox"/> GAS <input checked="" type="checkbox"/> LIQUID INJECTION <input type="checkbox"/> STORAGE <input type="checkbox"/> SHALLOW <input checked="" type="checkbox"/>	WATERSHED: BONELICK RUN DISTRICT: MCELROY COUNTY: TYLER SURFACE OWNER: RODNEY L. & VICKIE L. TIPPINS & THOMAS HEADLEY EST. OIL & GAS ROYALTY OWNER: SOUTH PENN OIL COMPANY

DRILL <input checked="" type="checkbox"/> DRILL DEEPER <input type="checkbox"/> REDRILL <input type="checkbox"/> FRACTURE OR STIMULATE <input checked="" type="checkbox"/> PLUG OFF OLD FORMATION <input type="checkbox"/> PERFORATE NEW FORMATION <input type="checkbox"/> CONVERT <input type="checkbox"/> PLUG & ABANDON <input type="checkbox"/> CLEAN OUT & REPLUG <input type="checkbox"/> OTHER CHANGE (SPECIFY) <input type="checkbox"/>	TARGET FORMATION: MARCELLUS ESTIMATED DEPTH: TMD 14,517' TVD 7,065' DATE: 03-16-2016 DRAWN BY: E. LYTLE SCALE: 1" = 2000' DRAWING NO: 050-5805 ASDRILLED PLAT
---	---

WELL OPERATOR: JAY BEE OIL & GAS, INC. ADDRESS: 1720 RT. 22, EAST CITY: UNION STATE: NJ ZIP CODE: 07083	DESIGNATED AGENT: RANDY BRODA ADDRESS: RT. 1 BOX 5 CITY: CAIRO STATE: WV ZIP CODE: 26337
---	--

LEGEND: ● PROPOSED SURFACE HOLE / BOTTOM HOLE ☼ EXISTING / PRODUCING WELLHEAD ✕ ABANDONED WELL ✕ PLUGGED & ABANDONED WELL △ CUT CONDUCTOR	REVISIONS: - - - - - LEASE BOUNDARY - - - - - 500' DHP BUFFER - - - - - AS-DRILLED DHP - - - - - PLANNED DHP
---	---