

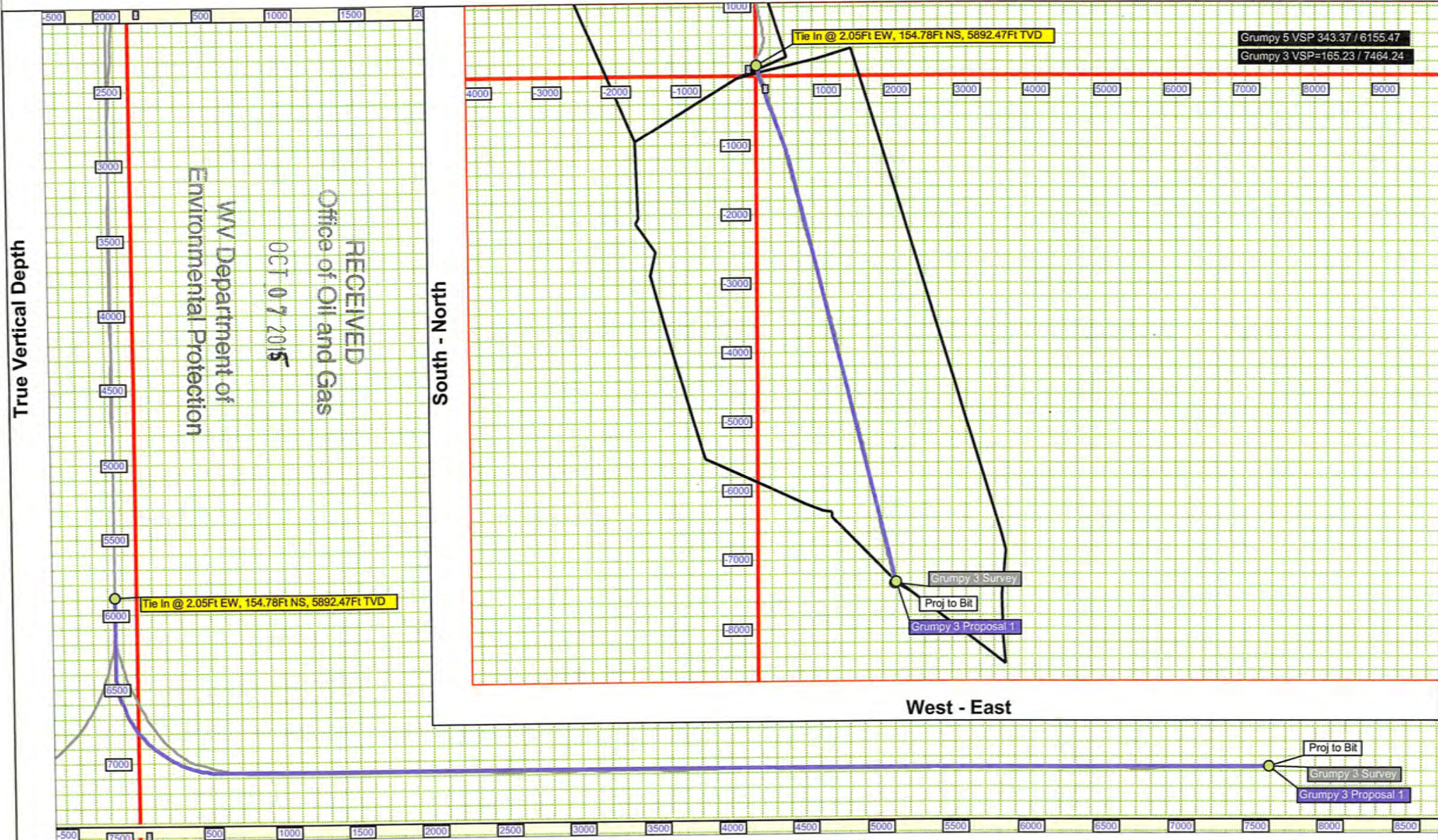

Job Number: Grumpy 3 Svys
Company: Jay Bee Oil & Gas
Lease/Well: Grumpy 3
Location: Northern
Rig Name:
State/County: West Virginia/ Tyler
Country: USA
API Number:



Elevation (To MSL): 1298.01 ft
RKB: 16.00 ft
Projection System: US State Plane 1927 (Exact solution)
Projection Group: West Virginia North 4701
Projection Datum: CLARKE 1866
Magnetic Declination: -8.53
Grid Convergence: -0.80623 W
Date: Monday, December 08, 2014





Job Number: Grumpy 3 Svys
Company: Jay Bee Oil & Gas
Lease/Well: Grumpy 3
Location: Northern
Rig Name:
State/County: West Virginia/ Tyler
Country: USA

Elev. GL: 1298.01 ft **RKB:** 16.00 ft
System: US State Plane 1927 (Exact solution)
Group: West Virginia North 4701
Datum: CLARKE 1866
Mag. Decl.: -8.53° (C:\HawkEye\IGRF2010.MIF)
Grid Conv.: -0.80623 W
Date: Monday, December 08, 2014



Calculated by HawkEye Software
 Minimum Curvature Method
 Vertical Section Plane 164.75°
 Northing (US ft): 354844.04 Easting (US ft): 1643097.45
 Latitude: 39°28'2.5000" N Longitude: -80°45'51.2000" W
 Direction Reference: Grid North



#	Measured Depth (Ft)	INC Deg	AZM Deg	CL (Ft)	TVD (Ft)	VS (Ft)	NS (Ft)	EW (Ft)	Northing (US ft)	Easting (US ft)	DLS */100 Ft	LR/EW From-Plan (Ft)	UD/NS From-Plan (Ft)
1	0.00	0.00	0.00	0.00	0.00	0.00	0.00	0.00	354844.04	1643097.45	0.00	-	-
2	100.00	0.34	195.66	100.00	100.00	0.25	-0.29	-0.08	354843.75	1643097.37	0.34	-	-
3	200.00	1.05	130.16	100.00	199.99	1.26	-1.16	0.54	354842.88	1643097.99	0.96	-	-
4	300.00	1.20	93.14	100.00	299.97	2.35	-1.81	2.29	354842.23	1643099.74	0.73	-	-
5	400.00	0.62	88.81	100.00	399.96	2.81	-1.86	3.87	354842.18	1643101.32	0.58	-	-
6	500.00	0.97	85.91	100.00	499.95	3.11	-1.79	5.26	354842.25	1643102.71	0.35	-	-
7	600.00	1.26	81.89	100.00	599.93	3.41	-1.57	7.19	354842.47	1643104.64	0.30	-	-
8	700.00	1.65	69.95	100.00	699.90	3.42	-0.92	9.63	354843.12	1643107.08	0.49	-	-
9	800.00	1.65	27.20	100.00	799.86	2.24	0.85	11.64	354844.89	1643109.09	1.20	-	-
10	900.00	5.45	19.96	100.00	899.65	-2.70	6.60	13.92	354850.64	1643111.37	3.82	-	-
11	1000.00	6.28	6.04	100.00	999.13	-11.68	16.50	16.12	354860.54	1643113.57	1.64	-	-
12	1100.00	6.15	6.94	100.00	1098.55	-21.74	27.26	17.34	354871.30	1643114.79	0.16	-	-
13	1200.00	6.10	6.86	100.00	1197.97	-31.62	37.85	18.62	354881.89	1643116.07	0.05	-	-
14	1300.00	6.05	7.03	100.00	1297.41	-41.42	48.36	19.90	354892.40	1643117.35	0.05	-	-
15	1400.00	5.96	5.59	100.00	1396.86	-51.15	58.75	21.05	354902.79	1643118.50	0.18	-	-
16	1500.00	5.70	3.52	100.00	1496.35	-60.70	68.88	21.86	354912.92	1643119.31	0.33	-	-
17	1600.00	5.73	3.64	100.00	1595.85	-70.12	78.82	22.49	354922.86	1643119.94	0.03	-	-
18	1700.00	5.52	2.32	100.00	1695.37	-79.43	88.60	23.00	354932.64	1643120.45	0.25	-	-
19	1800.00	5.27	356.87	100.00	1794.93	-88.51	98.00	22.94	354942.04	1643120.39	0.57	-	-
20	1900.00	5.02	356.68	100.00	1894.52	-97.28	106.95	22.44	354950.99	1643119.89	0.25	-	-
21	2000.00	4.43	5.16	100.00	1994.18	-105.18	115.16	22.53	354959.20	1643119.98	0.91	-	-
22	2100.00	4.09	8.96	100.00	2093.91	-112.05	122.53	23.43	354966.57	1643120.88	0.44	-	-
23	2200.00	3.84	9.71	100.00	2193.67	-118.34	129.36	24.55	354973.40	1643122.00	0.26	-	-
24	2300.00	3.97	10.07	100.00	2293.44	-124.50	136.06	25.72	354980.10	1643123.17	0.13	-	-
25	2400.00	3.46	13.49	100.00	2393.23	-130.28	142.41	27.03	354986.45	1643124.48	0.56	-	-
26	2500.00	3.30	15.89	100.00	2493.05	-135.39	148.11	28.53	354992.15	1643125.98	0.21	-	-
27	2600.00	3.27	17.91	100.00	2592.89	-140.24	153.59	30.19	354997.63	1643127.64	0.12	-	-
28	2700.00	2.46	11.66	100.00	2692.76	-144.54	158.41	31.50	355002.45	1643128.95	0.87	-	-
29	2800.00	1.43	3.47	100.00	2792.70	-147.63	161.76	32.01	355005.80	1643129.46	1.06	-	-
30	2900.00	0.73	354.86	100.00	2892.69	-149.44	163.64	32.03	355007.68	1643129.48	0.72	-	-

Environmental Protection
 Department of

RECEIVED
 OCT 07 2015

RECEIVED
 Jay Bee Oil & Gas

#	Measured Depth (Ft)	INC Deg	AZM Deg	CL (Ft)	TVD (Ft)	VS (Ft)	NS (Ft)	EW (Ft)	Northing (US ft)	Easting (US ft)	DLS ² /100 Ft	LR/EW From-Plan (Ft)	UD/NS From-Plan (Ft)
31	3000.00	0.62	329.26	100.00	2992.68	-150.59	164.73	31.70	355008.77	1643129.15	0.32	-	-
32	3100.00	0.66	314.66	100.00	3092.67	-151.61	165.60	31.01	355009.64	1643128.46	0.17	-	-
33	3200.00	0.43	307.77	100.00	3192.67	-152.41	166.24	30.30	355010.28	1643127.75	0.24	-	-
34	3300.00	0.54	270.61	100.00	3292.66	-152.84	166.47	29.54	355010.51	1643126.99	0.33	-	-
35	3400.00	0.61	267.61	100.00	3392.66	-153.09	166.46	28.53	355010.50	1643125.98	0.08	-	-
36	3500.00	0.60	260.45	100.00	3492.65	-153.26	166.35	27.48	355010.39	1643124.93	0.08	-	-
37	3600.00	0.50	254.88	100.00	3592.65	-153.31	166.15	26.55	355010.19	1643124.00	0.11	-	-
38	3700.00	0.39	255.38	100.00	3692.65	-153.31	165.95	25.80	355009.99	1643123.25	0.11	-	-
39	3800.00	0.36	251.08	100.00	3792.64	-153.30	165.76	25.17	355009.80	1643122.62	0.04	-	-
40	3900.00	0.48	249.67	100.00	3892.64	-153.24	165.51	24.48	355009.55	1643121.93	0.12	-	-
41	4000.00	0.49	232.30	100.00	3992.64	-153.04	165.11	23.75	355009.15	1643121.20	0.15	-	-
42	4100.00	0.48	238.76	100.00	4092.63	-152.76	164.63	23.05	355008.67	1643120.50	0.06	-	-
43	4200.00	0.60	247.44	100.00	4192.63	-152.58	164.21	22.21	355008.25	1643119.66	0.14	-	-
44	4300.00	0.45	269.62	100.00	4292.63	-152.61	164.00	21.33	355008.04	1643118.78	0.25	-	-
45	4400.00	0.61	266.73	100.00	4392.62	-152.83	163.97	20.41	355008.01	1643117.86	0.16	-	-
46	4500.00	0.62	270.42	100.00	4492.62	-153.08	163.95	19.34	355007.99	1643116.79	0.04	-	-
47	4600.00	0.53	261.95	100.00	4592.61	-153.29	163.88	18.34	355007.92	1643115.79	0.12	-	-
48	4700.00	0.74	237.85	100.00	4692.60	-153.16	163.48	17.33	355007.52	1643114.78	0.34	-	-
49	4800.00	0.83	226.08	100.00	4792.60	-152.62	162.63	16.27	355006.67	1643113.72	0.18	-	-
50	4900.00	1.02	231.11	100.00	4892.58	-151.92	161.57	15.05	355005.61	1643112.50	0.21	-	-
51	5000.00	1.10	245.81	100.00	4992.57	-151.41	160.62	13.48	355004.66	1643110.93	0.28	-	-
52	5100.00	0.98	248.08	100.00	5092.55	-151.16	159.90	11.81	355003.94	1643109.26	0.13	-	-
53	5200.00	0.88	249.08	100.00	5192.54	-150.99	159.31	10.30	355003.35	1643107.75	0.10	-	-
54	5300.00	0.85	237.71	100.00	5292.52	-150.69	158.64	8.96	355002.68	1643106.41	0.17	-	-
55	5400.00	0.83	231.44	100.00	5392.51	-150.19	157.79	7.77	355001.83	1643105.22	0.09	-	-
56	5500.00	0.79	239.34	100.00	5492.50	-149.72	156.99	6.61	355001.03	1643104.06	0.12	-	-
57	5600.00	0.74	241.23	100.00	5592.49	-149.39	156.33	5.45	355000.37	1643102.90	0.06	-	-
58	5700.00	0.64	237.05	100.00	5692.49	-149.07	155.71	4.41	354999.75	1643101.86	0.11	-	-
59	5800.00	0.70	244.26	100.00	5792.48	-148.79	155.14	3.39	354999.18	1643100.84	0.10	-	-
60	5900.00	0.92	263.03	100.00	5892.47	-148.79	154.78	2.05	354998.82	1643099.50	0.34	0.00 (W)	0.00 (N)
61	5969.00	0.80	283.80	69.00	5961.46	-149.10	154.83	1.03	354998.87	1643098.48	0.48	0.08 (E)	0.18 (N)
62	6013.00	0.70	279.10	44.00	6005.46	-149.36	154.94	0.46	354998.98	1643097.91	0.27	0.22 (E)	0.38 (N)
63	6057.00	0.40	257.60	44.00	6049.46	-149.48	154.95	0.05	354998.99	1643097.50	0.82	0.50 (E)	0.48 (N)
64	6101.00	0.40	255.90	44.00	6093.46	-149.49	154.88	-0.25	354998.92	1643097.20	0.03	0.90 (E)	0.50 (N)
65	6143.00	0.40	313.10	42.00	6135.46	-149.62	154.95	-0.50	354998.99	1643096.95	0.91	1.32 (E)	0.64 (N)
66	6187.00	4.90	150.50	44.00	6179.41	-147.93	153.42	0.31	354997.46	1643097.76	12.01	-2.08 (L)	2.11 (U)
67	6232.00	12.90	155.40	45.00	6223.83	-141.10	147.17	3.36	354991.21	1643100.81	17.84	-3.12 (L)	9.32 (U)
68	6276.00	16.80	155.40	44.00	6266.35	-129.97	136.92	8.05	354980.96	1643105.50	8.86	-3.84 (L)	21.51 (U)
69	6320.00	18.20	154.40	44.00	6308.31	-116.94	124.94	13.67	354968.98	1643111.12	3.25	-4.08 (L)	35.92 (U)
70	6362.00	17.60	159.40	42.00	6348.28	-104.16	113.08	18.74	354957.12	1643116.19	3.93	-8.29 (L)	48.73 (U)
71	6407.00	18.00	167.00	45.00	6391.13	-90.44	99.93	22.69	354943.97	1643120.14	5.24	-15.76 (L)	59.49 (U)

Environmental Protection
Department of
Mines and
Geological
Survey

OCT 07 2015

Methane Gas

#	Measured Depth (Ft)	INC Deg	AZM Deg	CL (Ft)	TVD (Ft)	VS (Ft)	NS (Ft)	EW (Ft)	Northing (US ft)	Easting (US ft)	DLS %/100 Ft	LR/EW From-Plan (Ft)	UD/NS From-Plan (Ft)
72	6451.00	21.30	165.10	44.00	6432.57	-75.65	85.58	26.28	354929.62	1643123.73	7.64	-13.96 (L)	71.05 (U)
73	6493.00	24.10	166.80	42.00	6471.31	-59.45	69.86	30.20	354913.90	1643127.65	6.85	-15.96 (L)	80.74 (U)
74	6537.00	25.20	161.20	44.00	6511.30	-41.12	52.24	35.27	354896.28	1643132.72	5.86	-8.39 (L)	90.40 (U)
75	6581.00	27.30	157.90	44.00	6550.77	-21.75	34.02	42.09	354878.06	1643139.54	5.81	-4.51 (L)	97.81 (U)
76	6626.00	28.70	156.70	45.00	6590.50	-0.80	14.53	50.24	354858.57	1643147.69	3.35	-4.33 (L)	103.32 (U)
77	6670.00	29.10	154.90	44.00	6629.02	20.20	-4.86	58.96	354839.18	1643156.41	2.18	-3.66 (L)	106.21 (U)
78	6714.00	29.80	155.70	44.00	6667.33	41.54	-24.51	68.00	354819.53	1643165.45	1.82	-7.55 (L)	106.74 (U)
79	6758.00	31.20	156.10	44.00	6705.25	63.60	-44.90	77.12	354799.14	1643174.57	3.22	-10.82 (L)	104.94 (U)
80	6803.00	33.40	157.20	45.00	6743.28	87.41	-66.97	86.64	354777.07	1643184.09	5.06	-15.05 (L)	101.35 (U)
81	6847.00	35.80	158.60	44.00	6779.50	112.21	-90.12	96.03	354753.92	1643193.48	5.75	-19.02 (L)	96.13 (U)
82	6892.00	39.60	158.80	45.00	6815.09	139.57	-115.76	106.02	354728.28	1643203.47	8.45	-20.97 (L)	90.11 (U)
83	6936.00	42.90	160.80	44.00	6848.17	168.47	-142.99	116.02	354701.05	1643213.47	8.08	-24.19 (L)	83.58 (U)
84	6981.00	45.00	162.60	45.00	6880.57	199.66	-172.64	125.82	354671.40	1643223.27	5.43	-25.64 (L)	75.99 (U)
85	7025.00	48.70	161.40	44.00	6910.66	231.71	-203.16	135.74	354640.88	1643233.19	8.64	-23.96 (L)	68.32 (U)
86	7069.00	52.40	161.90	44.00	6938.61	265.63	-235.40	146.44	354608.64	1643243.89	8.45	-23.85 (L)	60.22 (U)
87	7114.00	57.30	162.90	45.00	6964.51	302.38	-270.46	157.55	354573.58	1643255.00	11.04	-23.24 (L)	51.87 (U)
88	7156.00	63.40	163.30	42.00	6985.28	338.85	-305.37	168.15	354538.67	1643265.60	14.55	-21.68 (L)	45.59 (U)
89	7201.00	70.50	161.90	45.00	7002.89	380.20	-344.85	180.54	354499.19	1643277.99	16.03	-19.74 (L)	41.43 (U)
90	7246.00	75.90	162.10	45.00	7015.89	423.22	-385.81	193.84	354458.23	1643291.29	12.01	-18.72 (L)	39.04 (U)
91	7290.00	76.20	161.80	44.00	7026.49	465.87	-426.41	207.07	354417.63	1643304.52	0.95	-17.69 (L)	36.47 (U)
92	7335.00	76.30	161.90	45.00	7037.19	509.52	-467.95	220.69	354376.09	1643318.14	0.31	-16.71 (L)	30.83 (U)
93	7379.00	76.20	162.30	44.00	7047.65	552.22	-508.62	233.83	354335.42	1643331.28	0.91	-15.55 (L)	22.80 (U)
94	7423.00	79.90	161.80	44.00	7056.76	595.21	-549.56	247.09	354294.48	1643344.54	8.48	-14.26 (L)	13.47 (U)
95	7467.00	83.60	161.50	44.00	7063.07	638.68	-590.88	260.80	354253.16	1643358.25	8.44	-13.34 (L)	6.99 (U)
96	7512.00	84.70	162.20	45.00	7067.66	683.39	-633.42	274.74	354210.62	1643372.19	2.89	-12.27 (L)	2.37 (U)
97	7556.00	84.40	162.30	44.00	7071.84	727.15	-675.14	288.10	354168.90	1643385.55	0.72	-10.91 (L)	-1.83 (D)
98	7598.00	84.10	162.50	42.00	7076.04	768.90	-714.97	300.73	354129.07	1643398.18	0.86	-9.51 (L)	-6.06 (D)
99	7643.00	88.20	161.90	45.00	7079.06	813.75	-757.71	314.45	354086.33	1643411.90	9.21	-8.18 (L)	-9.06 (D)
100	7685.00	91.60	161.40	42.00	7079.14	855.68	-797.57	327.68	354046.47	1643425.13	8.18	-7.34 (L)	-9.13 (D)
101	7729.00	91.80	161.60	44.00	7077.83	899.59	-839.27	341.63	354004.77	1643439.08	0.64	-6.56 (L)	-7.82 (D)
102	7774.00	91.60	161.60	45.00	7076.50	944.50	-881.96	355.83	353962.08	1643453.28	0.44	-5.69 (L)	-6.49 (D)
103	7818.00	89.10	162.50	44.00	7076.23	988.45	-923.81	369.39	353920.23	1643466.84	6.04	-4.49 (L)	-6.22 (D)
104	7863.00	88.90	163.30	45.00	7077.01	1033.42	-966.81	382.62	353877.23	1643480.07	1.83	-2.59 (L)	-7.01 (D)
105	7907.00	89.00	163.40	44.00	7077.82	1077.40	-1008.96	395.22	353835.08	1643492.67	0.32	-0.40 (L)	-7.81 (D)
106	7951.00	88.80	163.10	44.00	7078.67	1121.37	-1051.09	407.90	353792.95	1643505.35	0.82	1.73 (R)	-8.66 (D)
107	7996.00	89.20	165.80	45.00	7079.45	1166.36	-1094.43	419.96	353749.61	1643517.41	6.06	4.81 (R)	-9.44 (D)
108	8040.00	92.70	168.00	44.00	7078.72	1210.31	-1137.27	429.93	353706.77	1643527.38	9.39	8.11 (R)	-8.72 (D)
109	8084.00	92.50	167.20	44.00	7076.73	1254.21	-1180.20	439.37	353663.84	1643536.82	1.87	9.91 (R)	-6.72 (D)
110	8128.00	92.10	165.80	44.00	7074.96	1298.16	-1222.95	449.63	353621.09	1643547.08	3.31	10.41 (R)	-4.95 (D)
111	8173.00	91.70	165.90	45.00	7073.47	1343.12	-1266.56	460.63	353577.48	1643558.08	0.92	10.40 (R)	-3.46 (D)
112	8217.00	89.90	165.50	44.00	7072.85	1387.11	-1309.19	471.49	353534.85	1643568.94	4.19	10.28 (R)	-2.84 (D)

Environmental Protection

Department of

OCT 07 2015

REGULATORY
Air Quality
and
Climate
Change
Division

#	Measured Depth (Ft)	INC Deg	AZM Deg	CL (Ft)	TVD (Ft)	VS (Ft)	NS (Ft)	EW (Ft)	Northing (US ft)	Easting (US ft)	DLS %/100 Ft	LR/EW From-Plan (Ft)	UD/NS From-Plan (Ft)
113	8261.00	89.80	165.50	44.00	7072.97	1431.11	-1351.79	482.51	353492.25	1643579.96	0.23	10.00 (R)	-2.96 (D)
114	8306.00	89.80	165.20	45.00	7073.13	1476.11	-1395.32	493.89	353448.72	1643591.34	0.67	9.60 (R)	-3.12 (D)
115	8350.00	89.40	164.80	44.00	7073.43	1520.10	-1437.82	505.28	353406.22	1643602.73	1.29	8.94 (R)	-3.42 (D)
116	8395.00	89.00	165.10	45.00	7074.06	1565.10	-1481.27	516.96	353362.77	1643614.41	1.11	8.22 (R)	-4.05 (D)
117	8439.00	88.90	165.20	44.00	7074.87	1609.09	-1523.80	528.24	353320.24	1643625.69	0.32	7.67 (R)	-4.86 (D)
118	8483.00	89.20	165.20	44.00	7075.60	1653.08	-1566.33	539.47	353277.71	1643636.92	0.68	7.17 (R)	-5.59 (D)
119	8527.00	90.50	165.80	44.00	7075.71	1697.08	-1608.93	550.49	353235.11	1643647.94	3.25	6.89 (R)	-5.70 (D)
120	8572.00	90.50	165.80	45.00	7075.32	1742.07	-1652.55	561.53	353191.49	1643658.98	0.00	6.84 (R)	-5.31 (D)
121	8616.00	90.20	165.90	44.00	7075.05	1786.06	-1695.22	572.29	353148.82	1643669.74	0.72	6.83 (R)	-5.04 (D)
122	8660.00	90.40	166.60	44.00	7074.82	1830.04	-1737.95	582.74	353106.09	1643680.19	1.65	7.13 (R)	-4.81 (D)
123	8705.00	90.90	166.80	45.00	7074.31	1875.01	-1781.74	593.10	353062.30	1643690.55	1.20	7.79 (R)	-4.30 (D)
124	8749.00	89.80	166.90	44.00	7074.04	1918.98	-1824.59	603.10	353019.45	1643700.55	2.51	8.55 (R)	-4.03 (D)
125	8794.00	89.40	166.60	45.00	7074.36	1963.95	-1868.39	613.42	352975.65	1643710.87	1.11	9.25 (R)	-4.35 (D)
126	8838.00	89.30	166.80	44.00	7074.85	2007.93	-1911.21	623.54	352932.83	1643720.99	0.51	9.89 (R)	-4.85 (D)
127	8883.00	89.30	166.90	45.00	7075.40	2052.89	-1955.02	633.78	352889.02	1643731.23	0.22	10.67 (R)	-5.40 (D)
128	8927.00	89.40	166.80	44.00	7075.90	2096.86	-1997.87	643.79	352846.17	1643741.24	0.32	11.43 (R)	-5.90 (D)
129	8969.00	89.20	166.50	42.00	7076.42	2138.83	-2038.73	653.48	352805.31	1643750.93	0.86	12.01 (R)	-6.41 (D)
130	9014.00	89.30	166.20	45.00	7077.01	2183.81	-2082.45	664.10	352761.59	1643761.55	0.70	12.39 (R)	-7.00 (D)
131	9058.00	88.70	166.10	44.00	7077.77	2227.79	-2125.17	674.63	352718.87	1643772.08	1.38	12.61 (R)	-7.77 (D)
132	9103.00	89.10	167.40	45.00	7078.64	2272.75	-2168.96	684.95	352675.08	1643782.40	3.02	13.32 (R)	-8.63 (D)
133	9147.00	89.30	166.60	44.00	7079.25	2316.72	-2211.83	694.84	352632.21	1643792.29	1.87	14.19 (R)	-9.24 (D)
134	9192.00	89.50	164.00	45.00	7079.72	2361.71	-2255.35	706.26	352588.69	1643803.71	5.79	13.75 (R)	-9.71 (D)
135	9236.00	88.70	162.10	44.00	7080.41	2405.68	-2297.43	719.08	352546.61	1643816.53	4.68	11.59 (R)	-10.41 (D)
136	9280.00	90.20	161.90	44.00	7080.84	2449.63	-2339.27	732.68	352504.77	1643830.13	3.44	8.65 (R)	-10.83 (D)
137	9324.00	89.90	162.30	44.00	7080.80	2493.58	-2381.14	746.20	352462.90	1643843.65	1.14	5.75 (R)	-10.79 (D)
138	9369.00	89.80	161.60	45.00	7080.92	2538.53	-2423.93	760.15	352420.11	1643857.60	1.57	2.67 (R)	-10.91 (D)
139	9413.00	90.60	163.20	44.00	7080.76	2582.49	-2465.87	773.45	352378.17	1643870.90	4.07	0.02 (R)	-10.75 (D)
140	9458.00	90.60	163.30	45.00	7080.29	2627.47	-2508.96	786.42	352335.08	1643883.87	0.22	-2.04 (L)	-10.28 (D)
141	9502.00	90.20	162.90	44.00	7079.98	2671.45	-2551.05	799.21	352292.99	1643896.66	1.29	-4.16 (L)	-9.98 (D)
142	9547.00	89.80	162.70	45.00	7079.98	2716.42	-2594.04	812.52	352250.00	1643909.97	0.99	-6.57 (L)	-9.98 (D)
143	9591.00	89.50	165.50	44.00	7080.25	2760.41	-2636.35	824.57	352207.69	1643922.02	6.40	-7.92 (L)	-10.24 (D)
144	9633.00	89.20	165.20	42.00	7080.73	2802.41	-2676.99	835.19	352167.05	1643932.64	1.01	-8.29 (L)	-10.72 (D)
145	9676.00	90.20	166.60	43.00	7080.95	2845.40	-2718.69	845.67	352125.35	1643943.12	4.00	-8.26 (L)	-10.95 (D)
146	9720.00	89.70	166.00	44.00	7080.99	2889.38	-2761.44	856.09	352082.60	1643953.54	1.78	-7.92 (L)	-10.98 (D)
147	9764.00	91.00	165.60	44.00	7080.72	2933.37	-2804.09	866.88	352039.95	1643964.33	3.09	-7.97 (L)	-10.72 (D)
148	9809.00	90.80	165.20	45.00	7080.02	2978.36	-2847.63	878.22	351996.41	1643975.67	0.99	-8.33 (L)	-10.01 (D)
149	9853.00	90.00	165.20	44.00	7079.71	3022.36	-2890.17	889.46	351953.87	1643986.91	1.82	-8.84 (L)	-9.70 (D)
150	9897.00	89.30	164.40	44.00	7079.98	3066.36	-2932.63	901.00	351911.41	1643998.45	2.42	-9.66 (L)	-9.97 (D)
151	9942.00	89.30	164.60	45.00	7080.53	3111.36	-2975.99	913.02	351868.05	1644010.47	0.44	-10.73 (L)	-10.52 (D)
152	9986.00	90.90	164.80	44.00	7080.45	3155.35	-3018.43	924.63	351825.61	1644022.08	3.66	-11.61 (L)	-10.44 (D)
153	10031.00	90.30	163.50	45.00	7079.98	3200.35	-3061.71	936.92	351782.33	1644034.37	3.18	-12.97 (L)	-9.97 (D)

Environmental Protection

OCT 07 2015

Department of Natural Resources

#	Measured Depth (Ft)	INC Deg	AZM Deg	CL (Ft)	TVD (Ft)	VS (Ft)	NS (Ft)	EW (Ft)	Northing (US ft)	Easting (US ft)	DLS ² /100 Ft	LR/EW From-Plan (Ft)	UD/NS From-Plan (Ft)
154	10075.00	90.60	164.00	44.00	7079.63	3244.34	-3103.95	949.23	351740.09	1644046.68	1.33	-14.58 (L)	-9.63 (D)
155	10119.00	90.40	163.90	44.00	7079.25	3288.33	-3146.24	961.40	351697.80	1644058.85	0.51	-16.05 (L)	-9.24 (D)
156	10164.00	89.90	163.80	45.00	7079.13	3333.33	-3189.46	973.91	351654.58	1644071.36	1.13	-17.64 (L)	-9.12 (D)
157	10208.00	89.60	163.30	44.00	7079.32	3377.32	-3231.66	986.37	351612.38	1644083.82	1.33	-19.42 (L)	-9.32 (D)
158	10250.00	89.20	163.20	42.00	7079.76	3419.30	-3271.88	998.48	351572.16	1644095.93	0.98	-21.34 (L)	-9.76 (D)
159	10292.00	89.80	164.50	42.00	7080.13	3461.29	-3312.22	1010.16	351531.82	1644107.61	3.41	-22.80 (L)	-10.12 (D)
160	10337.00	89.80	165.10	45.00	7080.29	3506.29	-3355.64	1021.96	351488.40	1644119.41	1.33	-23.62 (L)	-10.28 (D)
161	10381.00	89.80	165.80	44.00	7080.44	3550.29	-3398.23	1033.01	351445.81	1644130.46	1.59	-23.94 (L)	-10.43 (D)
162	10425.00	89.50	165.00	44.00	7080.71	3594.29	-3440.81	1044.10	351403.23	1644141.55	1.94	-24.30 (L)	-10.70 (D)
163	10470.00	89.60	165.20	45.00	7081.06	3639.28	-3484.29	1055.67	351359.75	1644153.12	0.50	-24.89 (L)	-11.06 (D)
164	10514.00	92.00	165.90	44.00	7080.45	3683.27	-3526.89	1066.65	351317.15	1644164.10	5.68	-25.13 (L)	-10.45 (D)
165	10556.00	92.40	165.90	42.00	7078.84	3725.23	-3567.60	1076.87	351276.44	1644174.32	0.95	-25.10 (L)	-8.84 (D)
166	10600.00	92.40	165.50	44.00	7077.00	3769.19	-3610.20	1087.73	351233.84	1644185.18	0.91	-25.22 (L)	-6.99 (D)
167	10645.00	91.50	164.40	45.00	7075.46	3814.16	-3653.63	1099.41	351190.41	1644196.86	3.16	-25.94 (L)	-5.46 (D)
168	10689.00	91.80	164.70	44.00	7074.20	3858.14	-3696.02	1111.13	351148.02	1644208.58	0.96	-26.95 (L)	-4.19 (D)
169	10733.00	92.40	165.30	44.00	7072.58	3902.11	-3738.49	1122.51	351105.55	1644219.96	1.93	-27.61 (L)	-2.58 (D)
170	10781.00	91.50	167.80	48.00	7070.95	3950.05	-3785.14	1133.66	351058.90	1644231.11	5.53	-27.05 (L)	-0.94 (D)
171	10823.00	90.90	168.60	42.00	7070.07	3991.97	-3826.25	1142.25	351017.79	1644239.70	2.38	-25.34 (L)	-0.06 (D)
172	10867.00	90.90	168.70	44.00	7069.38	4035.86	-3869.38	1150.91	350974.66	1644248.36	0.23	-23.20 (L)	0.63 (U)
173	10911.00	89.30	169.20	44.00	7069.30	4079.74	-3912.56	1159.34	350931.48	1644256.79	3.81	-20.84 (L)	0.71 (U)
174	10955.00	89.50	170.90	44.00	7069.76	4123.55	-3955.90	1166.94	350888.14	1644264.39	3.89	-17.66 (L)	0.25 (U)
175	11000.00	89.80	171.10	45.00	7070.04	4168.28	-4000.34	1173.98	350843.70	1644271.43	0.80	-13.62 (L)	-0.03 (D)
176	11044.00	89.80	168.10	44.00	7070.19	4212.12	-4043.61	1181.93	350800.43	1644279.38	6.82	-10.70 (L)	-0.18 (D)
177	11088.00	89.40	166.50	44.00	7070.50	4256.07	-4086.54	1191.60	350757.50	1644289.05	3.75	-9.59 (L)	-0.49 (D)
178	11133.00	87.50	166.10	45.00	7071.72	4301.04	-4130.24	1202.25	350713.80	1644299.70	4.31	-9.24 (L)	-1.71 (D)
179	11177.00	86.60	165.90	44.00	7073.98	4344.97	-4172.87	1212.88	350671.17	1644310.33	2.10	-9.13 (L)	-3.98 (D)
180	11221.00	90.00	166.60	44.00	7075.29	4388.92	-4215.59	1223.33	350628.45	1644320.78	7.89	-8.84 (L)	-5.28 (D)
181	11266.00	90.70	170.20	45.00	7075.01	4433.82	-4259.66	1232.38	350584.38	1644329.83	8.15	-6.87 (L)	-5.00 (D)
182	11310.00	90.70	170.20	44.00	7074.47	4477.62	-4303.01	1239.87	350541.03	1644337.32	0.00	-3.53 (L)	-4.47 (D)
183	11354.00	89.20	168.00	44.00	7074.51	4521.49	-4346.22	1248.19	350497.82	1644345.64	6.05	-1.03 (L)	-4.50 (D)
184	11399.00	88.80	167.10	45.00	7075.30	4566.43	-4390.15	1257.89	350453.89	1644355.34	2.19	0.30 (R)	-5.29 (D)
185	11443.00	88.40	166.70	44.00	7076.37	4610.39	-4432.99	1267.86	350411.05	1644365.31	1.29	1.10 (R)	-6.37 (D)
186	11486.00	90.30	166.10	43.00	7076.86	4653.36	-4474.78	1277.97	350369.26	1644375.42	4.63	1.50 (R)	-6.85 (D)
187	11530.00	89.70	164.80	44.00	7076.86	4697.36	-4517.37	1289.02	350326.67	1644386.47	3.25	1.18 (R)	-6.85 (D)
188	11575.00	89.20	163.70	45.00	7077.29	4742.35	-4560.68	1301.24	350283.36	1644398.69	2.69	-0.09 (L)	-7.28 (D)
189	11620.00	89.70	163.00	45.00	7077.72	4787.34	-4603.79	1314.13	350240.25	1644411.58	1.91	-2.06 (L)	-7.72 (D)
190	11664.00	89.20	163.00	44.00	7078.15	4831.32	-4645.86	1326.99	350198.18	1644424.44	1.14	-4.26 (L)	-8.14 (D)
191	11709.00	88.80	162.00	45.00	7078.93	4876.27	-4688.77	1340.52	350155.27	1644437.97	2.39	-6.92 (L)	-8.93 (D)
192	11753.00	90.10	162.80	44.00	7079.35	4920.23	-4730.71	1353.82	350113.33	1644451.27	3.47	-9.56 (L)	-9.35 (D)
193	11798.00	89.70	161.80	45.00	7079.43	4965.19	-4773.58	1367.51	350070.46	1644464.96	2.39	-12.37 (L)	-9.42 (D)
194	11842.00	90.00	163.40	44.00	7079.55	5009.16	-4815.57	1380.66	350028.47	1644478.11	3.70	-14.86 (L)	-9.54 (D)

Environmental Protection

RECEIVED
 OCT 07 2015
 Environmental Protection
 Department of
 Natural Resources

#	Measured Depth (Ft)	INC Deg	AZIM Deg	CL (Ft)	TVD (Ft)	VS (Ft)	NS (Ft)	EW (Ft)	Northing (US ft)	Easting (US ft)	DLS %/100 Ft	LR/EW From-Plan (Ft)	UD/NS From-Plan (Ft)
195	11886.00	90.20	163.00	44.00	7079.47	5053.14	-4857.69	1393.38	349986.35	1644490.83	1.02	-16.90 (L)	-9.46 (D)
196	11931.00	92.00	165.10	45.00	7078.61	5098.13	-4900.94	1405.74	349943.10	1644503.19	6.15	-18.30 (L)	-8.60 (D)
197	11976.00	92.10	164.50	45.00	7077.00	5143.10	-4944.34	1417.53	349899.70	1644514.98	1.35	-19.14 (L)	-6.99 (D)
198	12020.00	92.00	165.20	44.00	7075.42	5187.07	-4986.78	1429.03	349857.26	1644526.48	1.61	-19.92 (L)	-5.42 (D)
199	12064.00	91.70	164.70	44.00	7074.00	5231.05	-5029.25	1440.45	349814.79	1644537.90	1.32	-20.62 (L)	-4.00 (D)
200	12109.00	91.50	164.60	45.00	7072.75	5276.03	-5072.63	1452.35	349771.41	1644549.80	0.50	-21.57 (L)	-2.74 (D)
201	12153.00	91.10	164.20	44.00	7071.75	5320.02	-5115.00	1464.18	349729.04	1644561.63	1.29	-22.70 (L)	-1.74 (D)
202	12198.00	89.60	166.60	45.00	7071.47	5365.01	-5158.54	1475.52	349685.50	1644572.97	6.29	-23.05 (L)	-1.46 (D)
203	12240.00	89.30	166.50	42.00	7071.88	5406.98	-5199.39	1485.29	349644.65	1644582.74	0.75	-22.55 (L)	-1.87 (D)
204	12285.00	88.70	167.20	45.00	7072.66	5451.95	-5243.20	1495.53	349600.84	1644592.98	2.05	-21.77 (L)	-2.65 (D)
205	12329.00	88.60	166.80	44.00	7073.70	5495.90	-5286.06	1505.42	349557.98	1644602.87	0.94	-20.90 (L)	-3.69 (D)
206	12373.00	88.00	166.90	44.00	7075.00	5539.85	-5328.89	1515.43	349515.15	1644612.88	1.38	-20.14 (L)	-5.00 (D)
207	12418.00	87.60	166.20	45.00	7076.73	5584.80	-5372.62	1525.89	349471.42	1644623.34	1.79	-19.59 (L)	-6.73 (D)
208	12459.00	89.80	167.70	41.00	7077.66	5625.75	-5412.55	1535.14	349431.49	1644632.59	6.49	-18.82 (L)	-7.65 (D)
209	12504.00	89.80	167.60	45.00	7077.82	5670.69	-5456.51	1544.77	349387.53	1644642.22	0.22	-17.42 (L)	-7.81 (D)
210	12549.00	89.80	168.40	45.00	7077.98	5715.62	-5500.52	1554.12	349343.52	1644651.57	1.78	-15.75 (L)	-7.97 (D)
211	12592.00	90.20	168.50	43.00	7077.98	5758.53	-5542.65	1562.73	349301.39	1644660.18	0.96	-13.81 (L)	-7.97 (D)
212	12636.00	90.10	168.60	44.00	7077.86	5802.43	-5585.77	1571.47	349258.27	1644668.92	0.32	-11.74 (L)	-7.85 (D)
213	12680.00	90.00	168.80	44.00	7077.82	5846.33	-5628.92	1580.09	349215.12	1644677.54	0.51	-9.56 (L)	-7.81 (D)
214	12725.00	90.60	169.50	45.00	7077.59	5891.19	-5673.12	1588.56	349170.92	1644686.01	2.05	-6.98 (L)	-7.58 (D)
215	12769.00	91.10	168.10	44.00	7076.93	5935.08	-5716.27	1597.10	349127.77	1644694.55	3.38	-4.72 (L)	-6.93 (D)
216	12814.00	90.50	168.10	45.00	7076.31	5980.00	-5760.30	1606.38	349083.74	1644703.83	1.33	-2.96 (L)	-6.30 (D)
217	12858.00	91.00	166.10	44.00	7075.73	6023.95	-5803.18	1616.20	349040.86	1644713.65	4.68	-2.00 (L)	-5.72 (D)
218	12902.00	91.10	165.90	44.00	7074.92	6067.93	-5845.87	1626.85	348998.17	1644724.30	0.51	-1.89 (L)	-4.92 (D)
219	12945.00	89.20	166.90	43.00	7074.81	6110.91	-5887.66	1636.96	348956.38	1644734.41	4.99	-1.49 (L)	-4.80 (D)
220	12987.00	89.00	166.60	42.00	7075.47	6152.88	-5928.54	1646.58	348915.50	1644744.03	0.86	-0.84 (L)	-5.46 (D)
221	13032.00	88.70	167.10	45.00	7076.37	6197.84	-5972.35	1656.82	348871.69	1644754.27	1.30	-0.06 (L)	-6.37 (D)
222	13074.00	88.80	167.70	42.00	7077.29	6239.79	-6013.33	1665.98	348830.71	1644763.43	1.45	1.07 (R)	-7.28 (D)
223	13118.00	89.40	166.00	44.00	7077.98	6283.75	-6056.17	1675.99	348787.87	1644773.44	4.10	1.83 (R)	-7.97 (D)
224	13163.00	89.50	165.60	45.00	7078.41	6328.74	-6099.79	1687.02	348744.25	1644784.47	0.92	1.78 (R)	-8.40 (D)
225	13205.00	89.20	165.40	42.00	7078.89	6370.74	-6140.45	1697.54	348703.59	1644794.99	0.86	1.51 (R)	-8.88 (D)
226	13247.00	89.10	165.10	42.00	7079.51	6412.73	-6181.06	1708.23	348662.98	1644805.68	0.75	1.06 (R)	-9.50 (D)
227	13291.00	90.20	167.80	44.00	7079.78	6456.70	-6223.83	1718.54	348620.21	1644815.99	6.63	1.52 (R)	-9.77 (D)
228	13336.00	90.10	169.70	45.00	7079.66	6501.59	-6267.96	1727.32	348576.08	1644824.77	4.23	3.79 (R)	-9.65 (D)
229	13380.00	90.00	171.80	44.00	7079.63	6545.35	-6311.39	1734.39	348532.65	1644831.84	4.78	7.58 (R)	-9.62 (D)
230	13425.00	89.60	172.40	45.00	7079.78	6589.98	-6355.96	1740.58	348488.08	1644838.03	1.60	12.51 (R)	-9.77 (D)
231	13469.00	89.20	169.70	44.00	7080.24	6633.70	-6399.42	1747.42	348444.62	1644844.87	6.20	16.45 (R)	-10.24 (D)
232	13513.00	88.40	168.10	44.00	7081.16	6677.58	-6442.59	1755.89	348401.45	1644853.34	4.06	18.76 (R)	-11.16 (D)
233	13558.00	88.30	168.70	45.00	7082.46	6722.47	-6486.65	1764.93	348357.39	1644862.38	1.35	20.77 (R)	-12.46 (D)
234	13602.00	90.20	166.80	44.00	7083.04	6766.40	-6529.64	1774.27	348314.40	1644871.72	6.11	22.18 (R)	-13.03 (D)
235	13647.00	92.40	166.20	45.00	7082.02	6811.36	-6573.38	1784.77	348270.66	1644882.22	5.07	22.68 (R)	-12.02 (D)

Environmental Protection

Department of

OCT 07 2015

RD
Grumpy 3
Well Path

#	Measured Depth (Ft)	INC Deg	AZM Deg	CL (Ft)	TVD (Ft)	VS (Ft)	NS (Ft)	EW (Ft)	Northing (US ft)	Easting (US ft)	DLS %/100 Ft	LR/EW From-Plan (Ft)	UD/NS From-Plan (Ft)
236	13691.00	92.40	166.20	44.00	7080.17	6855.31	-6616.07	1795.25	348227.97	1644892.70	0.00	22.94 (R)	-10.17 (D)
237	13736.00	92.60	165.70	45.00	7078.21	6900.26	-6659.69	1806.17	348184.35	1644903.62	1.20	23.01 (R)	-8.21 (D)
238	13780.00	92.40	165.80	44.00	7076.29	6944.21	-6702.29	1816.99	348141.75	1644914.44	0.51	22.92 (R)	-6.29 (D)
239	13824.00	90.90	166.70	44.00	7075.02	6988.17	-6745.01	1827.44	348099.03	1644924.89	3.98	23.22 (R)	-5.02 (D)
240	13868.00	90.80	166.70	44.00	7074.37	7032.14	-6787.83	1837.56	348056.21	1644935.01	0.23	23.87 (R)	-4.36 (D)
241	13913.00	90.40	166.30	45.00	7073.90	7077.12	-6831.58	1848.07	348012.46	1644945.52	1.26	24.37 (R)	-3.89 (D)
242	13957.00	89.50	165.50	44.00	7073.94	7121.11	-6874.25	1858.79	347969.79	1644956.24	2.74	24.40 (R)	-3.93 (D)
243	14002.00	89.30	165.10	45.00	7074.41	7166.11	-6917.78	1870.21	347926.26	1644967.66	0.99	23.96 (R)	-4.40 (D)
244	14089.00	90.50	166.00	87.00	7074.56	7253.09	-7002.02	1891.91	347842.02	1644989.36	1.72	23.48 (R)	-4.55 (D)
245	14133.00	90.30	165.90	44.00	7074.25	7297.08	-7044.71	1902.60	347799.33	1645000.05	0.51	23.55 (R)	-4.24 (D)
246	14175.00	90.20	165.50	42.00	7074.07	7339.08	-7085.40	1912.97	347758.64	1645010.42	0.98	23.44 (R)	-4.06 (D)
247	14220.00	90.80	166.10	45.00	7073.68	7384.07	-7129.03	1924.01	347715.01	1645021.46	1.89	23.39 (R)	-3.67 (D)
248	14265.00	90.90	167.30	45.00	7073.01	7429.04	-7172.81	1934.36	347671.23	1645031.81	2.68	24.05 (R)	-3.00 (D)
249	14309.00	90.90	167.70	44.00	7072.32	7472.98	-7215.77	1943.88	347628.27	1645041.33	0.91	25.32 (R)	-2.31 (D)
250	14354.00	90.40	167.30	45.00	7071.81	7517.92	-7259.70	1953.62	347584.34	1645051.07	1.42	26.60 (R)	-1.80 (D)

Proj to Bit	251	14425.00	90.40	167.30	71.00	7071.31	7588.85	-7328.96	1969.23	347515.08	1645066.68	0.00	-	-
--------------------	-----	----------	-------	--------	-------	---------	---------	----------	---------	-----------	------------	------	---	---

GEODETTIC INFORMATION

Latitude: 39°28'2.5000" N Dec. Latitude: 39.46736110 Longitude: -80°45'51.2000" W Dec. Longitude: -80.76422222 Geodetic Group: US State Plane 1927 (Exact solution)	Geodetic Zone: West Virginia North 4701 Geodetic Datum: NAD27 Easting: 1643097.45 Northing: 354844.04 Convergence: -0.81
--	---

MAGNETICS INFORMATION

Magnetic Model: C:\HawkEye\IGRF2010.MIF Date for Magnetics: 11/12/2014 Latitude: 39°28'2.5000" N Longitude: -80°45'51.2000" W Magnetic Declination: -8.53 Total Correction(Mag to Grid): -7.73	Field Strength (nt): 52336 B-X Component (nt): 20298 B-Y Component (nt): -3045 B-Z Component (nt): 48144 B-Horz Component (nt): 20525 Dip Angle: 66.91
---	---

TARGET DATA

Name	Shape	Easting (Ft)	Northing (Ft)	Subsea (Ft)	TVD (Ft)	NS (Ft)	EW (Ft)	Side A (Ft)	Side B (Ft)	Diameter (Ft)
Grumpy 3 VSP=165.23 / 7464.24	POINT	1645054.1	356955.4	-1314.0	0.0	2111.3	1956.6	-	-	-
Grumpy 3 KOP Gyro	POINT	1642944.0	354828.9	-1314.0	0.0	-15.1	-153.4	-	-	-
Grumpy 3 PT	POINT	1643521.4	353752.8	5756.0	7070.0	-1091.2	423.9	-	-	-
Grumpy 3 TD	POINT	1644999.9	347626.3	5756.0	7070.0	-7217.7	1902.5	-	-	-
Grumpy 3 TD #2	POINT	1645093.9	347523.0	5756.0	7070.0	-7321.0	1996.5	-	-	-

Environmental Protection
Department of

RECEIVED
Office of Oil and Gas
11/15

LEASE LINE DATA

#	X Point (Ft)	Y Point (Ft)	Direction (Deg)	Quad	Deg	Min	Sec	Distance (Ft)	Easting (Ft)	Northing (Ft)	Latitude (Deg)	Longitude (Deg)
Name: Lease Lines (Top)												
0	465.0	153.9	246.43945111	3	66	26	22.0240	542.9	1643519.0	355109.2	39.46810543	-80.76274233
1	-32.7	-63.1	245.50020673	3	65	30	0.7442	216.5	1643021.4	354892.2	39.46749046	-80.76449407
2	-229.7	-152.9	238.34440844	3	58	20	39.8704	1723.4	1642824.3	354802.4	39.46723631	-80.76518750
3	-1696.8	-1057.4	336.96655095	4	23	2	0.4166	3109.7	1641357.3	353898.0	39.46469643	-80.77033798
4	-2913.5	1804.4	337.88322037	4	22	7	0.4067	3249.2	1640140.6	356759.7	39.47250551	-80.77479098
5	-4136.8	4814.5	43.05633290	1	43	3	22.7985	198.3	1638917.3	359769.9	39.48072136	-80.77927576
6	-4001.4	4959.4	88.51199044	1	88	30	43.1656	1047.5	1639052.6	359914.7	39.48112436	-80.77880357
7	-2954.3	4986.6	7.45355547	1	7	27	12.7997	707.1	1640099.7	359941.9	39.48123990	-80.77509566
8	-2862.6	5687.7	78.82304134	1	78	49	22.9488	1485.6	1640191.5	360643.1	39.48316832	-80.77480596
9	-1405.2	5975.7	162.19391611	2	17	48	21.9020	6122.0	1641648.8	360931.0	39.48401551	-80.76965755
10	466.8	147.0	344.72386561	4	15	16	34.0838	7.2	1643520.9	355102.3	39.46808650	-80.76273529
11	465.0	153.9	246.43945111	3	66	26	22.0240	0.0	1643519.0	355109.2	39.46810543	-80.76274233
Name: Lease Lines (Bot)												
0	-718.6	-5643.1	114.32849853	2	65	40	17.4053	1590.2	1642335.5	349312.3	39.45214545	-80.76664466
1	730.5	-6298.2	112.73848306	2	67	15	41.4610	266.0	1643784.5	348657.2	39.45040291	-80.76148112
2	975.8	-6401.0	95.63100928	2	84	22	8.3666	147.6	1644029.9	348554.3	39.45013007	-80.76060722
3	1122.7	-6415.5	178.64602971	2	1	21	14.2930	75.3	1644176.7	348539.9	39.45009597	-80.76008649
4	1124.5	-6490.8	135.64450507	2	44	21	19.7817	1174.9	1644178.5	348464.6	39.44988929	-80.76007645
5	1945.8	-7330.9	127.79207521	2	52	12	28.5292	2107.4	1644999.9	347624.5	39.44761465	-80.75712643
6	3611.2	-8622.3	356.23296571	4	3	46	1.3235	393.8	1646665.3	346333.0	39.44413310	-80.75116603
7	3585.4	-8229.4	358.42611118	4	1	34	25.9998	616.0	1646639.4	346726.0	39.44521077	-80.75127700
8	3568.4	-7613.6	5.04394343	1	5	2	38.1963	641.2	1646622.5	347341.8	39.44690067	-80.75136728
9	3624.8	-6974.9	342.86479019	4	17	8	6.7553	295.7	1646678.9	347980.4	39.44865616	-80.75119919
10	3537.7	-6692.4	342.74113747	4	17	15	31.9051	1910.4	1646591.7	348263.0	39.44942857	-80.75152160
11	2970.9	-4867.9	343.00497470	4	16	59	42.0911	1677.1	1646024.9	350087.4	39.45441546	-80.75361873
12	2480.7	-3264.1	342.73871814	4	17	15	40.6147	568.3	1645534.7	351691.3	39.45879975	-80.75543394
13	2312.0	-2721.4	342.93749973	4	17	3	45.0010	2051.3	1645366.1	352234.0	39.46028314	-80.75605799
14	1710.2	-760.3	343.04276228	4	16	57	26.0558	1100.8	1644764.2	354195.0	39.46564363	-80.75828679
15	1389.1	292.6	252.72607524	3	72	43	33.8709	505.7	1644443.2	355248.0	39.46852192	-80.75947615
16	906.2	142.5	256.18063348	3	76	10	50.2805	903.5	1643960.3	355097.8	39.46809112	-80.76117885
17	28.9	-73.3	252.89602589	3	72	53	45.6932	270.7	1643083.0	354882.0	39.46746484	-80.76427529
18	-229.7	-152.9	238.34440844	3	58	20	39.8704	1723.4	1642824.3	354802.4	39.46723631	-80.76518750
19	-1696.8	-1057.4	177.87760360	2	2	7	20.6270	1109.2	1641357.3	353898.0	39.46469643	-80.77033798
20	-1655.7	-2165.9	206.32091618	3	26	19	15.2982	84.0	1641398.4	352789.5	39.46165494	-80.77013698
21	-1692.9	-2241.1	145.62914155	2	34	22	15.0904	493.2	1641361.2	352714.2	39.46144688	-80.77026506
22	-1414.5	-2648.3	190.10091841	3	10	6	3.3063	341.8	1641639.6	352307.1	39.46034006	-80.76925858
23	-1474.4	-2984.7	164.35046945	2	15	38	58.3100	1336.2	1641579.7	351970.6	39.45941403	-80.76945401
24	-1114.0	-4271.3	163.92058203	2	16	4	45.9047	1427.6	1641940.1	350684.0	39.45589587	-80.76811329
25	-718.6	-5643.1	114.32849853	2	65	40	17.4053	0.0	1642335.5	349312.3	39.45214545	-80.76664466

RECEIVED
 Office of Oil and Gas
 OCT 07 2016
 Environmental Protection Department of