

1736.4' LATITUDE 39° 32' 30"

MINERAL OWNERSHIP

UNIT 1 MARY MAXINE WELCH 2-17-42 69.5 AC
UNIT 2 ALLEN SMITH ET. AL. TM 2-17-14 3, 14, 4, 14, 9, 15, P/O 2-12-26, 71.75 AC
UNIT 3 JON AND MARY BLOD ET. AL. TM 2-17-40, P/O 2-17-19, 147 AC
UNIT 4 DEX USA, INC. ET. AL. TM 2-17-12, 14, 14, 1, 14, 2, 14, 5, 14, 6, 14, 7, 14, 8, 14, 10, P/O 2-17-19, 93.5 AC
UNIT 5 SHIBEN ESTATES, INC. TM 2-12-27, 28, 29 & 2-17-18 1, 69.5 AC
UNIT 6 FLOYD E. LEWIS/LIFE ET. AL. TM P/O 2-17-18, 60 AC
UNIT 7 S.A. SMITH & C. BURKE MORRIS TRUST ET. AL. TM 2-17-41, 40.5 AC
UNIT 8 JOSEPHINE CORRELL ET. AL. TM 2-18-11, 33.25 AC
UNIT 9 DEX USA, INC. ET. AL. TM 2-17-17, 30.21 AC
UNIT 10 CECIL AND MARGARET LANCASTER TM 2-12-25, 78.17 AC
UNIT 11 GLADYS MAYFIELD BOYD, ET. AL. P/O TM 2-12-26 24.08 AC

LEGEND

- ⊕ TOPD MAP POINT
- ⊗ EXISTING WELLS
- PRE-29 WELLS
- PLUGGED WELL
- MINERAL TRACT
- PARCEL LINES
- AS-DRILLED
- - - PROPOSED WELL
- ROAD
- ~ STREAM

SURFACE LOC.

UTM 17-NAD 83 METERS

N: 4372954.19'
E: 520978.32'

NAD 83

LAT: 39.50595840
LON: -80.75598584

LANDING POINT LOC.

UTM 17-NAD 83 METERS

N: 4373166.60'
E: 520517.16'

NAD 83

LAT: 39.50788340
LON: -80.76134330

BOTTOM HOLE LOC.

UTM 17-NAD 83 METERS

N: 4375197.59'
E: 519928.46'

NAD 83

LAT: 39.52619748
LON: -80.76813022

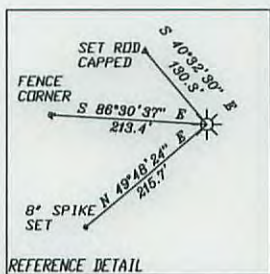

NOTES:

1. THERE ARE NO WATER WELLS OR DEVELOPED SPRINGS WITHIN 250' OF PROPOSED WELL.
2. THERE ARE NO EXISTING BUILDINGS WITHIN 625' OF PROPOSED WELL.
3. PROPOSED WELL IS GREATER THAN 100' FROM PERENNIAL STREAM, WETLAND, POND, RESERVOIR, OR LAKE.
4. THERE ARE NO NATIVE TROUT STREAMS WITHIN 300' OF PROPOSED WELL.
5. PROPOSED WELL IS GREATER THAN 1000' FROM SURFACE/GROUNDWATER INTAKE OR PUBLIC WATER SUPPLY.
6. IT IS NOT THE INTENTION OF THIS PLAN TO REPRESENT SURVEYED LOCATIONS OF THE SURFACE OR MINERAL PARCELS DEPICTED HEREON. THE LOCATION OF THE BOUNDARY LINES, AS SHOWN, ARE BASED ON RECORD DEED DESCRIPTIONS, FIELD EVIDENCE FOUND, AND/OR TAX MAP POSITION, UNLESS OTHERWISE NOTED.



11283 Emerson Avenue Phone: (304) 464-5305
Parkersburg, West Virginia 26104 Fax: (304) 464-4428

FILE#: 2146001
DRAWING#: 2146001-STA-BALL. DWG
SCALE: 1"=1500'
ACCURACY: 1/2500
ELEVATION: OPUS SOL. NAVD 88
DATE: 10/23/15

I, THE UNDERSIGNED, HEREBY CERTIFY THAT THIS PLAN IS CORRECT TO THE BEST OF MY KNOWLEDGE AND BELIEF AND SHOWS ALL THE INFORMATION REQUIRED BY LAW AND THE RULES ISSUED AND PRESCRIBED BY THE DEPARTMENT OF ENVIRONMENTAL PROTECTION.
SIGNED: *[Signature]* PS# 2141



WELL TYPE: OIL WASTE DISPOSAL PRODUCTION DEEP OPERATOR'S WELL# : BALL 9H
 GAS LIQUID INJECTION STORAGE SHALLOW API WELL#: 47 095 02177
STATE COUNTY PERMIT

WATERSHED: ELK FORK COUNTY/DISTRICT: TYLER/ELLSWORTH QUADRANGLE: PORTLAND
SURFACE OWNER: ROBERT D. BALL & SHERRY A. BALL ET. AL. ACREAGE: 69.5±
OIL & GAS ROYALTY OWNER: MARY MAXINE WELCH ACREAGE: 693.4±
DRILL CONVERT DRILL DEEPER REDRILL FRACTURE OR STIMULATE
PLUG OFF OLD FORMATION PERFORATE NEW FORMATION PLUG & ABANDON
PAD ELEVATION: 1169' CLEAN OUT & REPLUG OTHER CHANGE (SPECIFY):
TARGET FORMATION MARCELLUS ESTIMATED DEPTH TVD. 6942' ± MD. 13,500'
WELL OPERATOR STATOIL USA ONSHORE PROPERTIES INC. DESIGNATED AGENT RICHARD PYLES
ADDRESS 2103 CITYWEST BLVD. STE. 800 ADDRESS 803 NASH ROAD
CITY HOUSTON STATE TX ZIP CODE 77042 CITY MIDDLEBOURNE STATE WV ZIP CODE 26149

01/08/2016