

Top Hole Latitude: 39°27'30"

5133'

Bottom Hole Latitude: 39°27'30" 543'

# THRASHER

THE THRASHER GROUP, INC.  
600 WHITE OAKS BLVD.  
BRIDGEPORT, WV 26330  
PHONE 304-624-4108

## AS-DRILLED

### NOTES ON SURVEY

- COORDINATES SYSTEM IS UTM, NAD 83 DATUM, ZONE 17, U.S. FOOT AND WELL COORDINATES ESTABLISHED USING SURVEY GRADE GPS.
- SURFACE AND ROYALTY OWNER INFORMATION AND THEIR BOUNDARIES SHOWN HEREON WERE PLOTTED FROM DEEDS AND/OR TAX PARCEL MAPS PROVIDED BY CLIENT AND FIELD LOCATIONS.
- THIS PLAT DOES NOT REPRESENT A BOUNDARY SURVEY OF THE PARCELS SHOWN HEREON.
- NO DWELLINGS AND BUILDINGS WITHIN 625 FEET OF PROPOSED OF CENTER OF PAD.
- NO WATER WELLS OR DEVELOPED SPRINGS WITHIN 250 FEET OF PROPOSED WELL.
- NO PERENNIAL STREAMS, LAKES, PONDS, RESERVOIRS OR WETLANDS WITHIN 100 FEET OF THE LIMITS OF DISTURBANCE.
- NO NATURALLY PRODUCING TROUT STREAM WITHIN 300 FEET OF LIMITS OF DISTURBANCE.

TRACT	SURFACE OWNER	TAX PARCEL	ACRES	LEASE NO.
A	FRANCIS W TENNANT SR & RANDY W TUSTIN	5-11-6	46.51	T-2142A
B	VICTORY CEMETERY ASSN	5-11-30.4	3.76	PRE-2
C	KATHERINE & CHRISTINA M HOLLIDAY	5-11-30	124.54	PRE-1
D	KATHERINE & CHRISTINA M HOLLIDAY	5-11-30.1	12.00	T-18C
E	ENCL R JR & GLENDA SUE HEADLEY	5-11-33	66.92	T-18A
F	HUNTER REAL ESTATE LLC	5-11-38	60.00	T-3017
G	SUSAN CLANCY	5-12-43	45.5	T-3016

ADJOINER	SURFACE OWNER	TAX PARCEL
1	PATRICK WILSON & SHEILA BLACK	5-11-17.1
2	PATRICK WILSON & SHEILA BLACK	5-11-31
3	WALTER JR & LENA EUREKA	5-11-32
4	MARK E HEADLEY	5-11-33.1
5	TERRY R HEADLEY	5-11-34
6	EDWARD & SHIRLEY LANCASTER	5-11-35
7	KATHERINE & CHRISTINA HOLLIDAY	5-11-30.2
8	WILLIAM WOODBURN	5-11-14.1
9	KATHERINE & CHRISTINA HOLLIDAY	5-11-30.3
10	JACKIELEE STRAIGHT	5-11-15
11	VICTORY CEMETERY ASSOCIATION	5-11-30.5

LINE	BEARING	DISTANCE
L1	S 23°23'08" E	743.09'
L2	S 11°23'51" W	1338.67'

SHL

Bottom Hole Longitude: 80°45'00" 9659'  
Top Hole Longitude: 80°45'00" 9427'

GRID NORTH  
UTM, NAD83 DATUM, ZONE 17, US FT

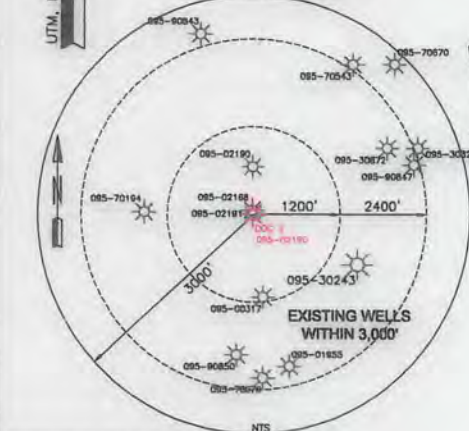
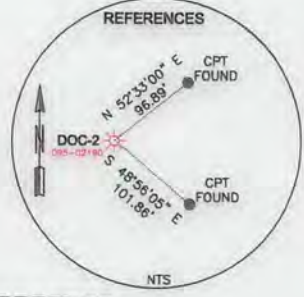
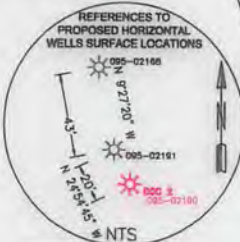

<b>SURFACE HOLE LOCATION (SHL):</b> UTM (NAD83, ZONE 17, METERS): NORTHING: 4,366,633.631 EASTING: 519,945.253 GEOGRAPHIC (NAD83): LATITUDE: 39.449031° LONGITUDE: -80.768191°
<b>BOTTOM HOLE LOCATION (BHL):</b> UTM (NAD83, ZONE 17, METERS): NORTHING: 4,364,738.029 EASTING: 521,349.688 GEOGRAPHIC (NAD83): LATITUDE: 39.431917° LONGITUDE: -80.751929°

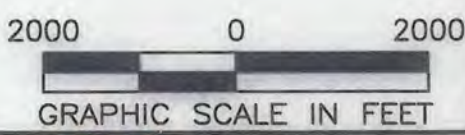

I, THE UNDERSIGNED, HEREBY CERTIFY THAT THIS PLAT IS CORRECT TO THE BEST OF MY KNOWLEDGE AND BELIEF AND SHOWS ALL THE INFORMATION REQUIRED BY LAW AND REGULATIONS ISSUED AND PRESCRIBED BY THE DEPARTMENT OF ENVIRONMENTAL PROTECTION.

P.S. 2270

*W.S. Wolf* 3/31/16

<p>(+) DENOTES LOCATION OF WELL ON UNITED STATES TOPOGRAPHIC MAPS</p> <p>WVDEP OFFICE OF OIL &amp; GAS 601 57TH STREET CHARLESTON, WV 25034</p>	<p>MINIMUM DEGREE OF ACCURACY: 1/200</p> <p>PROVEN SURVEY SOURCE OF GRADE GPS ELEVATION: (NAVD 88, US FT)</p>	<p>OPERATOR'S WELL #: DOC-2</p> <p>API WELL #: 47 095 02190H6A STATE COUNTY PERMIT</p>
	<p>WELL TYPE: OIL <input type="checkbox"/> WASTE DISPOSAL <input type="checkbox"/> PRODUCTION <input type="checkbox"/> DEEP <input type="checkbox"/> GAS <input checked="" type="checkbox"/> LIQUID INJECTION <input type="checkbox"/> STORAGE <input type="checkbox"/> SHALLOW <input checked="" type="checkbox"/></p> <p>WATERSHED: OUTLET MIDDLE ISLAND CREEK ELEVATION: 1036'</p> <p>DISTRICT: MCELROY COUNTY: TYLER QUADRANGLE: SHIRLEY</p> <p>SURFACE OWNER: FRANCIS W TENNANT SR &amp; RANDY W TUSTIN ACREAGE: 46.51±</p> <p>OIL &amp; GAS ROYALTY OWNER: JACOB FEIN, ETAL; WINDY FOUT, ETAL; JAMES T. GUSTON, ETAL; WIS EXPLORATION I LLC; WILLIAM F. WOODBURN, ETAL. VICTORY CEMETERY ASSOCIATION; JACOB W. FEIN. ACREAGE: 359.23±</p> <p>DRILL <input checked="" type="checkbox"/> DRILL DEEPER <input type="checkbox"/> REDRILL <input type="checkbox"/> FRACTURE OR STIMULATE <input checked="" type="checkbox"/> PLUG OFF OLD FORMATION <input type="checkbox"/> PERFORATE NEW FORMATION <input type="checkbox"/></p> <p>CONVERT <input type="checkbox"/> PLUG &amp; ABANDON <input type="checkbox"/> CLEAN OUT &amp; REPLUG <input type="checkbox"/> OTHER CHANGE <input type="checkbox"/> (SPECIFY)</p> <p>TARGET FORMATION: MARCELLUS ESTIMATED DEPTH: TMD 14,161' TVD 6,793'</p>	
<p>WELL OPERATOR: JAY BEE OIL &amp; GAS, INC. ADDRESS: 1720 RT. 22, EAST CITY: UNION STATE: NJ ZIP CODE: 07083</p>	<p>DESIGNATED AGENT: RANDY BRODA ADDRESS: RT. 1 BOX 5 CITY: CAIRO STATE: WV ZIP CODE: 26337</p>	<p>REVISIONS: DATE: 03-28-2016</p> <p>DRAWN BY: E. LYTLE SCALE: 1" = 2000' DRAWING NO: 050-5823 ASDRILLED PLAT</p>

06/10/2016