

LATITUDE 39°27'30"

8,251'

6,306' TO BOTTOM HOLE

LATITUDE 39°25'00"

LONGITUDE 80°50'00"

9,579'

LONGITUDE 80°50'00"

Antero Resources Corporation
Well No. Johnston Unit 2H

WILLIE R. LESTER
D.B. 326 PG. 402
T.M. 04 PAR. 07
97.75 AC. ±

2H BOTTOM HOLE

ROBERT L. RIPLEY ET AL
D.B. 327 PG. 77
T.M. 04 PAR. 06.2
18.75 AC. ±

REGINA H. BERTOZZI ET AL
D.B. 334 PG. 420
T.M. 04 PAR. 08.3
41.86 AC. ±

RAYMOND UNDERWOOD
W.B. 28 PG. 70
T.M. 04 PAR. 12
76.5 AC. ±

RAYMOND UNDERWOOD
D.B. 114 PG. 272
T.M. 04 PAR. 13
96 AC. ±

LANDING POINT
N:342144
E:1614588

NOTES:
WELL 2H TOP HOLE INFORMATION:
N: 342,385ft E: 1,615,147ft
LAT: 39°25'55.33" LON: 80°51'45.16"
BOTTOM HOLE INFORMATION:
N: 335,015ft E: 1,616,983ft
LAT: 39°24'42.77" LON: 80°51'20.34"
WEST VIRGINIA COORDINATE SYSTEM OF 1927 NORTH ZONE.
ZONE WAS DERIVED FROM MEASUREMENTS TAKEN WITH TRIMBLE GEOXT SUBMETER MAPPING GRADE GPS UNIT. PLAT ORIENTATION, CORNER, AND WELL REFERENCE TIE LINES ARE BASED ON GRID NORTH.

(NAD) 83 (UTM) ZONE 17 COORDS:
WELL 2H TOP HOLE INFORMATION:
N: 4,364,740m E: 511,844m
BOTTOM HOLE INFORMATION:
N: 4,362,504m E: 512,441m

NOTE:
NO OCCUPIED DWELLINGS OR BUILDINGS TWO THOUSAND FIVE HUNDRED (2,500) SQUARE FEET OR LARGER USED TO HOUSE OR SHELTER DAIRY CATTLE OR POULTRY HUSBANDRY ARE LOCATED WITHIN SIX HUNDRED TWENTY-FIVE (625) FEET OF THE CENTER OF THE WELL PAD.

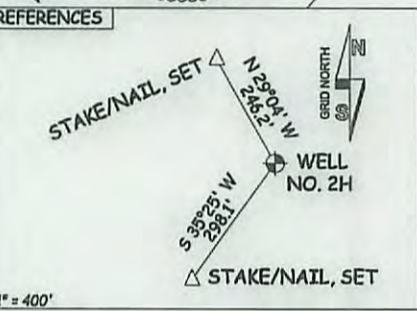
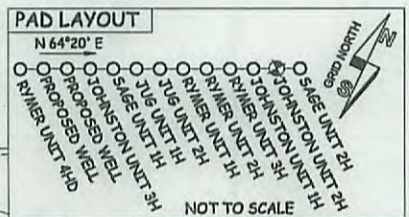

I, THE UNDERSIGNED, HEREBY CERTIFY THAT THIS PLAT IS CORRECT TO THE BEST OF MY KNOWLEDGE AND BELIEF AND SHOWS ALL THE INFORMATION REQUIRED BY LAW AND THE RULES ISSUED AND PERSCRIBED BY THE DEPARTMENT OF ENVIRONMENTAL PROTECTION.



STATE OF WEST VIRGINIA, DIVISION OF ENVIRONMENTAL PROTECTION, OFFICE OF OIL AND GAS

WILLOW LAND SURVEYING PLLC
220 MASONIC AVE. PENNSBORO WEST VIRGINIA 26415

JOB # 15-034WA
DRAWING # JOHNSTON2HR2
SCALE 1" = 1000'
MINIMUM DEGREE OF ACCURACY SUBMETER
PROVEN SOURCE OF ELEV. SUBMETER MAPPING GRADE GPS

LEGEND
- - - - - Surface Owner Boundary Lines +/-
- - - - - Interior Surface Tracts +/-
- x - x - Existing Fence
⊕ Found monument, as noted

DOUGLAS R. ROWE P.S. 2202

STATE OF WEST VIRGINIA DEPARTMENT OF ENERGY DIVISION OF OIL AND GAS

DATE 01/26/16
OPERATOR'S WELL# JOHNSTON UNIT #2H

A = LOREN E. BAGLEY D.B. 349 PG. 284 T.M. 8 PAR 3.1
B = LOREN E. BAGLEY D.B. 349 PG. 284 T.M. 8 PAR 3.3
C = ARLIT ARBOGAST D.B. 376 PG. 826 T.M. 8 PAR 3.2
D = DAVID D. CHIPPS D.B. 290 PG. 682 T.M. 8 PAR 3.5

WELL TYPE: OIL ___ GAS X LIQUID INJECTION ___ WASTE DISPOSAL ___ 47 - 095 - 02300 HGA
(IF "GAS") PRODUCTION X STORAGE ___ DEEP ___ SHALLOW X STATE COUNTY PERMIT COUNTY NAME
LOCATION: ELEVATION 1,036' ORIGINAL - 1,017' PROPOSED WATERSHED HEADWATERS MIDDLE ISLAND CREEK DISTRICT CENTERVILLE COUNTY TYLER PERMIT
QUADRANGLE SHIRLEY 7.5' DISTRICT CENTERVILLE COUNTY TYLER
SURFACE OWNER RAYMOND UNDERWOOD ACREAGE 96 ACRES +/- LEASE ACREAGE 96 ACRES±; 244.25 ACRES±;
OIL & GAS ROYALTY OWNER RAYMOND V. UNDERWOOD ET UX; W.V.D.N.R.; FORREST E. LEASEBURG ET UX; EATHEL JOHNSTON; RITA J. HITCHCOCK; LILLIE H. MAPLE ET AL 78 AC±; 108 ACRES±; 50 ACRES±; 341 ACRES±
PROPOSED WORK: DRILL X CONVERT ___ DRILL DEEPER ___ REDRILL ___ FRACTURE OR STIMULATE X
PLUG OFF OLD FORMATION ___ PERFORATE NEW FORMATION X OTHER PHYSICAL CHANGE IN WELL
(SPECIFY) MOD-SHL PLUG & ABANDON CLEAN OUT & REPLUG
TARGET FORMATION MARCELLUS ESTIMATED DEPTH 6,700' TVD 14,700' MD
WELL OPERATOR ANTERO RESOURCES CORP. DESIGNATED AGENT DIANNA STAMPER - CT CORPORATION SYSTEM
ADDRESS 1615 WYNKOOP STREET ADDRESS 5400 D BIG TYLER ROAD
DENVER, CO 80202 CHARLESTON, WV 25313