

LATITUDE 39°22'30" 1,678'

LATITUDE 39°25'00"

LONGITUDE 80°57'30"

2,487'

LONGITUDE 80°57'30"

9,943 TO BOTTOM HOLE

Antero Resources Corporation
Well No. Edwards Unit 1H

AS DRILLED DATA:
WELL 1H TOP HOLE INFORMATION:
N: 319,579ft E: 1,586,038ft
LAT: 39°22'05.42" LON: 80°57'51.37"
BOTTOM HOLE INFORMATION:
N: 327,374ft E: 1,581,590ft
LAT: 39°23'21.73" LON: 80°58'49.64"

WEST VIRGINIA COORDINATE SYSTEM OF 1927 NORTH ZONE. ZONE WAS DERIVED FROM MEASUREMENTS TAKEN WITH TRIMBLE GEOXT SUBMETER MAPPING GRADE GPS UNIT. PLAT ORIENTATION, CORNER, AND WELL REFERENCE TIE LINES ARE BASED ON GRID NORTH.

(NAD) 83 (UTM) ZONE 17 COORDS:
WELL 1H TOP HOLE INFORMATION:
N: 4,357,644m E: 503,092m
BOTTOM HOLE INFORMATION:
N: 4,359,996m E: 501,698m

WV NORTH ZONE GRID NORTH

WELL NO. 1H BOTTOM HOLE

500'

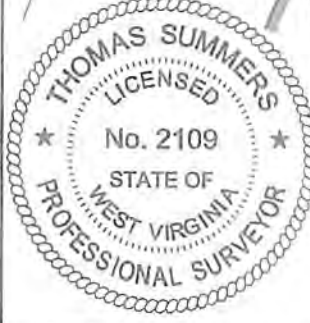

PAD LAYOUT NOT TO SCALE

- EDWARDS UNIT 1H
- MARKLE UNIT 1H
- EDWARDS UNIT 3H
- MARKLE UNIT 2H
- EDWARDS UNIT 2H
- MARKLE UNIT 3H
- TINKER UNIT 3H
- DILLON UNIT 2H
- TINKER UNIT 2H
- DILLON UNIT 3H
- TINKER UNIT 1H
- DILLON UNIT 1H



NOTE:
3 WATER WELLS WERE LOCATED WITHIN 2000' OF CENTER OF PAD

LEGEND
- - - Surface Owner Boundary Lines +/-
- - - Interior Surface Tracts +/-
○ Proposed Well Path
⊙ As Drilled Well Path

I, THE UNDERSIGNED, HEREBY CERTIFY THAT THIS PLAT IS CORRECT TO THE BEST OF MY KNOWLEDGE AND BELIEF AND SHOWS ALL THE INFORMATION REQUIRED BY LAW AND THE RULES ISSUED AND PERSCRIBED BY THE DEPARTMENT OF ENVIRONMENTAL PROTECTION.



STATE OF WEST VIRGINIA, DIVISION OF ENVIRONMENTAL PROTECTION, OFFICE OF OIL AND GAS

WILLOW LAND SURVEYING PLLC
220 MASONIC AVE. PENNSBORO WEST VIRGINIA 26415

JOB # 16-009WA
DRAWING # EDWARDS1HAD
SCALE 1" = 1000'
MINIMUM DEGREE OF ACCURACY SUBMETER
PROVEN SOURCE OF ELEV. SUBMETER MAPPING GRADE GPS

THOMAS SUMMERS P.S. 2109

STATE OF WEST VIRGINIA DEPARTMENT OF ENERGY DIVISION OF OIL AND GAS

DATE 08/01/18 OPERATOR'S WELL# EDWARDS UNIT #1H

- NOTE
- NO OCCUPIED DWELLINGS OR BUILDINGS TWO THOUSAND FIVE HUNDRED (2,500) SQUARE FEET OR LARGER USED TO HOUSE OR SHELTER DAIRY CATTLE OR POULTRY HUSBANDRY ARE LOCATED WITHIN SIX HUNDRED TWENTY-FIVE (625) FEET OF THE CENTER OF THE WELL PAD.
 - TOP HOLE DATA SHOWN HEREON WAS PROVIDED BY ALLEGHENY SURVEYS, INC.
 - AS DRILLED DATA WAS PROVIDED BY ANTERO RESOURCES CORPORATION.
 - WLS IS NOT CERTIFYING THE DATA AND INFORMATION PROVIDED LISTED IN NOTES 2 AND 3, ONLY THE RELATIONSHIP TO THE DATA AND INFORMATION PROVIDED TO THE LEASE BOUNDARIES.
 - WLS IS BY NO MEANS RESPONSIBLE FOR ANY ERRORS OR INACCURACIES WITH THE DATA AND INFORMATION THAT HAS BEEN PROVIDED.

WELL TYPE: OIL GAS LIQUID INJECTION WASTE DISPOSAL 47 - 095 - 02374
 (IF "GAS") PRODUCTION STORAGE DEEP SHALLOW STATE COUNTY PERMIT
 LOCATION: ELEVATION 1,146.5' AS-BUILT WATERSHED OUTLET MIDDLE ISLAND CREEK
 QUADRANGLE PENNSBORO 7.5' - SHL MIDDLEBOURNE 7.5' - BHL DISTRICT MEADE COUNTY TYLER
 SURFACE OWNER RITCHIE PETROLEUM INC. ACREAGE 30.92 ACRES +/-
 OIL & GAS ROYALTY OWNER ASHFORD BROADWATER; TERRY L. SNIDER; ROBERT A. LOWTHER; LEASE ACREAGE 593.712 ACRES +/-; 67 ACRES +/-; 250 ACRES +/-
 CHARLES O. CONAWAY; BERYLE GARNETT MAYFIELD; ELIZABETH M. LATHEY 44.5 ACRES +/-; 155.33 ACRES +/-; 127.85 ACRES +/-
 PROPOSED WORK: DRILL CONVERT DRILL DEEPER REDRILL FRACTURE OR STIMULATE
 PLUG OFF OLD FORMATION PERFORATE NEW FORMATION OTHER PHYSICAL CHANGE IN WELL (SPECIFY) AS DRILLED
 TARGET FORMATION MARCELLUS ESTIMATED DEPTH 6,405' TVD 15,829' MD
 WELL OPERATOR ANTERO RESOURCES CORP. DESIGNATED AGENT DIANNA STAMPER - CT CORPORATION SYSTEM
 ADDRESS 1615 WYNKOOP STREET ADDRESS 5400 D BIG TYLER ROAD
 DENVER, CO 80202 CHARLESTON, WV 25313