

LATITUDE 39°27'30"

8,227'

766' TO BOTTOM HOLE  
LATITUDE 39°27'30"

LONGITUDE 80°55'00"

3,866' TO BOTTOM HOLE

11,978'

LONGITUDE 80°52'30"

# Antero Resources Corporation Well No. Mysis Unit 1H

**NOTE**  
NO OCCUPIED DWELLINGS OR BUILDINGS TWO THOUSAND FIVE HUNDRED (2,500) SQUARE FEET OR LARGER USED TO HOUSE OR SHELTER DAIRY CATTLE OR POULTRY HUSBANDRY ARE LOCATED WITHIN SIX HUNDRED TWENTY-FIVE (625) FEET OF THE CENTER OF THE WELL PAD.

**NOTES:**  
WELL 1H TOP HOLE INFORMATION:  
N: 340,167ft E: 1,603,367ft  
LAT: 39°25'31.62" LON: 80°54'14.84"  
BOTTOM HOLE INFORMATION:  
N: 348,345ft E: 1,599,185ft  
LAT: 39°26'51.79" LON: 80°55'09.77"  
WEST VIRGINIA COORDINATE SYSTEM OF 1927 NORTH ZONE. ZONE WAS DERIVED FROM MEASUREMENTS TAKEN WITH TRIMBLE GEOXT SUBMETER 1H MAPPING GRADE GPS UNIT. BOTTOM HOLE PLAT ORIENTATION, CORNER, AND WELL REFERENCE TIE LINES ARE BASED ON GRID NORTH.

(NAD) 83 (UTM) ZONE 17 COORDS:  
WELL 1H TOP HOLE INFORMATION:  
N: 4,364,004m E: 508,267m  
BOTTOM HOLE INFORMATION:  
N: 4,366,474m E: 506,951m

(NAD) 27 (UTM) ZONE 17 COORDS:  
WELL 1H TOP HOLE INFORMATION:  
N: 14,316,856ft E: 1,667,492ft  
POINT OF ENTRY INFORMATION:  
N: 14,316,749ft E: 1,666,119ft  
BOTTOM HOLE INFORMATION:  
N: 14,324,960ft E: 1,663,176ft

### PAD LAYOUT

- NOT TO SCALE
- MYSIS UNIT 1H 10'
  - MYSIS UNIT 2H 10'
  - MYSIS UNIT 3H 10'
  - ANT UNIT 1H 10'
  - ANT UNIT 2H 10'
  - ANT UNIT 3H 10'
  - SAN JUAN UNIT 1H 10'
  - SAN JUAN UNIT 2H 10'
  - SAN JUAN UNIT 3H 10'
  - SAN JUAN UNIT 4H 10'
  - EMERGER UNIT 1H 10'
  - EMERGER UNIT 2H 10'
  - EMERGER UNIT 3H 10'
  - EMERGER UNIT 4H 10'

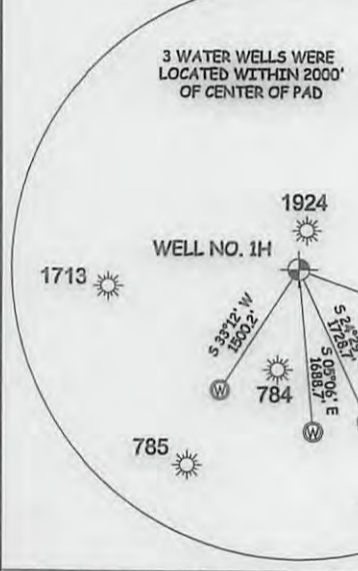
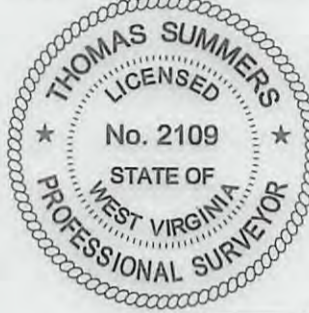
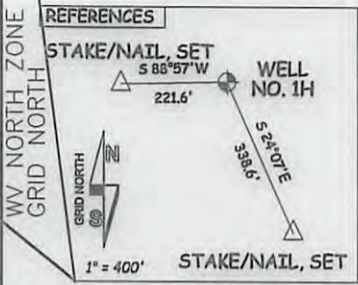

I THE UNDERSIGNED, HEREBY CERTIFY THAT THIS PLAT IS CORRECT TO THE BEST OF MY KNOWLEDGE AND BELIEF AND SHOWS ALL THE INFORMATION REQUIRED BY LAW AND THE RULES ISSUED AND PERSCRIBED BY THE DEPARTMENT OF ENVIRONMENTAL PROTECTION.

STATE OF WEST VIRGINIA, DIVISION OF ENVIRONMENTAL PROTECTION, OFFICE OF OIL AND GAS

WILLOW LAND SURVEYING PLLC  
220 MASONIC AVE. PENNSBORO WEST VIRGINIA 26415

JOB # 16-046WA  
DRAWING # MYSIS1HR  
SCALE 1" = 1000'  
MINIMUM DEGREE OF ACCURACY SUBMETER  
PROVEN SOURCE OF ELEV. SUBMETER MAPPING GRADE GPS

**LEGEND**  
----- Surface Owner Boundary Lines +/-  
----- Interior Surface Tracts +/-  
----- Existing Fence  
⊕ Found monument, as noted

*Thomas Summers*  
THOMAS SUMMERS P.S. 2109

STATE OF WEST VIRGINIA DEPARTMENT OF ENERGY DIVISION OF OIL AND GAS

DATE 08/09/16  
OPERATOR'S WELL# MYSIS UNIT #1H

WELL TYPE: OIL  GAS  LIQUID INJECTION  WASTE DISPOSAL  (IF "GAS") PRODUCTION  STORAGE  DEEP  SHALLOW  STATE COUNTY PERMIT

LOCATION: ELEVATION 1,168' - ORIGINAL 1,145' - PROPOSED 1,145' WATERSHED OUTLET MIDDLE ISLAND CREEK

QUADRANGLE MIDDLEBOURNE 7.5' DISTRICT CENTERVILLE COUNTY TYLER

SURFACE OWNER VERA O. THOMAS ACREAGE 51.11 ACRES +/-

OIL & GAS ROYALTY OWNER NORMAN H. THOMAS ET UX; KATHLEEN L. LOUGH; RUSSELL PAUL STACKPOLE; LEASE ACREAGE 125 AC.±; 40.27 AC.±; 27.5 AC.±; CHARLES C. FAIRBEE; EDWIN K. LIVINGSTON; LARRY D. MCMULLEN; ROBERT GOODE; 24.5 AC.±; 24.41 AC.±; 118.14 AC.±; 53.13 AC.±; GLENNA R. MCMULLEN; LEMUEL MOORE ET UX 70 AC.±; 73 AC.±

PROPOSED WORK: DRILL  CONVERT  DRILL DEEPER  REDRILL  FRACTURE OR STIMULATE  PLUG OFF OLD FORMATION  PERFORATE NEW FORMATION  OTHER PHYSICAL CHANGE IN WELL (SPECIFY) \_\_\_\_\_ PLUG & ABANDON CLEAN OUT & REPLUG

TARGET FORMATION MARCELLUS ESTIMATED DEPTH 7,100' TVD 16,300' MD

WELL OPERATOR ANTERO RESOURCES CORP. DESIGNATED AGENT DIANNA STAMPER - CT CORPORATION SYSTEM

ADDRESS 1615 WYNKOOP ST. ADDRESS 5400 D BIG TYLER ROAD

DENVER, CO 80202 CHARLESTON, WV 25313

01/27/2017

COUNTY NAME

PERMIT

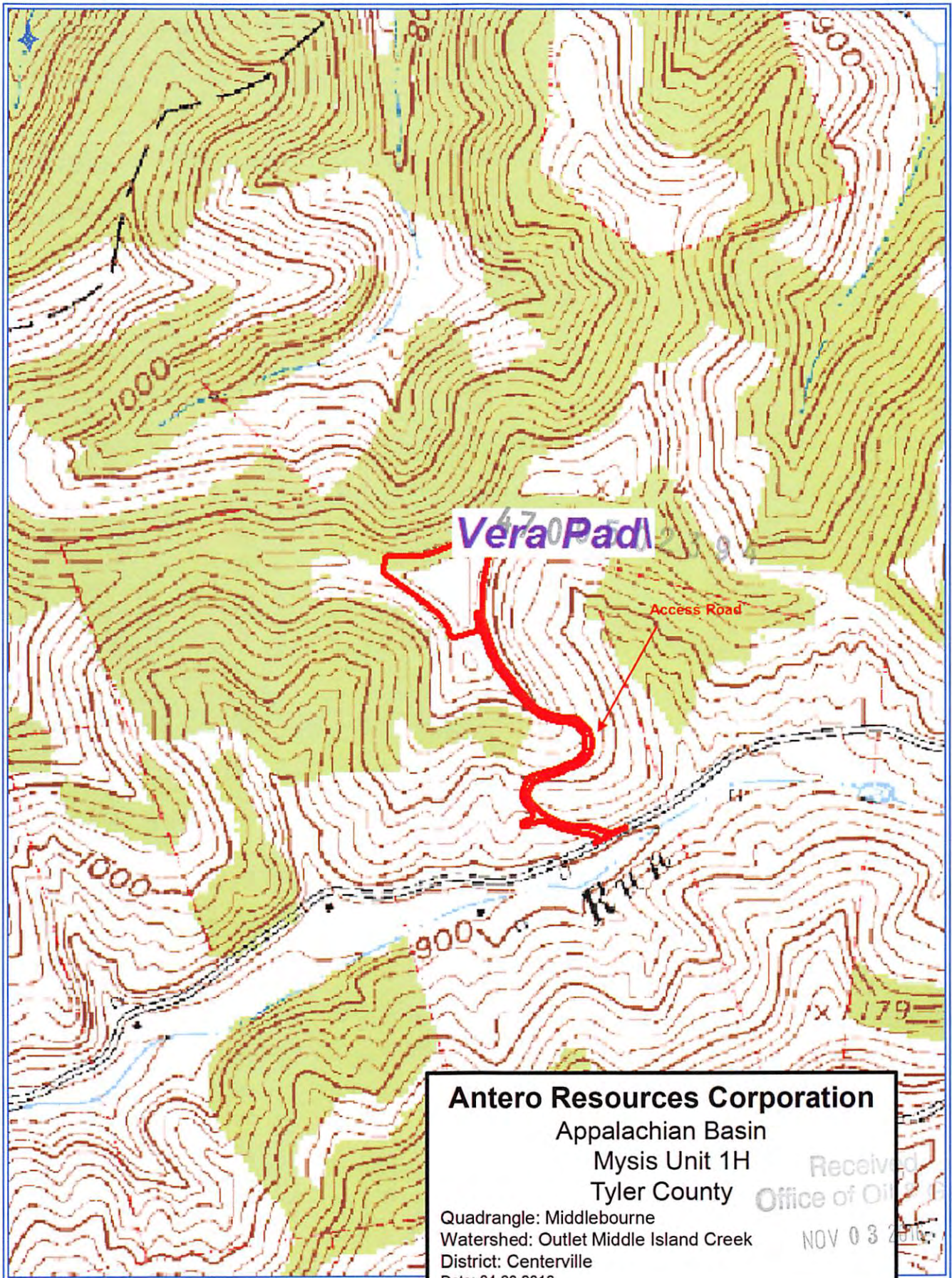

**Antero Resources Corporation**

Appalachian Basin

Mysis Unit 1H

Tyler County

Quadrangle: Middlebourne

Watershed: Outlet Middle Island Creek

District: Centerville

Date: 04-20-2016

Received  
Office of Oil & Gas

NOV 03 2016