

LATITUDE 39°27'30"

8,224'

LATITUDE 39°27'30"

11,382' TO BOTTOM HOLE

LONGITUDE 80°52'30"

Antero Resources Corporation Well No. Mysis Unit 2H

- NOTE**
1. NO OCCUPIED DWELLINGS OR BUILDINGS TWO THOUSAND FIVE HUNDRED (2,500) SQUARE FEET OR LARGER USED TO HOUSE OR SHELTER DAIRY CATTLE OR POULTRY HUSBANDRY ARE LOCATED WITHIN SIX HUNDRED TWENTY-FIVE (625) FEET OF THE CENTER OF THE WELL PAD.
 2. TOP HOLE DATA SHOWN HEREON WAS PROVIDED BY ALLEGHENY SURVEYS, INC.
 3. AS DRILLED DATA WAS PROVIDED BY ANTERO RESOURCES CORPORATION.
 4. WLS IS NOT CERTIFYING THE DATA AND INFORMATION PROVIDED LISTED IN NOTES 2 AND 3, ONLY THE RELATIONSHIP TO THE DATA AND INFORMATION PROVIDED TO THE LEASE BOUNDARIES.
 5. WLS IS BY NO MEANS RESPONSIBLE FOR ANY ERRORS OR INACCURACIES WITH THE DATA AND INFORMATION THAT HAS BEEN PROVIDED.

AS DRILLED DATA:
WELL 2H TOP HOLE INFORMATION:
 N: 340,158ft E: 1,603,370ft
 LAT: 39°25'31.53" LON: 80°54'14.80"
BOTTOM HOLE INFORMATION:
 N: 347,100ft E: 1,600,317ft
 LAT: 39°26'39.66" LON: 80°54'55.09"
 WEST VIRGINIA COORDINATE SYSTEM OF 1927 NORTH ZONE. ZONE WAS DERIVED FROM MEASUREMENTS TAKEN WITH TRIMBLE GEOXT SUBMETER MAPPING GRADE GPS UNIT. PLAT ORIENTATION, CORNER, AND WELL REFERENCE TIE LINES ARE BASED ON GRID NORTH.

(NAD) 83 (UTM) ZONE 17 COORDS:
WELL 2H TOP HOLE INFORMATION:
 N: 4,364,001m E: 508,268m
BOTTOM HOLE INFORMATION:
 N: 4,366,101m E: 507,303m

47 - 095 - 02395
 STATE COUNTY PERMIT

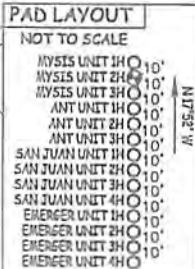
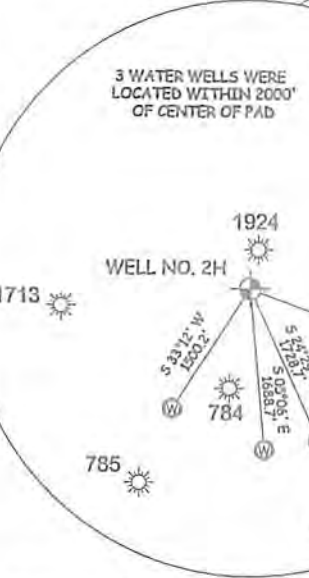
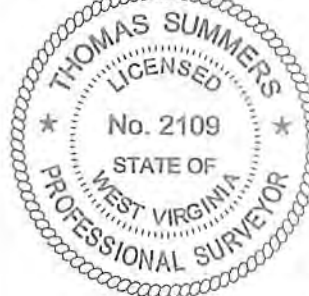

I THE UNDERSIGNED, HEREBY CERTIFY THAT THIS PLAT IS CORRECT TO THE BEST OF MY KNOWLEDGE AND BELIEF AND SHOWS ALL THE INFORMATION REQUIRED BY LAW AND THE RULES ISSUED AND PERSCRIBED BY THE DEPARTMENT OF ENVIRONMENTAL PROTECTION.



STATE OF WEST VIRGINIA, DIVISION OF ENVIRONMENTAL PROTECTION, OFFICE OF OIL AND GAS
 WILLOW LAND SURVEYING PLLC
 220 MASONIC AVE. PENNSBORO WEST VIRGINIA 26415

JOB # 16-046WA
 DRAWING # MYSIS2HAD
 SCALE 1" = 1000'
 MINIMUM DEGREE OF ACCURACY SUBMETER
 PROVEN SOURCE OF ELEV. SUBMETER MAPPING GRADE GPS

LEGEND
 - - - - - Surface Owner Boundary Lines +/-
 - - - - - Interior Surface Tracts +/-
 O Proposed Well Path
 O As Drilled Well Path

Thomas Summers
 THOMAS SUMMERS P.S. 2109
 DATE 10/12/18
 OPERATOR'S WELL# MYSIS UNIT #2H

STATE OF WEST VIRGINIA DEPARTMENT OF ENERGY DIVISION OF OIL AND GAS

WELL TYPE: OIL ___ GAS LIQUID INJECTION ___ WASTE DISPOSAL ___
 (IF "GAS") PRODUCTION STORAGE ___ DEEP ___ SHALLOW
 LOCATION: ELEVATION 1,148.1' - AS BUILT ___ WATERSHED ___ OUTLET MIDDLE ISLAND CREEK
 QUADRANGLE MIDDLEBOURNE 7.5' DISTRICT CENTERVILLE COUNTY TYLER

SURFACE OWNER VERA O. THOMAS ACREAGE 51.11 ACRES +/-
 OIL & GAS ROYALTY OWNER NORMAN H. THOMAS ET UX; KATHLEEN L. LOUGH; KATHLEEN L. LOUGH; EDWIN K. LIVINGSTON; LARRY D. MCMULLEN; CHARLES O. CONAWAY; ROBERT GOODE; GARY L. STEVENS ET UX; GLENNA R. MCMULLEN; PATSY J. FLETCHER LEASE ACREAGE 125 AC.±; 40.27 AC.±; 25.68 AC.±; 24.41 AC.±; 118.14 AC.±; 77.66 AC.±; 53.13 AC.±; 2.87 AC.±; 70 AC.±; 69 AC.±

PROPOSED WORK: DRILL ___ CONVERT ___ DRILL DEEPER ___ REDRILL ___ FRACTURE OR STIMULATE ___
 PLUG OFF OLD FORMATION ___ PERFORATE NEW FORMATION ___ OTHER PHYSICAL CHANGE IN WELL (SPECIFY) AS DRILLED PLUG & ABANDON CLEAN OUT & REPLUG

TARGET FORMATION MARCELLUS ESTIMATED DEPTH 6,541' TVD 14,183' MD
 WELL OPERATOR ANTERO RESOURCES CORP. DESIGNATED AGENT DIANNA STAMPER - CT CORPORATION SYSTEM
 ADDRESS 1615 WYNKOOP ST. ADDRESS 5400 D BIG TYLER ROAD
 DENVER, CO 80202 CHARLESTON, WV 25313

5,093' TO BOTTOM HOLE

LONGITUDE 80°52'30"

COUNTY NAME

PERMIT