

LATITUDE 39°27'30"

5,957'

4,436' TO BOTTOM HOLE  
LATITUDE 39°25'00"

LONGITUDE 80°55'00"

9,209' TO BOTTOM HOLE

13,437'

LONGITUDE 80°55'00"

Antero Resources Corporation  
Well No. Jim Unit 1H  
47-095-02408

NOTES:  
WELL 1H TOP HOLE INFORMATION:  
N: 338,859ft E: 1,593,844ft  
LAT: 39°25'17.20" LON: 80°56'15.91"  
BOTTOM HOLE INFORMATION:  
N: 327,887ft E: 1,595,192ft  
LAT: 39°23'28.98" LON: 80°55'56.50"  
WEST VIRGINIA COORDINATE SYSTEM OF 1927 NORTH ZONE. ZONE WAS DERIVED FROM MEASUREMENTS TAKEN WITH TRIMBLE GEOXT SUBMETER MAPPING GRADE GPS UNIT. FLAT ORIENTATION, CORNER, AND WELL REFERENCE TIE LINES ARE BASED ON GRID NORTH.

(NAD) 83 (UTM) ZONE 17 COORDS:  
WELL 1H TOP HOLE INFORMATION:  
N: 4,363,557m E: 505,372m  
BOTTOM HOLE INFORMATION:  
N: 4,360,221m E: 505,839m

PAD LAYOUT



WV NORTH ZONE  
GRID NORTH

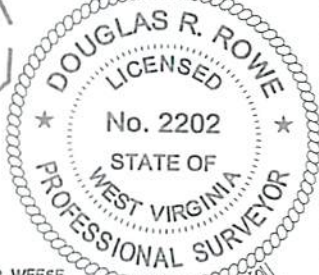

- NOTE
- 1. NO OCCUPIED DWELLINGS OR BUILDINGS TWO THOUSAND FIVE HUNDRED (2,500) SQUARE FEET OR LARGER USED TO HOUSE OR SHELTER DAIRY CATTLE OR POULTRY HUSBANDRY ARE LOCATED WITHIN SIX HUNDRED TWENTY-FIVE (625) FEET OF THE CENTER OF THE WELL PAD.
  - 2. TOP HOLE DATA SHOWN HEREON WAS PROVIDED BY ANTERO RESOURCES CORPORATION.
  - 3. AS DRILLED DATA WAS PROVIDED BY ANTERO RESOURCES CORPORATION.
  - 4. WLS IS NOT CERTIFYING THE DATA AND INFORMATION PROVIDED LISTED IN NOTES 2 AND 3, ONLY THE RELATIONSHIP TO THE DATA AND INFORMATION PROVIDED TO THE LEASE BOUNDARIES.
  - 5. WLS IS BY NO MEANS RESPONSIBLE FOR ANY ERRORS OR INACCURACIES WITH THE DATA AND INFORMATION THAT HAS BEEN PROVIDED.

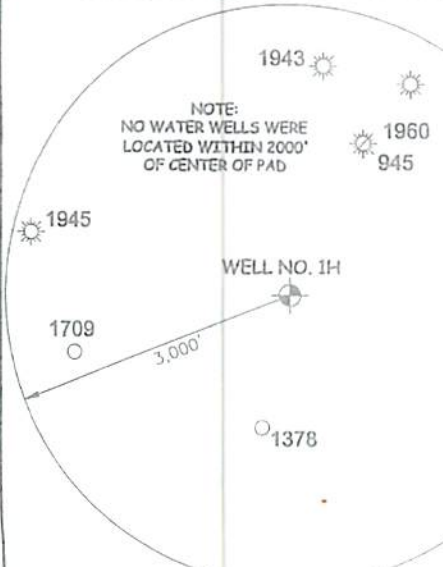

I THE UNDERSIGNED, HEREBY CERTIFY THAT THIS PLAN IS CORRECT TO THE BEST OF MY KNOWLEDGE AND BELIEF AND SHOWS ALL THE INFORMATION REQUIRED BY LAW AND THE RULES ISSUED AND PERSCRIBED BY THE DEPARTMENT OF ENVIRONMENTAL PROTECTION.



STATE OF WEST VIRGINIA, DIVISION OF ENVIRONMENTAL PROTECTION, OFFICE OF OIL AND GAS  
WILLOW LAND SURVEYING PLLC  
220 MASONIC AVE. PENNSBORO WEST VIRGINIA 26415

JOB # 14-128WA  
DRAWING # JIMHAD  
SCALE 1" = 1000'  
MINIMUM DEGREE OF ACCURACY SUBMETER  
PROVEN SOURCE OF ELEV. SUBMETER MAPPING GRADE GPS  
STATE OF WEST VIRGINIA DEPARTMENT OF ENERGY DIVISION OF OIL AND GAS

LEGEND  
--- Surface Owner Boundary Lines +/-  
--- Interior Surface Tracts +/-  
--- Proposed Well Path  
--- As Drilled Well Path  
DOUGLAS R. ROWE P.S. 2202  
DATE 06/04/19  
OPERATOR'S WELL# JIM UNIT #1H

WELL TYPE: OIL GAS X LIQUID INJECTION WASTE DISPOSAL  
(IF "GAS") PRODUCTION X STORAGE DEEP SHALLOW X  
LOCATION: ELEVATION 1,005' - AS BUILT WATERSHED OUTLET MIDDLE ISLAND CREEK QUADRANGLE MIDDLEBOURNE 7.5' DISTRICT MEADE COUNTY TYLER  
SURFACE OWNER ROGER R. WEESE ACREAGE 177.31 ACRES +/-  
OIL & GAS ROYALTY OWNER ROGER R. WEESE; JAMES A. SMITH; STEVEN P. CARSE; RONNIE LEE SMITH; DAVID QUENTIN CARSE; DAVID QUENTIN CARSE; DAVID QUENTIN CARSE; CHARLES E. STULL ET UX; LEEMAN W. MASON ET UX; GRACE SEWELL DeCARLO; JAMES McCULLOUGH ET UX; RONALD P. FLETCHER; RICHARD HALL BARNARD  
OIL & GAS ROYALTY OWNER 196.709 AC±; 31.919 AC±; 81.57 AC±; 97.544 AC±; 3.623 AC±; 14.022 AC±; 10 AC±; 105 AC±; 37.69 AC±; 85.52 AC±; 78 AC±; 44.35 AC±; 284.33 AC±  
PROPOSED WORK: DRILL CONVERT DRILL DEEPER REDRILL  
FRACTURE OR STIMULATE PLUG OFF OLD FORMATION  
PLUG & ABANDON CLEAN OUT & REPLUG PERFORATE NEW FORMATION  
OTHER PHYSICAL CHANGE IN WELL (SPECIFY) AS DRILLED  
TARGET FORMATION MARCELLUS ESTIMATED DEPTH 6,375' TVD 18,006' MD

WELL OPERATOR ANTERO RESOURCES CORP. DESIGNATED AGENT DIANNA STAMPER  
ADDRESS 1615 WYNKOOP STREET ADDRESS 5400 D BIG TYLER ROAD  
FORM WW-6 DENVER, CO 80202 CHARLESTON, WV 25313

47 - 095 - 02408  
STATE COUNTY PERMIT