

State of West Virginia
Department of Environmental Protection - Office of Oil and Gas
Well Operator's Report of Well Work

API 47 - 095 - 02452 County Tyler District Centerville
 Quad Middlebourne 7.5' Pad Name Lemuel Pad Field/Pool Name -----
 Farm name Antero Resources Corporation Well Number Olive Unit 3H
 Operator (as registered with the OOG) Antero Resources Corporation
 Address 1615 Wynkoop Street City Denver State CO Zip 80202

As Drilled location NAD 83/UTM Attach an as-drilled plat, profile view, and deviation survey
 Top hole Northing 4363668m Easting 507463m
 Landing Point of Curve Northing 4363786m Easting 507476m
 Bottom Hole Northing 4366352m Easting 506563m

Elevation (ft) 1155' GL Type of Well New Existing Type of Report Interim Final
 Permit Type Deviated Horizontal Horizontal 6A Vertical Depth Type Deep Shallow
 Type of Operation Convert Deepen Drill Plug Back Redrilling Rework Stimulate
 Well Type Brine Disposal CBM Gas Oil Secondary Recovery Solution Mining Storage Other _____
 Type of Completion Single Multiple Fluids Produced Brine Gas NGL Oil Other _____
 Drilled with Cable Rotary

Drilling Media Surface hole Air Mud Fresh Water Intermediate hole Air Mud Fresh Water Brine
 Production hole Air Mud Fresh Water Brine

Mud Type(s) and Additive(s)

Air - Foam & 4% KCL

Mud - Polymer

Date permit issued 6/23/2017 Date drilling commenced 12/10/2017 Date drilling ceased 8/8/2018
 Date completion activities began 8/27/2018 Date completion activities ceased 10/10/2018
 Verbal plugging (Y/N) N/A Date permission granted N/A Granted by N/A

Please note: Operator is required to submit a plugging application within 5 days of verbal permission to plug

Freshwater depth(s) ft None Identified Open mine(s) (Y/N) depths No
 Salt water depth(s) ft None Identified Void(s) encountered (Y/N) depths No
 Coal depth(s) ft 1328', 1468' Cavern(s) encountered (Y/N) depths No
 Is coal being mined in area (Y/N) No

Reviewed by:

WR-35
Rev. 8/23/13

API 47-095 - 02452 Farm name Antero Resources Corporation Well number Olive Unit 3H

CASING STRINGS	Hole Size	Casing Size	Depth	New or Used	Grade wt/ft	Basket Depth(s)	Did cement circulate (Y/ N) * Provide details below*
Conductor	24"	20"	112'	New	78.67#, A252	N/A	Y
Surface	17-1/2"	13-3/8"	605'	New	61#, J-55	N/A	Y
Coal							
Intermediate 1	12-1/4"	9-5/8"	2613'	New	36#, J-55	N/A	Y
Intermediate 2							
Intermediate 3							
Production	8-3/4"/8-1/2"	5-1/2"	16089'	New	23#, HCP-110	N/A	Y
Tubing		2-3/8"	6741'		4.7#, L-80		
Packer type and depth set		N/A					

Comment Details _____

CEMENT DATA	Class/Type of Cement	Number of Sacks	Slurry wt (ppg)	Yield (ft ³ /sks)	Volume (ft ³)	Cement Top (MD)	WOC (hrs)
Conductor	Class A	204 sx	15.6	1.18	241	0'	8 Hrs.
Surface	Class A	504 sx	15.6	1.20	605	0'	8 Hrs.
Coal							
Intermediate 1	Class A	900 sx	15.6	1.18	1062	0'	8 Hrs.
Intermediate 2							
Intermediate 3							
Production	Class H	704 sx (Lead) 1500 sx (Tail)	14.0 (Lead), 15.2 (Tail)	1.45 (Lead), 1.83 (Tail)	3766	~500' into Intermediate Casing	8 Hrs.
Tubing							

Drillers TD (ft) 16109' MD, 6523' TVD (BHL), 6598' (Deepest Point Drilled) Loggers TD (ft) 16109' MD

Deepest formation penetrated Marcellus Plug back to (ft) N/A

Plug back procedure N/A

Kick off depth (ft) 5816'

Check all wireline logs run caliper density deviated/directional induction
 neutron resistivity gamma ray temperature sonic

Well cored Yes No Conventional Sidewall Were cuttings collected Yes No

DESCRIBE THE CENTRALIZER PLACEMENT USED FOR EACH CASING STRING _____

Conductor - 0

Surface - 1 above guide shoe, 1 above insert float, 1 every 4th joint to surface

Intermediate - 1 above float joint, 1 above float collar, 1 every 4th joint to surface

Production - 1 above float joint, 1 below float collar, 1 every 3rd joint to top of cement

WAS WELL COMPLETED AS SHOT HOLE Yes No DETAILS _____

WAS WELL COMPLETED OPEN HOLE? Yes No DETAILS _____

WERE TRACERS USED Yes No TYPE OF TRACER(S) USED N/A

WR-35
Rev. 8/23/13

API 47- 095 - 02452 Farm name Antero Resources Corporation Well number Olive Unit 3H

PERFORATION RECORD

Stage No.	Perforation date	Perforated from MD ft.	Perforated to MD ft.	Number of Perforations	Formation(s)
*PLEASE SEE ATTACHED EXHIBIT 1					

Please insert additional pages as applicable.

STIMULATION INFORMATION PER STAGE

Complete a separate record for each stimulation stage.

Stage No.	Stimulations Date	Ave Pump Rate (BPM)	Ave Treatment Pressure (PSI)	Max Breakdown Pressure (PSI)	ISIP (PSI)	Amount of Proppant (lbs)	Amount of Water (bbls)	Amount of Nitrogen/other (units)
*PLEASE SEE ATTACHED EXHIBIT 2								

Please insert additional pages as applicable.

WR-35
Rev. 8/23/13

API 47- 095 - 02452 Farm name Antero Resources Corporation Well number Olive Unit 3H

<u>PRODUCING FORMATION(S)</u>	<u>DEPTHS</u>		
Marcellus	6539' (TOP)	TVD	6790' (TOP) MD

Please insert additional pages as applicable.

GAS TEST Build up Drawdown Open Flow OIL TEST Flow Pump

SHUT-IN PRESSURE Surface 4100 psi Bottom Hole --- psi DURATION OF TEST --- hrs

OPEN FLOW Gas 12173 mcfpd Oil 345 bpd NGL --- bpd Water 661 bpd GAS MEASURED BY Estimated Orifice Pilot

LITHOLOGY/ FORMATION	TOP	BOTTOM	TOP	BOTTOM	DESCRIBE ROCK TYPE AND RECORD QUANTITY AND TYPE OF FLUID (FRESHWATER, BRINE, OIL, GAS, H ₂ S, ETC)
	DEPTH IN FT NAME TVD	DEPTH IN FT TVD	DEPTH IN FT MD	DEPTH IN FT MD	

***PLEASE SEE ATTACHED EXHIBIT 3**

Please insert additional pages as applicable.

Drilling Contractor Frontier Drilling LLC
Address 562 Spring Run Road City Pennsboro State WV Zip 26415

Logging Company Reach Wireline
Address 100 Nu Energy Drive, Suite 1 City Aledo State TX Zip 76008

Cementing Company C&J Energy Services
Address 1650 Hackers Creek City Jane Lew State WV Zip 26378

Stimulating Company US Well Services
Address 535 Industrial Park Drive City Jane Lew State WV Zip 26378

Please insert additional pages as applicable.

Completed by Karin Cox Telephone 303-357-7223
Signature  Title Permitting Agent Date 2/28/2019

Submittal of Hydraulic Fracturing Chemical Disclosure Information Attach copy of FRACFOCUS Registry

API 47-095-02452 Farm Name Antero Resources Corporation Well Number Olive Unit 3H					
EXHIBIT 1					
Stage No.	Perforation Date	Perforated from MD ft.	Perforated to MD ft.	Number of Perforations	Formations
1	8/27/2018	15879	15984.5	24	Marcellus
2	8/27/2018	15678.18	15847.53	48	Marcellus
3	8/28/2018	15477.36	15646.71	48	Marcellus
4	8/28/2018	15276.54	15445.89	48	Marcellus
5	8/28/2018	15075.72	15245.07	48	Marcellus
6	8/29/2018	14874.9	15044.25	48	Marcellus
7	8/29/2018	14674.08	14843.43	48	Marcellus
8	8/29/2018	14473.26	14642.61	48	Marcellus
9	8/30/2018	14272.44	14441.79	48	Marcellus
10	8/30/2018	14071.62	14240.97	48	Marcellus
11	8/30/2018	13870.8	14040.15	48	Marcellus
12	8/31/2018	13669.98	13839.33	48	Marcellus
13	8/31/2018	13469.16	13638.51	48	Marcellus
14	8/31/2018	13268.34	13437.69	48	Marcellus
15	9/1/2018	13067.52	13236.87	48	Marcellus
16	9/1/2018	12866.7	13036.05	48	Marcellus
17	9/1/2018	12665.88	12835.23	48	Marcellus
18	9/1/2018	12465.06	12634.41	48	Marcellus
19	9/2/2018	12264.24	12433.59	48	Marcellus
20	9/2/2018	12063.42	12232.77	48	Marcellus
21	9/2/2018	11862.6	12031.95	48	Marcellus
22	9/3/2018	11661.78	11831.13	48	Marcellus
23	9/3/2018	11460.96	11630.31	48	Marcellus
24	9/3/2018	11260.14	11429.49	48	Marcellus
25	9/4/2018	11059.32	11228.67	48	Marcellus
26	9/4/2018	10858.5	11027.85	48	Marcellus
27	9/4/2018	10657.68	10827.03	48	Marcellus
28	9/4/2018	10456.86	10626.21	48	Marcellus
29	9/5/2018	10256.04	10425.39	48	Marcellus
30	9/5/2018	10055.22	10224.57	48	Marcellus
31	9/5/2018	9854.4	10023.75	48	Marcellus
32	9/5/2018	9653.58	9822.93	48	Marcellus
33	9/6/2018	9452.76	9622.11	48	Marcellus
34	9/6/2018	9251.94	9421.29	48	Marcellus
35	9/7/2018	9051.12	9220.47	48	Marcellus
36	9/7/2018	8850.3	9019.65	48	Marcellus
37	9/7/2018	8649.48	8818.83	48	Marcellus
38	9/7/2018	8448.66	8618.01	48	Marcellus
39	9/8/2018	8247.84	8417.19	48	Marcellus
40	9/8/2018	8047.02	8216.37	48	Marcellus
41	9/8/2018	7846.2	8015.55	48	Marcellus
42	9/9/2018	7645.38	7814.73	48	Marcellus
43	9/9/2018	7444.56	7613.91	48	Marcellus
44	9/9/2018	7243.74	7413.09	48	Marcellus
45	9/10/2018	7042.92	7212.27	48	Marcellus
46	9/10/2018	6842.1	7011.45	48	Marcellus

API 47-095-02452 Farm Name Antero Resources Corporation Well Number Olive Unit 3H

EXHIBIT 2

Stage No.	Stimulations Date	Avg Pump Rate	Avg Treatment Pressure (PSI)	Max Breakdown Pressure (PSI)	ISIP (PSI)	Amount of Proppant (lbs)	Amount of Water (bbls)	Amount of Nitrogen/ other (units)
1	8/27/2018	73.2874	7173.831	5927	4916	270100	7382	N/A
2	8/27/2018	77.3983	7636.065	5253	3901	333370	7713	N/A
3	8/28/2018	79.5648	7451.637	5261	4306	401400	7972	N/A
4	8/28/2018	76.2375	7295.145	4690	3965	443660	8618	N/A
5	8/28/2018	76.0577	7573.695	7068	3880	401180	7935	N/A
6	8/29/2018	70.7719	7277.57	5759	3444	414680	8239	N/A
7	8/29/2018	71.425	7112.318	4986	3397	414080	8180	N/A
8	8/29/2018	73.1634	7539.239	5614	4027	400260	9471	N/A
9	8/30/2018	74.094	7375.663	5386	3710	413415	8192	N/A
10	8/30/2018	73.0047	7217.435	5260	3670	403460	8033	N/A
11	8/30/2018	76.0746	7401.066	5518	3692	401760	7867	N/A
12	8/31/2018	77.4318	7537.089	5566	3516	406520	7961	N/A
13	8/31/2018	72.9254	7223.145	5711	3905	403420	7969	N/A
14	8/31/2018	76.8599	7439.296	6157	3268	400220	7943	N/A
15	9/1/2018	78.0265	7158.971	4996	3524	400840	7941	N/A
16	9/1/2018	76.3389	7162.472	5006	3270	403040	7959	N/A
17	9/1/2018	76.3064	7322.004	5870	3484	399400	7917	N/A
18	9/1/2018	76.6791	7311.85	6460	3511	400820	7805	N/A
19	9/2/2018	75.711	7017.319	6208	3311	403620	7964	N/A
20	9/2/2018	74.5737	7101.088	6496	3394	402940	7793	N/A
21	9/2/2018	78.0461	7126.228	6588	3825	401440	7779	N/A
22	9/3/2018	79.3099	6983.674	5750	3844	400880	7871	N/A
23	9/3/2018	74.8567	7202.524	6018	3832	401530	7953	N/A
24	9/3/2018	77.9219	7065.888	5796	3771	399700	7754	N/A
25	9/4/2018	79.1699	7160.54	6147	4292	398900	7855	N/A
26	9/4/2018	76.7183	7151.611	5885	4059	404060	7836	N/A
27	9/4/2018	75.9493	7047.461	6003	3831	402500	7834	N/A
28	9/4/2018	80.1638	7365.615	5784	3716	400360	7827	N/A
29	9/5/2018	78.0261	7314.072	5853	3704	401520	7822	N/A
30	9/5/2018	75.0575	7087.414	6363	3866	402620	7814	N/A
31	9/5/2018	75.7126	6945.018	5949	4039	404680	7796	N/A
32	9/5/2018	77.3275	7087.087	6001	3659	402420	7797	N/A
33	9/6/2018	79.8132	6997.785	6252	4571	400920	7811	N/A
34	9/6/2018	77.3652	7021.706	6165	3305	401520	7774	N/A
35	9/7/2018	78.3593	7051.049	5852	3556	401120	7766	N/A
36	9/7/2018	77.9245	6805.553	6352	3725	401500	7652	N/A
37	9/7/2018	80.5162	6595.01	5583	3756	402520	7645	N/A
38	9/7/2018	76.8732	6593.439	6299	3432	405840	7643	N/A
39	9/8/2018	77.8889	6650.16	6315	3442	406780	7636	N/A
40	9/8/2018	78.9234	6877.667	6686	4773	403020	7798	N/A
41	9/8/2018	72.3969	7407	6157	4627	402140	11954	N/A
42	9/9/2018	79.6223	6911.857	5883	3634	402580	7611	N/A
43	9/9/2018	79.6156	6717.44	6724	3943	403560	7610	N/A
44	9/9/2018	79.1091	6929.714	6409	3515	402800	7585	N/A
45	9/10/2018	79.5768	6937.467	7033	3785	403240	7572	N/A
46	9/10/2018	79.8752	6599.021	5658	4025	403200	7569	N/A
	AVG=	77	7,130	5,928	3,796	18,379,535	366,418	TOTAL

API 47-095-02452 Farm Name Antero Resources Corporation Well Number Olive Unit 3H				
EXHIBIT 3				
LITHOLOGY/ FORMATION	TOP DEPTH (TVD) From Surface	BOTTOM DEPTH (TVD) From Surface	TOP DEPTH (MD) From Surface	BOTTOM DEPTH (MD) From Surface
Sandstone	0	528	0	528
Silty sandstone	est. 528	568	est. 528	568
Sandy siltstone	est. 568	608	est. 568	608
Silty shale	est. 608	688	est. 608	688
Calcareous shale	est. 688	788	est. 688	788
Shaly siltstone	est. 788	848	est. 788	848
Silty Marlstone	est. 848	948	est. 848	948
Calcareous shale	est. 948	1,008	est. 948	1,008
Sandy siltstone	est. 1008	1,088	est. 1008	1,088
Calcareous shale	est. 1088	1,328	est. 1088	1,328
Coal / shale	est. 1328	1,468	est. 1328	1,468
Sandy shale/coal	est. 1468	1,908	est. 1468	1,908
Sandy siltstone	est. 1908	2,006	est. 1908	2,021
Big Lime	2,006	2,204	2,021	2,222
Big Injun	2,204	2,686	2,222	2,713
Gantz Sand	2,686	2,827	2,713	2,857
Fifty Foot Sandstone	2,827	2,948	2,857	2,979
Gordon	2,948	3,112	2,979	3,146
Fifth Sandstone	3,112	3,393	3,146	3,429
Bayard	3,393	3,697	3,429	3,737
Warren	3,697	4,075	3,737	4,118
Speechley	4,075	4,325	4,118	4,369
Balltown	4,325	4,717	4,369	4,761
Bradford	4,717	4,996	4,761	5,040
Benson	4,996	5,402	5,040	5,446
Alexander	5,402	5,900	5,446	5,947
Rhinestreet	5,900	6,250	5,947	6,313
Sycamore	6,250	6,392	6,313	6,482
Middlesex	6,392	6,484	6,482	6,625
Burkett	6,484	6,510	6,625	6,684
Tully	6,510	6,539	6,684	6,790
Marcellus	6,539	N/A	6,790	N/A

*Please note Antero determines formation tops based on mud logs that are only run on one well on a multi-well pad. The measured depth (MD) data on subsequent wells may be slightly different due to the well's unique departure.

Hydraulic Fracturing Fluid Product Component Information Disclosure

Job Start Date:	8/27/2018
Job End Date:	9/10/2018
State:	West Virginia
County:	Tyler
API Number:	47-095-02452-00-00
Operator Name:	Antero Resources Corporation
Well Name and Number:	Olive 3H
Latitude:	39.42242800
Longitude:	-80.91346900
Datum:	NAD83
Federal Well:	NO
Indian Well:	NO
True Vertical Depth:	6,598
Total Base Water Volume (gal):	15,211,560
Total Base Non Water Volume:	0



Hydraulic Fracturing Fluid Composition:

Trade Name	Supplier	Purpose	Ingredients	Chemical Abstract Service Number (CAS #)	Maximum Concentration in Additive (% by mass)**	Maximum Concentration in HF Fluid (% by mass)**	Comments
Water	Antero Resources	Carrier/Base Fluid	Water	7732-18-5	100.00000	87.11425	
Sand	J.S. Well Services, LLC	Proppant					
HCL Acid (12.6%-17.5%)	J.S. Well Services, LLC	Bulk Acid	Crystalline Silica, quartz	14808-60-7	100.00000	12.62071	
			Water	7732-18-5	87.40000	0.14751	
			Hydrogen Chloride	7647-01-0	17.50000	0.03430	
LGC-15	J.S. Well Services, LLC	Gelling Agents					
			Guar Gum	9000-30-0	50.00000	0.02127	
			Petroleum Distillates	64742-47-8	60.00000	0.02015	
			Suspending agent (solid)	14808-60-7	3.00000	0.00325	
			Surfactant	68439-51-0	3.00000	0.00128	
WFRA-405	J.S. Well Services, LLC	Friction Reducer					
			2-Propenoic acid, polymer with 2-propenamide	29003-06-9	30.00000	0.01548	
			Hydrated light distillate (petroleum)	64742-47-8	30.00000	0.01246	

Bioclear 2000	J.S. Well Services, LLC	Anti-Bacterial Agent							
			2,2-dibromo-3-nitropropionamide	10222-01-2		20.00000		0.00435	
SI-1200s	J.S. Well Services, LLC	Scale Inhibitor	Deionized Water	7732-18-5		28.00000		0.00248	
AP One	J.S. Well Services, LLC	Gel Breakers	Proprietary Scale Inhibitor	Proprietary		10.00000		0.00137	
AI-303	J.S. Well Services, LLC	Acid Corrosion Inhibitors	Ammonium Persulfate	7727-54-0		100.00000		0.00104	
			Ethylene glycol	107-21-1		40.00000		0.00005	
			Cinnamaldehyde	104-55-2		20.00000		0.00002	
			Formic acid	64-18-6		20.00000		0.00002	
			Butyl cellosolve	111-76-2		20.00000		0.00002	
			Polyether	60828-78-6		10.00000		0.00001	
			Acetophenone, thiourea, formaldehyde polymer	68527-49-1		5.00000		0.00000	

Ingredients shown above are subject to 29 CFR 1910.1200(i) and appear on Material Safety Data Sheets (MSDS). Ingredients shown below are Non-MSDS.

* Total Water Volume sources may include fresh water, produced water, and/or recycled water

** Information is based on the maximum potential for concentration and thus the total may be over 100%

Note: For Field Development Products (products that begin with FDP), MSDS level only information has been provided. Ingredient information for chemicals subject to 29 CFR 1910.1200(i) and Appendix D are obtained from suppliers Material Safety Data Sheets (MSDS)

LATITUDE 39°27'30"

10,867'

LATITUDE 39°27'30"

2,042' TO BOTTOM HOLE

4,267' TO BOTTOM HOLE

LONGITUDE 80°55'00"

13,078'

LONGITUDE 80°52'30"

AS DRILLED DATA:
WELL 3H TOP HOLE INFORMATION:
 N: 339,108ft E: 1,600,709ft
 LAT: 39°25'20.74" LON: 80°54'48.49"
BOTTOM HOLE INFORMATION:
 N: 347,965ft E: 1,597,904ft
 LAT: 39°26'47.83" LON: 80°55'26.03"
 WEST VIRGINIA COORDINATE SYSTEM OF 1927 NORTH ZONE. ZONE WAS DERIVED FROM MEASUREMENTS TAKEN WITH TRIMBLE GEOXT SUBMETER MAPPING GRADE GPS UNIT. PLAT ORIENTATION, CORNER, AND WELL REFERENCE TIE LINES ARE BASED ON GRID NORTH.
 3H BOTTOM HOLE

(NAD) 83 (UTM) ZONE 17 COORDS:
WELL 3H TOP HOLE INFORMATION:
 N: 4,363,668m E: 507,463m
BOTTOM HOLE INFORMATION:
 N: 4,366,352m E: 506,563m

03/08/2019

LEGEND

- Surface Owner Boundary Lines +/-
- Interior Surface Tracts +/-
- Proposed Well Path
- As Drilled Well Path

1. NO OCCUPIED DWELLINGS OR BUILDINGS TWO THOUSAND FIVE HUNDRED (2,500) SQUARE FEET OR LARGER USED TO HOUSE OR SHELTER DAIRY CATTLE OR POULTRY HUSBANDRY ARE LOCATED WITHIN SIX HUNDRED TWENTY-FIVE (625) FEET OF THE CENTER OF THE WELL PAD.
 2. TOP HOLE DATA SHOWN HEREON WAS PROVIDED BY ALLEGHENY SURVEYS, INC.
 3. AS DRILLED DATA WAS PROVIDED BY ANTERO RESOURCES CORPORATION.
 4. WLS IS NOT CERTIFYING THE DATA AND INFORMATION PROVIDED LISTED IN NOTES 2 AND 3, ONLY THE RELATIONSHIP TO THE DATA AND INFORMATION PROVIDED TO THE LEASE BOUNDARIES.
 5. WLS IS BY NO MEANS RESPONSIBLE FOR ANY ERRORS OR INACCURACIES WITH THE DATA AND INFORMATION THAT HAS BEEN PROVIDED.

DOUGLAS R. ROWE
 LICENSED
 No. 2202
 STATE OF WEST VIRGINIA
 PROFESSIONAL SURVEYOR

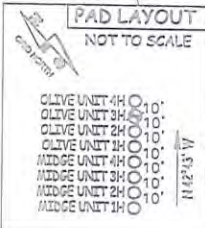
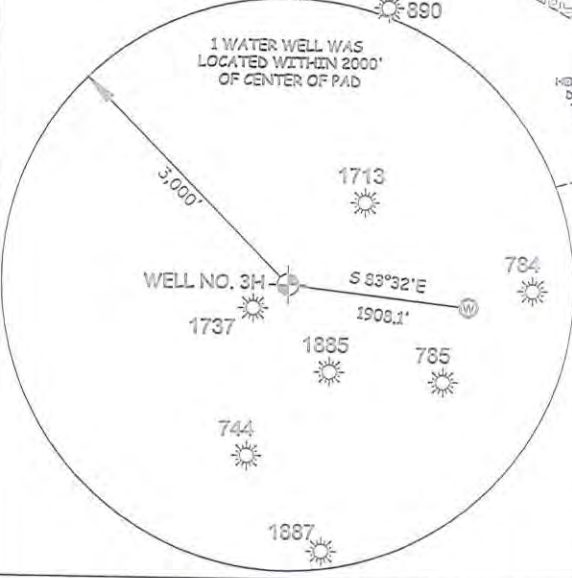

JOB # 16-049WA	I, THE UNDERSIGNED, HEREBY CERTIFY THAT THIS PLAT IS CORRECT TO THE BEST OF MY KNOWLEDGE AND BELIEF AND SHOWS ALL THE INFORMATION REQUIRED BY LAW AND THE RULES ISSUED AND PERSCRIBED BY THE DEPARTMENT OF ENVIRONMENTAL PROTECTION.	STATE OF WEST VIRGINIA, DIVISION OF ENVIRONMENTAL PROTECTION, OFFICE OF OIL AND GAS	DOUGLAS R. ROWE P.S. 2202
DRAWING # OLIVE3HAD		WILLOW LAND SURVEYING PLLC 220 MASONIC AVE. PENNSBORO WEST VIRGINIA 26415	DATE 01/21/19
SCALE 1" = 1000'		OPERATOR'S WELL# OLIVE UNIT #3H	COUNTY NAME
MINIMUM DEGREE OF ACCURACY SUBMETER			
PROVEN SOURCE OF ELEV. SUBMETER MAPPING GRADE GPS	STATE OF WEST VIRGINIA DEPARTMENT OF ENERGY DIVISION OF OIL AND GAS	ACREAGE 77.73 ACRES +/-	PERMIT
WELL TYPE: OIL <input checked="" type="checkbox"/> GAS <input type="checkbox"/> LIQUID INJECTION <input type="checkbox"/> WASTE DISPOSAL <input type="checkbox"/>	QUADRANGLE MIDDLEBOURNE 7.5'	LEASE ACREAGE 94 AC.; 40.27 AC.; 27.5 AC.;	PERMIT
(IF "GAS") PRODUCTION <input checked="" type="checkbox"/> STORAGE <input type="checkbox"/> DEEP <input type="checkbox"/> SHALLOW <input checked="" type="checkbox"/>	SURFACE OWNER ANTERO RESOURCES CORPORATION	149.29 AC.; 53.13 AC.; 166.63 AC.; 119 AC.; 52.32 AC.;	
LOCATION: ELEVATION 1,155' AS BUILT	OIL & GAS ROYALTY OWNER RONALD H. WOODBURN; KATHLEEN L. LOUGH; RUSSELL PAUL STACKPOLE;	PLUG & ABANDON CLEAN OUT & REPLUG	PERMIT
QUADRANGLE MIDDLEBOURNE 7.5'	LISA A. GUYZAK; ROBERT GOODE; MARK HUMM ET UX; ROBERT HALSTEAD; JERRY R. BROWN	ESTIMATED DEPTH 6,523' TVD 16,109' MD	
SURFACE OWNER ANTERO RESOURCES CORPORATION	PROPOSED WORK: DRILL <input type="checkbox"/> CONVERT <input type="checkbox"/> DRILL DEEPER <input type="checkbox"/> REDRILL <input type="checkbox"/> FRACTURE OR STIMULATE <input type="checkbox"/>	DESIGNATED AGENT DIANNA STAMPER - CT CORPORATION SYSTEM	PERMIT
OIL & GAS ROYALTY OWNER RONALD H. WOODBURN; KATHLEEN L. LOUGH; RUSSELL PAUL STACKPOLE;	PLUG OFF OLD FORMATION <input type="checkbox"/> PERFORATE NEW FORMATION <input type="checkbox"/> OTHER PHYSICAL CHANGE IN WELL (SPECIFY) AS DRILLED	ADDRESS 5400 D BIG TYLER ROAD CHARLESTON, WV 25313	
TARGET FORMATION MARCELLUS	WELL OPERATOR ANTERO RESOURCES CORP.		
ADDRESS 1615 WYNKOOP ST. DENVER, CO 80202			