

LATITUDE 39°25'00"

11,303'

6,720' TO BOTTOM HOLE

LATITUDE 39°25'00"

577' LONGITUDE 80°55'00"

7,265' TO BOTTOM HOLE

Antero Resources Corporation Well No. Orvis Unit 1H

- A - SURFACE - RAYMOND L. MOORE D.B. 265 PG. 310 T.M. 08 PAR. 29.110 AC. ±
- A - LEASE - RAYMOND L. MOORE ET UX
- B - SURFACE - DESTROY S. NELSON ET AL D.B. 347 PG. 643 T.M. 08 PAR. 23.1236 AC. ±
- B - LEASE - DAVID E. BOWYER
- C1, C2, C3 - SURFACE - DONALD R. ROBINSON ET AL D.B. 294 PG. 713 T.M. 08 PAR. 28.0514 AC. ±
- C1 - LEASE - LILLIAN LEE EDDY
- C2 - LEASE - DONALD E. ROBINSON ET UX
- C3 - LEASE - EARL G. GLENDENNING

NOTES:

WELL 1H TOP HOLE INFORMATION:  
N: 336,628ft E: 1,588,463ft  
LAT: 39°24'54.30" LON: 80°57'24.02"  
BOTTOM HOLE INFORMATION:  
N: 329,868ft E: 1,592,939ft  
LAT: 39°23'48.20" LON: 80°56'25.61"  
WEST VIRGINIA COORDINATE SYSTEM OF 1927 NORTH ZONE. ZONE WAS DERIVED FROM MEASUREMENTS TAKEN WITH TRIMBLE GEOXT SUBMETER MAPPING GRADE GPS UNIT. PLAT ORIENTATION, CORNER, AND WELL REFERENCE TIE LINES ARE BASED ON GRID NORTH.

(NAD) 83 (UTM) ZONE 17 COORDS:  
WELL 1H TOP HOLE INFORMATION:  
N: 4,362,850m E: 503,744m  
BOTTOM HOLE INFORMATION:  
N: 4,360,813m E: 505,143m

NOTE:  
7 WATER WELLS WERE LOCATED WITHIN 2000' OF CENTER OF PAD

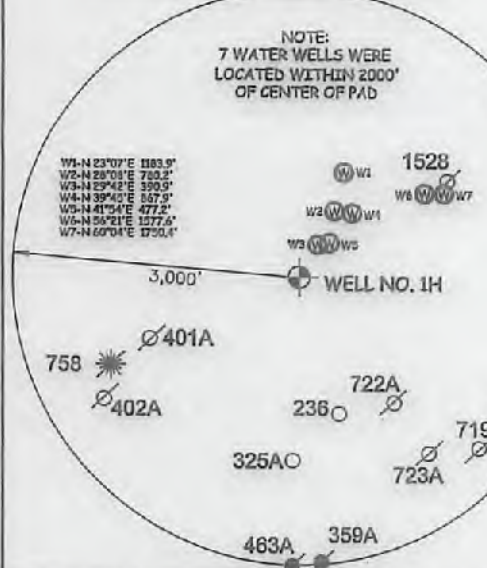

I, THE UNDERSIGNED, HEREBY CERTIFY THAT THIS PLAT IS CORRECT TO THE BEST OF MY KNOWLEDGE AND BELIEF AND SHOWS ALL THE INFORMATION REQUIRED BY LAW AND THE RULES ISSUED AND PERSCRIBED BY THE DEPARTMENT OF ENVIRONMENTAL PROTECTION.



STATE OF WEST VIRGINIA, DIVISION OF ENVIRONMENTAL PROTECTION, OFFICE OF OIL AND GAS

WILLOW LAND SURVEYING PLLC  
220 MASONIC AVE. PENNSBORO WEST VIRGINIA 26415

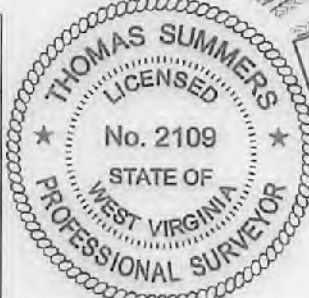

JOB # 17-003WA  
DRAWING # ORVIS1H  
SCALE 1" = 1000'  
MINIMUM DEGREE OF ACCURACY SUBMETER  
PROVEN SOURCE OF ELEV. SUBMETER MAPPING GRADE GPS  
STATE OF WEST VIRGINIA DEPARTMENT OF ENERGY DIVISION OF OIL AND GAS

LEGEND  
— Surface Owner Boundary Lines +/-  
- - - Interior Surface Tracts +/-  
⊕ Existing Fence  
⊕ Found monument, as noted  
*Thomas Summers*  
THOMAS SUMMERS P.S. 2109  
DATE 10/12/17  
OPERATOR'S WELL # ORVIS UNIT #1H



WELL TYPE: OIL  GAS  LIQUID INJECTION  WASTE DISPOSAL  47 - 085 - 02481  
(IF "GAS") PRODUCTION  STORAGE  DEEP  SHALLOW   
LOCATION: ELEVATION 799' - PROPOSED 791' - ORIGINAL \_\_\_\_\_ WATERSHED \_\_\_\_\_ STATE \_\_\_\_\_ COUNTY \_\_\_\_\_ PERMIT \_\_\_\_\_  
QUADRANGLE MIDDLEBOURNE 7.5' DISTRICT MEADE COUNTY TYLER  
SURFACE OWNER JAMES SINE ET AL ACREAGE 32.395 ACRES +/- LEASE ACREAGE 54.74 ACRES; 140 ACRES; 9.40 ACRES; 3.20 ACRES;  
OIL & GAS ROYALTY OWNER JAMES L. SINE ET UX; ROBERT S. CARSE ET UX; JASON GREATHOUSE; DAVID E. BOWYER  
DAVID W. JUDGE; DAVID CARSE; THOMAS W. MOORE ET AL; THOMAS W. MOORE ET AL; REITA J. HALL; GRACE SEWELL DeCARLO; TESSA PETERZAK 13.65 ACRES; 16 ACRES; 56.25 ACRES; 175.07 ACRES; 23.31 ACRES; 35.52 ACRES; 3 ACRES  
PROPOSED WORK: DRILL  CONVERT  DRILL DEEPER  REDRILL  FRACTURE OR STIMULATE   
PLUG OFF OLD FORMATION  PERFORATE NEW FORMATION  OTHER PHYSICAL CHANGE IN WELL (SPECIFY) \_\_\_\_\_  
TARGET FORMATION MARCELLUS ESTIMATED DEPTH 6,700' TVD 14,900' MD  
WELL OPERATOR ANTERO RESOURCES CORP. DESIGNATED AGENT DIANNA STAMPER - CT CORPORATION SYSTEM  
ADDRESS 1615 WYNKOOP STREET ADDRESS 5400 D BIG TYLER ROAD  
FORM WW-6 DENVER, CO 80202 CHARLESTON, WV 25313

02/09/2018

COUNTY NAME PERMIT

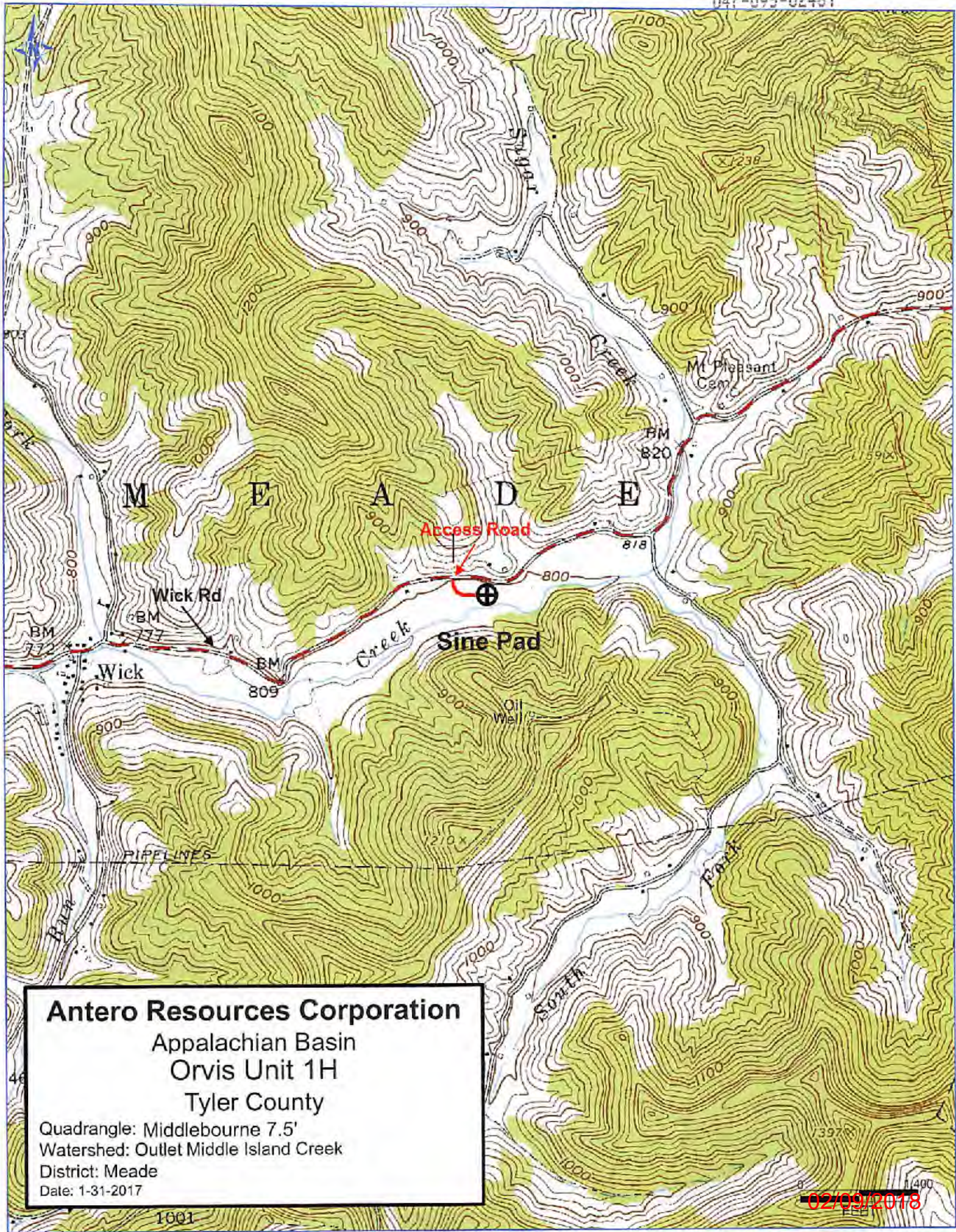

**Antero Resources Corporation**  
 Appalachian Basin  
 Orvis Unit 1H  
 Tyler County

Quadrangle: Middlebourne 7.5'  
 Watershed: Outlet Middle Island Creek  
 District: Meade  
 Date: 1-31-2017

02/09/2018